







ILLINI CENTRAL C.U.S.D. #189







ILLINI CENTRAL C.U.S.D. #189









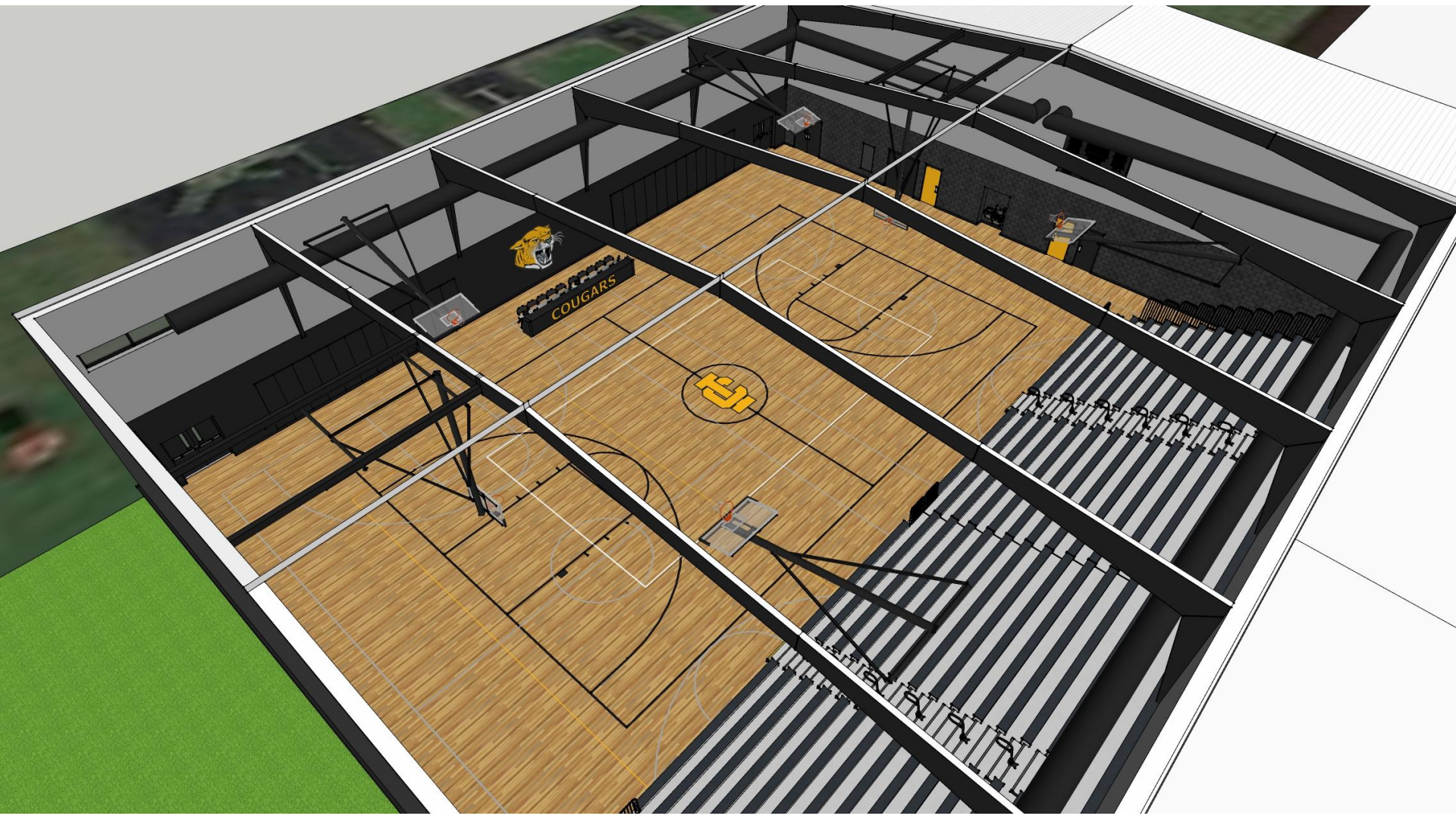









Illini Central Addition Renovation		50% CD Cost Estimate Update		
	50% CD	Original Low	Original High	
Base Bid	\$11,463,000	\$9,312,500	\$10,500,000	fitness (old shop) remodel not included
Site Added Scope	\$250,000			
Electrical Added Scope	\$250,000			
Subtotal	\$11,963,000			
Bid Contingency (5%)	\$598,150			
Total Base Bid	\$12,561,150	\$9,312,500	\$10,500,000	
Alts	\$1,500,000	\$2,100,000	\$2,650,000	
Alt Contingency (25%)	\$375,000	\$525,000	\$662,500	
Alts subtotal w/ contingency	\$1,875,000	\$2,625,000	\$3,312,500	
Construction Total with Alts	\$14,436,150	\$11,937,500	\$13,812,500	
Other Project Costs				
A/E Fees				
Construction Testing				
Owner's Insurance				
FF&E				
Financing/Legal Fees				
Operating Costs				
Abatement				
Ameren Direct Costs				
Relocate Maintenance Shed (any cost above \$50k allowance)				
Cafeteria Acoustics (Any cost above \$75k allowance)				
Old Shop / Fitness Center Remodel (took this out of original estimate numbers)				