

The Pilot Rock School District is eligible for a 2020 OSCM grant from the Oregon Department of Education. If the proposed district bond measure passes in November, the Pilot Rock School District would receive up to \$4 million in matching bond funds. If the proposed bond measure does not pass, the grant will be awarded to another qualifying school district.

## SCHOOL REPAIRS & DEFERRED MAINTENANCE

### PA system replacement.

Replacement of the PA system will allow the school to communicate with the front office during school lock downs or in the event of an emergency. Currently the PA system has limited functionality and is difficult to hear in all the classrooms.

### Interior & Exterior door repair and replacement.

Numerous interior doors, handles, locks, and frames are damaged and need replaced. Proper functionality of doors are important during an emergency such as a fire or a school lockdown. There are numerous doors which are non-secure, not working properly, or are damaged.

### Fire Alarm replacement & Upgrade.

The current fire alarms are dated require constant repair and are not up to current code. It's important that in the event of an emergency the fire alarms are working properly.

### HVAC system Repair & Retro-commission.

The old heating and cooling systems need replaced, and the newer systems need some fine tuning. A comfortable environment fosters better learning for the students and an efficient heating and cooling system saves energy.

### Roof repairs

Existing Roofing conditions vary from school to school but all are in need of repair and or replacement. Maintaining roof weather tightness prevents mold, structural damage, and damage to computers and books.

### Exterior Building Lighting

The current exterior entrance lighting is not up to current standards. Providing adequate lighting at building points of entry improve safety during after school events and prevents vandalism and break-ins.

### Interior Lighting and Ceiling replacement

The majority of classroom lighting at the facilities are original to the building. Replacement of the existing lighting will improve light quality and energy usage. The Power Company offers monetary incentive towards new lighting fixtures. During this replacement necessary ceiling repairs and replacement will also take place

### Window Replacement

Many of the windows throughout the school district are original and do not operate, are leaking, and are not energy efficient. Window replacement will allow an increase in energy efficiency and will provide natural ventilation to classroom spaces.

### New Flooring

The existing flooring throughout all facilities are in various states of condition. Much of the flooring is original and is in need of replacement. Upkeep of maintenance prolongs the functional use of buildings.

### Interior Painting

Although the school district has done a good job maintaining the interior paint, manpower and facilities budgets have been limited. Repainting of interior spaces will improve the overall appearance of the existing school.

### Furnishings & Lockers

The existing student desks, tables & chairs vary with age and condition as they have been replaced over time on an as needed basis. The lockers at the Jr/Sr. high school are original many of which are not functional and broken. Replacement will improve school appearance and will help with School District operational and maintenance budgets.

### Exterior Parking & Drainage

There are several areas in existing parking lots that puddle and do not drain correctly. Additional parking is also needed for after school events.

## NEW MIDDLE SCHOOL PERFORMANCE GYMNASIUM & COMMUNITY CENTER

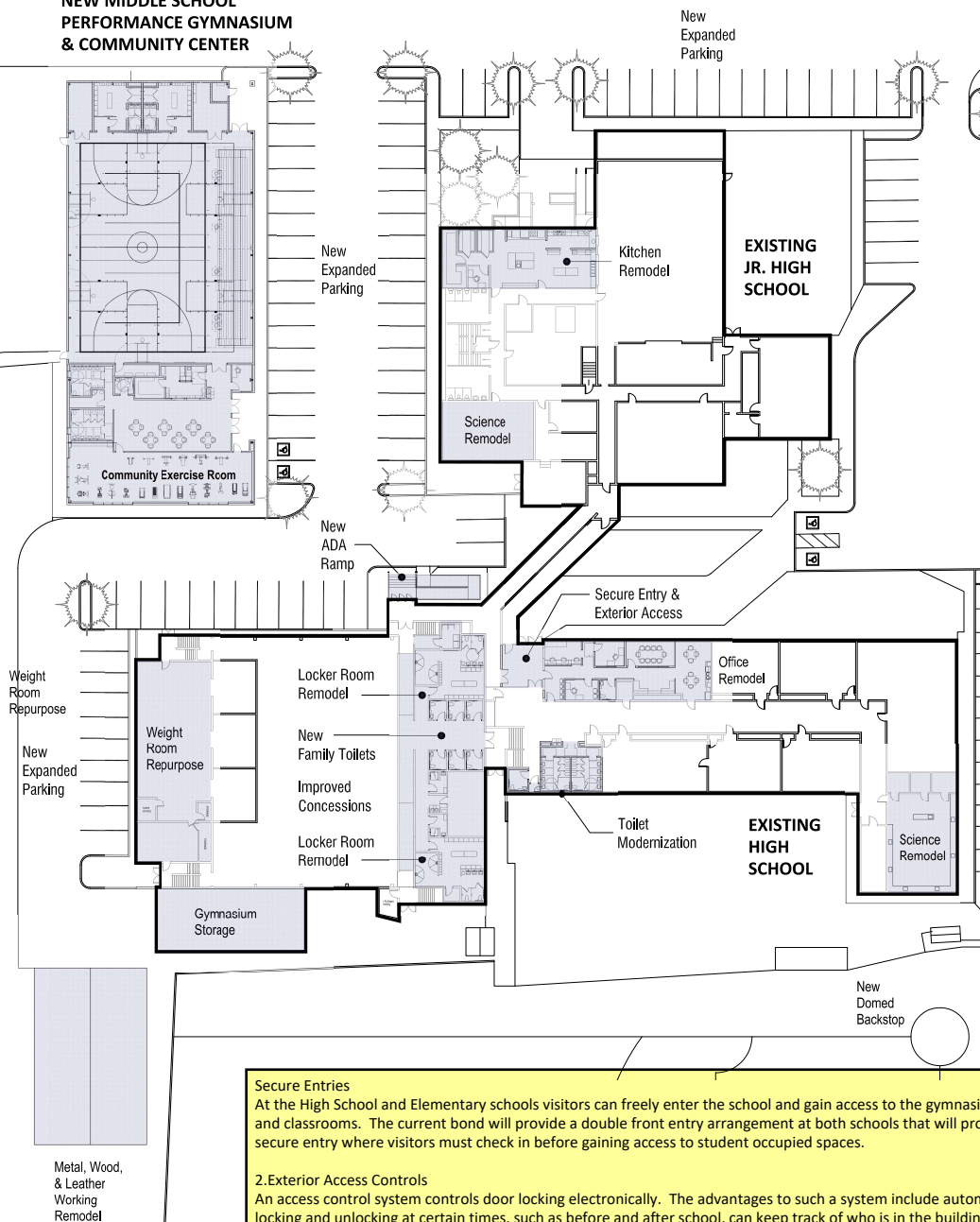

### Secure Entries

At the High School and Elementary schools visitors can freely enter the school and gain access to the gymnasiums and classrooms. The current bond will provide a double front entry arrangement at both schools that will provide a secure entry where visitors must check in before gaining access to student occupied spaces.

### 2.Exterior Access Controls

An access control system controls door locking electronically. The advantages to such a system include automatic locking and unlocking at certain times, such as before and after school, can keep track of who is in the building, and can provide automatic lockdown in the event of an emergency. Such access controls are the new standard on all school facilities.

### 3.Kitchen upgrades, remodel & equipment

The kitchens at both the Jr/Sr. high and elementary school have aged equipment and do not function efficiently. Remodeling and replacement of equipment foster efficiency in food preparation, provide healthy food for the students, and will help reduce School District food costs.

## NEW MIDDLE SCHOOL PERFORMANCE GYMNASIUM & COMMUNITY CENTER

