

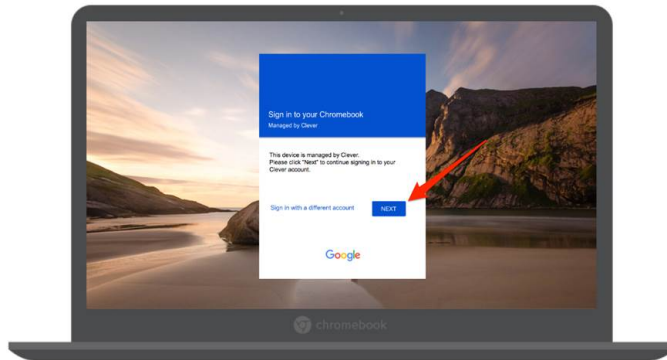

QR Code Badge login

Students who are using Badges will go through the following login flow:

1. They will have the option to choose "Sign in with a different account" or the blue "NEXT" button. They should select "NEXT".



- a. Note that the Chromebook must be joined to the student's home Wi-Fi network  before it will work. If they see an "Network not available" message they need to: Click on "**Add other Wi-Fi network.**" Then Select their **Wi-Fi network** from the list and enter their **Password.**
 - b. If they have trouble with the QR code working they can sign in with their username and password by clicking "**Sign in with a different account.**"
2. Once they select the "NEXT" button, the badge screen will appear. They should then be able to scan their badge, see a green checkmark.

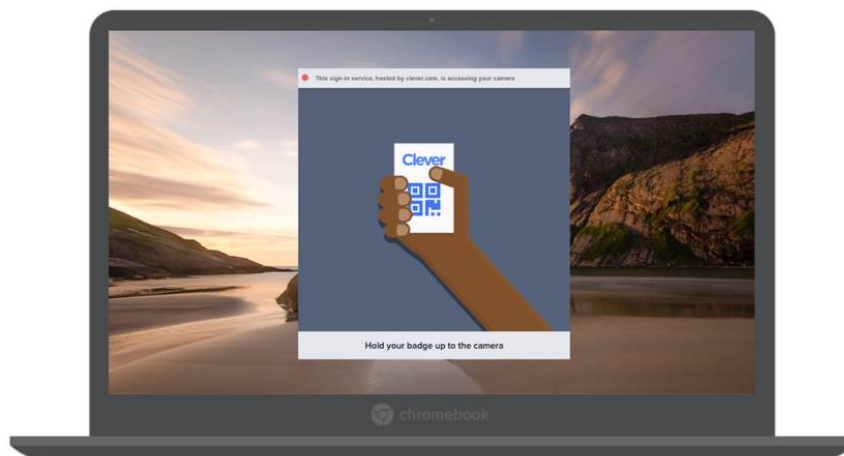

Once students see the green checkmark, the Clever loading page will appear and the student will be signed into the Chromebook!