

Janet's Law
Colonial Conference Verification Contract
2014-2015 School Year

Audubon
Haddon Heights
Paulsboro

Collingswood
Haddon Township
Sterling

Gateway
Lindenwold
West Deptford

Haddonfield
Overbrook
Woodbury

As you know, Janet's Law requires public and nonpublic schools K-12 to have automated external defibrillators or AEDs onsite and establish emergency action plans for responding to a sudden cardiac arrest event.

An AED must be placed onsite in an unblocked location with an appropriate sign to identify it. It should be accessible during the school day and any other time an athletic event, including practices, is taking place. The defibrillator needs to be "within reasonable proximity of the school athletic field", as applicable. For every minute that passes the chance of survival decreases 10 percent.

Janet's Law about onsite AED defibrillators on school grounds also mandates that schools "shall establish and implement an emergency action plan for responding to a sudden cardiac event including, but not limited to, an event in which the use of an automated external defibrillator may be necessary."

Please list all athletic facilities used throughout your school district.

Athletic Facilities Used in Your School District

- | | |
|--------------------------------------|----------------------------------|
| 1. <u>High School Irvine Gym</u> | 7. <u>Middle School Aux. Gym</u> |
| 2. <u>Middle School Ben Mark Gym</u> | 8. <u>Tennis Courts</u> |
| 3. <u>Oaklyn Public Schools</u> | 9. <u>Track</u> |
| 4. <u>Knights Park</u> | 10. <u>Softball fields</u> |
| 5. <u>Football Stadium</u> | 11. _____ |
| 6. <u>Coursen Wrestling Center</u> | 12. _____ |

Please have the appropriate administrators sign this form below. Please note that the signatures below verify that you are compliant with Janet's Law and meet all requirements which are stated in the above description, including having an emergency action plan for responding to a sudden cardiac event.



Signature of Athletic Director

Ron Hamrick

Print Athletic Director's Name

11 / 10 / 14

Date



Signature of Principal

Matthew Genna

Print Principal's Name

11 / 10 / 14

Date

Syns O'mall

Signature of Superintendent

Scott A Oswald

Print Superintendent's Name

11 / 12 / 14

Date

Name of School: Collingswood High School

Collingswood Public Schools

Fall Sport	Level	Site	AED Location
Field Hockey	V	Knights Park	Between baseball fields
	JV	Knights Park	Between baseball fields
	F	Knights Park	Between baseball fields
	MS	Softball fields	Bay 3 Stadium
Football	V	Stadium	Bay 3 Stadium
	JV	Stadium	Bay 3 Stadium
	F	Stadium	Bay 3 Stadium
	MS	N/A	N/A
Soccer	V	Knights Park	Between baseball fields
	JV	Knights Park	Between baseball fields
	F	Knights Park	Between baseball fields
	MS	Knights Park	Between baseball fields
Tennis	V	Tennis Courts	Bay 3 Stadium
	JV	Tennis Courts	Bay 3 Stadium
Cross Country	V / JV	Pennypacker/WD park	Coach has one
	MS	Pennypacker/WD Park	Coach has one
Winter Sport	Level	Site	AED Location
Basketball	V / JV / F	Irvine Gym	Hallway
	MS	Ben Mark Gym	Hallway
Bowling	V / JV	Westbrook	Coach has one
Swimming	V/JV	Camden County/Gloucester College	Coach has one
Winter Track	V / JV	Track	Bay 3 Stadium
Wrestling	V / JV	Coursen Center	Hallway
	MS	Auxiliary Gym	Hallway
Spring Sport	Level	Site	AED Location
Baseball	V	Knights Park	Between Baseball fields
	JV	Knights Park	Between Baseball fields
	F	Knights Park	Between Baseball fields
Crew	V / JV / F	N/A	N/A
Golf	V / JV	N/A	N/A
Lacrosse	V / JV	Knights Park	Between baseball fields
	F	Knights Park	Between baseball fields
Softball	V	Softball fields	Bay 3 Stadium
	JV	Softball fields	Bay 3 Stadium
	F	Softball fields	Bay 3 Stadium
Tennis	V / JV	Tennis Courts	Bay 3 Stadium
Track	V / JV	Stadium	Bay 3 Stadium

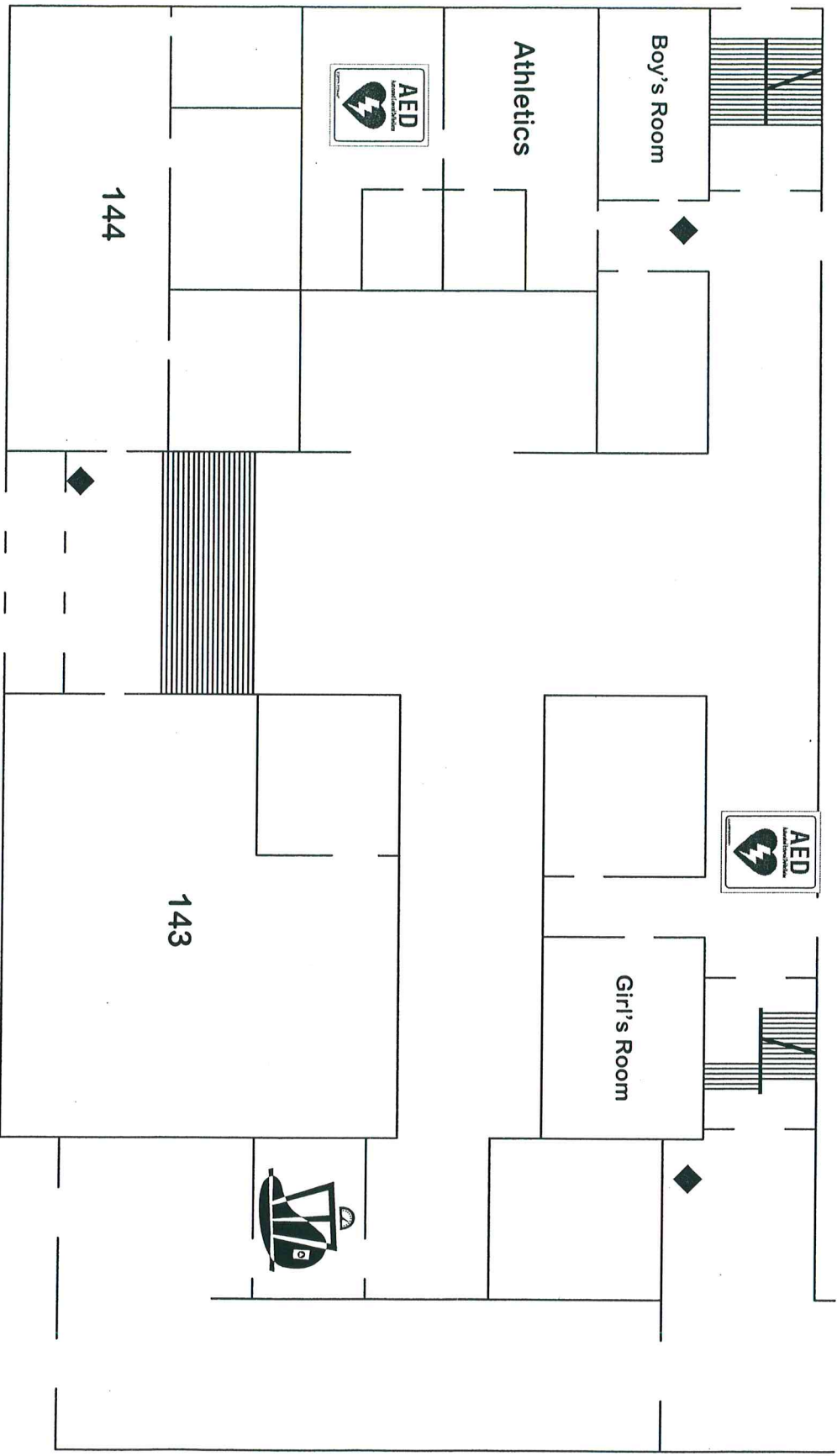

Irvine Gym - 1st Floor

AED HS-2 (Hallway); AED HS-5 & HS-6 (Athletics)

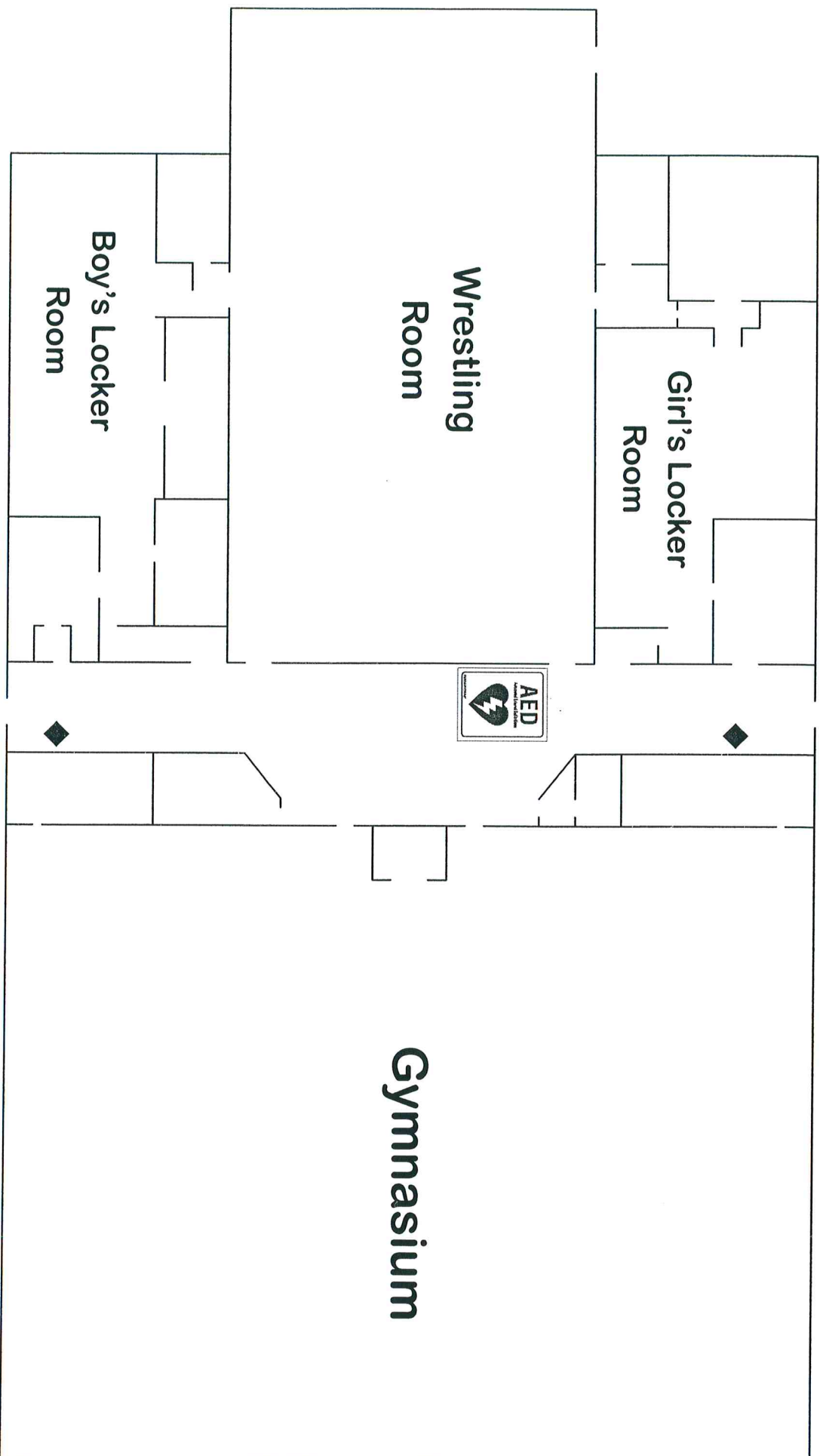

Ben Mark Gym - 1st Floor

AED MS-1

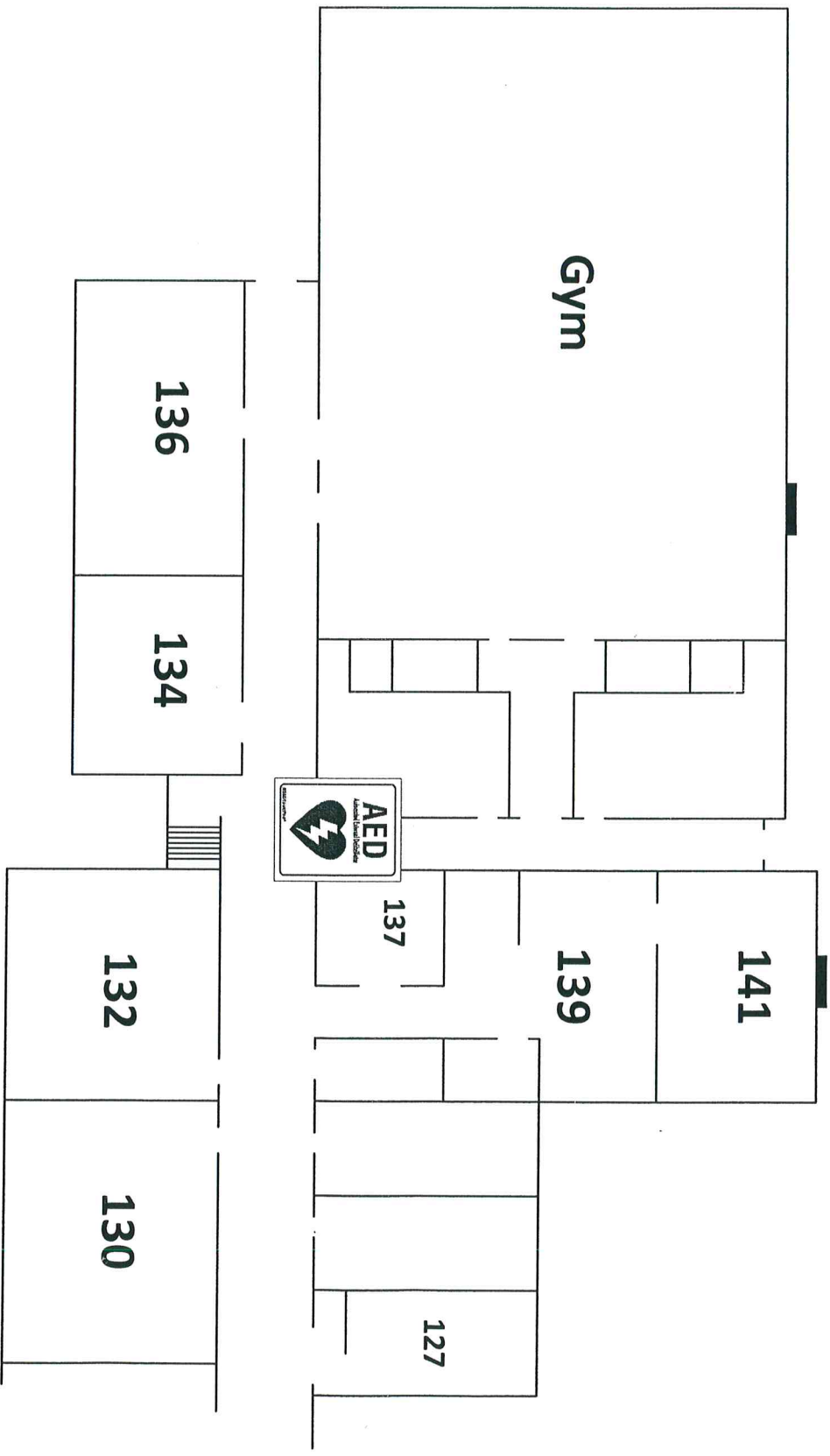

Oaklyn - 1st Floor

AED OAK-1