

Highland Primary

2022-2023



Back to School- 2022-23

Parents:

GETTING TO AND FROM SCHOOL SAFELY:

- ✓ **Before coming to school:** If your child is displaying symptoms of Covid 19 or generalized illness such as: fever greater than 100.0, new onset of cough, shortness of breath, chills, fatigue, muscle and body aches, moderate to severe headache, sore throat, new loss of taste and smell, vomiting, or diarrhea, please keep your child home and contact his/her physician.
- ✓ **If your child is eligible for bus transportation and you wish for them to ride a bus,** parents will need to check the correct boxes on InfoSnap when registering. Students must wear a mask while riding the bus.
- ✓ **If your student is a bus rider,** they will exit the bus near the cafeteria doors and enter the Primary from the back ramp door.
- ✓ Please keep your student's transportation plan **consistent and simple.**
- ✓ **If you have a drop-off student,** they will exit your car when it comes to a stop between the center and east doors of the Primary. **Highland Primary doors will open at 8am.**
- ✓ **If you have a pick up student,** please meet your child at the designated door. (See Pick-Up Map below.)
- ✓ If you need to pick your student up during the school day, please report to the office and **show identification** to sign your student out.
- ✓ Primary students are **not allowed** to walk or ride a bike alone to and from school, without proper supervision.



Students:

AT SCHOOL:



- ✓ **When I arrive at school**, I will report the HP gym, find my teacher's picture, and sit in my classroom line.
- ✓ **If I am a breakfast eater**, I will be dismissed by holding up my breakfast tag when breakfast is announced. (If you would like to sign your child up to have a breakfast tag and didn't mark that in Info Snap, please contact the Highland Primary office.)
- ✓ After eating I will return to the gym for the Morning Assembly/Pledge of Allegiance. Then, I will be dismissed to go to my classroom.
- ✓ I will have a schedule for washing my hands throughout the day.
- ✓ **I will memorize my lunch number**, so that I can type it in the keypad in the cafeteria as a buyer. We will be using all three serving lines.
- ✓ If I bring my lunch, my teacher will seat me at a designated table. I can bring my drink from home or purchase milk from the cafeteria.
- ✓ At recess, I will be able to play with my entire grade level and recess equipment.



Kindergarten 1st Week:

Highland Community Unit School District No. 5

Kindergarten Events

Highland Primary
First Week's Schedule
August 17-19, 2022

Wednesday, August 17, 2022 – Kindergarten Orientation

You and your kindergarten child are invited to visit the classroom on Wednesday, August 17.

If your child's last name begins with:

A-K – you are invited to the morning session from 9:30 – 11:00 a.m.

L-Z – you are invited to the afternoon session from 12:30 – 2:00 p.m.

You and your child will be introduced to the kindergarten program and participate in fun activities. Please bring school supplies with your child on this day. ***Please label with student's name.**

School supplies include:

- | | |
|--|--|
| 1 RED plastic folder with two pockets and prongs | 1 <u>Crayola</u> watercolor paint set (single row) |
| 1 plastic folder with two pockets (no side pockets) | 1 pair <u>Fiskars</u> scissors |
| 1 pink block eraser | 1 large box of facial tissues |
| 24 count box of standard size <u>Crayola</u> crayons | 1 box of baby wipes or a refill pack (boys) |
| 8 count <u>Crayola</u> crayons (Not Jumbo) | 1 container of <u>Clorox</u> wipes (girls) |
| 2 (4 oz.) bottles of white <u>Elmer's</u> school glue | 1 large bath towel (no rest mats, please) |
| (not-"No Run" or Gel) | 1 box <u>Ziploc</u> gallon size bags (Boys) |
| 3 large glue sticks (.77 oz.) (2 for classroom, 1 for art) | 1 box <u>Ziploc</u> quart size bags (Girls) |
| 10 Ticonderoga #2 pencils, <u>sharpened</u> | headphones (not earphones) that fit an iPad |
| 1 box broad tipped large washable <u>Crayola Classic Markers</u> | 1 plastic supply box |
| *backpack or book bag (no wheels) | |
| *gym shoes, <u>velcro</u> or <u>slip-on</u> (No black soles unless non marking.) | |

If your child uses a lunch box, please be sure to label it with child's name.

(Some teachers may request additional items.)

We request that you and your child come to participate in this activity together (without siblings). Only kindergarten students accompanied by an adult are expected to attend kindergarten class on this day.

Bus transportation will **not** be available for kindergarten students on Wednesday, August 17, 2022.

Please park in the parking lot nearest Lindendale Park to avoid being blocked in by school buses.

This is a special time for you and your child to get to know the teacher, school procedures, and classroom environment, as well as ask questions.

Thursday, August 18, 2022

Only kindergarten students with last initials A-K will attend on Thursday.

Friday, August 19, 2022

Only kindergarten students with last initials L-Z will attend on Friday.

Monday, August 22, 2022

All students will be in attendance.

Updates for the 22-23 school year

- The doors will open at 8am. School will start at 8:40 and end at 3:20pm.
- All students will be entering the building and reporting to the gym. (Please remind them so they don't go directly to the classrooms.)
- Breakfast and lunch will not be free for all students this year. Students will be required to know their lunch number to purchase meals. This number is the same as their student ID number.
 - Breakfast \$1.35 (reduced .30)
 - Lunch \$3.10 (reduced .40)
- During registration you should have indicated whether or not your student will be eating breakfast at school. If you would like to make a change to this please email treichman@highlandcusd5.org or call the HP Office. Also please know that if your child is signed up to eat breakfast, they can still choose not to eat breakfast on any given day.
- Student will use hand sanitizer upon entering the building, but will then have hand-washing breaks throughout the day.
- We will not be using lanyards or ID badges this year.
- We are looking for volunteers to help at the beginning of the school year as well as in the classrooms. If you are interested, please contact the office or your classroom teacher.
- Just a reminder to keep your child's transportation plan simple. One pick-up plan is best!
- We will again be using assigned doors for pick-up. Please see the map for your teacher's assigned location.

Pick Up Map:

PLAYGROUND

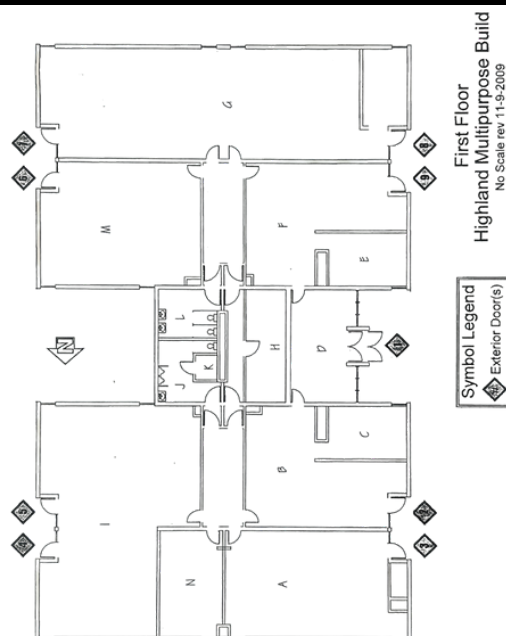

PRE-K:

Carman: Door 2
Hanlon: Door 2
Wilke: Door 3
Zuccarelli: Door 3
Hefferly: Door 1

KINDERGARTEN

Albers: Door 5
Mortland: Door 5
Potthast: Door 5
Townsend: Door 5
Wesselman: Door 6
Woods: Door 6
Mendenhall: Door 6

1ST GRADE

Drazen: Door 2
Ficker: Door 2
Geest: Door 14
Moss: Door 14
Counts: Door 1
Pittman: Door 1
Wilkinson: Door 1

2ND GRADE

Chapman: Cafeteria/Playground
Kellerstrass: Cafeteria/Playground
Laird: Cafeteria/Playground
Sinnock: Cafeteria/Playground
Smart: Cafeteria/Playground
Smith: Cafeteria/Playground
Warnecke: Cafeteria/Playground

Special Dates

- **August 10** - Parents may log into PowerSchool to see who their child's teacher is.
- **August 15** - Back to School Night 6-7pm (bring your school supplies)
- **August 17**
 - First day for Grade 1 & 2 students
 - Orientation for Kindergarten
 - Kdg. with last names A-K come with a parent from 9:30-11
 - Kdg. with last names L-Z come with a parent from 12:30-2
- **August 18** - Attendance day for Kdg. with last names A-K
- **August 19**
 - Attendance day for Kdg. with last names L-Z
 - Pre-K & ECH Orientation
- **August 22** - All students in attendance.
- **September 14** - Picture Day (For those not taken in Aug.)

We are looking forward to a great school year at Highland Primary!



Igniting bright futures to build a better community