

	Heating & Air Conditioning	Electrical	Addition	Total
<b>Simpson Elementary</b>	1,189,339	573,500	2,565,019	4,327,858
	<ul style="list-style-type: none"> <li>▶ New VRF Heating &amp; Air Conditioning</li> <li>▶ Repair Ceilings as Required</li> <li>▶ Remove Existing Systems</li> </ul>	<ul style="list-style-type: none"> <li>▶ Fire Alarm System</li> <li>▶ Clock System</li> <li>▶ Electric Service Revisions</li> <li>▶ Replace Outdated Panelboards</li> <li>▶ Add Exit Signs w/Battery Backup</li> <li>▶ Additional Emergency Lighting</li> </ul>	<ul style="list-style-type: none"> <li>▶ 6 Classrooms</li> <li>▶ Alternate for 2 Classrooms</li> <li>▶ No Storm Shelter</li> <li>▶ No Demolition of Old Addition</li> </ul>	
<b>Bickerdyke Elementary</b>	1,797,086	420,717		2,217,803
	<ul style="list-style-type: none"> <li>▶ New VRF Heating &amp; Air Conditioning</li> <li>▶ Repair Ceilings as Required</li> <li>▶ Remove Existing Systems</li> </ul>	<ul style="list-style-type: none"> <li>▶ Clock System</li> <li>▶ Replace Outdated Panelboards</li> <li>▶ Add Exit Signs w/Battery Backup</li> <li>▶ Additional Emergency Lighting</li> </ul>		
<b>Ruppenthal Middle School</b>	2,794,832	1,226,789		4,021,621
	<ul style="list-style-type: none"> <li>▶ New VRF Heating &amp; Air Conditioning</li> <li>▶ Repair Ceilings as Required</li> <li>▶ Remove Existing Systems</li> </ul>	<ul style="list-style-type: none"> <li>▶ Fire Alarm System</li> <li>▶ Clock System</li> <li>▶ Electric Service Revisions</li> <li>▶ Replace Outdated Panelboards</li> <li>▶ Add Exit Signs w/Battery Backup</li> <li>▶ Additional Emergency Lighting</li> </ul>		
<b>Russell High School</b>	5,772,909	1,159,809		6,932,718
	<ul style="list-style-type: none"> <li>▶ New VRF Heating &amp; Air Conditioning</li> <li>▶ Repair Ceilings as Required</li> <li>▶ Remove Existing Systems</li> </ul>	<ul style="list-style-type: none"> <li>▶ Clock System</li> <li>▶ Add Exit Signs w/Battery Backup</li> <li>▶ Additional Emergency Lighting</li> </ul>		
<b>Totals</b>	11,554,166	3,380,815	2,565,019	17,500,000

**Clarifications:** The above numbers include CM Fees, Architect & Engineer Fees, FFE, Contingency and 2020 Pricing  
Bond fees are excluded

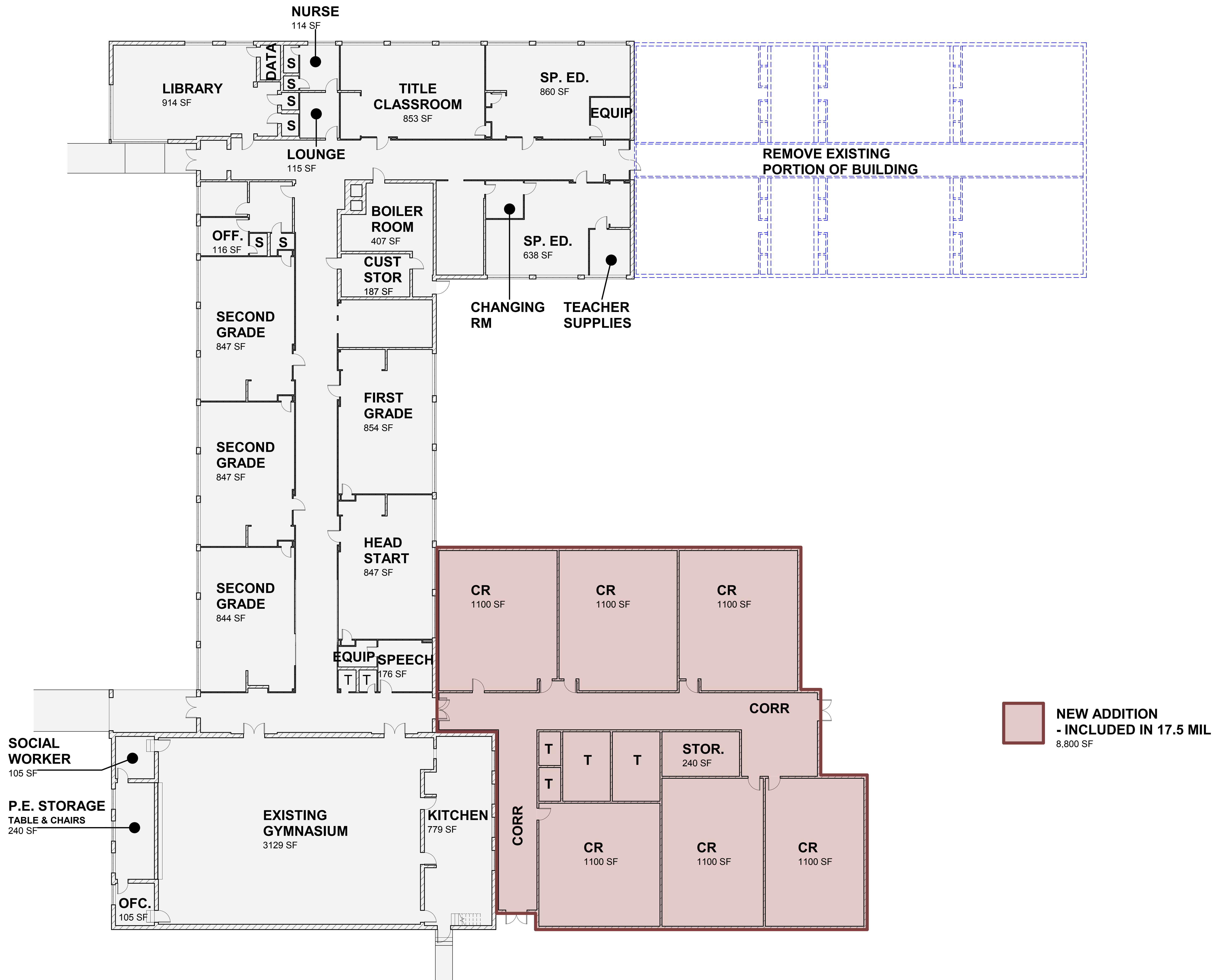



A FIRST FLOOR PLAN  
1" = 10'-0"

