

# Washington Middle School

Washington Grade School District 52

1100 N. Main Street, Washington, Illinois 61571 Phone (309) 444-3361

---

**Scott Lawson, Principal**

**Megan McMullen, Assistant Principal**

## Drop-off/Pick-up Procedures at WMS

Our number one goal during drop-off and pick-up is to have a safe passage for students. The next goal is for the process to be efficient. Please be mindful that when the weather is not cooperating there will be a major increase in vehicle traffic.

Please be aware of students walking to school; maintain a low rate of speed and keep watch for students. Students walking to and from school should use sidewalks, look for traffic before crossing streets and pay attention to the surrounding area.

### Drop-off

Students should only be dropped off in the right lane of our circle drive. The left lane will be used as a passing lane. Please be sure to pull all the way up to the cone, sign or Mr. Foehrkolb. We want as many students as possible exiting cars curbside.



Students may be dropped off starting at 7:30. Our busiest time is between 7:50 and 8:00; avoiding that time will make your drop-off less stressful.

## Pick-up

Students riding a bus will be dismissed promptly at 2:50. All students riding a bus will use the north exit and have a clear path to the bus loading zone. Students being picked up will be dismissed at 2:50 as well and use the east exit (main entrance). Students walking home will be dismissed after all buses have left the property. Students walking home will be held in the cafeteria and will exit out the west and south exits.

When picking up students at WMS, please utilize the entire right lane of our circle drive. The left lane will be used as a passing lane. Use the staff lot for overflow parking. Please leave a path for our buses to exit the property.

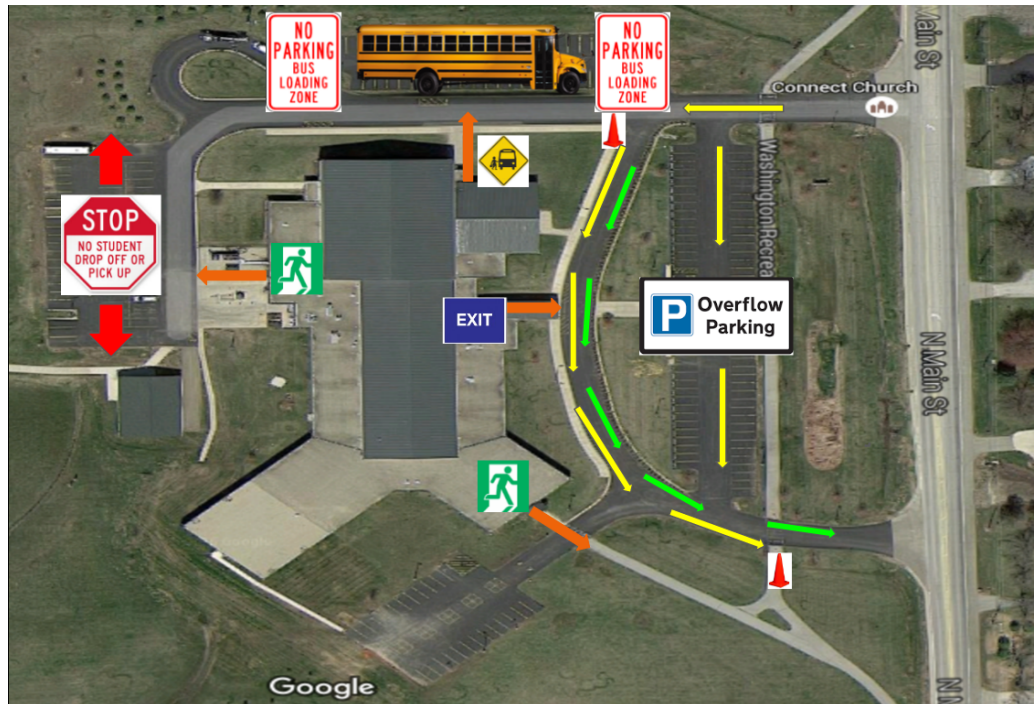

Thank you for following the drop-off and pick-up procedures at WMS. Again, our number one goal is the safety of our students. It takes everyone involved to partner with us to make this happen. If you have questions, concerns or feedback please call me at the office.

Thank you,

Scott Lawson  
Principal, WMS