



MAROA-FORSYTH TROJANS VS. TRI-VALLEY

Saturday November 19, 2022

1:00 pm

Maroa-Forsyth High School

INSTRUCTIONS TO TEAMS AND OFFICIALS.

PRE-GAME (Times are approximate)

- 11:30 pm 90 minutes will be started on the game clock- Gates Open
- 12:40 pm **Teams leave field**
- 12:40-12:41 Visitors Starting Line-up
- 12:50-12:57 Band will come onto field to perform..
 1. National Anthem
 2. Tri-Valley School Song
 3. MF School Song
- 12:57 pm After band performs pre-game and forms tunnel, home starting lineup will be introduced
- 12:58 pm Officials will re-enact coin toss and signal press box- OFFICIALS CAN DO THIS AFTER CAPTAIN MEETING IF THEY CHOOSE- TOTALLY UP TO THEM
- 1:00 pm Kickoff

HOME TEAM VARSITY - Will dress in the Boy's Team Locker Room.

VISITING TEAM - Drop off for the player's bus will be in front of the Event Entry of the High School. (See Map) A Maroa-Forsyth employee will be there to greet the team and show them to the locker room. After unloading, the bus should pull forward and park next to the front curb of the High School. Player Locker Room will be #171 and #168. (See Map of High School Gym Area) You will receive keys to your locker rooms from a Maroa-Forsyth employee. That employee will collect the keys at the conclusion of the game. Maroa-Forsyth Football team managers are available to help with moving your equipment to your sideline.

HALFTIME - 15 minutes on Clock after teams leave field

Band performs

Poms perform

When both teams are on field – 3 minutes will be put on clock and ran down

Second half will begin at the conclusion of mandatory 3 minute warm-up

Officials for Game

Will be met and escorted into PE Office #169

Please park in reserved parking area west of school- 2 spots are reserved (see map)

Gates Open

11:30 pm

Admission

\$8- GoFan <https://gofan.co/app/school/IHSA?activity=Football>

\$9- At gate

No passes

Parking

Reserved parking for season ticket holders is located to the west and behind the school. Non-reserved parking is located in the high school lot, south of the new middle school, and overflow areas as directed by parking attendants. Non-reserved parking in the lot south of the new middle school must be accessed off Lincoln St.

Footballs

Footballs or other objects that are deemed to be possible distractions to the on field competition are not allowed inside the gates. Items will be confiscated and returned at the conclusion of the game.

Endzone/Sideline Viewing

Fans are allowed to stand in the endzones outside portable fencing. Sideline viewing will be allowed in areas not marked NO STANDING but fans must remain off of the all-weather track.

Alcoholic Beverages

The possession, distribution, sale and/or consumption of alcoholic beverages are prohibited.

Tobacco is prohibited on school grounds

Concession Stand

Concession Stand is located inside the football gates.

Spirit Wear

Located near the East End of the Concession Stand

Cheer/Student Fan Bus

If you bring a student fan bus they need to be unloaded at the Event Entry Way. We ask that if you bring a student fan bus, please pre-collect your admission money so all we have to do is stamp students hands when they come into the game. **Also the cheerleading bus can unload in front of the Event Entry Way. Cheer room is located inside the high school by the restrooms outside the gym in room 109 (marked as Hospitality on attached map).**

Directions:

FROM NORTH:

Take U.S. 51 South to Maroa. Get off at Washington Street Exit. Follow Washington Street and take first right turn into school driveway.

FROM SOUTH:

Take U.S. 51 North to Maroa. Get off at Washington Street Exit. Follow Washington Street and take first right turn into school driveway.



**PUBLIC
PARKING**

ACCESS VIA WASHINGTON ST

PLAYER/CHEER/BAND DROP OFF

**R
E
S
E
R
V
E
D**

RESERVED PARKING

**NEW MIDDLE SCHOOL
CONSTRUCTION**

**PUBLIC
PARKING**

ACCESS VIA LINCOLN ST

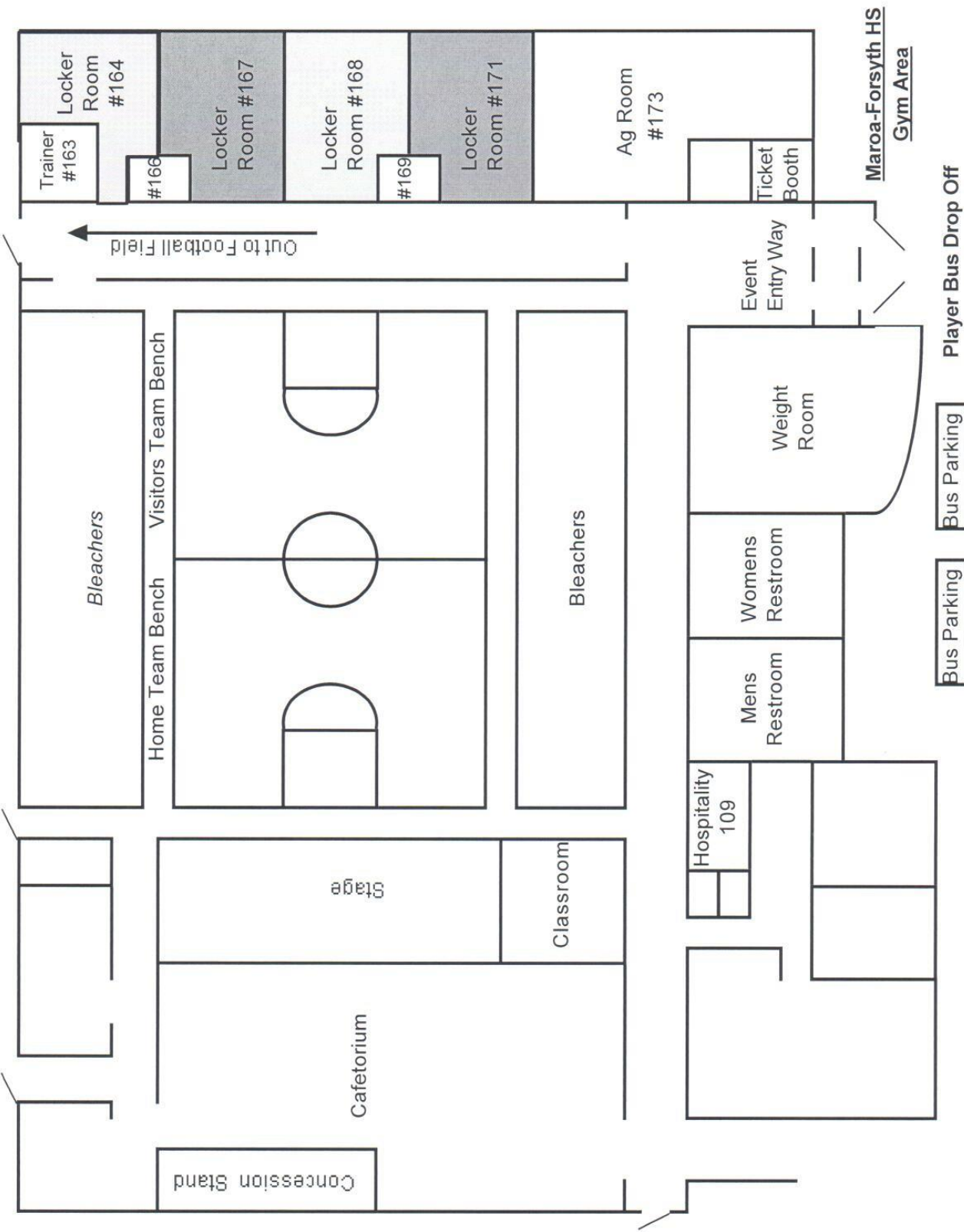

Bus Parking

Bus Parking

Player Bus Drop Off