

RADON INVESTIGATION REPORT

**BETHPAGE HIGH SCHOOL
10 CHERRY AVENUE
BETHPAGE, NEW YORK 11714**

**PREPARED FOR:
BETHPAGE UNION FREE SCHOOL DISTRICT
10 CHERRY AVENUE
BETHPAGE, NEW YORK 11714**

**JCB PROJECT #: 20-46056
APRIL 2020**

**J.C. BRODERICK & ASSOCIATES, INC.
Environmental Consulting & Testing**

**1775 Expressway Drive North
Hauppauge, New York 11788
631-584-5492 Fax: 631-584-3395**



Table of Contents

Section No. 1.0: Introduction	1
Section No. 2.0: Site Description and Location	1
Section No. 3.0: Radon Sampling and Analysis.....	1
Section No. 4.0: Radon Laboratory Analytical Summary.....	2
Section No. 5.0: Quality Assurance and Quality Control (QA/QC) Procedures.....	3
Section No. 6.0: Conclusions and Recommendations	4

List of Tables

Table No. 1 - Summary of Radon Samples Submitted for Laboratory Analysis

Table No. 2 - Summary of Radon Samples Analysis Results

List of Figures

Figure 1 – Site Location Map

Figure 2 – Administration Basement Radon Sampling Locations

Figure 3 – Bethpage High School Radon Basement Sampling Locations

Appendices

Appendix A - Figures

Appendix B - Field Photograph Logs

Appendix C - Laboratory Analytical Report

Section No. 1.0: Introduction

J.C. Broderick and Associates (JCB) was retained by the Bethpage Union Free School District (Bethpage) to perform an indoor air survey for radon gas as a result of identifying radium in the local groundwater by the Bethpage Water District and by JCB during our annual groundwater investigation at the Bethpage High School. The sampling protocol was performed essentially in accordance with the requirements of the United States Environmental Protection Agency (EPA) *Radon Measurement in Schools Revised Edition* (EPA 402-R-92-014), dated July 1993.

Section No. 2.0: Site Description and Location

The Subject Site is located at 10 Cherry Avenue Bethpage, New York 11714. The Subject Site is located on the southeast corner of the intersection formed by Stewart and Cherry Avenues. According to the United States Geological Survey (USGS) *Huntington, New York, 1992 7.5 Minute Series Topographical Map*, the Subject Site is situated at an approximate elevation of 121 feet (ft) above mean sea level. Groundwater is estimated at approximately 50 feet below surface grade (bsg). The location of the Subject Site is shown on the Site Location Map, Appendix-A Figure-1.

Section No. 3.0: Radon Sampling and Analysis

The historic detection of Radium 226 and 228 in the groundwater at the three (3) groundwater monitoring well locations prompted the sampling and analysis of Radon within the Administration and High School buildings. As a result, on April 13, 2020, JCB set up short term Radon in Air test kits in eighteen (18) rooms and spaces within the basement of the administration building and High School building that were in contact with the ground. The sampling devices were collected on April 17, 2019 after at least three days of exposure.

The following table summarizes the Radon samples submitted for laboratory analysis:

Table No. 1: Summary of Radon Samples Submitted for Laboratory Analysis					
Sample ID#	Location	Sample Start Date	Sample End Date	Description of Sample	Analysis Method
417964	Admin Basement Room 001	04/13/19	04/17/19	Admin Basement Storage Room	Radon in Air
418186	Admin Basement Room 002	04/13/19	04/17/19	Admin Basement Storage Room	Radon in Air
418086	Admin Basement Room 002	04/13/19	04/17/19	Admin Basement Storage Room - Dup	Radon in Air
418097	Admin Basement Room 004	04/13/19	04/17/19	Admin Copy Center	Radon in Air
420196	Admin Basement Room 006	04/13/19	04/17/19	Admin Basement Storage Room	Radon in Air
418105	Admin Basement Room 007	04/13/19	04/17/19	Admin Basement Storage Room	Radon in Air
418198	Admin Basement Room 007	04/13/19	04/17/19	Admin Basement Storage Room - Blank	Radon in Air
418145	Admin Basement Room 008	04/13/19	04/17/19	Admin Basement Storage Room	Radon in Air
418091	Admin Basement Room 013	04/13/19	04/17/19	Admin Basement Hallway	Radon in Air
418099	Admin Basement Room 013A/B	04/13/19	04/17/19	Admin Basement Office	Radon in Air
418273	Admin Basement Room 013A/B	04/13/19	04/17/19	Admin Basement Office - Dup	Radon in Air
418144	Admin Basement Room 013D	04/13/19	04/17/19	Admin Basement Office	Radon in Air
418118	Admin Basement Room 013D	04/13/19	04/17/19	Admin Basement Office - Blank	Radon in Air
418229	Admin Basement Room 013E	04/13/19	04/17/19	Admin Basement Office	Radon in Air

Table No. 1: Summary of Radon Samples Submitted for Laboratory Analysis					
Sample ID#	Location	Sample Start Date	Sample End Date	Description of Sample	Analysis Method
418003	Admin Basement Hallway 014	04/13/19	04/17/19	Admin Basement Hallway	Radon in Air
418090	Admin Basement Hallway 014	04/13/19	04/17/19	Admin Basement Hallway - Dup	Radon in Air
418209	HS Hallway 0006	04/13/19	04/17/19	High School Basement Hallway	Radon in Air
416396	HS Hallway 0010A	04/13/19	04/17/19	High School Basement Hallway	Radon in Air
419517	HS Hallway 0010A	04/13/19	04/17/19	High School Basement Hallway - Blank	Radon in Air
418221	HS Basement Room 0013	04/13/19	04/17/19	High School Locker Room	Radon in Air
418087	HS Basement Room 0013A	04/13/19	04/17/19	High School Gymnasium	Radon in Air
418106	HS Basement Room 0013B	04/13/19	04/17/19	High School Locker Room	Radon in Air
418137	HS Basement Room 0013B	04/13/19	04/17/19	High School Locker Room - Dup	Radon in Air
418185	HS Basement Room 0013C	04/13/19	04/17/19	High School Locker Room	Radon in Air
418084	HS Basement Room 0013D	04/13/19	04/17/19	High School Coach's Office	Radon in Air
418247	HS Basement Room 0013D	04/13/19	04/17/19	High School Coach's Office - Dup	Radon in Air
Notes: Admin = Administration HS = High School Dup = Duplicate Sample Blank = Field Blank					

Section No. 4.0: Radon Laboratory Analytical Summary

The short-term Radon in Air sampling was performed by laboratory supplied test kits, assigned individual identification numbers and secured. Chain of Custody documents were prepared, and the samples were then delivered to an independent New York State Department of Health (NYSDOH) Environmental Laboratory Approval Program (ELAP) certified laboratory for analysis of Radon in Air.

EMSL Analytical Inc. (EMSL) of Cinnaminson, New Jersey provided laboratory analytical services. Copies of EMSL's NYSDOH certifications are available upon request.

The laboratory analytical results for the Radon in Air samples were reviewed and compared to the United States Environmental Protection Agency (EPA) recommended action level of 4 pCi/L as reported in *Radon Measurement in Schools Revised Edition* (EPA 402-R-92-014), dated July 1993.

The following table summarized the Radon in Air analytical results:

Table No. 2: Summary of Radon Samples Analysis Results		
Sample Device Number	Location	Radon Activity pCi/L
417964	Admin Basement Room 001	0.2
418186	Admin Basement Room 002	0.4
418086	Admin Basement Room 002 – Dup	0.2
418097	Admin Basement Room 004	0.0
420196	Admin Basement Room 006	0.7

Table No. 2: Summary of Radon Samples Analysis Results		
Sample Device Number	Location	Radon Activity pCi/L
418105	Admin Basement Room 007	0.8
418198	Admin Basement Room 007	0.7
418145	Admin Basement Room 008	0.4
418091	Admin Basement Room 013	0.1
418099	Admin Basement Room 013A/B	0.2
418273	Admin Basement Room 013A/B – Dup	0.0
418144	Admin Basement Room 013D	0.1
418118	Admin Basement Room 013D – Blank	0.0
418229	Admin Basement Room 013E	0.1
418003	Admin Basement Hallway 014	0.2
418090	Admin Basement Hallway 014 – Dup	0.2
418209	HS Hallway 0006	0.8
416396	HS Hallway 0010A	0.4
419517	HS Hallway 0010A – Blank	-0.2
418221	HS Basement Room 0013	0.5
418087	HS Basement Room 0013A	0.2
418106	HS Basement Room 0013B	0.2
418137	HS Basement Room 0013B – Dup	0.1
418185	HS Basement Room 0013C	0.0
418084	HS Basement Room 0013D	-0.1
418247	HS Basement Room 0013D - Dup	0.1

The laboratory analysis results from the Radon in Air samples and duplicates submitted did not reveal any elevated concentrations of Radon exceeding 4.0 pCi/L, the referenced guidance value established by the EPA.

Section No. 5.0: Quality Assurance and Quality Control (QA/QC) Procedures

To ensure that measurement results are reliable, JCB performed unexposed control detectors (blanks) side-by-side with the sampling device at each sampling location.

The field sampling team-maintained Radon sampling chain of custody records used to track samples from sampling point to analysis which summarized the following:

- Sample identification;
- Test Kit ID number;
- Device ID number;
- Sampling beginning date and time;
- Sampling ending date and time;
- Temperature, °F;
- Humidity, %;

Section No. 6.0: Conclusions and Recommendations

Based upon the sampling results reported, the USEPA decision matrix does not recommend any mitigation for Radon.

Due to the detection of Radium 226 and 228 in the groundwater adjacent to the Administration and High School buildings, JCB does recommend that continued monitoring for Radon in Air within the school buildings be performed to confirm the effectiveness of the isolation barrier.

Sincerely,
J.C. Broderick & Associates, Inc.

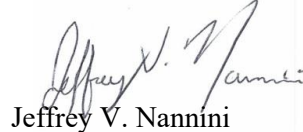

Jeffrey V. Nannini
Environmental Scientist

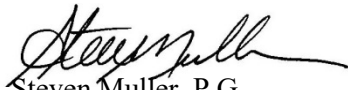

Steven Muller, P.G.
Project Manager

Appendix A

Figures



J.C. BRODERICK

& Associates

Environmental Consulting and
Testing

1775 Express Drive North

Hauppauge, NY 11788

Phone: (631).584.5492

Fax: (631).584.3395

Notes:

Bethpage High School
10 Cherry Avenue
Bethpage, NY 11714

Drawing Title

Figure No. 1

Site Location Map

Scale As Noted Project No. 20-46056 Date 04-17-2020

Drawn By J.V.N. Checked By S.W.M. Page No. 1 of 3

Drawing No.

1

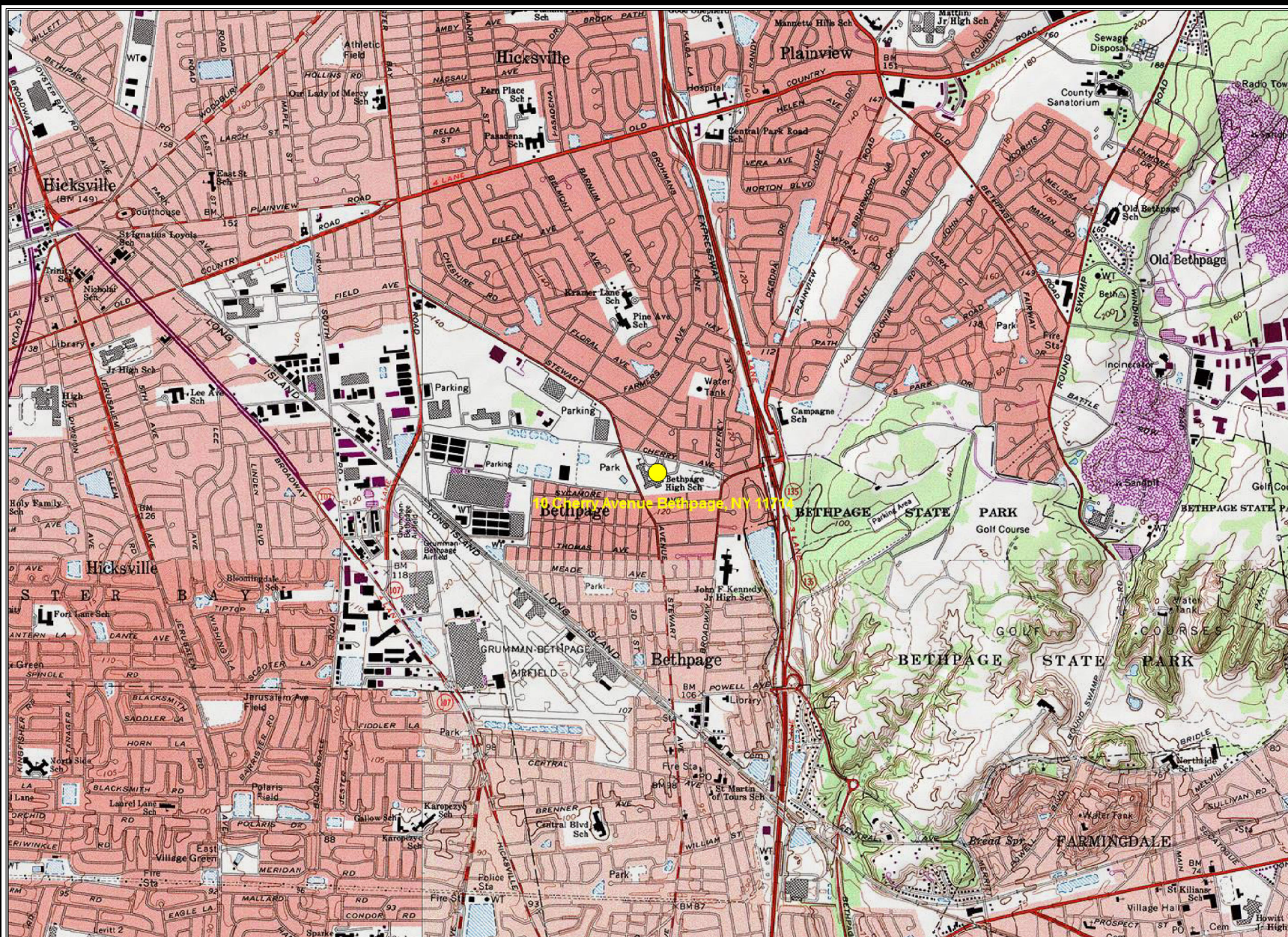

Map created with TOPO!® ©2003 National Geographic (www.nationalgeographic.com/topo)

JCB LEGEND

● SUBJECT SITE

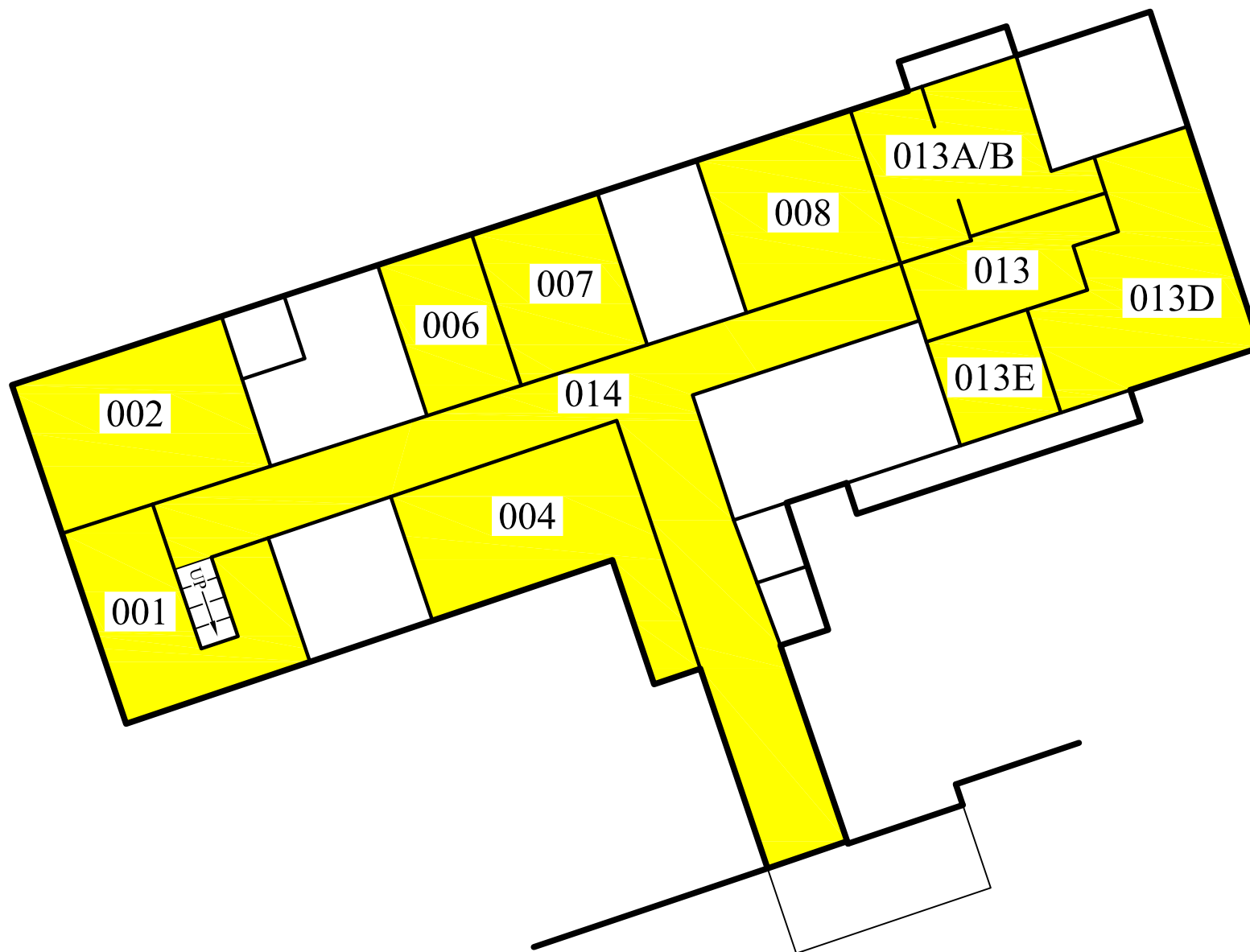

PROJECT
NORTH

JCB LEGEND
■ RADON SAMPLE LOCATION



J.C. BRODERICK

& Associates
Environmental Consulting and
Testing
1775 Express Drive North
Hauppauge, New York 11788
Phone: (631).584.5492
Fax: (631).584.3395

Notes:

Bethpage UFSD
Administration Building
10 Cherry Avenue
Bethpage, NY 11714

Drawing Title

Figure No. 2
Administration
Building
Radon
Sampling
Locations

Scale	Project No.	Date
N.T.S.	20-46056	04-17-2020

Drawn By	Checked By	Page No.
J.V.N.	S.W.M.	2 of 3

Drawing No.

2



J.C. BRODERICK

& Associates
Environmental Consulting and
Testing
1775 Express Drive North
Hauppauge, New York 11788
Phone: (631).584.5492
Fax: (631).584.3395

Notes:

Bethpage High School
10 Cherry Avenue
Bethpage, NY 11714

Drawing Title

Figure No. 3

Bethpage
High School
Basement
Radon
Sampling
Locations

Scale	Project No.	Date
N.T.S.	20-46056	04-17-2020

Drawn By	Checked By	Page No.
J.V.N.	S.W.M.	3 of 3

Drawing No.

3

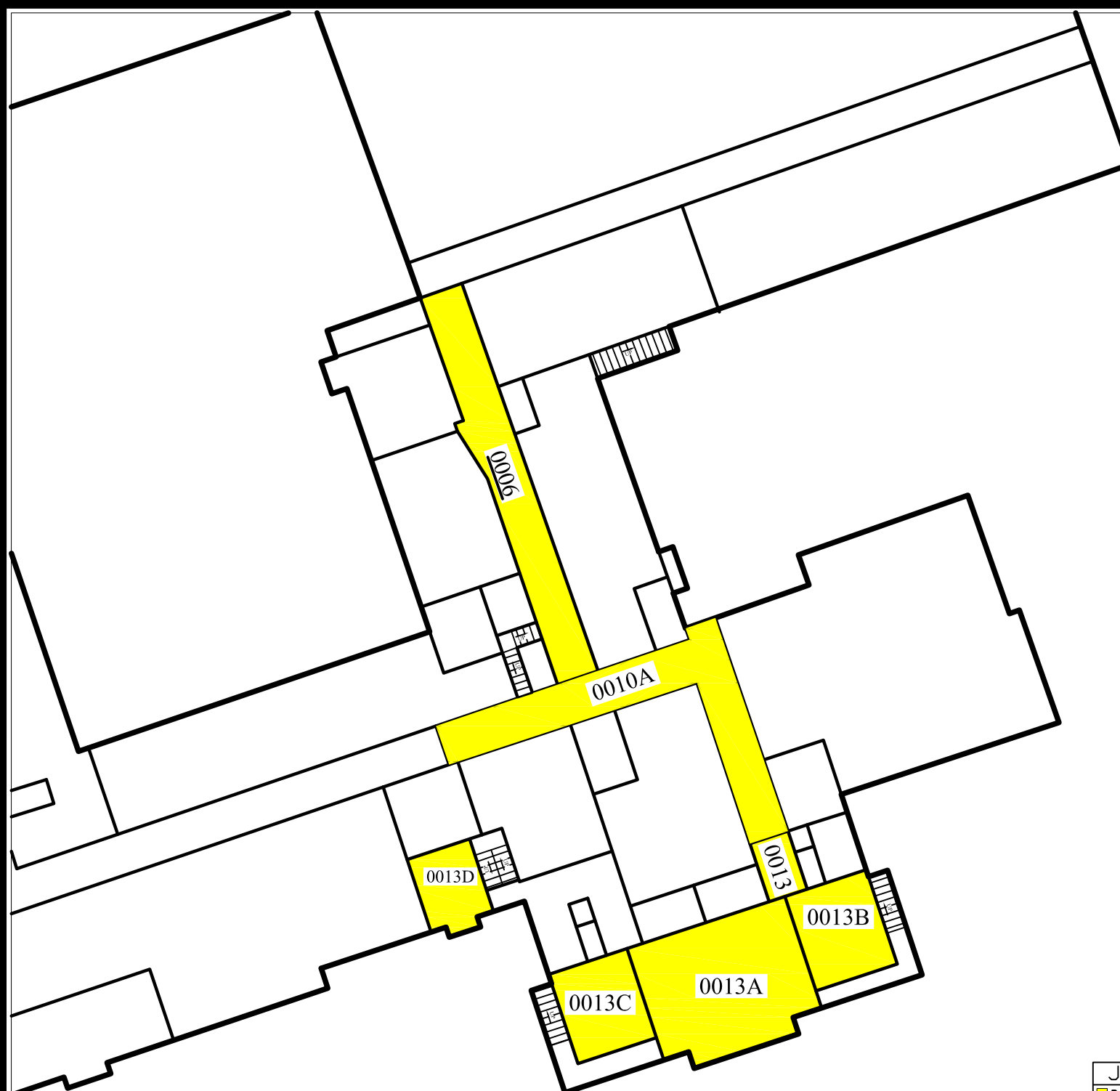

JCB LEGEND
■ RADON SAMPLE LOCATION

Appendix B

Field Photograph Logs

**Radon Sampling Location
High School Basement Hallway**



Field Photograph Log

Radon Investigation Report

**Bethpage High School
10 Cherry Avenue
Bethpage, New York 11714**

Photo No. 01

JCB#: 20-46056

**Radon Sampling Location
High School Basement Locker Room**



Field Photograph Log

Radon Investigation Report

**Bethpage High School
10 Cherry Avenue
Bethpage, New York 11714**

Photo No. 02

JCB#: 20-46056

**Radon Sampling Location
High School Basement Office**



Field Photograph Log

Radon Investigation Report

**Bethpage High School
10 Cherry Avenue
Bethpage, New York 11714**

Photo No. 03

JCB#: 20-46056

Radon Sampling Location Administration Building Storage Room



Field Photograph Log

Radon Investigation Report

Bethpage High School
10 Cherry Avenue
Bethpage, New York 11714

Photo No. 04

JCB#: 20-46056

**Radon Sampling Location
Administration Building Hallway**



Field Photograph Log

Radon Investigation Report

**Bethpage High School
10 Cherry Avenue
Bethpage, New York 11714**

Photo No. 05

JCB#: 20-46056

**Radon Sampling Location
Administration Building Office**



Field Photograph Log

Radon Investigation Report

**Bethpage High School
10 Cherry Avenue
Bethpage, New York 11714**

Photo No. 06

JCB#: 20-46056

Appendix C

Laboratory Analysis Reports

**EMSL Analytical, Inc.**

200 Route 130 North, Cinnaminson, NJ 08077

Phone/Fax: (800) 220-3675 / (856) 786-0327

<http://www.EMSL.com>cinnaminsonradonlab@emsl.com

EMSL Order: 382003571

CustomerID: JCBR50

CustomerPO:

ProjectID:

Attn: **Steven Muller**
J.C. Broderick & Associates
1775 Expressway Drive North, Suite 1
Hauppauge, NY 11788

Phone: (631) 584-5492
 Fax:
 Received: 04/20/20 10:41 AM
 Analysis Date: 4/21/2020
 Collected: 4/13/2020

Project: **Bethpage HS / 20-46056 / 10 Cherry Avenue**

Test **Bethpage HC / 20-46056**
 Site: **10 Cherry Avenue**
Bethpage, NY 11714

Test Report: Radon in Air Test Results

Liquid Scintillation ID	Location	Radon Activity (pCi/L)	Start	Stop	Temperature F	Humidity %	Sample Type
418209 382003571-0001	HS Hallway / Room 0006	0.8	4/13/2020 9:01:00 AM	4/17/2020 7:57:00 AM	70	23	Customer
Sample Notes:							
416396 382003571-0002	HS Hallway / Room 0010A	0.4	4/13/2020 9:03:00 AM	4/17/2020 7:58:00 AM	70	22	Customer
Sample Notes:							
419517 382003571-0003	HS Hallway / Room 0010A	-0.2	4/13/2020 9:03:00 AM	4/17/2020 7:58:00 AM	70	22	Blank
Sample Notes:							
418221 382003571-0004	HS / Basement / Room 0013	0.5	4/13/2020 9:05:00 AM	4/17/2020 7:59:00 AM	70	22	Customer
Sample Notes:							
418087 382003571-0005	HS / Basement / Room 0013A	0.2	4/13/2020 9:06:00 AM	4/17/2020 8:01:00 AM	69	20	Customer
Sample Notes:							
418106 382003571-0006	HS / Basement / Room 0013B	0.2	4/13/2020 9:08:00 AM	4/17/2020 8:00:00 AM	70	22	Customer
Sample Notes:							
418137 382003571-0007	HS / Basement / Room 0013B	0.1	4/13/2020 9:08:00 AM	4/17/2020 8:00:00 AM	70	22	Duplicate
Sample Notes: Duplicate's Customer Sample:382003571-0006					Duplicate RPD = 66.7%		
418185 382003571-0008	HS / Basement / Room 0013C	0	4/13/2020 9:10:00 AM	4/17/2020 8:02:00 AM	68	17	Customer
Sample Notes:							
418084 382003571-0009	HS / Basement / Room 0013D	-0.1	4/13/2020 9:11:00 AM	4/17/2020 8:03:00 AM	66	15	Customer
Sample Notes:							
418247 382003571-0010	HS / Basement / Room 0013D	0.1	4/13/2020 9:11:00 AM	4/17/2020 8:03:00 AM	66	15	Duplicate
Sample Notes: Duplicate's Customer Sample:382003571-0009 Duplicate RPD >67%					Duplicate RPD = 200.0%		

Please visit www.radontestinglab.com

**EMSL Analytical, Inc.**

200 Route 130 North, Cinnaminson, NJ 08077

Phone/Fax: (800) 220-3675 / (856) 786-0327

<http://www.EMSL.com>cinnaminsonradonlab@emsl.com

EMSL Order: 382003571

CustomerID: JCBR50

CustomerPO:

ProjectID:

Test Report: Radon in Air Test Results

Liquid Scintillation ID	Location	Radon Activity (pCi/L)	Start	Stop	Temperature F	Humidity %	Sample Type
417964 382003571-0011	Admin Basement / Room 001	0.2	4/13/2020 9:23:00 AM	4/17/2020 7:39:00 AM	70	28	Customer
Sample Notes:							
418186 382003571-0012	Admin Basement / Room 002	0.4	4/13/2020 9:25:00 AM	4/17/2020 7:40:00 AM	71	25	Customer
Sample Notes:							
418086 382003571-0013	Admin Basement / Room 002	0.2	4/13/2020 9:25:00 AM	4/17/2020 7:40:00 AM	71	25	Duplicate
Sample Notes: Duplicate's Customer Sample:Not specified							
418097 382003571-0014	Admin Basement / Room 004	0	4/13/2020 9:26:00 AM	4/17/2020 7:41:00 AM	72	25	Customer
Sample Notes:							
420196 382003571-0015	Admin Basement / Room 006	0.7	4/13/2020 9:28:00 AM	4/17/2020 7:42:00 AM	73	30	Customer
Sample Notes:							
418105 382003571-0016	Admin Basement / Room 007	0.8	4/13/2020 9:29:00 AM	4/17/2020 7:50:00 AM	74	25	Customer
Sample Notes:							
418198 382003571-0017	Admin Basement / Room 007	0.7	4/13/2020 9:29:00 AM	4/17/2020 7:50:00 AM	74	25	Blank
Sample Notes:							
418145 382003571-0018	Admin Basement / Room 008	0.4	4/13/2020 9:30:00 AM	4/17/2020 7:52:00 AM	74	25	Customer
Sample Notes:							
418091 382003571-0019	Admin Basement / Room 013	0.1	4/13/2020 9:35:00 AM	4/17/2020 7:14:00 AM	74	23	Customer
Sample Notes:							
418099 382003571-0020	Admin Basement / Room 013 A/B	0.2	4/13/2020 9:36:00 AM	4/17/2020 7:43:00 AM	74	23	Customer
Sample Notes:							
418273 382003571-0021	Admin Basement / Room 013 A/B	0	4/13/2020 9:36:00 AM	4/17/2020 7:43:00 AM	74	23	Duplicate
Sample Notes: Duplicate's Customer Sample:382003571-0020 Duplicate RPD >67%							
418144 382003571-0022	Admin Basement / Room 013D	0.1	4/13/2020 9:37:00 AM	4/17/2020 7:45:00 AM	74	23	Customer
Sample Notes:							
418118 382003571-0023	Admin Basement / Room 013D	0	4/13/2020 9:37:00 AM	4/17/2020 7:45:00 AM	74	23	Blank
Sample Notes:							

Please visit www.radontestinglab.com

**EMSL Analytical, Inc.**

200 Route 130 North, Cinnaminson, NJ 08077

Phone/Fax: (800) 220-3675 / (856) 786-0327

<http://www.EMSL.com>cinnaminsonradonlab@emsl.com

EMSL Order: 382003571

CustomerID: JCBR50

CustomerPO:

ProjectID:

Test Report: Radon in Air Test Results

Liquid Scintillation ID	Location	Radon Activity (pCi/L)	Start	Stop	Temperature F	Humidity %	Sample Type
418229 382003571-0024	Admin Basement / Room 013E	0.1	4/13/2020 9:38:00 AM	4/17/2020 7:44:00 AM	74	23	Customer
Sample Notes:							
418003 382003571-0025	Admin Hallway / Room 014	0.2	4/13/2020 9:40:00 AM	4/17/2020 7:46:00 AM	75	26	Customer
Sample Notes:							
418090 382003571-0026	Admin Hallway / Room 014	0.2	4/13/2020 9:40:00 AM	4/17/2020 7:46:00 AM	75	26	Duplicate
					Duplicate RPD = 0.0%		
Sample Notes: Duplicate's Customer Sample:382003571-0025							

Report Notes

The United States Environmental Protection Agency (EPA) has established a radon action level of 4.0pCi/L. EPA recommends mitigation of a structure if the confirmed radon level is equal to or greater than 4.0pCi/L.

The radon tests were performed using liquid scintillation radon detectors and counted on a liquid scintillation counter following EPA Method # 402-R-92-004 testing protocol for Radon in Air testing. EPA recommends retesting every two years.

Please contact EMSL Analytical, Inc. or your State Health Department for further information.

All procedures used for generating this report are in complete accordance with the current EPA protocols for the analysis of Radon in Air.

Analyst(s) _____

Dominic Gehret, Radiochemistry Laboratory Manager, 10872

In no event shall EMSL be liable for indirect, special, consequential, or incidental damages, including, but not limited to, damages for loss of profit or goodwill regardless of the negligence (either sole or concurrent) of EMSL and whether EMSL has been informed of the possibility of such damages, arising out of or in connection with EMSL's services thereunder or the delivery, use, reliance upon or interpretation of test results by client or any third party. We accept no legal responsibility for the purposes for which the client uses the test results. In no event shall EMSL be liable to a client or any third party, whether based upon theories of tort, contract or any other legal or equitable theory, in excess of the amount paid to EMSL by client thereunder. The test results meets all NELAC requirements unless otherwise specified.

Samples analyzed by EMSL Analytical, Inc. Cinnaminson, NJ FL RB2034/R2687,IL RNL2008202,IN RTL00935,IA RNLAB10005,KS KS-LB-0005/KS-MS-0482,ME SPC202,MN RL-0005,NE 474/RMB-1083,NJ 03036/MEB92525/MES13910,NY 10872,OH RL39,OK D9952,PA 2573/3393/68-00367,RI RMB-108/RI00179,WV RL000220,NRSB-ARL6006,NRPP

Initial report from 04/21/2020 10:52:10

JCBKSO

Fedex 7957 8058 9130

M3 20



EMSL ANALYTICAL, INC.

CHAIN OF CUSTODY RADON LABORATORY SERVICES (COMMERCIAL USE)

2020 APR 20 10:41
EMSL Job #: 382003571

EMSL ANALYTICAL, INC.
200 ROUTE 130 NORTH
CINNAMINSON, NJ 08077
PHONE: 800-220-3675
www.emsl.com

Company Information:

EMSL
Acct #: JCBKSO

Company Name: JCBRODERICK & ASSOC.

Contact: S. MULLER

Address: 1775 EXPRESSWAY DR. N

City: HAUPPAUGE

State: NY Zip: 11788

Phone: 631-584-5492 Fax: 631-584-3395

Email: Smullen@JCBroderick.com

Technician Certification #:

Tech Name: STEVEN MULLER

Tech Signature:

Project/Site Information:

*Required

Project Name: BETHPAGE HS

Project # / PO: 20-46050

*Address: 10 CHERRY AVE

*City: BETHPAGE *State: NY *Zip: 11714

*Building type? ☐ Residential ☐ Non-Residential☒ School ☐ Other:*Building foundation type? ☒ Basement ☐ Crawlspace☐ Slab on Grade ☐ Other

Special Notes / Instructions:

*Turnaround Time (TAT) Options

☐ 1 Day☐ 2 Day☐ 3 Day☒ 4 Day

Disclaimer: In no event shall EMSL be liable for indirect, special, consequential, or incidental damages for loss of profit or goodwill regardless of the negligence (either sole or concurrent) of EMSL and whether EMSL has been informed of the possibility of such damages arising out of or in connection with EMSL's services there under or the delivery, use, or reliance upon or interpretation of test results by client or third party. We accept no legal responsibility for the purposes for which the client uses the test results. In no event shall EMSL be liable to a client or any third party, whether based upon theories of tort, contract or any other legal or equitable theory, in excess of the amount paid to EMSL by client thereafter.

(S) Sample (B) Blank (D) Duplicate	Device Number	Location	Room #	Exposure Period Beginning Date		Exposure Period Ending Date		Temp, °F	Humidity, %
				Date	Time	Date	Time		
(S) Sample	418209	HS BASEMENT HALLWAY	0006	4/13/20	9:01 AM	4/17/20	7:57	70	23
S	416396	HS							
B	419517	HALLWAY	0010A	4/13/20	9:03	4/17/20	7:58	70	22
S	418221	HS BASEMENT	0013	4/13/20	9:05	4/17/20	7:59	70	22
S	418087	HS BASEMENT	0013A	4/13/20	9:06	4/17/20	8:01	69	20
S	418106	HS							
D	418137	BASEMENT	0013B	4/13/20	9:08	4/17/20	8:00	70	22
S	418185	HS BASEMENT	0013C	4/13/20	9:10	4/17/20	8:02	68	17
S	418084	HS							
D	418247	BASEMENT	0013D	4/13/20	9:11	4/17/20	8:03	66	15

Relinquished by (Sign):

Date: 4/17/20 Time: 10:00

Page of

Received by EMSL (Sign):

Date:

Time:

EMSL Job #: 38200354

EMSL ANALYTICAL, INC.

Relinquished by (Sign) _____

Date: 4/7/20 Time: 10:00

Page of

Received by EMSL (Sign): _____

Date:

Time: