



BUNCOMBE COUNTY SCHOOLS

VALLEY SPRINGS MIDDLE SCHOOL

ROOF REPLACEMENT PROJECT

224 LONG SHOALS ROAD
ARDEN, NORTH CAROLINA

VICINITY MAP

INDEX OF DRAWINGS

SHEET NO:	SHEET NAME:
G-101	COVER SHEET
A-101	ROOF PLAN: AREA O & J
A-102	ROOF PLAN: AREA H
A-501	ROOF DETAILS
A-502	ROOF DETAILS
A-503	ROOF DETAILS
A-504	ROOF DETAILS

LOCATION MAP



Terracon

Consulting Engineers and Scientists

2020 STARITA ROAD SUITE-E

CHARLOTTE, NORTH CAROLINA

p: 704.594.8940 f: 704.509.1888

terracon.com

PROJECT NAME AND ADDRESS:

BUNCOMBE COUNTY SCHOOLS

VALLEY SPRINGS MIDDLE SCHOOL

ROOF REPLACEMENT PROJECT

224 LONG SHOALS ROAD

ARDEN, NORTH CAROLINA

ISSUE DATE:

APRIL 27, 2016

ISSUE FOR:

☐ DESIGN DEVELOPMENT SUBMITTAL:
NOT FOR CONSTRUCTION

☐ SURVEY REPORT SUBMITTAL:
NOT FOR CONSTRUCTION

☐ CONSTRUCTION DOCUMENT SUBMITTAL:
NOT FOR CONSTRUCTION

☒ BID DOCUMENTS
NOT FOR CONSTRUCTION

☐ CONSTRUCTION DOCUMENT SUBMITTAL

☐ ADDENDUM SUBMITTAL

☐ RECORD DRAWINGS

PROJECT TEAM:

DESIGNED BY:

JJC/JHP

DRAWN BY:

EGM II

APPROVED BY:

LTH

PROJECT NUMBER:

FH166112

ADDENDUM:

NO. 1:	DATE:	DESCRIPTION:
1	05.6.16	ADDENDUM No.1

ENGINEER STATE LICENSE SEAL

NORTH CAROLINA

PROFESSIONAL

SEAL

021987

ENGINEER

QUINTANA

TITLE SHEET:

COVER SHEET

SHEET NUMBER:

G-101

KEYPLAN:

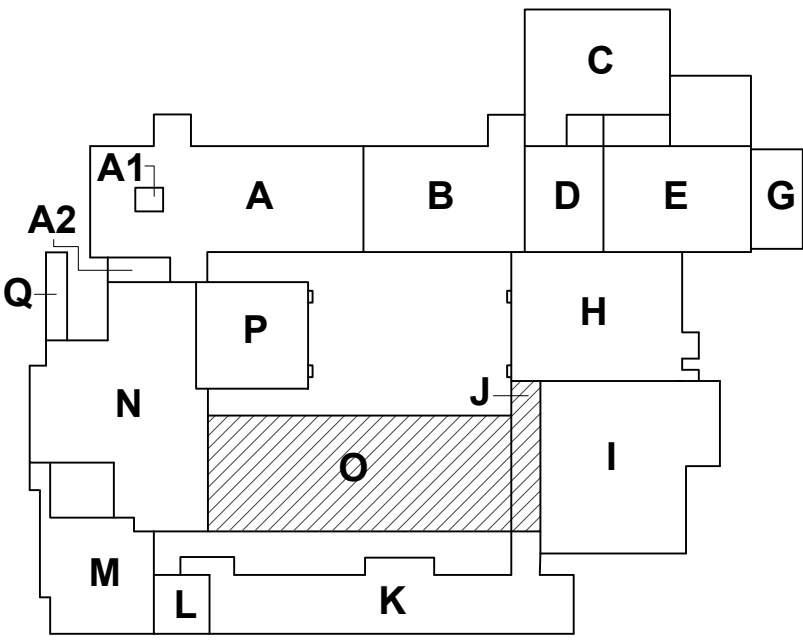

BUILDING CODE:

NORTH CAROLINA BUILDING CODE (2012 EDITION)
AND ASCE 7-05

BASIC WIND SPEED = 100 MPH
BUILDING CATEGORY = III
EXPOSURE CATEGORY = B
INTERNAL PRESSURE COEF. = +/- .18

THE NEW ROOF SYSTEM SHALL BE DESIGNED
AND CONSTRUCTED TO MEET THE FOLLOWING
WIND UPLIFT PRESSURES:

1. INTERIOR ZONE = -25.01 PSF
2. EDGE ZONE = -41.97 PSF
3. CORNER ZONE = -63.16 PSF

LEGEND

- RD ○ ROOF DRAIN
⊗ MECHANICAL UNIT
● ○ VENT PIPE/PENETRATION
→ DECK SLOPE
--- TAPERED INSULATION
--- TAPERED INSULATION SLOPE
○ DETAIL NO.
--- GENERAL NOTES FLAG
--- EXPANSION JOINT

Terracon
Consulting Engineers and Scientists

2020 STARITA ROAD SUITE-E
CHARLOTTE, NORTH CAROLINA
P: 704.594.8940 F: 704.509.1888
terracon.com

PROJECT NAME AND ADDRESS:

BUNCOMBE COUNTY SCHOOLS
**VALLEY SPRINGS MIDDLE SCHOOL
ROOF REPLACEMENT PROJECT**

224 LONG SHOALS ROAD
ARDEN, NORTH CAROLINA

ISSUE DATE:

APRIL 27, 2016

ISSUE FOR:

- ☐ DESIGN DEVELOPMENT SUBMITTAL:
NOT FOR CONSTRUCTION
☐ SURVEY REPORT SUBMITTAL:
NOT FOR CONSTRUCTION
☐ CONSTRUCTION DOCUMENT SUBMITTAL:
NOT FOR CONSTRUCTION
☒ BID DOCUMENTS
NOT FOR CONSTRUCTION
☐ CONSTRUCTION DOCUMENT SUBMITTAL
☐ ADDENDUM SUBMITTAL
☐ RECORD DRAWINGS

PROJECT TEAM:

DESIGNED BY:

JJC/JHP

DRAWN BY:

EGM II

APPROVED BY:

LTH

PROJECT NUMBER:

FH166112

ADDENDUM:

NO. 1: DATE: DESCRIPTION:

1	05.6.16	ADDENDUM No.1

ENGINEER STATE LICENSE SEAL



TITLE SHEET:

ROOF PLAN: AREA O & J

SHEET NUMBER:

A-101

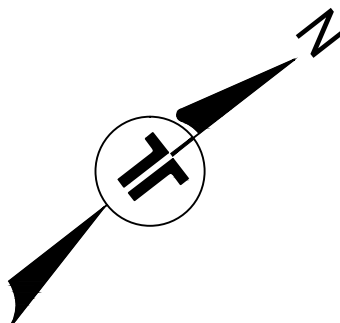
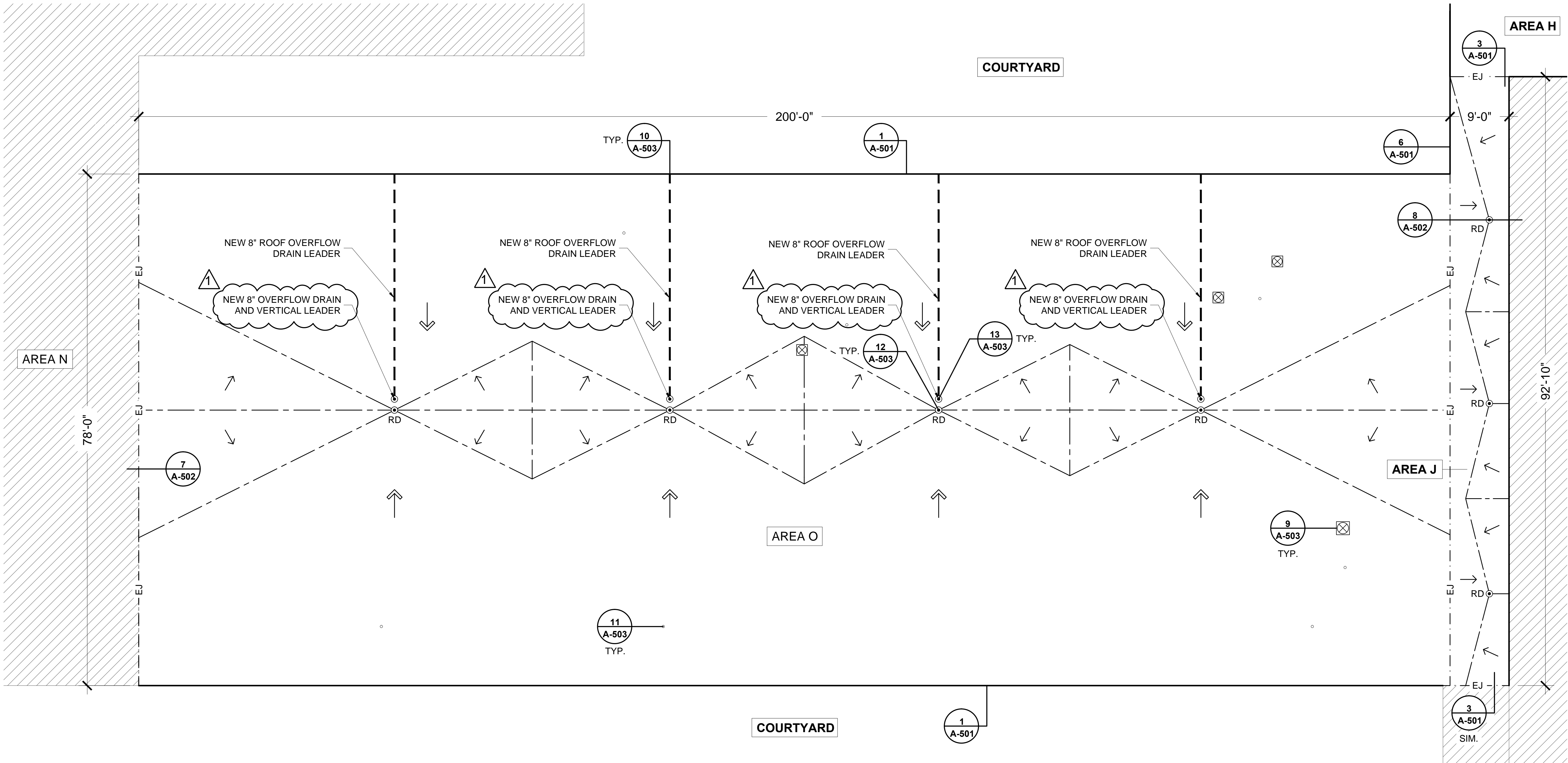

1 ROOF PLAN: VALLEY SPRINGS AREA O & J
1/8" = 1'-0"
0 4' 8' 16'

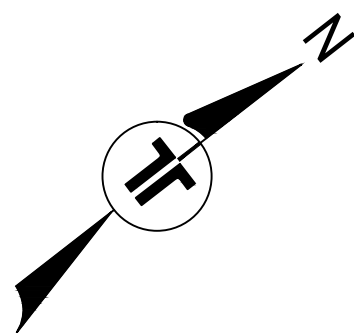
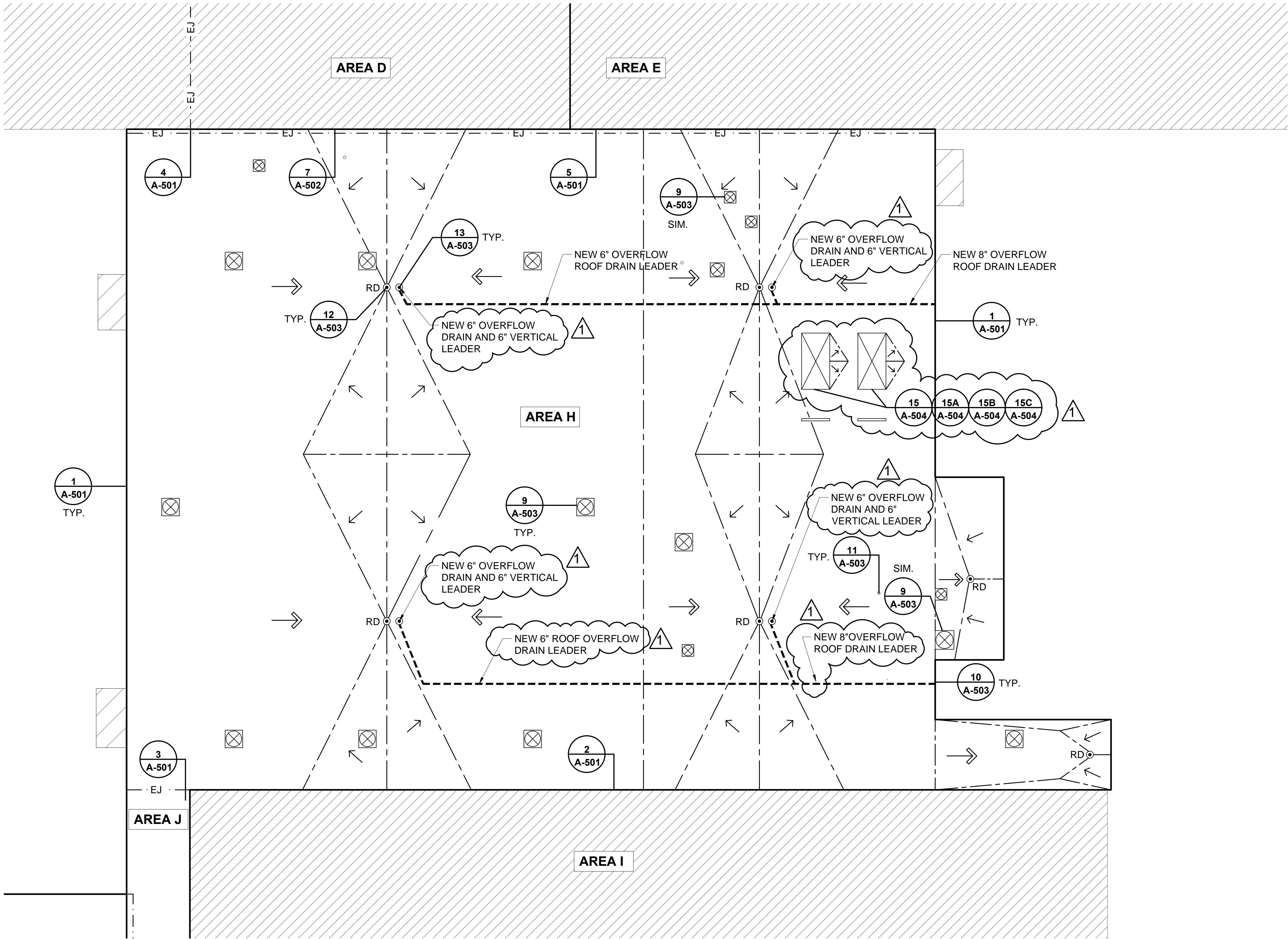

1

ROOF PLAN: VALLEY SPRINGS AREA H

1/8" = 1'-0"
0 4' 8' 16'

LEGEND

- RD ROOF DRAIN AND NEW SUMP
- MECHANICAL UNIT
- VENT PIPE/PENETRATION
- DECK SLOPE
- TAPERED INSULATION
- TAPERED INSULATION SLOPE
- DETAIL NO.
- GENERAL NOTES FLAG
- EXPANSION JOINT

BUILDING CODE:

NORTH CAROLINA CODE (2012 EDITION)
AND ASCE 7-05

BASIC WIND SPEED = 100 MPH
BUILDING CATEGORY = III
EXPOSURE CATEGORY = B
INTERNAL PRESSURE COEF. = +/- .18

THE NEW ROOF SYSTEM SHALL BE DESIGNED
AND CONSTRUCTED TO MEET THE FOLLOWING
WIND UPLIFT PRESSURES:

1. INTERIOR ZONE = -25.01 PSF
2. EDGE ZONE = -41.97 PSF
3. CORNER ZONE = -63.16 PSF

KEYPLAN:

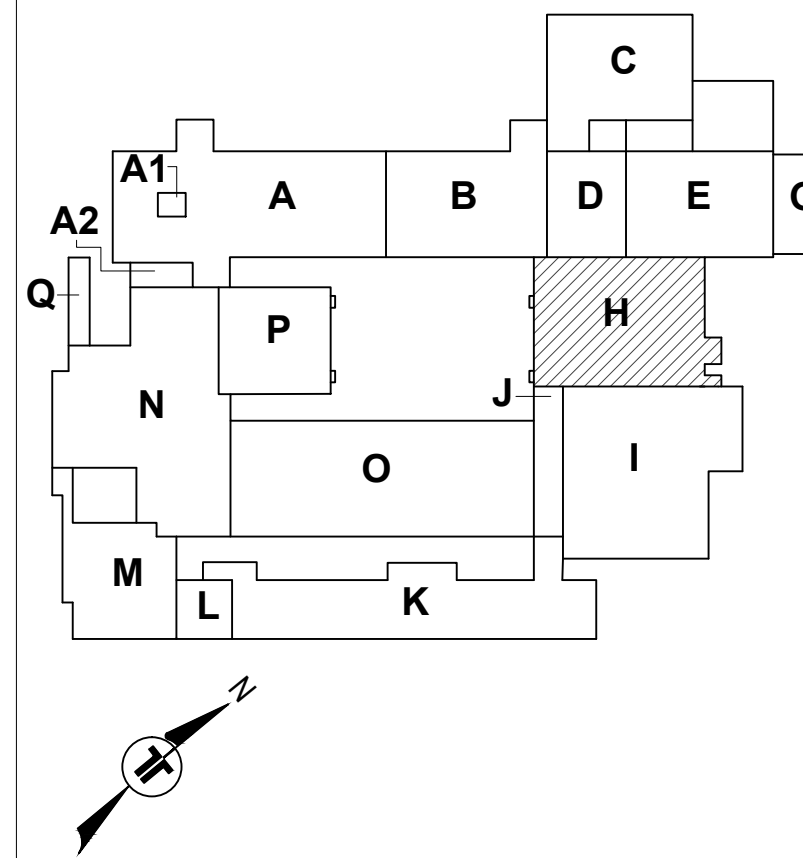

Terracon
Consulting Engineers and Scientists

2020 STARITA ROAD SUITE-E
CHARLOTTE, NORTH CAROLINA
P: 704.594.8940 F: 704.509.1888
terracon.com

PROJECT NAME AND ADDRESS:

BUNCOMBE COUNTY SCHOOLS
**VALLEY SPRINGS MIDDLE SCHOOL
ROOF REPLACEMENT PROJECT**
224 LONG SHOALS ROAD
ARDEN, NORTH CAROLINA

ISSUE DATE:

APRIL 27, 2016

ISSUE FOR:

- ☐ DESIGN DEVELOPMENT SUBMITTAL:
NOT FOR CONSTRUCTION
- ☐ SURVEY REPORT SUBMITTAL:
NOT FOR CONSTRUCTION
- ☐ CONSTRUCTION DOCUMENT SUBMITTAL:
NOT FOR CONSTRUCTION
- ☒ **BID DOCUMENTS**
NOT FOR CONSTRUCTION
- ☐ CONSTRUCTION DOCUMENT SUBMITTAL
- ☐ ADDENDUM SUBMITTAL
- ☐ RECORD DRAWINGS

PROJECT TEAM:

DESIGNED BY:

JJC/JHP

DRAWN BY:

EGM II

APPROVED BY:

LTH

PROJECT NUMBER:

FH166112

ADDENDUM:

NO. 1: DATE: DESCRIPTION:

	05.6.16	ADDENDUM No.1

ENGINEER STATE LICENSE SEAL



TITLE SHEET:

ROOF PLAN: AREA H

SHEET NUMBER:

A-102

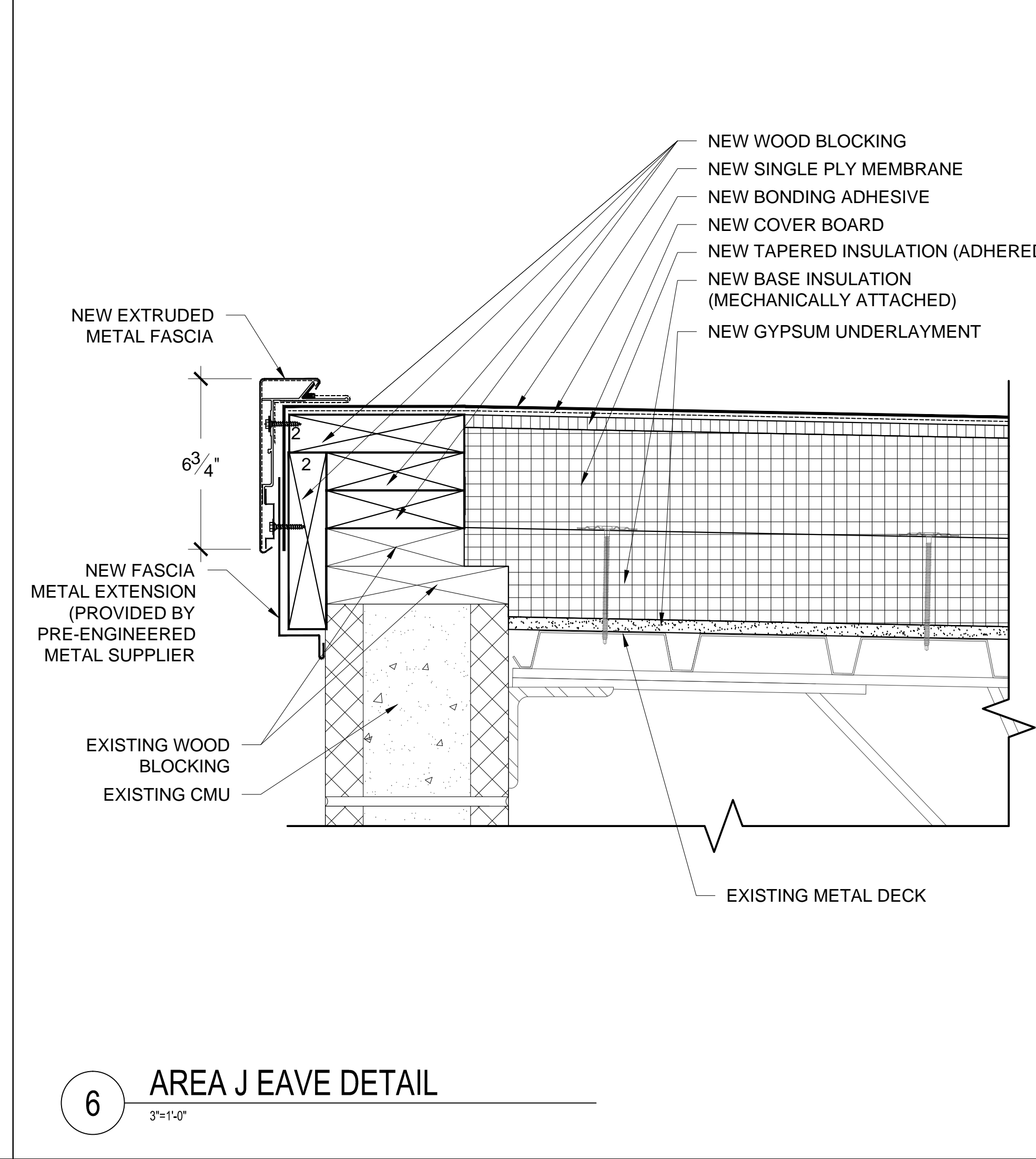
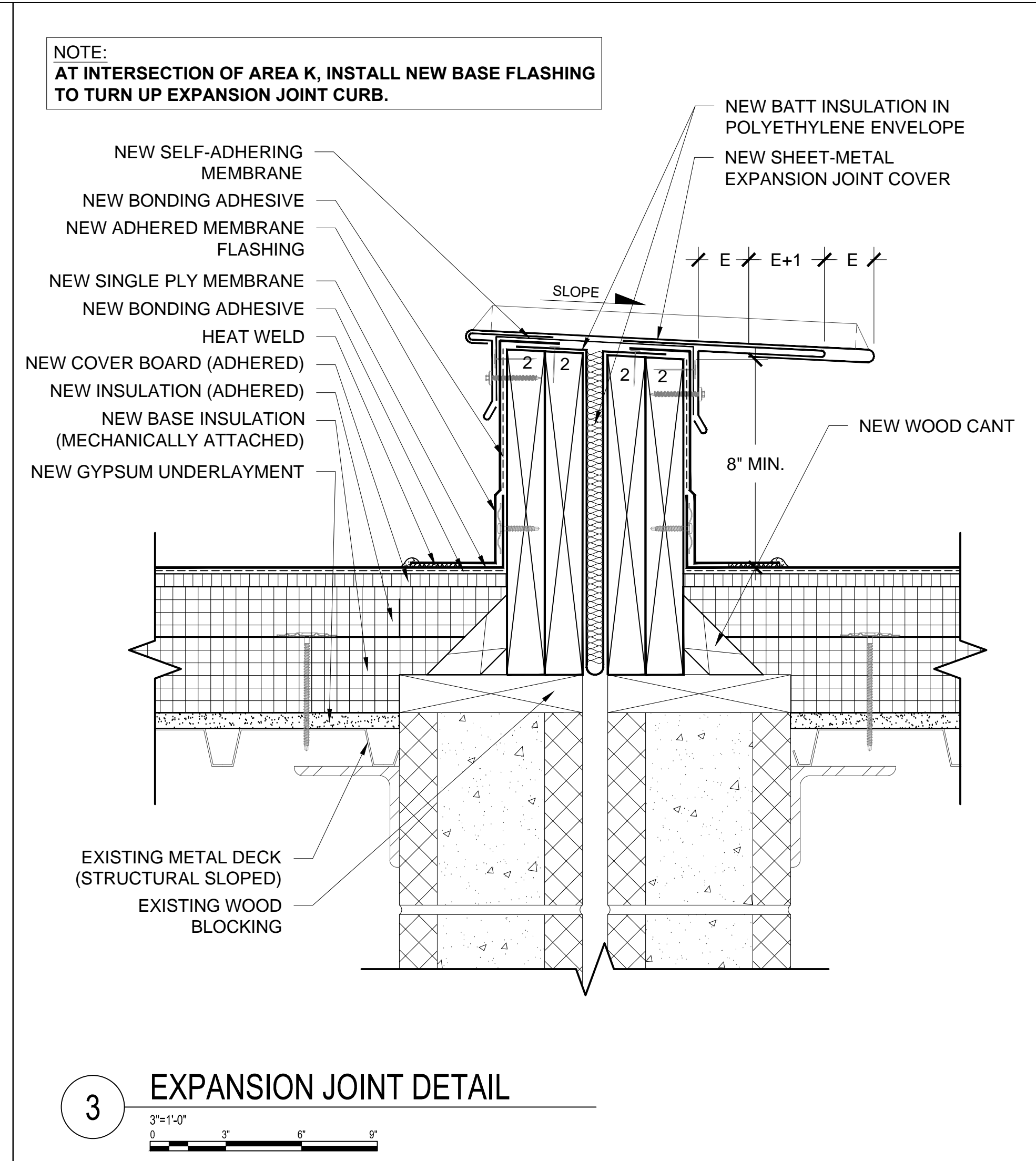
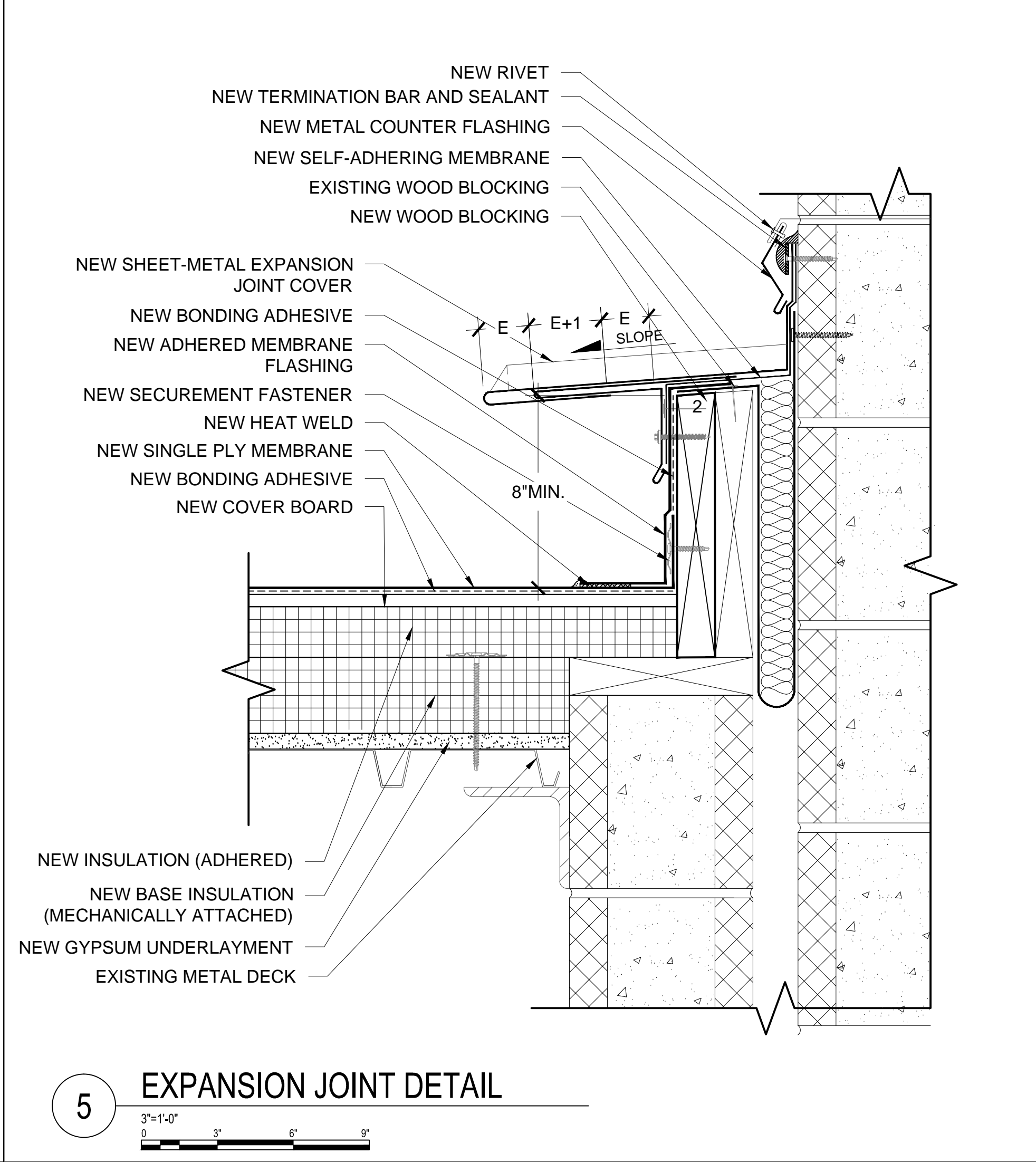
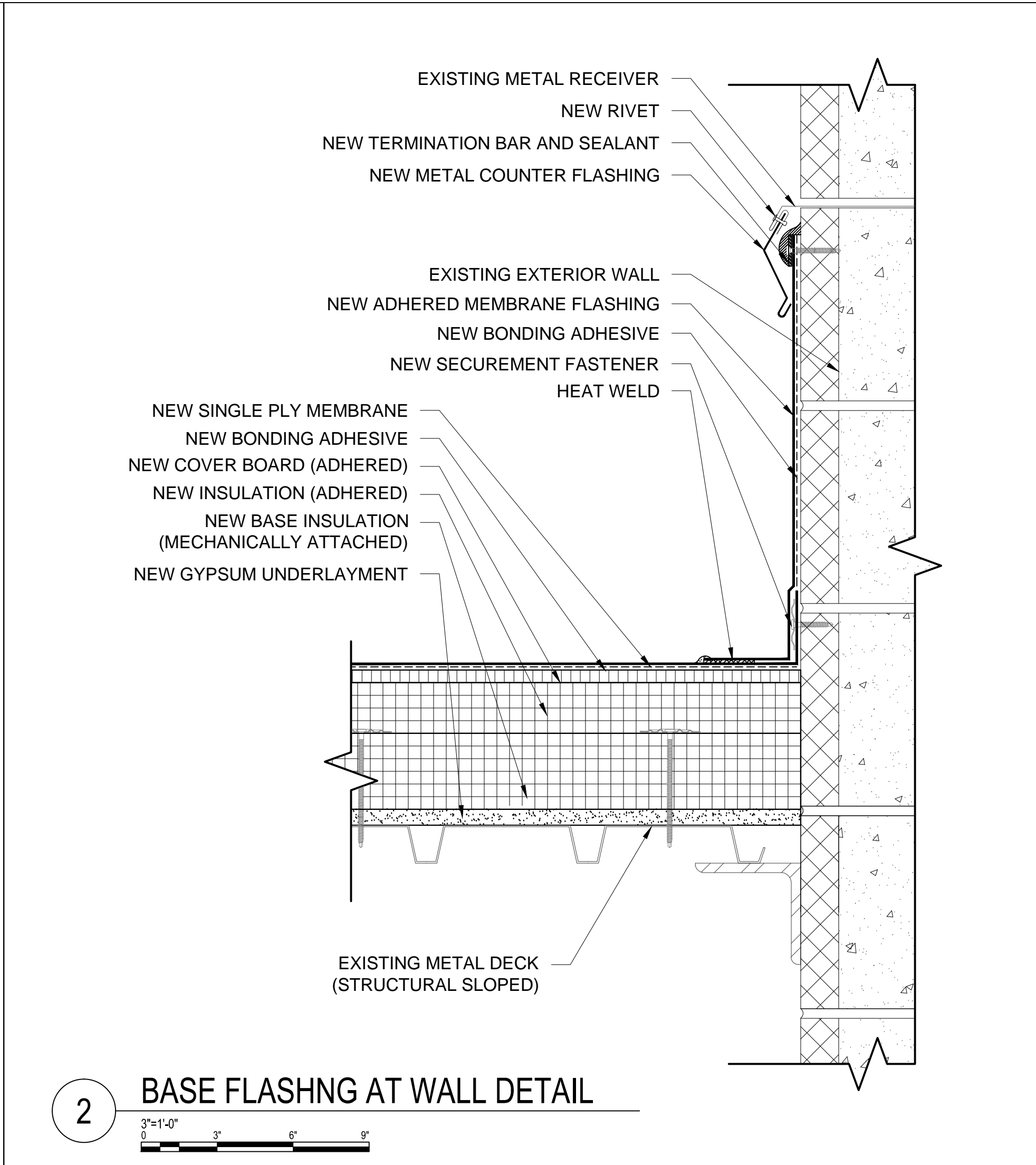
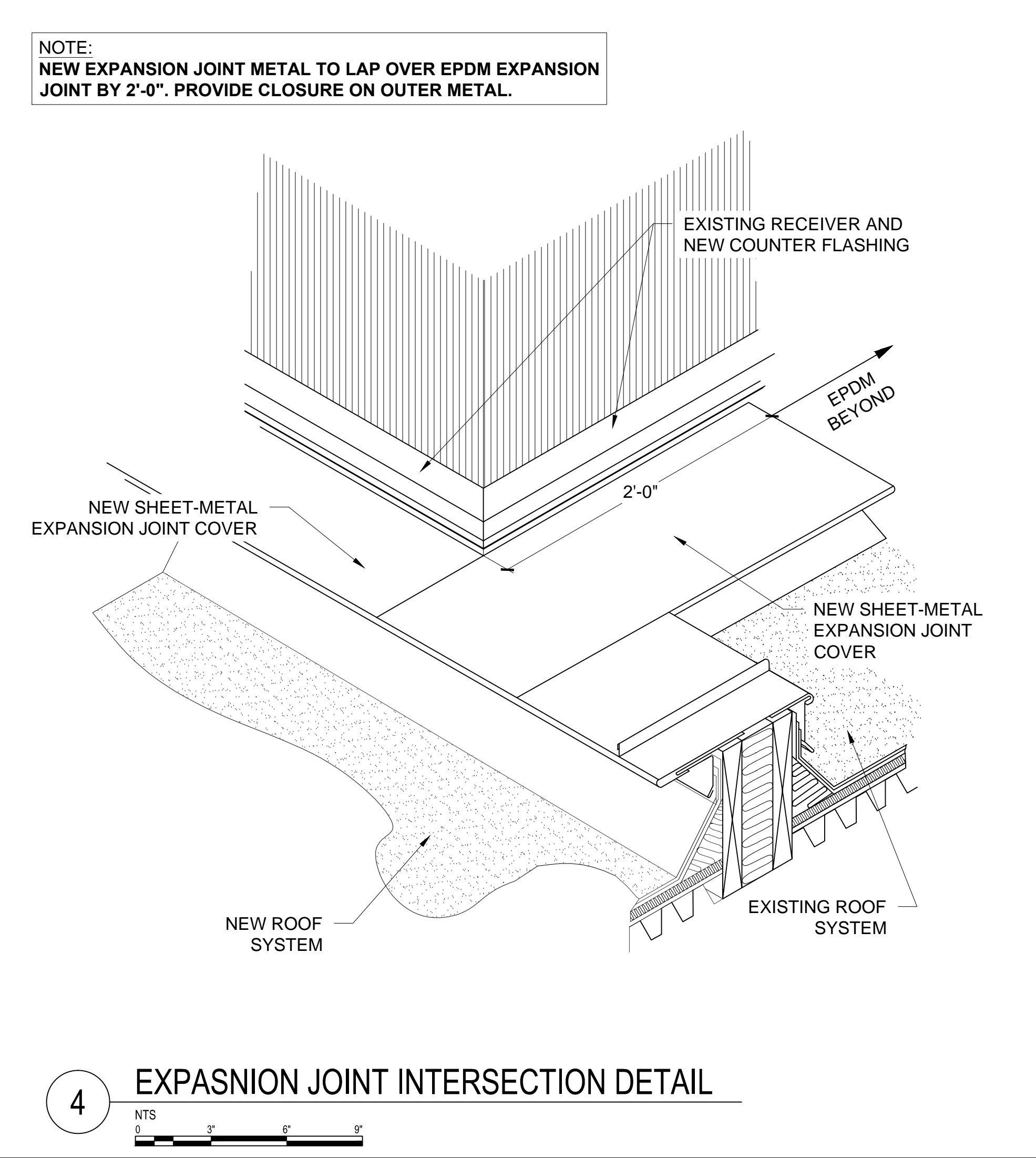
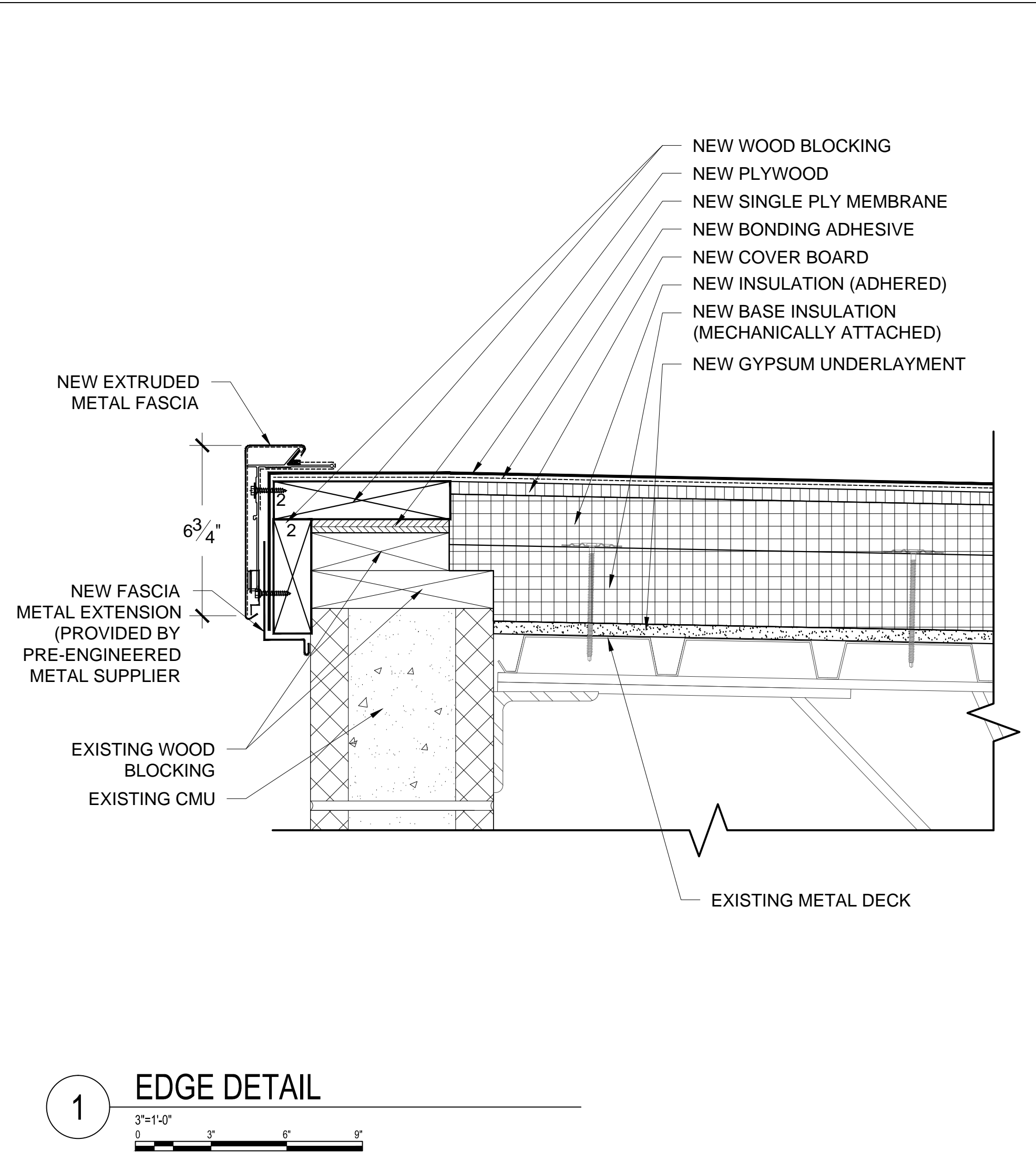

Terracon
Consulting Engineers and Scientists

2020 STARITA ROAD SUITE-E
CHARLOTTE, NORTH CAROLINA
p: 704.594.8940 f: 704.509.1888
terracon.com

PROJECT NAME AND ADDRESS:
**VALLEY SPRINGS MIDDLE SCHOOL
ROOF REPLACEMENT PROJECT**
BUNCOMBE COUNTY SCHOOLS
224 LONG SHOALS ROAD
ARDEN, NORTH CAROLINA

ISSUE DATE:
APRIL 27, 2016

ISSUE FOR:
☐ DESIGN DEVELOPMENT SUBMITTAL:
NOT FOR CONSTRUCTION
☐ SURVEY REPORT SUBMITTAL:
NOT FOR CONSTRUCTION
☐ CONSTRUCTION DOCUMENT SUBMITTAL:
NOT FOR CONSTRUCTION
☒ **BID DOCUMENTS**
NOT FOR CONSTRUCTION
☐ CONSTRUCTION DOCUMENT SUBMITTAL
☐ ADDENDUM SUBMITTAL
☐ RECORD DRAWINGS

PROJECT TEAM:
DESIGNED BY: **JJC/JHP**
DRAWN BY: **EGM II**
APPROVED BY: **LTH**
PROJECT NUMBER: **FH166112**

ADDENDUM:
NO. 1: DATE: 05.6.16 DESCRIPTION: ADDENDUM No.1

ENGINEER STATE LICENSE SEAL

TITLE SHEET:
ROOF DETAILS
SHEET NUMBER:
A-501

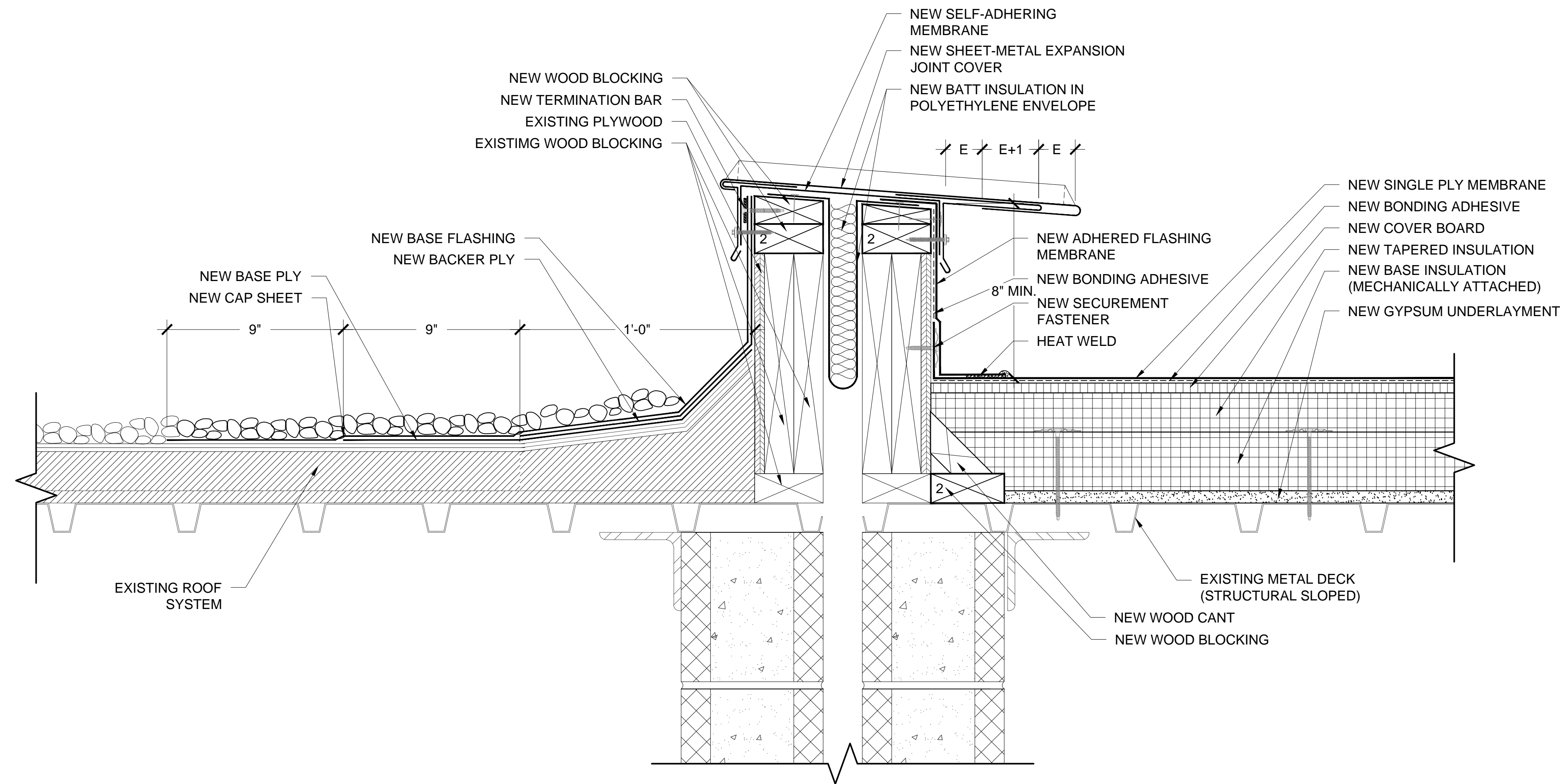

7 TRANSITION DETAIL

3"=1'-0"

0 3' 6' 9'

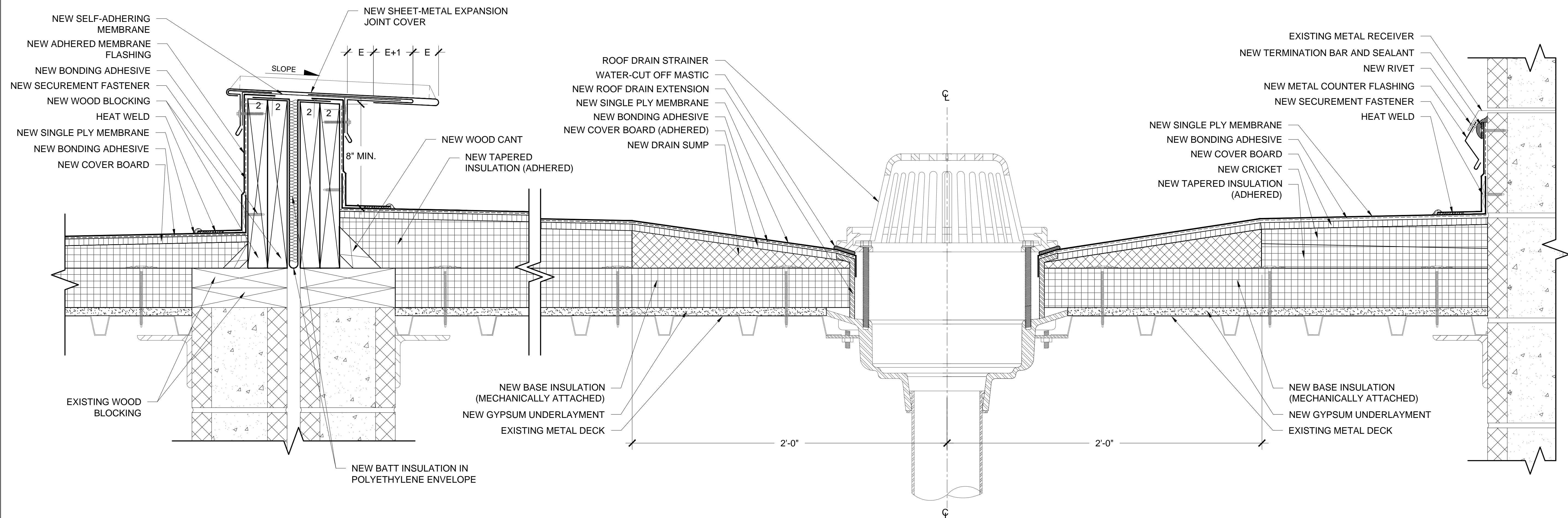

8 ROOF SECTION: AREA I, J & O

3"=1'-0"

0 3' 6' 9'

PROJECT NAME AND ADDRESS:

BUNCOMBE COUNTY SCHOOLS
**VALLEY SPRINGS MIDDLE SCHOOL
ROOF REPLACEMENT PROJECT**
224 LONG SHOALS ROAD
ARDEN, NORTH CAROLINA

ISSUE DATE:
APRIL 27, 2016

ISSUE FOR:

☐ DESIGN DEVELOPMENT SUBMITTAL:
NOT FOR CONSTRUCTION

☐ SURVEY REPORT SUBMITTAL:
NOT FOR CONSTRUCTION

☐ CONSTRUCTION DOCUMENT SUBMITTAL:
NOT FOR CONSTRUCTION

☒ **BID DOCUMENTS**
NOT FOR CONSTRUCTION

☐ CONSTRUCTION DOCUMENT SUBMITTAL

☐ ADDENDUM SUBMITTAL

☐ RECORD DRAWINGS

PROJECT TEAM:

DESIGNED BY:
JJC/JHP

DRAWN BY:
EGM II

APPROVED BY:
LTH

PROJECT NUMBER:
FH166112

ADDENDUM:		
NO. 1:	DATE:	DESCRIPTION:
1	05.6.16	ADDENDUM No.1

ENGINEER STATE LICENSE SEAL



TITLE SHEET:
ROOF DETAILS

SHEET NUMBER:

A-502

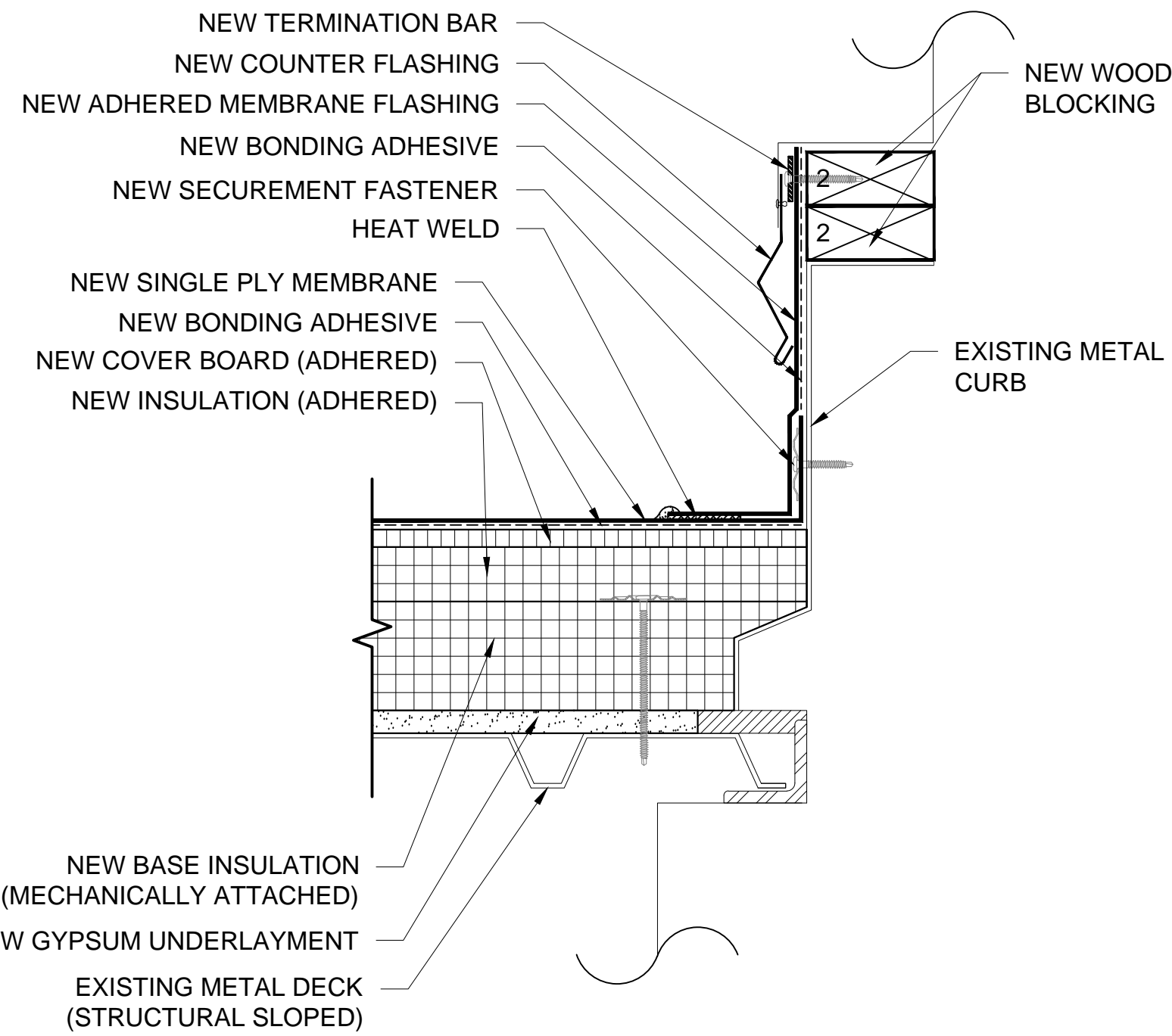

9 EQUIPMENT CURB DETAIL

NOTE:
CONTRACTOR SHALL COORDINATE WITH
OWNER AND LEADER OUTSIDE OF SCHOOL
HOURS. CONTRACTOR IS RESPONSIBLE
FOR ALL DAMAGE TO CMU WHEN MAKING
OPENINGS.

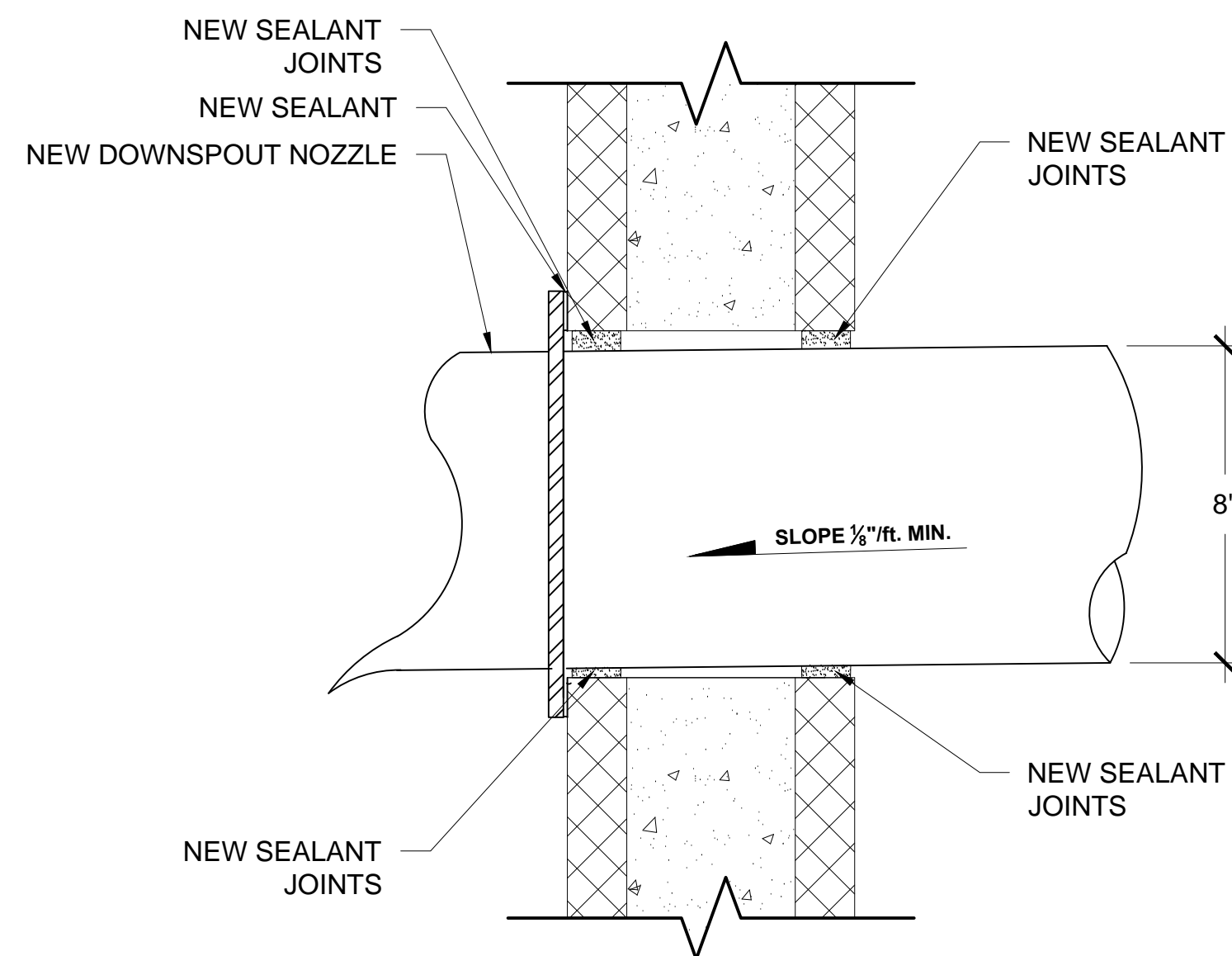

10 OVERFLOW DRAIN OUTLET

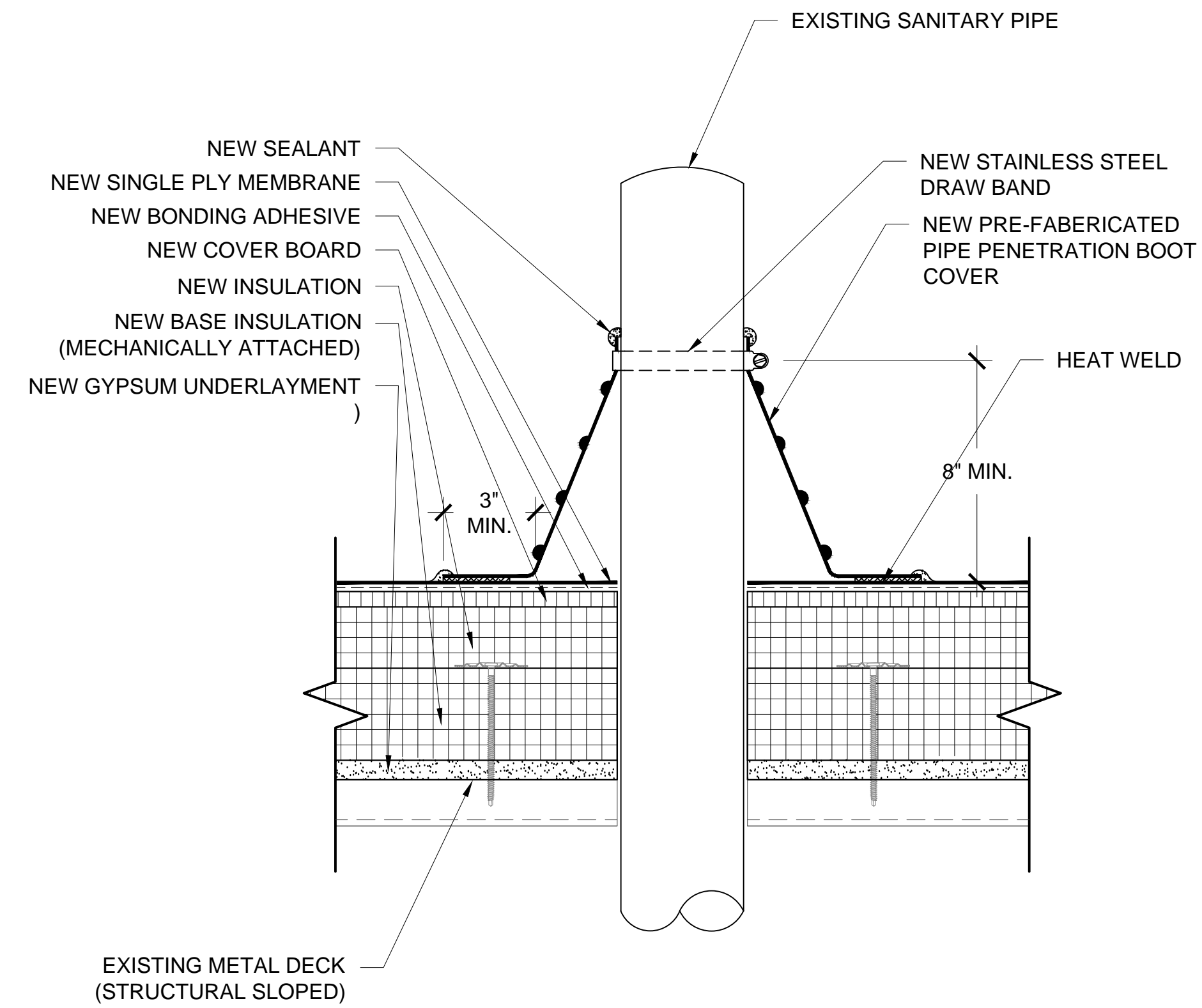

11 SANITARY PIPE PENTRATION DETAIL

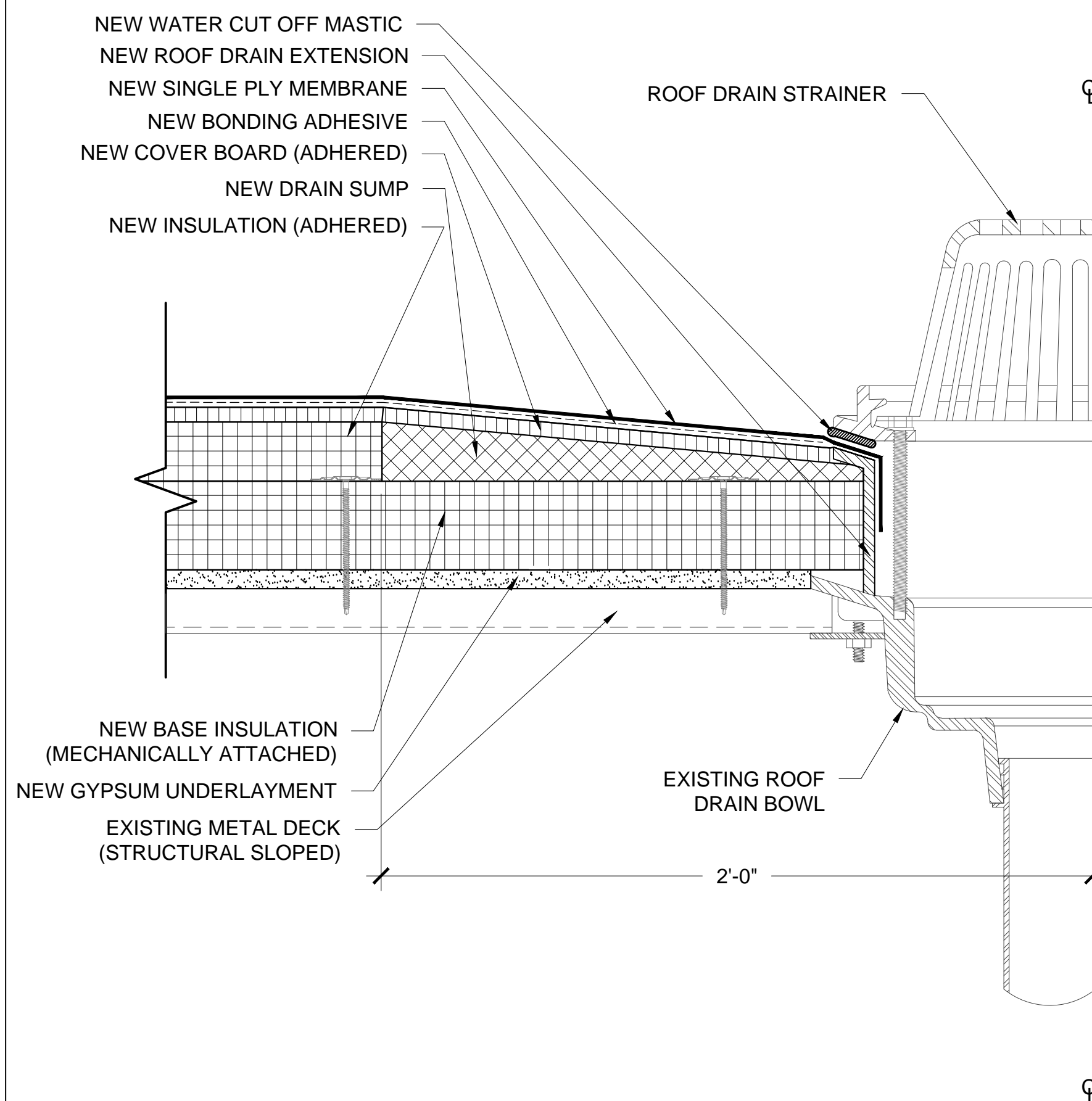

12 ROOF DRAIN DETAIL

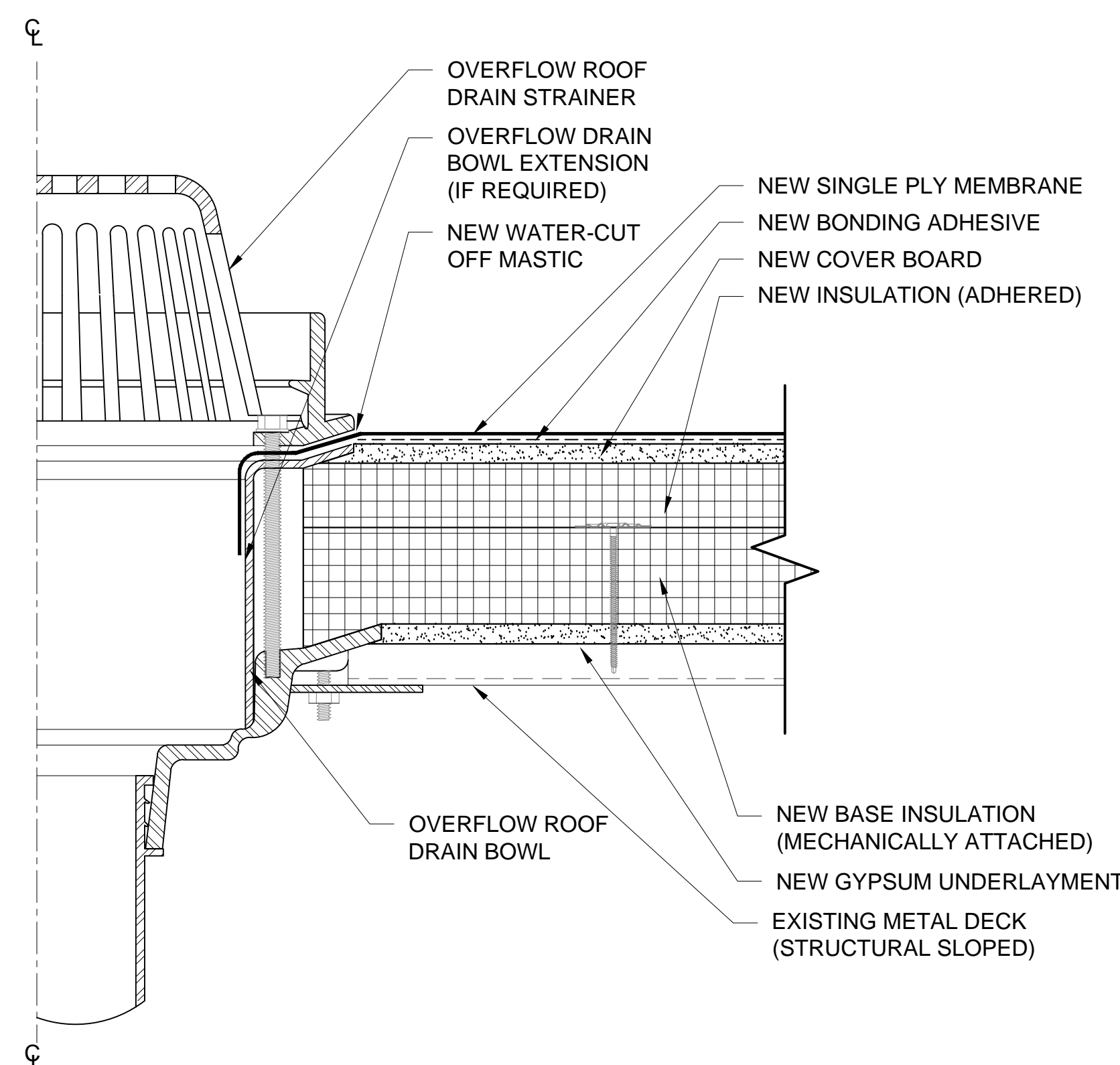

13 OVERFLOW ROOF DRAIN DETAIL

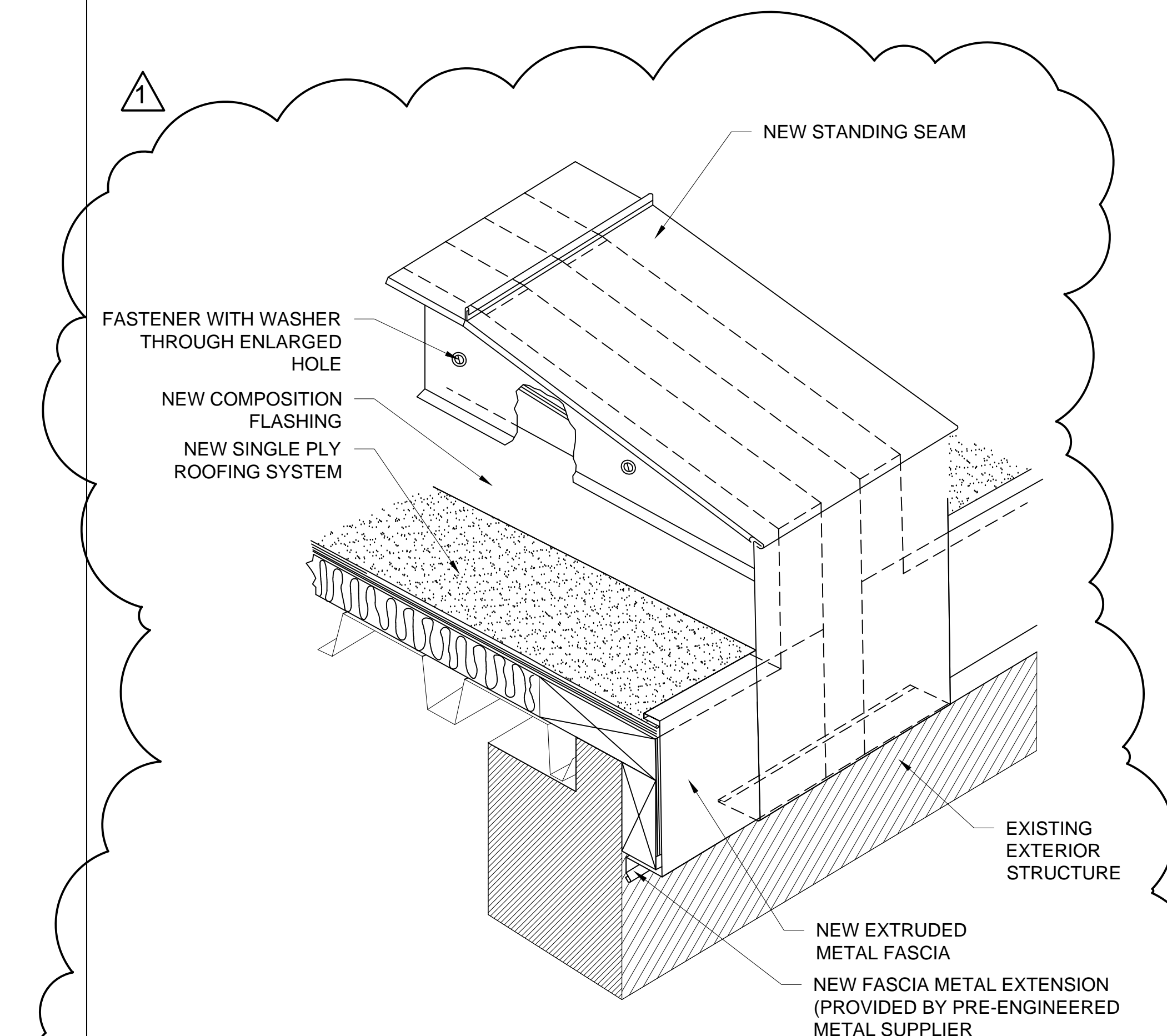

14 BUILDING EXPANSION JOINT DETAIL

PROJECT NAME AND ADDRESS:

BUNCOMBE COUNTY SCHOOLS
**VALLEY SPRINGS MIDDLE SCHOOL
ROOF REPLACEMENT PROJECT**
224 LONG SHOALS ROAD
ARDEN, NORTH CAROLINA

ISSUE DATE:

APRIL 27, 2016

ISSUE FOR:

- ☐ DESIGN DEVELOPMENT SUBMITTAL:
NOT FOR CONSTRUCTION
☐ SURVEY REPORT SUBMITTAL:
NOT FOR CONSTRUCTION
☐ CONSTRUCTION DOCUMENT SUBMITTAL:
NOT FOR CONSTRUCTION
☒ **BID DOCUMENTS**
NOT FOR CONSTRUCTION
☐ CONSTRUCTION DOCUMENT SUBMITTAL
☐ ADDENDUM SUBMITTAL
☐ RECORD DRAWINGS

PROJECT TEAM:

DESIGNED BY:

JJC/JHP

DRAWN BY:

EGM II

APPROVED BY:

LTH

PROJECT NUMBER:

FH166112

ADDENDUM:

NO. 1:	DATE:	DESCRIPTION:
1	05.6.16	ADDENDUM No.1

ENGINEER STATE LICENSE SEAL



TITLE SHEET:

ROOF DETAILS (ALT. No.1)

SHEET NUMBER:

A-503



PHOTO OF EXISTING EQUIPMENT CURB AT ROOF AREA H

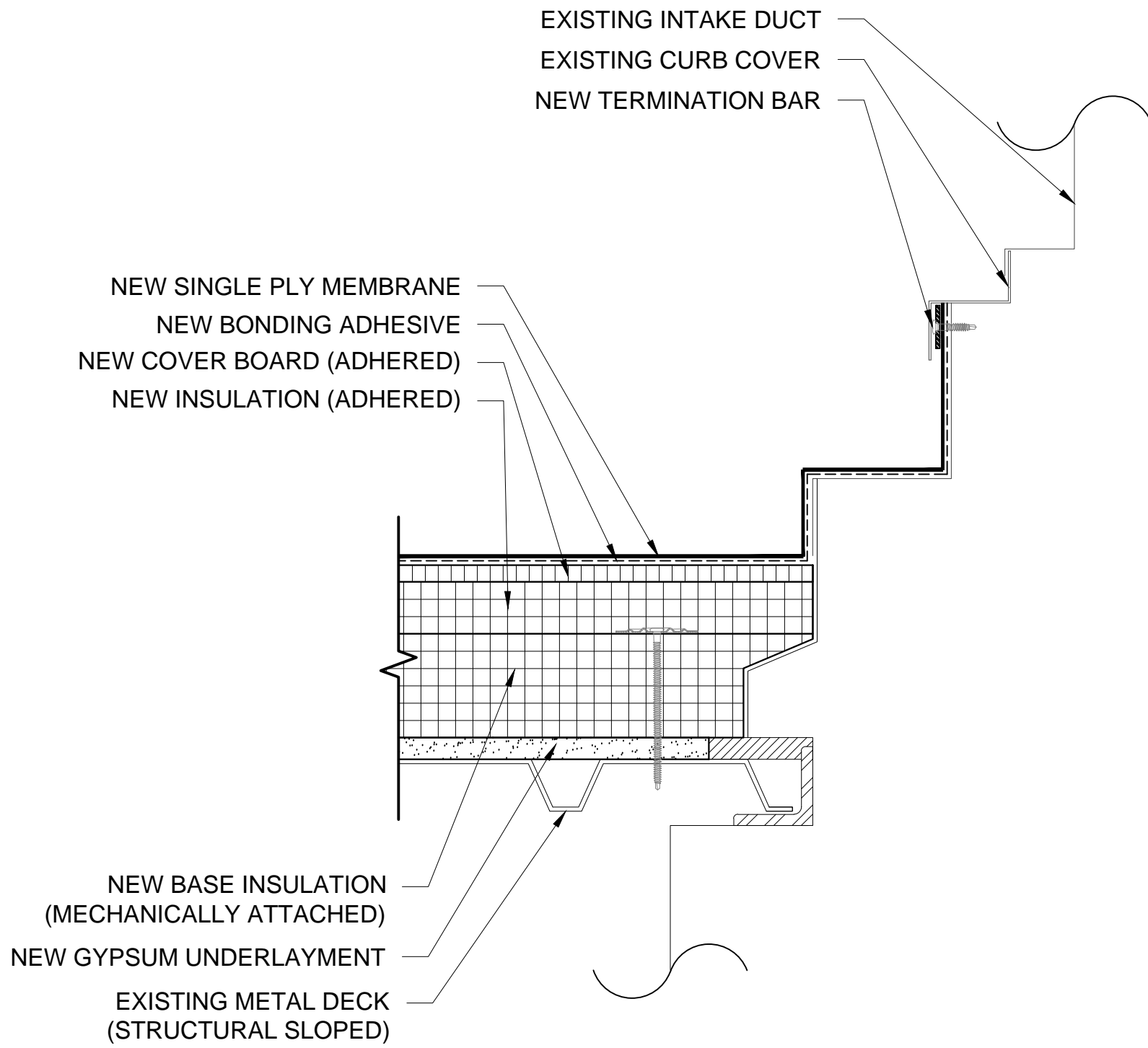

15 EXISTING EQUIPMENT CURB DETAIL

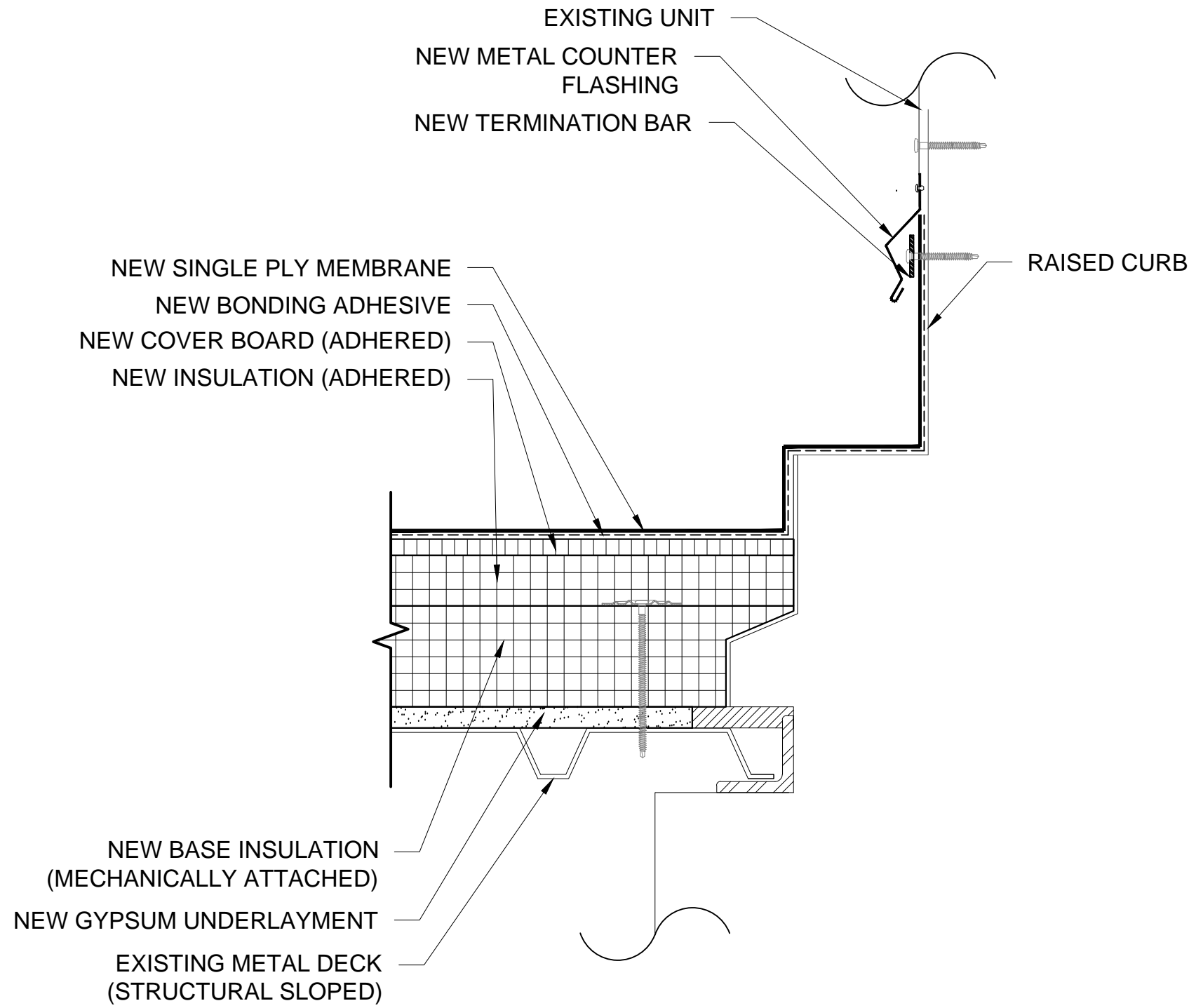

15A EXISTING EQUIPMENT CURB DETAIL

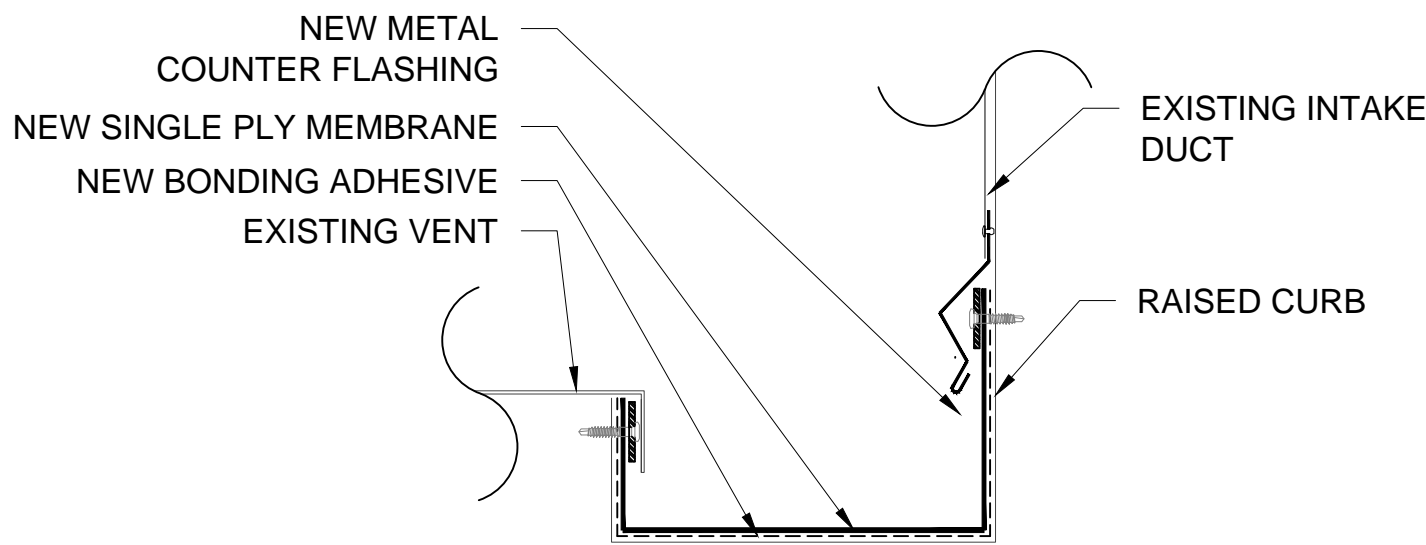

15B EXISTING EQUIPMENT CURB COVER FLASHING DETAIL

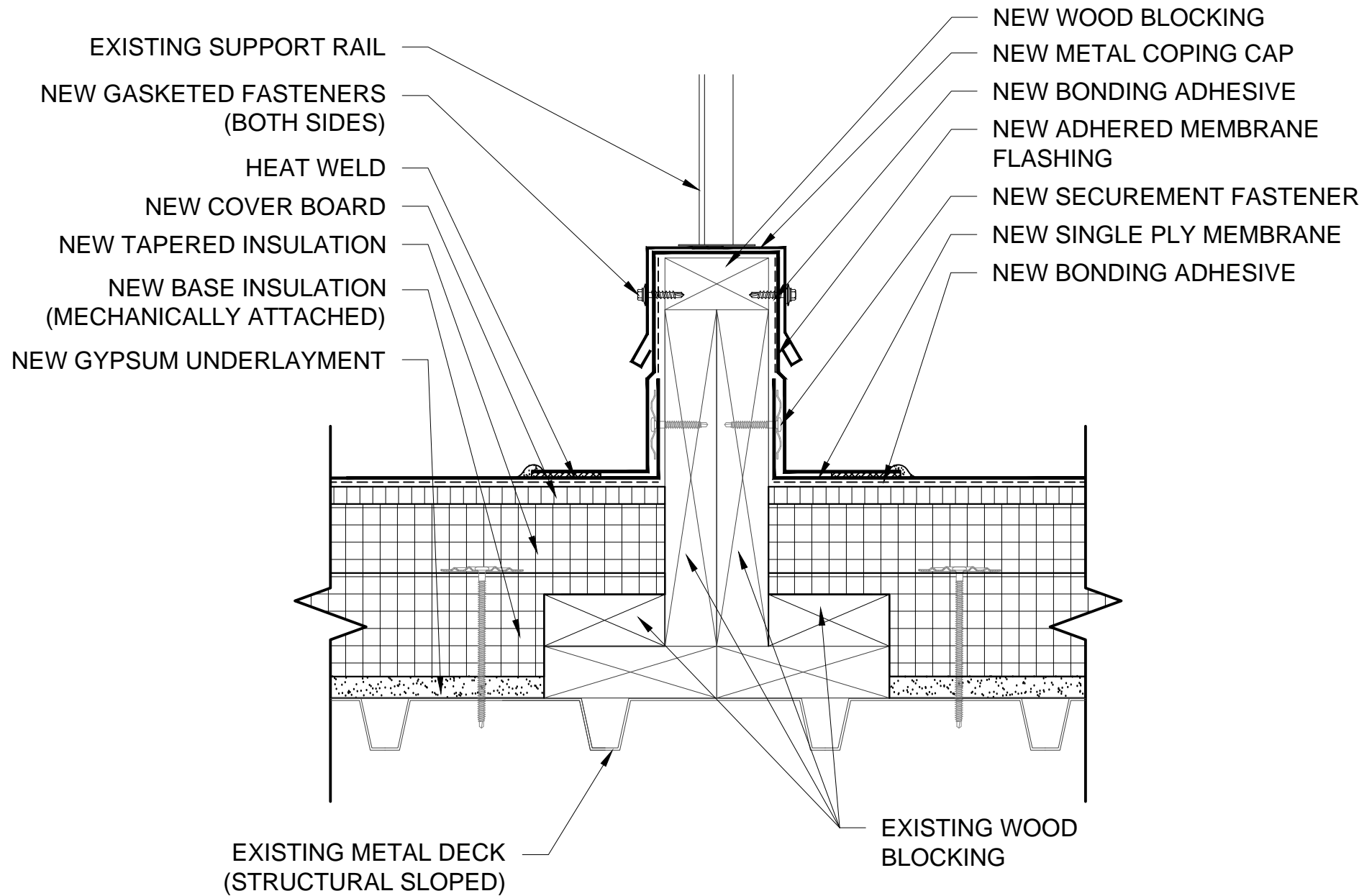

15C EXISTING EQUIPMENT SUPPORT CURB DETAIL

PROJECT NAME AND ADDRESS:

BUNCOMBE COUNTY SCHOOLS
**VALLEY SPRINGS MIDDLE SCHOOL
ROOF REPLACEMENT PROJECT**
224 LONG SHOALS ROAD
ARDEN, NORTH CAROLINA

ISSUE DATE:

APRIL 27, 2016

ISSUE FOR:

- ☐ DESIGN DEVELOPMENT SUBMITTAL:
NOT FOR CONSTRUCTION
- ☐ SURVEY REPORT SUBMITTAL:
NOT FOR CONSTRUCTION
- ☐ CONSTRUCTION DOCUMENT SUBMITTAL:
NOT FOR CONSTRUCTION
- ☒ **BID DOCUMENTS**
NOT FOR CONSTRUCTION
- ☐ CONSTRUCTION DOCUMENT SUBMITTAL
- ☐ ADDENDUM SUBMITTAL
- ☐ RECORD DRAWINGS

PROJECT TEAM:

DESIGNED BY:

JJC/JHP

DRAWN BY:

EGM II

APPROVED BY:

LTH

PROJECT NUMBER:

FH166112

ADDENDUM:

NO. 1: DATE: DESCRIPTION:

1 05.6.16 ADDENDUM No.1

ENGINEER STATE LICENSE SEAL



TITLE SHEET:

ROOF DETAILS (ALT. No.1)

SHEET NUMBER:

1
A-504