

DEVELOPMENT DATA

OWNER:
 BUNCOMBE COUNTY BOARD OF EDUCATION
 175 BINGHAM ROAD
 ASHEVILLE, NC 28806
 828-255-5921

ARCHITECT:
 MHA WORKS
 12 S. LEXINGTON AVE. UNIT 100
 ASHEVILLE NC, 28801
 828-251-5550

CIVIL ENGINEER:
 MATTERN & CRAIG
 12 BROAD STREET
 ASHEVILLE, NC 28801
 828-254-2201







SURVEYOR:
 MCABEE & ASSOCIATES, P.A.
 3 MCABEE TRAIL
 FAIRVIEW NC, 28730
 828-628-1295

PIN: 9743-44-1042
 DB 717 PG 626
 ZONING: R-3 RESIDENTIAL
 ACREAGE OF SITE: 28.95 AC
 LIMITS OF DISTURBANCE: 2.45 AC
 PRE-DEVELOPMENT IMPERVIOUS: (34.9%)
 POST-DEVELOPMENT IMPERVIOUS: (45.7%)

THE SITE CONSISTS OF THE FOLLOWING SOILS (SOILS WERE TAKEN FROM THE USDA ONLINE GIS SOIL MAP):

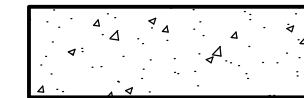
CLIFTON CLAY LOAM (CLAY LOAM)
 UDORTHENTS, LOAMY (SANDY CLAY LOAM)
 UDORTHENTS-URBAN LAND COMPLEX(2 TO 50 PERCENT)

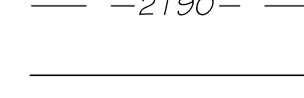
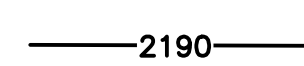
LEGEND

-  STANDARD DUTY PAVEMENT SECTION. SEE DETAIL C13.
-  OVERLAY EXISTING ASPHALT PAVEMENT. SEE DETAIL C13.
-  PROPOSED 4" CONCRETE SIDEWALK. SEE DETAIL C13.
-  EXISTING MINOR CONTOUR
-  EXISTING MAJOR CONTOUR
-  PROPOSED MINOR CONTOUR
-  PROPOSED MAJOR CONTOUR

BID ALTERNATE #3
 PROVIDE SOD FOR ALL DISTURBED AREAS IN LIEU OF SEEDING.

BID ALTERNATE #4
 DEDUCT ALL PAVING AND STRIPING FROM BASE BID

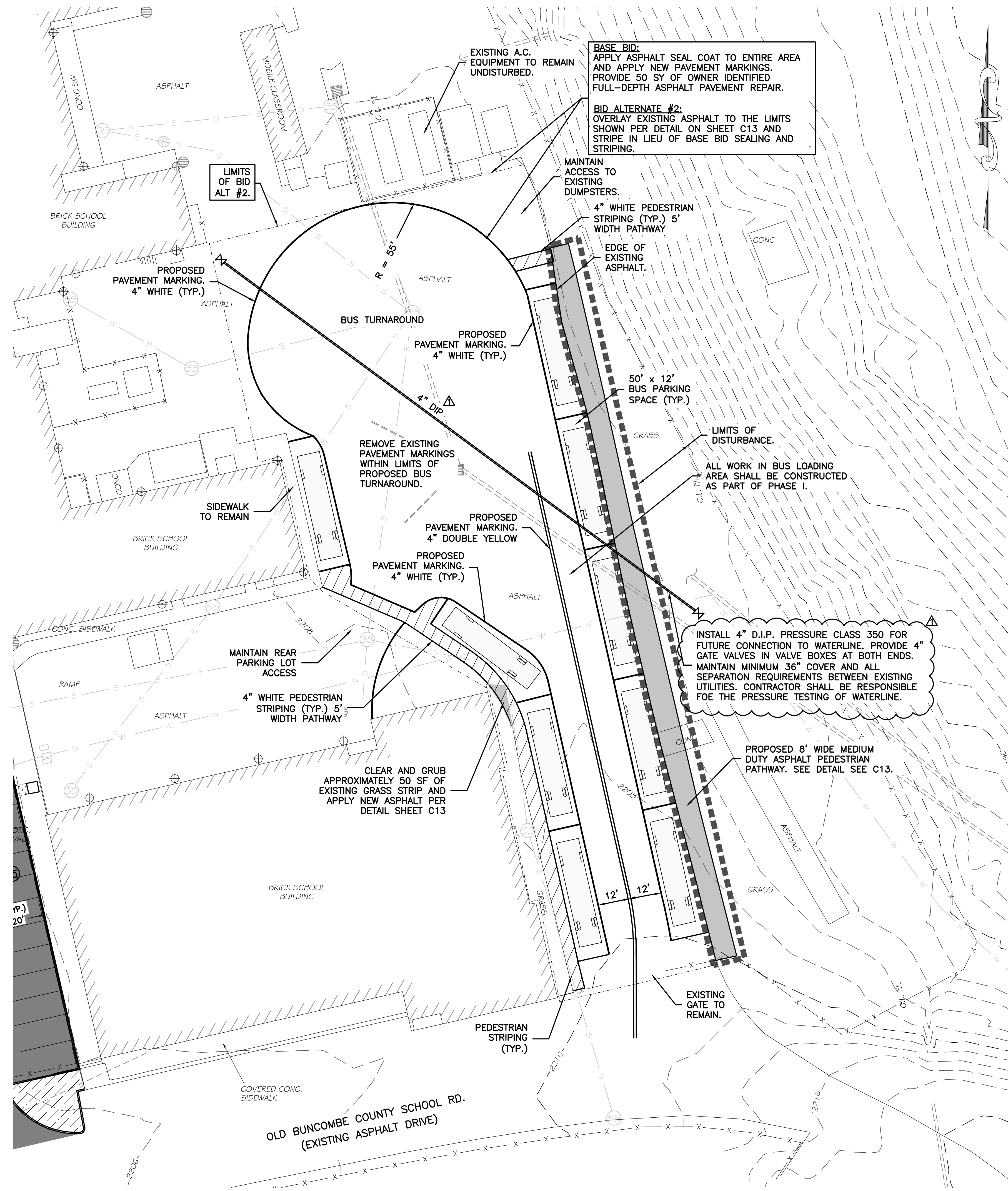

BASE BID:
 APPLY ASPHALT SEAL COAT TO ENTIRE AREA AND APPLY NEW PAVEMENT MARKINGS. PROVIDE 50 SY OF OWNER IDENTIFIED FULL-DEPTH ASPHALT PAVEMENT REPAIR.

BID ALTERNATE #2:
 OVERLAY EXISTING ASPHALT TO THE LIMITS SHOWN PER DETAIL ON SHEET C13 AND STRIPE IN LIEU OF BASE BID SEALING AND STRIPING.

INSTALL 4" D.I.P. PRESSURE CLASS 350 FOR FUTURE CONNECTION TO WATERLINE. PROVIDE 4" GATE VALVES IN VALVE BOXES AT BOTH ENDS. MAINTAIN MINIMUM 36" COVER AND ALL SEPARATION REQUIREMENTS BETWEEN EXISTING UTILITIES. CONTRACTOR SHALL BE RESPONSIBLE FOR THE PRESSURE TESTING OF WATERLINE.

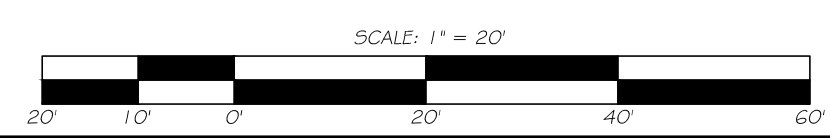

Date	4.10.18
Revisions	REVISED 6" SLEEVE TO 4" WATER LINE

Issue Date: MAR 9, 2018
 Drawn By: BGR
 Designed By: DJB
 Checked By: DJB
 Date: MAR 9, 2018

Mattern & Craig
 CONSULTING ENGINEERS
 12 BROAD STREET
 ASHEVILLE, NORTH CAROLINA 28801
 (828) 254-2201
 FAX (828) 254-4562

NORTH BUNCOMBE MIDDLE SCHOOL DRIVEWAY
TEMPORARY BUS LOADING PLAN
 BUNCOMBE COUNTY, NC

Vertical Scale: N/A

Horizontal Scale: 1" = 20'

Commission Number: 3762

Sheet No.: **C8**