

PROJECT DESCRIPTION:

WORK INVOLVES: WORK CONSISTS OF THE CONSTRUCTION OF A (4) STALL RESTROOM AND A STAFF TOILET ROOM TO BE INTERNAL TO THE BUILDING. WORK INCLUDES THE DEMOLITION AND RENOVATION OF BLOCK WALLS, PLUMBING, MECHANICAL, ELECTRICAL, TOILET PARTITIONS AND TOILET ACCESSORIES.

THE PROJECT INVOLVES: GENERAL CONTRACTOR, MECHANICAL, PLUMBING AND ELECTRICAL WORK. THE LOCATION IS INTERNAL TO THE BUILDING AND DOES NOT INVOLVE AN ADDITION OR NEW BUILDING FOOTPRINT.

CONTRACTOR IS RESPONSIBLE FOR OBTAINING AND PAYING ALL COSTS ASSOCIATED W/ BUNCOMBE COUNTY PERMITS AND FEES ASSOCIATED WITH THIS WORK.

GENERAL NOTES

1. PRIOR TO CONSTRUCTION, CONTRACTOR SHALL FIELD VERIFY EXISTING DIMENSIONS AND NOTIFY ARCHITECT OF ANY DISCREPANCIES THAT WILL IMPACT THE DESIGN INTENT OF THE ADA COMPLIANT IMPROVEMENTS INDICATED IN THESE DOCUMENTS.
2. ALL EQUIPMENT, FIXTURES, HARDWARE AND ACCESSORIES PROVIDED ARE TO COMPLY WITH 2010 ADA STANDARDS FOR ACCESSIBLE DESIGN BY THE US DEPARTMENT OF JUSTICE AND ICC A117.1-2009 ACCESSIBLE AND USABLE BUILDINGS AND FACILITIES. ALL PRODUCTS IDENTIFIED INDICATE BASIS OF DESIGN. REFER TO SPECIFICATIONS FOR ADDITIONAL INFORMATION.
3. ALL EXISTING MATERIALS TO REMAIN ARE TO BE PROTECTED AND CLEANED. REMOVE EXISTING DEBRIS WITHOUT DAMAGING FINISHES.
4. NEATLY SEAL NEW MATERIALS TO EXISTING MATERIAL AND SURFACES.

OWNER CONTACTS:

DESIGN AND TECHNICAL CONTACT:

ARCHITECT
CAROL HENNE FAY
ASST. FACILITIES DIRECTOR, BUNCOMBE CO. SCHOOLS
PHONE: 828-255-5917
E-MAIL: CAROL.FAY@BCSEMAIL.ORG

PME ENGINEER
SUD ASSOCIATES, P.A.
CONSULTING ENGINEERS
PHONE- 828-255-4691

BIDDING & ADMINISTRATIVE CONTACT:

TIFFANY McCANTS
PURCHASING OFFICER
PHONE: 828-255-5891
FAX: 828-251-1730

SHEET INDEX:

COVER	
A1.1	PROPOSED AND DEMOLITION PLANS
A2.1	ELEVATIONS AND DETAILS, DOOR AND HARDWARE SCHEDULE, REFLECTED CEILING PLANS, FINISH SCHEDULE
PME	TO BE ISSUED

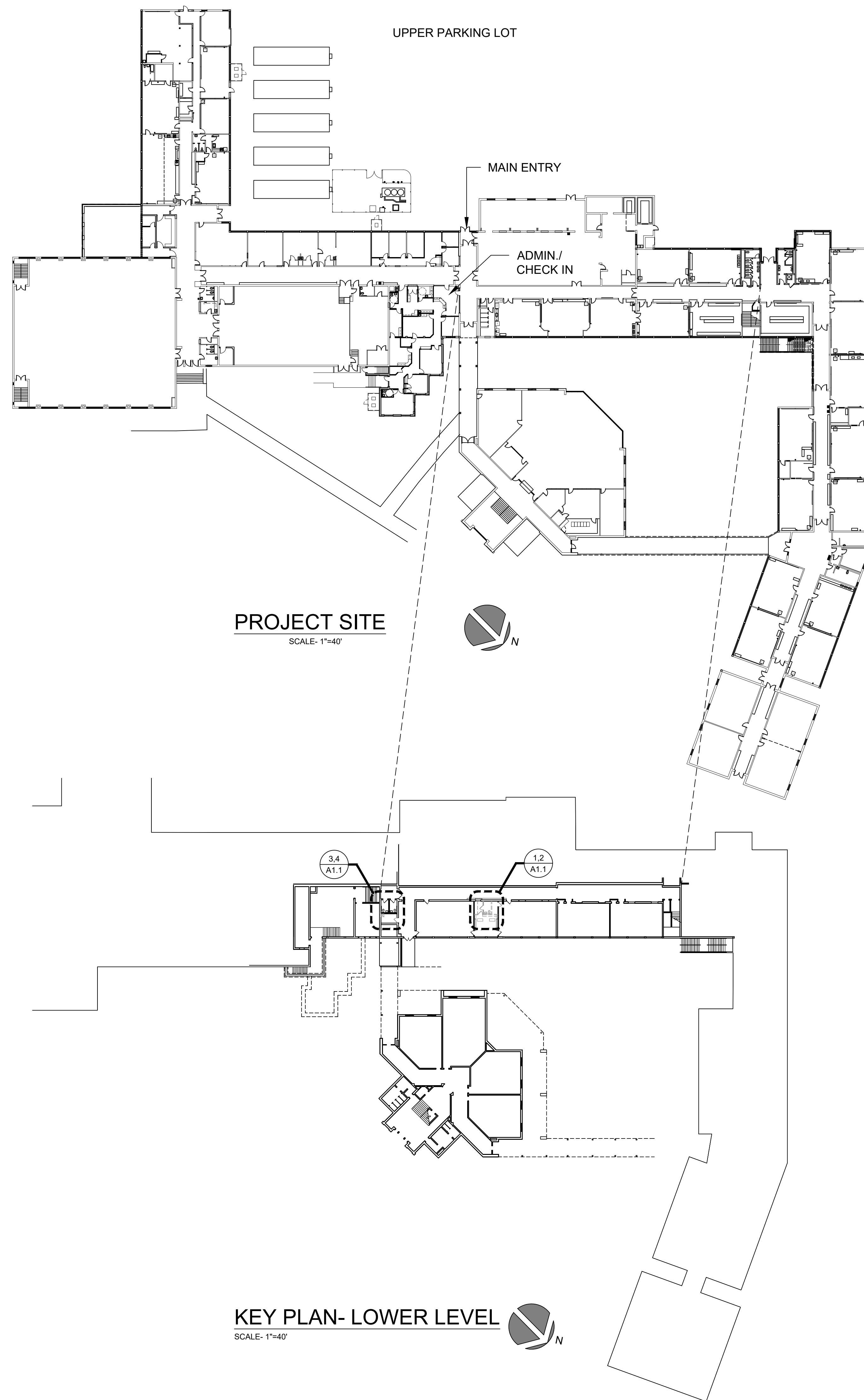
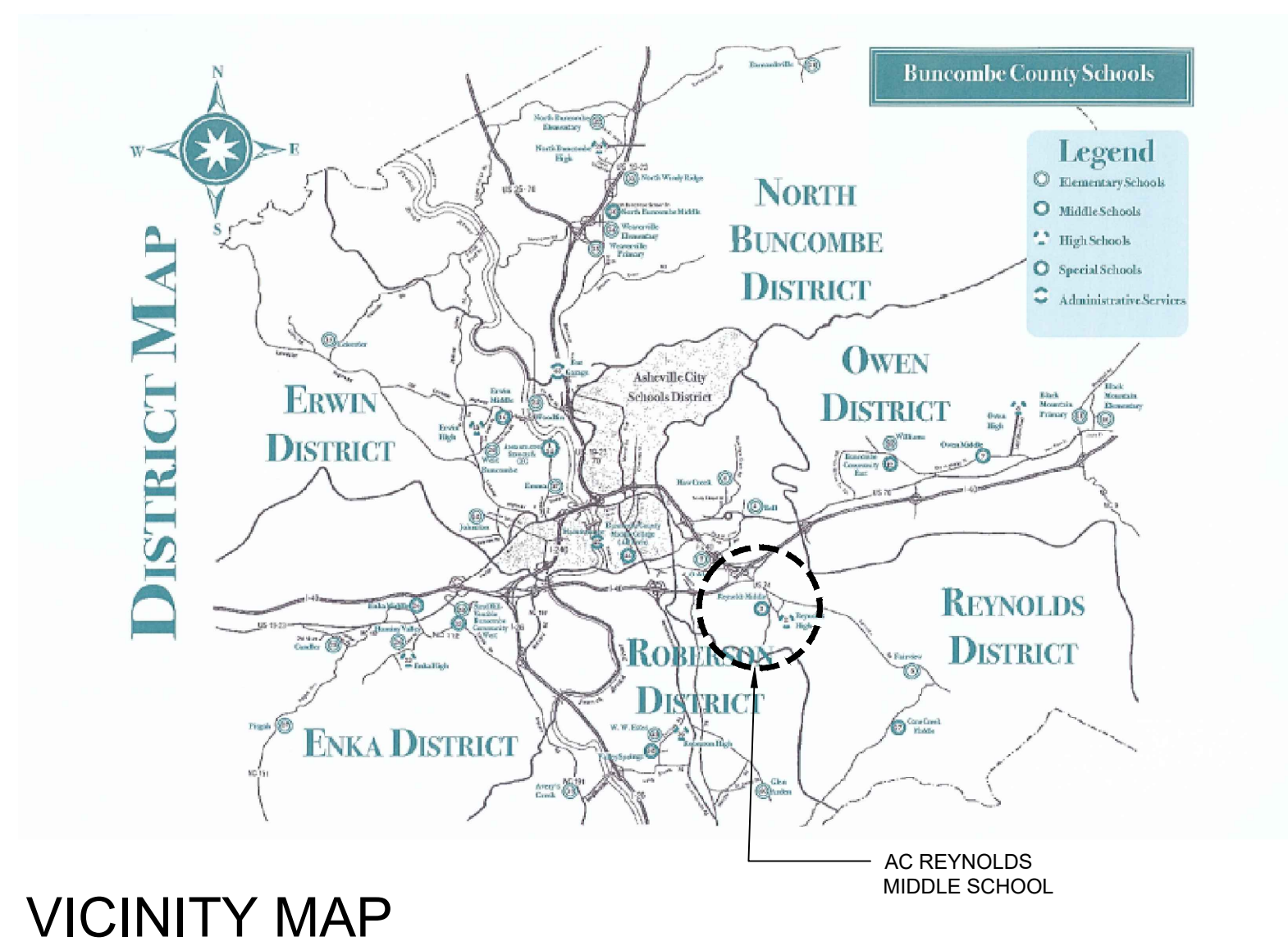

**Buncombe County Schools
Facilities and Planning**

Timothy Fierle AIA, Director
175 Bingham Road □ Asheville, N.C. 28806-3800
Phone: (828) 255-5916 Fax: (828) 255-5923



COVER

DESIGNED BY: CHF
DATE: 06.14.2019