



814 Broad St.
Weymouth, MA 02189

T 781.337.0016
TRCcompanies.com

December 10, 2020

VIA EMAIL: jason.parenteau@sodexo.com

Mr. Jason Parenteau
General Manager
Attleboro School District
100 Rathbun Willard Drive
Attleboro, Massachusetts 02703

Project No. 413225

**Subject: Asbestos Reinspection, 2020
Thacher School
Attleboro, Massachusetts**

Dear Mr. Parenteau:

Please find enclosed the three-year re-inspection report for the Thacher School. If you require any further assistance please feel free to contact me at (781) 337-0016.

Thank you for allowing TRC Environmental, Inc (TRC) to assist you with this project.

Sincerely,
TRC Environmental, Inc

A handwritten signature in black ink, appearing to read 'Gregory Hatch', written in a cursive style.

Gregory Hatch
BSI Office Practice Leader

MA Certified Asbestos Inspector (AI061535)
MA Certified Management Planner (AP061534)



814 Broad St.
Weymouth, MA 02189

T 781.337.0016
TRCcompanies.com

**AHERA
3-YEAR REINSPECTION REPORT
THACHER SCHOOL**

SUBMITTED TO:

**Mr. Jason Parenteau
General Manager
Attleboro School District
100 Rathbun Willard Drive
Attleboro, Massachusetts 02703**

SUBMITTED BY:

**TRC ENVIRONMENTAL, INC.
814 Broad Street
Weymouth, Massachusetts 02189**

PROJECT NO. 413225

December 10, 2020

**AHERA
3-YEAR REINSPECTION REPORT
THACHER SCHOOL
ATTLEBORO, MASSACHUSETTS**

Submitted To:

Mr. Jason Parenteau
General Manager
Attleboro School District
100 Rathbun Willard Drive
Attleboro, Massachusetts 02703

Inspector:

Gregory Hatch

A handwritten signature in black ink, appearing to read "Gregory Hatch", written over a horizontal line.

BSI – Office Practice Leader
TRC Environmental, Inc
Massachusetts Inspector # AI061535

December 10, 2020

TABLE OF CONTENTS

SECTION	PAGE
1.0 INTRODUCTION.....	1
2.0 DISCUSSION.....	2
3.0 REINSPECTION EPA ASSESSMENT SUMMARY	4
4.0 CONCLUSIONS.....	5

APPENDICES

SCHOOL KEY PLAN.....	APPENDIX A
ACBM MATERIALS REMAINING.....	APPENDIX B
HOMOGENOUS MATERIAL IDENTIFICATION	APPENDIX C
EPA AHERA SELF AUDIT CHECKLIST	APPENDIX D
MANAGEMENT PLANNER TRAINING INFORMATION	APPENDIX E
AHERA MEMO TO PARENTS	APPENDIX F
BULK SAMPLE RESULTS.....	APPENDIX G

1.0 INTRODUCTION

TRC Environmental, Inc (TRC) was retained by the Attleboro Public School to perform a three-year reinspection at the Thatcher School located at 7 James Street in Attleboro, Massachusetts.

The inspection was performed on November 11, 2020 by TRC's Industrial Hygienist, Gregory Hatch, with Massachusetts State Accreditation # AI061535.

The purpose of this inspection is to visually reinspect and reassess all friable and non-friable known or assumed asbestos-containing building material (ACBM) within the school facility in compliance with the United States Environmental Protection Agency's (USEPA) Asbestos Hazard Emergency Response Act (AHERA) (40 CFR Part 763.85 [b]).

The reinspection was conducted in two phases.

PHASE I

- Review the existing management plan and discuss with the designated person response actions completed.
- Review abatement/remedial activities, work orders and training records since management plan implementation, if applicable.
- Obtain 8 1/2" x 11" drawings from the Local Education Agency (LEA).

PHASE II

- Visually re-inspect and reassess the condition of all friable known or assumed ACBM.
- Visually inspect material that was previously identified as non-friable ACBM and touch the material to determine whether it has become friable since the last inspection or reinspection.
- Identify homogeneous areas with materials that have become friable since the last inspection or reinspection.
- Assess the condition of any newly friable materials.
- Submit to the designated person any assessments or reassessments made of friable known or assumed ACBM as identified in the original inspection report.
- Submit a report detailing the results of the reinspection for inclusion into the LEA's management plans.

2.0 DISCUSSION

The management plan on file at the office of the LEA was reviewed and the following summarizes this review.

2.1 Designated Person

Mr. Jason Parenteau
General Manager
Attleboro School District
100 Rathbun Willard Drive
Attleboro, Massachusetts 02703

The AHERA regulation 763.84[g](1) states that "the general LEA shall designate a person to ensure that requirements under this section are properly implemented". Section 763.84[g](2) further states that "the LEA shall ensure that the designated person receives adequate training to perform duties assigned under this section".

2.2 Yearly Building Occupant Notification

"The designated person must ensure that workers and building occupants, or their legal guardians and any company that conducts work in the building, are informed at least once each school year about inspections, response actions, and post-response action activities, including periodic re-inspection and surveillance activities that are planned or in progress", as per the AHERA regulation section 763.84(c).

The records for previous years have been incorporated into the management plan for the school. A copy of the letter is attached in Appendix F. It is recommended that a copy of the letter for each year and be sure to include the contact information of the LEA. TRC recommends that copies of the records be incorporated into the management plans to satisfy the requirement to maintain and update the plan.

2.3 Custodial/Maintenance Personnel Training

Custodial and maintenance personnel hired are required to receive a minimum of 2 hours "asbestos awareness training". Training should be provided within 60 days of employment.

Documentation of the 2-hour Asbestos Awareness training for custodial staff that may be working in the building was included in the Management Plan. These records should be cross-checked with the list of personnel currently working in the building. If any staff remains untrained, training should be provided for and documentation should be added to the Management Plan.

2.4 Periodic Surveillance

The LEA shall conduct six-month periodic surveillance of all known ACBM present in each school in accordance with the AHERA Regulation. A 2-hour trained staff member may conduct the six-month inspection. The inspection is performed to document any changes in condition in the ACBMs.

Records were available documenting the most recent six-month periodic surveillance inspections. TRC recommends documenting these periodic inspections including date completed and signed by the trained person who conducted the inspection. Copies of these records should be entered into the management plan to satisfy the requirement to maintain and update the plan. The records should be maintained in a central location. The attached Appendix B can be copied and used as a basis for the re-inspection.

2.5 Warning Labels

As per the AHERA regulation section 763.95[a], "the LEA shall attach a warning label immediately adjacent to any friable and non-friable ACBM and suspected ACBM assumed to be asbestos-containing material (ACM) located in routine maintenance areas (such as boiler rooms) at each school building".

Warning labels on suspect friable materials were not observed in routine maintenance areas is not required at this school. The breeching and pipe insulation is non-ACM.

2.6 Summary of Response Actions

According to the LEA, there hasn't been any renovation work in the school in the last three years or since the last AHERA 3-year inspection performed in July 2017.

3.0 REINSPECTION EPA ASSESSMENT SUMMARY

3.1 ACBM Remaining

Asbestos-containing and assumed asbestos containing building materials remaining in the building includes:

Surfacing Materials

Suspect ACM plaster ceiling was observed in the Boy's and Girl's locker room. It is in good condition.

Thermal System Insulation

Suspect thermal system insulation was sampled and determined to be non-ACM

Miscellaneous Materials

Miscellaneous materials are in areas throughout the school building. Detailed locations, amounts and condition information can be found in Appendix B and C.

3.2 Additional ACBM Identified

No additional ACBM was identified during the reinspection.

3.3 Results and Recommendations

The identified ACBM remaining in the Thacher School was inspected and found to be in generally good condition. None of the materials were found to be damaged.

The remainder of the materials should continue to be maintained in place under the O & M plan until removal is made necessary by renovations or demolition.

4.0 CONCLUSIONS

The AHERA three-year reinspection at the Thacher School was performed on November 11, 2020 in accordance with the AHERA regulations. A management plan audit was performed with additional results and recommendations for correction and updating the management plan listed in Section 2 of this report.

The ACM/PACM was found to be in good condition with a low potential for damage.

Recommendations/schedule/Cost:

- a. There will be a cost for response actions between this re-inspection and the next. This is dependent on renovation and operation/maintenance activities. There will be a cost related to consulting services and abatement contractor services.
- b. There will be time associated with each six-month periodic inspection. It is anticipated that this activity would require half of a work shift including reporting documentation.

APPENDIX A

SCHOOL KEY PLAN

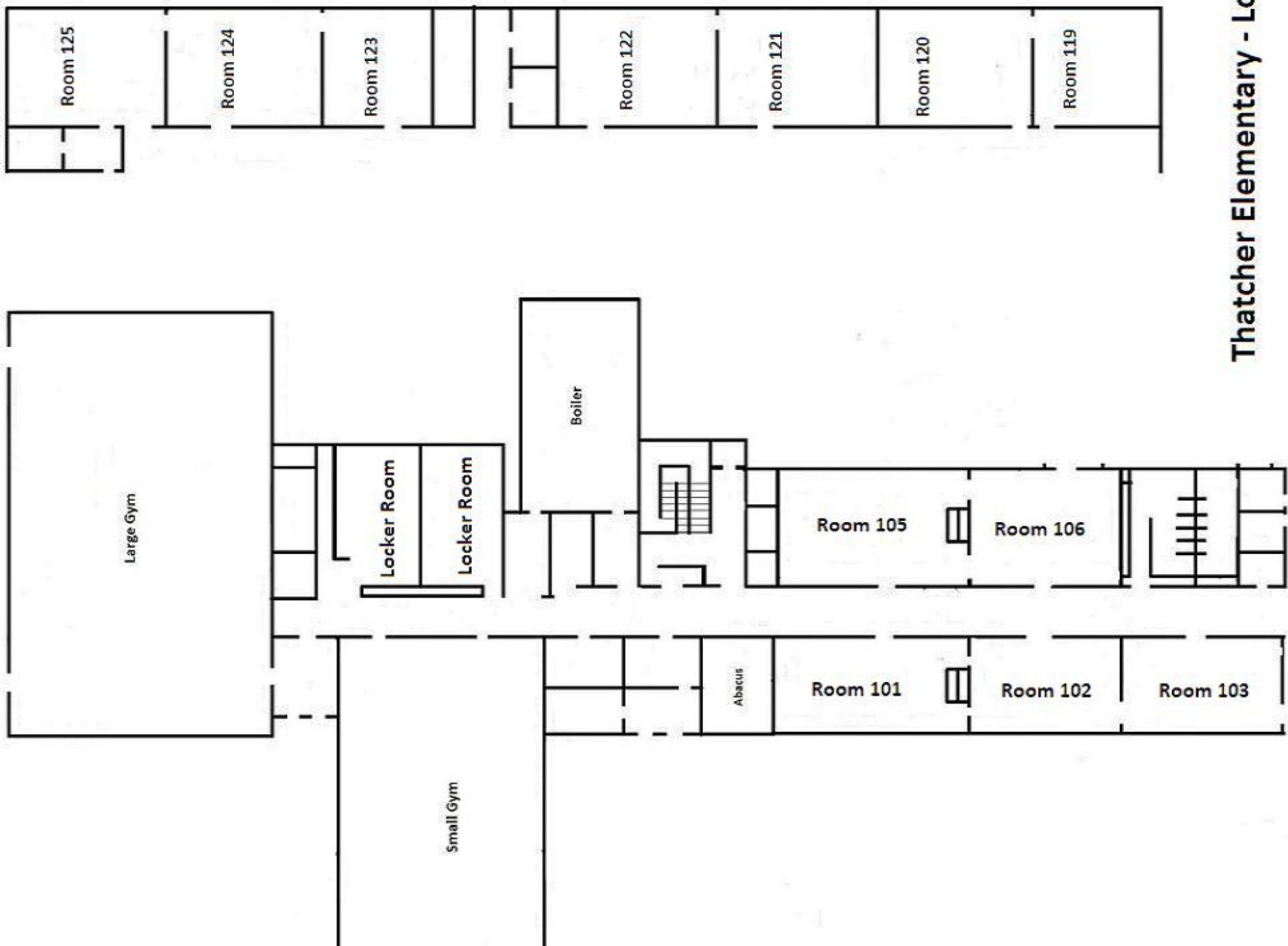

Thatcher Elementary - Lower

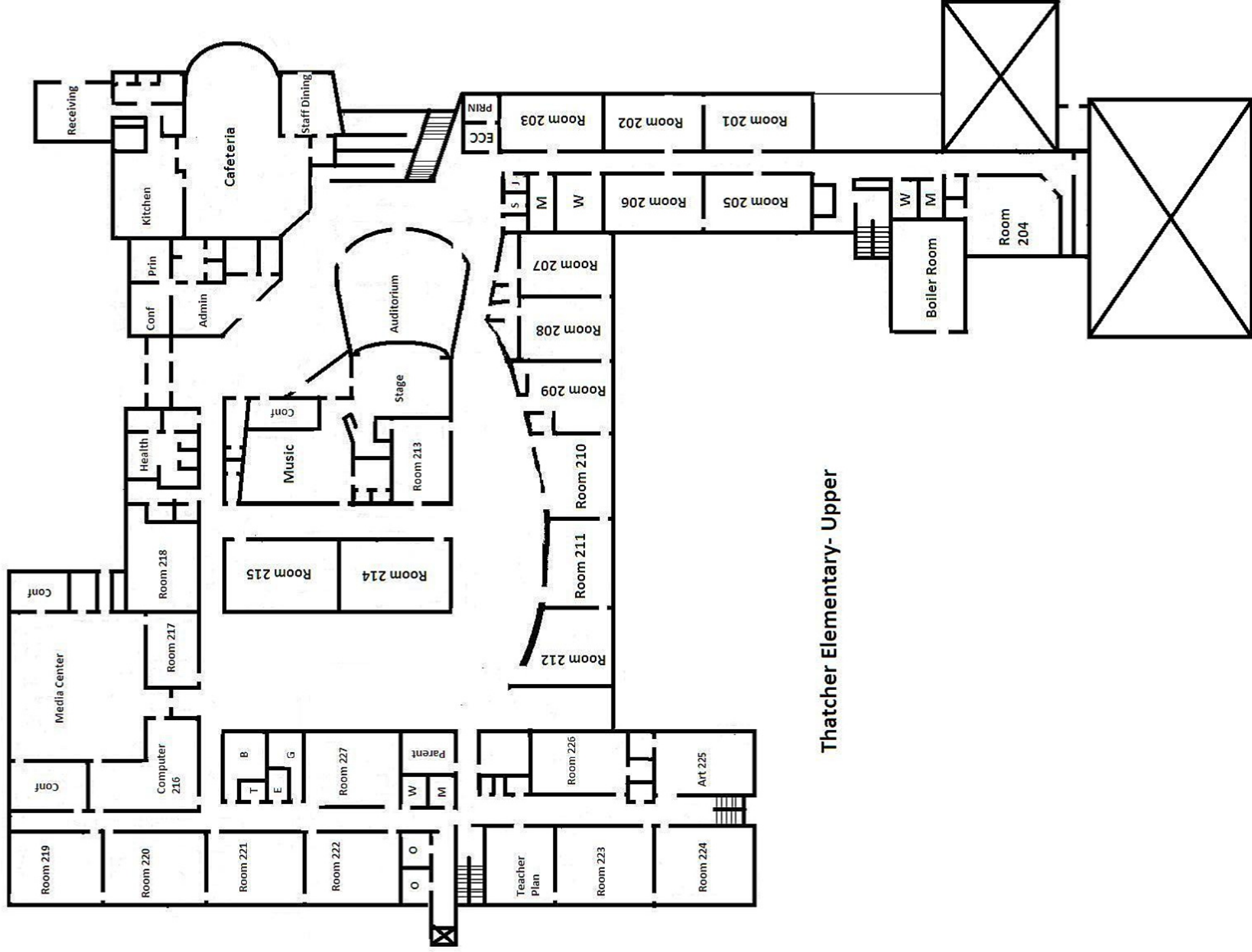

APPENDIX B
ACBM REMAINING

ACBM REMAINING

The following abbreviations were used in the Reinspection Assessment Table that follows:

SF = Square Feet; LF = Linear Feet; EA = Each

The assessment is divided into two categories. The physical assessment and the hazard potential assessment as follows:

PHYSICAL ASSESSMENT:

The physical assessment is divided into the following seven categories and describes the material condition at the time of the inspection:

- Physical Condition #1 - Damaged or significantly damaged thermal insulation.
- Physical Condition #2 Damaged friable surfacing ACM.
- Physical Condition #3 Significantly damaged friable surfacing ACM.
- Physical Condition #4 Damaged or significantly damaged friable miscellaneous ACM.
- Physical Condition #5 ACBM with potential for damage.
- Physical Condition #6 ACBM with potential for significant damage.
- Physical Condition #7 Any remaining friable ACBM or friable suspected ACBM.

HAZARD ASSESSMENT:

The hazard assessment is a combination of the physical assessment combined with the potential for disturbance (i.e. physical contact, vibration air movement) as follows:

- Hazard rank #1 – Good condition/Low potential for disturbance
- Hazard rank #2 – Good condition/ Moderate potential for disturbance
- Hazard rank #3 – Good condition/ High potential for disturbance
- Hazard rank #4 – Fair condition/Low potential for disturbance
- Hazard rank #5 – Fair condition/Moderate potential for disturbance
- Hazard rank #6 – Fair condition/ High potential for disturbance
- Hazard rank #7 – Poor condition (significant damage)

THACHER SCHOOL

**3-YEAR REINSPECTION
ASSESSMENT TABLE**

November 11, 2020

Project No. 413225

Location: Building-Floor/Room or Area	Type of Material	Quantity	Homogenous Area Number	Physical/Hazard Assessment	Condition	Friable/Non-Friable (F/NF)
Tile used as accent to majority of white VFT in classrooms, hallways offices and Common areas	12"x12" Purple accent tile	2,000 SF	HA-10	5/1	Good	NF
Boy's and Girl's locker room	Plaster white finish coat	700 SF	HA-16	5/1	Good	F
Boy's and Girl's locker room	Plaster gray base coat	700 SF	HA-17	5/1	Good	F
Bathrooms	1" multi-color ceramic tile grout	1,800 SF	HA-20	5/1	Good	NF
Bathrooms	1" multi-color ceramic tile adhesive	1,800 SF	HA-21	7/4	Good (where exposed)	NF
Stairwells and entryways	Vinyl dot stair	2,400 SF	HA-27	5/1	Good	NF
Stairwells and entryways	Mastic	2,400 SF	HA-28	5/1	Good	NF
Small Gym	Heavy duty black 4" cove base	900 LF	HA-34	5/1	Good	NF
Small Gym	Mastic	900 LF	HA-35	5/1	Good	NF
Smaller Gym	Tectum ceiling panels	5,000 SF	HA-36	5/1	Good	F

6- Month Periodic Re-inspection

Date Re-inspected: _____

Re-inspection done by: _____

Changes in Condition: _____

APPENDIX C
HOMOGENOUS AREA SAMPLING GUIDE

HOMOGENOUS AREA SAMPLING GUIDE

Note 1: Where mastic is listed, it is associated with the material above. (i.e. Floor tile is followed by mastic and cove base is followed by mastic etc).

<u>THACHER SCHOOL</u>							
3-YEAR REINSPECTION HOMOGENOUS MATERIAL TABLE							
November 11, 2020				Project No. 413225			
Homogenous Material Number	Material	Sampled (Yes/No)	ACM (yes/no)	Date Sampled	How Many Samples	Lab Doing Analysis	Lab Project Number
HA-1	2'x2' Textured pin hole ceiling tile	Yes	No	11/10/17	2	SanAir	17046311
HA-2	2'x2' Smooth speck ceiling tile	Yes	No	11/10/17	2	SanAir	17046311
HA 3	12"x12" White with tan VFT	Yes	No	11/10/17	2	SanAir	17046311
HA 4	Mastic	Yes	No	11/10/17	2	SanAir	17046311
HA-5	12"x12" White with green VFT	Yes	No	11/10/17	2	SanAir	17046311
HA-6	Mastic	Yes	No	11/10/17	2	SanAir	17046311
HA-7	12"x12" Yellow accent tile	Yes	No	11/11/20	2	TRC	0055969
HA-8	12"x12" Blue accent tile	Yes	No	11/10/17	2	SanAir	17046311
HA-9	12"x12" Aqua accent tile	Yes	No	11/10/17	2	SanAir	17046311
HA-10	12"x12" Purple accent tile	No	Assumed	NA	NA	NA	NA
HA-11	12"x12" Green accent tile	Yes	No	11/10/17	2	SanAir	17046311
HA-12	Blue cove base	Yes	No	11/10/17	2	SanAir	17046311
HA-13	Mastic	Yes	No	11/10/17	2	SanAir	17046311
HA-14	Sheetrock	Yes	No	11/10/17	5	SanAir	17046311

THACHER SCHOOL
3-YEAR REINSPECTION
HOMOGENOUS MATERIAL TABLE

November 11, 2020

Project No. 413225

Homogenous Material Number	Material	Sampled (Yes/No)	ACM (yes/no)	Date Sampled	How Many Samples	Lab Doing Analysis	Lab Project Number
HA-15	Joint compound	Yes	No	11/10/17	3	SanAir	17046311
HA-16	Plaster white finish coat	No	Assumed	NA	NA	NA	NA
HA-17	Plaster gray base coat	No	Assumed	NA	NA	NA	NA
HA-18	4" Off-white ceramic tile grout	Yes	No	11/11/20	2	TRC	0055969
HA-19	4" Off-white ceramic tile adhesive	Yes	No	11/11/20	2	TRC	0055969
HA-20	1" multi-color ceramic tile grout	No	Assumed	NA	NA	NA	NA
HA-21	1" multi-color ceramic tile adhesive	No	Assumed	NA	NA	NA	NA
HA-22	Black sink undercoating	Yes	No	11/11/20	2	TRC	0055969
HA-23	Wood door core	Yes	No	11/10/17	3	SanAir	17046311
HA-24	Breeching insulation	Yes	No	11/10/17	6	SanAir	17046311
HA-25	Generator exhaust insulation	Yes	No	11/10/17	6	SanAir	17046311
HA-26	Carpet mastic	Yes	No	11/11/20	2	TRC	0055969
HA-27	Vinyl dot stair	No	Assumed	NA	NA	NA	NA
HA-28	Mastic	No	Assumed	NA	NA	NA	NA
HA-29	Bulletin board (homosote)	Yes	No	11/10/17	2	SanAir	17046311
HA-30	2'x2' Sheetrock ceiling tile	Yes	No	11/10/17	2	SanAir	17046311

THACHER SCHOOL
3-YEAR REINSPECTION
HOMOGENOUS MATERIAL TABLE

November 11, 2020

Project No. 413225

Homogenous Material Number	Material	Sampled (Yes/No)	ACM (yes/no)	Date Sampled	How Many Samples	Lab Doing Analysis	Lab Project Number
HA-31	12"x12" White with green/brown chip VFT	Yes	No	11/10/17	2	SanAir	17046311
HA-32	Mastic	Yes	No	11/10/17	2	SanAir	17046311
HA-33	Coating on fiberglass insulation ends	Yes	No	11/10/17	3	SanAir	17046311
HA-34	Heavy duty black 4" cove base	No	Assumed	NA	NA	NA	NA
HA-35	Mastic	No	Assumed	NA	NA	NA	NA
HA-36	Tectum ceiling panels	No	Assumed	NA	NA	NA	NA
HA-37	Interior caulking (window to Concrete seam)	Yes	No	11/10/17	2	SanAir	17046311
HA-38	Interior caulking (Bulletin board to Concrete seam)	Yes	No	11/10/17	2	SanAir	17046311
HA-39	Interior window caulking	Yes	No	11/10/17	2	SanAir	17046311
HA-40	Textured ceiling	Yes	No	11/10/17	3	SanAir	17046311

NA – Not applicable

APPENDIX D

EPA AHERA SELF AUDIT CHECKLIST

AHERA Asbestos Management Plan Self-Audit Checklist for Designated Persons*	
School:	Phone:
Address:	
County:	
Local Education Agency:	Phone:
Address:	
Designated Person:	Phone:
Address:	
Date Checklist Completed by Designated Person:	
Designated Person's Signature:	
Yes No N/A <small>N/A - Not Applicable</small>	School:
General Information	
<input type="checkbox"/> <input type="checkbox"/> <input type="checkbox"/>	1. Has an Asbestos Management Plan been developed for your school? <div style="text-align: right;"><small>(40 CFR § 763.93)</small></div>
<input type="checkbox"/> <input type="checkbox"/> <input type="checkbox"/>	2. Does the Local Education Agency (LEA) have a complete and up-to-date copy of the school's management plan in both the LEA's administrative office and the school's administrative office? <div style="text-align: right;"><small>(40 CFR § 763.93(g)(2)-(3))</small></div>
<input type="checkbox"/> <input type="checkbox"/> <input type="checkbox"/>	3. Was the management plan developed by an accredited management planner? <div style="border: 1px solid black; padding: 5px; margin-top: 10px;"> <p>Did you know? Your LEA <i>may</i> require each management plan to contain a statement signed by an accredited management plan developer that he/she has prepared or assisted in the preparation of the plan or has reviewed the plan and that the plan is in compliance with 40 CFR 763, Subpart E. The management plan developer that signs the statement may not also implement the plan (40 CFR § 763.93(f)).</p> </div> <div style="text-align: right;"><small>(40 CFR § 763.93(e))</small></div>

*References to Model Asbestos Management Plan (AMP) forms are to the forms contained in EPA Region 2's guidance manual, published March 2004, entitled: "Model AHERA Asbestos Management Plan for Local Education Agencies." The Model AMP forms and this Self-Audit Checklist are not a substitute for the applicable legal requirements, are not regulations themselves, and are not required to be used/completed under AHERA. Rather, they are provided by EPA Region 2 as guidance to enhance schools' compliance with EPA AHERA regulations regarding the required documentation that must be included in the AMP. These documents do not impose legally binding requirements on any party, including EPA, states, or the regulated community, and are not intended and cannot be relied upon to create any rights, substantive or procedural, enforceable by any party in litigation with the United States. Please contact your state asbestos coordinator for any applicable state regulations/AMP Forms.



Yes No N/A <small>N/A - Not Applicable</small>	School:
<input type="checkbox"/> <input type="checkbox"/> <input type="checkbox"/>	<p>4. For each consultant who contributed to the management plan, does the plan include the following:</p> <ul style="list-style-type: none"> • consultant's name? • a statement that he/she is accredited under the state accreditation program or another state's accreditation program or an EPA-approved course? <p style="text-align: right;">(40 CFR § 763.93 (e)(12)(i)-(ii))</p> <p>Note: Although not required, EPA suggests including in the AMP the name of the training agency, the course name and date, and a copy of the accreditation certificate for each consultant.</p> <p>*Tip: See suggested Model AMP Form 1 - Contact Information</p>
<input type="checkbox"/> <input type="checkbox"/> <input type="checkbox"/>	<p>5. Does the management plan include a list of the name and address of each building used as a school building and identify whether the school building has:</p> <ul style="list-style-type: none"> • friable ACBM (asbestos-containing building material)? • non-friable ACBM? • friable and non-friable suspected ACBM assumed to be ACM (asbestos-containing material)? <p style="text-align: right;">(40 CFR §§ 763.93(a)(1)-(2) and 763.93(e)(1))</p> <p>*Tip: See Model AMP Form 2 - School Building List</p>
<input type="checkbox"/> <input type="checkbox"/> <input type="checkbox"/>	<p>6. If a new school building was constructed after October 12, 1988 and is asbestos-free, does the management plan include the following and has a copy of same been provided by the LEA to the EPA Regional Office:</p> <ul style="list-style-type: none"> • a statement signed by an architect or project engineer responsible for the construction of the building, or by an accredited inspector, indicating that no ACBM was specified as a building material in any construction document for the building, or, to the best of his or her knowledge, no ACBM was used as a building material in the building? <p style="text-align: right;">(40 CFR § 763.99(a)(7))</p> <p>*Tip: See Model AMP Form 2 - School Building List</p>
<input type="checkbox"/> <input type="checkbox"/> <input type="checkbox"/>	<p>7. Does the management plan include a copy of any of the statements required under 40 CFR § 763.99(a)(1)-(7) to support an exclusion from inspection that the school may qualify for under 40 CFR § 763.99 and has a copy of any such statement been provided by the LEA to the Regional Office?</p> <p style="text-align: right;">(40 CFR § 763.99)</p> <p>Note: The exclusion under 40 CFR § 763.99(a)(7) is also covered under Checklist question number 6.</p>



Yes No N/A N/A - Not Applicable	School:	
<input type="checkbox"/> <input type="checkbox"/> <input type="checkbox"/>	<p>8. Does the management plan include the following information about the LEA Designated Person (DP):</p> <ul style="list-style-type: none"> • Name, address, and telephone number of the DP? • Course name, dates, and hours of training that the DP attended to carry out his or her AHERA duties? • Signed statement by the DP that the LEA's general responsibilities under 40 CFR § 763.84 have been or will be met? <p style="text-align: right;">(40 CFR § 763.93(e)(4) and (i))</p> <p>Note: Although not required, EPA suggests including in the AMP the name of the training agency and a copy of the DP's training certificates.</p> <p>*Tip: See Model AMP Form 1 - Contact Information and Form 3 - Designated Person Assurances</p>	
<input type="checkbox"/> <input type="checkbox"/> <input type="checkbox"/>	<p>9. Does the management plan include the following recommendations:</p> <ul style="list-style-type: none"> • A plan for reinspection required under 40 CFR § 763.85? • A plan for operations and maintenance activities (including initial cleaning) required under 40 CFR § 763.91? • A plan for periodic surveillance required under 40 CFR § 763.92? • A description of the management planner's recommendation for additional cleaning under 40 CFR § 763.91(c)(2), as part of an operations and maintenance program, and the response of the LEA to that recommendation? <p style="text-align: right;">(40 CFR § 763.93(e)(9))</p> <p>*Tip: See Model AMP Form 10 - Plan for Reinspection, Form 14 - Plan for Operations and Maintenance Activities, Form 18 - Periodic Surveillance Plan/Report, and Form 16 Cleaning Record</p>	
<input type="checkbox"/> <input type="checkbox"/> <input type="checkbox"/>	<p>10. Does the management plan include an evaluation of resources needed to carry out response actions, reinspections, operations and maintenance, and periodic surveillance and training?</p> <p style="text-align: right;">(40 CFR § 763.93(e)(11))</p> <p>*Tip: See suggested Model AMP Form 4 - Evaluation of Resources</p>	
<input type="checkbox"/> <input type="checkbox"/> <input type="checkbox"/>	<p>11. Does the management plan include a record of the minimum 2 hours of awareness training required under 40 CFR § 763.92(a)(1) for all maintenance and custodial staff who may work in a building that contains ACBM, whether or not they are required to work with ACBM, and does the record include the following information:</p> <ul style="list-style-type: none"> • person's name and job title? • date training was completed? • location of training? • number of hours completed? <p style="text-align: right;">(40 CFR §§ 763.93(h) and 763.94(c))</p> <p>Note: Although not required, EPA suggests including in the AMP the name of the training agency, the course name, and a copy of the accreditation certificate for each staff person.</p> <p>*Tip: See Model AMP Form 5 - Training Record for Maintenance and Custodial Staff</p>	

Did you know? New custodial and maintenance employees must be trained within 60 days after starting work (40 CFR § 763.92(a)(1)).



Yes No N/A <small>N/A - Not Applicable</small>	School:
<input type="checkbox"/> <input type="checkbox"/> <input type="checkbox"/>	<p>12. Does the management plan include a record of the additional 14 hours of training required under 40 CFR § 763.92(a)(2) for maintenance and custodial staff who conduct any activities that will result in the disturbance of ACBM and does the record include the following information:</p> <ul style="list-style-type: none"> • person's name and job title? • date training was completed? • location of training? • number of hours completed? <p style="text-align: right;">(40 CFR §§ 763.93(h) and 763.94(c))</p> <p>Note: Although not required, EPA suggests including in the AMP the name of the training agency, the course name, and a copy of the accreditation certificate for each staff person.</p> <p>*Tip: See Model AMP Form 5 - Training Record for Maintenance and Custodial Staff</p>
Inspections and Reinspections	
<input type="checkbox"/> <input type="checkbox"/> <input type="checkbox"/>	<p>13. For inspections conducted before 12/14/87 (i.e., the effective date of the 10/30/87 EPA Asbestos-Containing Materials in Schools rule), does the management plan include the following information:</p> <ul style="list-style-type: none"> • date of inspection? • blueprint, diagram or written description of each school building that identifies clearly each location and approximate square or linear footage of homogenous /sampling area sampled for ACM? • if possible, the exact locations where the bulk samples were collected and the dates of collection? • a copy of the analyses of any bulk samples, dates of analyses, and a copy of any other laboratory reports pertaining to the analyses. • description of response actions or preventive measures taken, including, if possible, the names and addresses of all contractors, start and completion dates and air clearance sample results? • description of assessments of material identified prior to 12/14/87 as friable ACBM or friable suspected ACBM assumed to be ACM, and the name, signature, state of accreditation and if, applicable, the accreditation number of the person making the assessments (i.e., inspector)? <p style="text-align: right;">(40 CFR § 763.93(e)(2)(i)-(v))</p> <p>*Tip: See Model AMP Form 6 - Inspection Cover Sheet, Form 8 - Homogeneous Area/Bulk Sample Summary, Form 9 - Homogeneous Area/Bulk Sample Diagram, Form 12 - Implementation of Response Actions, and Form 7 - Room/Functional Space Assessment</p>
<input type="checkbox"/> <input type="checkbox"/> <input type="checkbox"/>	<p>14. Does the management plan include for each inspection and reinspection conducted under 40 CFR § 763.85 the following information:</p> <ul style="list-style-type: none"> • date of the inspection or reinspection? • name, signature, state of accreditation, and, if applicable, the accreditation number for each accredited inspector performing the inspection or reinspection? <p style="text-align: right;">(40 CFR § 763.93(e)(3)(i))</p> <p>Note: Although not required, EPA suggests including in the AMP the name of the training agency, the course name and date, and a copy of the accreditation certificate for each inspector.</p> <p>*Tip: See Model AMP Form 6 - Inspection Cover Sheet</p>



Yes No N/A <small>N/A - Not Applicable</small>	School:
<input type="checkbox"/> <input type="checkbox"/> <input type="checkbox"/>	<p>15. Does the management plan include for each inspection and reinspection conducted under 40 CFR § 763.85 the following sampling information:</p> <ul style="list-style-type: none"> • Blueprint, diagram, or written description of each school building that identifies clearly each location and approximate square or linear footage of homogeneous areas where material was sampled for ACM? • Exact location where each bulk sample was collected and the date of collection of each bulk sample? • Homogeneous areas where friable suspected ACBM is assumed to be ACM? • Homogeneous areas where nonfriable suspected ACBM is assumed to be ACM? • Description of the manner used to determine sampling locations? • The name, signature, state of accreditation, and, if applicable, the accreditation number for each accredited inspector that collected samples? <p style="text-align: right;">(40 CFR § 763.93(e)(3)(ii)-(iii))</p> <p>Note: For details on how to collect bulk samples, see 40 CFR § 763.86. Although not required, EPA suggests including in the AMP the name of the training agency, the course name and date, and a copy of the accreditation certificate for each inspector that collected the samples.</p> <p>*Tip: See Model AMP Form 6 - Inspection Cover Sheet, Form 8 - Homogeneous Area/Bulk Sample Summary, and Form 9 - Homogeneous Area/Bulk Sample Diagram</p>
<input type="checkbox"/> <input type="checkbox"/> <input type="checkbox"/>	<p>16. Does the management plan include for each inspection and reinspection conducted under 40 CFR § 763.85 the following information on the analysis of the bulk samples and has it been submitted to the DP for inclusion in the plan within 30 days of the analysis:</p> <ul style="list-style-type: none"> • Copy of the analysis of any bulk samples collected and analyzed? • Name and address of any laboratory that analyzed bulk samples? • A statement that any laboratory used meets the applicable laboratory accreditation requirements of 40 CFR § 763.87(a)? • Dates of any analyses performed? • Name and signature of the person performing each analysis? <p style="text-align: right;">(40 CFR §§ 763.87(d) and 763.93(e)(3)(iv))</p> <p>Note: For details on how to submit bulk samples for analysis, see 40 CFR § 763.87.</p>
<input type="checkbox"/> <input type="checkbox"/> <input type="checkbox"/>	<p>17. Does the management plan include for each inspection and reinspection conducted under 40 CFR § 763.85 the following assessment information and has it been submitted to the DP for inclusion in the plan within 30 days of the assessment:</p> <ul style="list-style-type: none"> • Written assessments (signed and dated) required to be made under 40 CFR § 763.88 of all ACBM and suspected ACBM assumed to be ACBM? • Name, signature, state of accreditation, and, if applicable, the accreditation number of each accredited person making the assessment (i.e., inspector(s)) <p style="text-align: right;">(40 CFR §§ 763.88(a)(2) and 763.93(c)(3)(v))</p> <p>Note: Although not required, EPA suggests including in the AMP the name of the training agency, the course name and date, and a copy of the accreditation certificate for each inspector making the assessment.</p> <p>*Tip: See Model AMP Form 6 - Inspection Cover Sheet and Form 7 - Room/Functional Space Assessment</p>



Yes No N/A N/A - Not Applicable	School:
<input type="checkbox"/> <input type="checkbox"/> <input type="checkbox"/>	<p>18. Has the following information about the inspection been recorded and submitted to the DP for inclusion in the management plan within 30 days of the inspection:</p> <ul style="list-style-type: none"> • Inspection report with the date of inspection signed by each accredited inspector making the inspection, the state of accreditation, and if applicable, his/her accreditation number? • Inventory of the locations of the homogeneous areas where samples are collected, exact location where each bulk sample is collected, dates that samples are collected, homogeneous areas where friable suspected ACBM is assumed to be ACM and homogeneous areas where nonfriable suspected ACBM is assumed to be ACM? • Description of the manner used to determine sampling locations, the name and signature of each accredited inspector who collected the samples, state of accreditation, and, if applicable, his or her accreditation number? • List of whether the homogeneous areas identified under 40 CFR § 763.85(a)(4)(vi)(B) of this section, are surfacing material, thermal system insulation, or miscellaneous material? • Assessments of friable material (signed and dated), the name and signature of each accredited inspector making the assessment, state of accreditation, and if applicable, his or her accreditation number? <p style="text-align: right;">(40 CFR §§ 763.85(a)(4)(vi)(A)-(E) and 763.88(a)(2))</p> <p>Note: For further details on activities conducted during an inspection (e.g., visually inspect/touch material), see 40 CFR § 763.85(a)(4)(i)-(v)</p> <p>*Tip: See Model AMP Form 6 - Inspection Cover Sheet, Form 7 - Room/Functional Space Assessment, Form 8 - Homogeneous Area/Bulk Sample Summary and Form 9 - Homogeneous Area /Bulk Sample Diagram</p>
<input type="checkbox"/> <input type="checkbox"/> <input type="checkbox"/>	<p>19. Has the following information about the reinspection been recorded and submitted to the DP for inclusion in the management plan within 30 days of the reinspection:</p> <ul style="list-style-type: none"> • Date of reinspection, name and signature of the person making the reinspection, state of accreditation, and if applicable, his or her accreditation number, and any changes in the condition of known or assumed ACBM? • Exact location where samples were collected during the reinspection, a description of the manner used to determine sampling locations, the name and signature of each accredited inspector who collected the samples, state of accreditation, and, if applicable, his or her accreditation number? • Any assessments or reassessments of friable material, date of the assessment or reassessment, the name and the signature of the accredited inspector making the assessments, state of accreditation, and if applicable, his or her accreditation number? <p style="text-align: right;">(40 CFR §§ 763.85(b)(3)(vii)(A) - (C) and 763.88(a)(2))</p> <p>Note: At least once every 3 years after a management plan has been in effect, a reinspection must be conducted by an accredited inspector of all friable and nonfriable known or assumed ACBM in each school building that the LEA leases, owns, or otherwise uses as a school building (40 CFR § 763.85(b)(1)-(2)). For further details on activities conducted during a reinspection (e.g., visually reinspect/touch material), see 40 CFR § 763.85(b)(3)(i)-(vi).</p> <p>*Tip: See Model AMP Form 6 - Inspection Cover Sheet, Form 7 - Room/Functional Space Assessment, Form 8 - Homogeneous Area/Bulk Sample Summary, Form 9 - Homogeneous Area /Bulk Sample Diagram</p>



Yes No N/A N/A - Not Applicable	School:	
Response Actions		
<input type="checkbox"/> <input type="checkbox"/> <input type="checkbox"/>	<p>20. Does the management plan include the recommendations made to the LEA regarding response actions under 40 CFR § 763.88(d) and the following information about the accredited management planner:</p> <ul style="list-style-type: none"> name, signature, state of accreditation, and, if applicable, the accreditation number for each accredited management planner making the recommendations? <p style="text-align: right;">(40 CFR §§ 763.88(d) and 763.93(e)(5))</p> <p>Note: Although not required, EPA suggests including in the AMP the name of the training agency, the course name and date, and a copy of the accreditation certificate for each accredited person making the recommendations.</p> <p>*Tip: See Model AMP Form 11 - Recommended Response Actions</p>	
<input type="checkbox"/> <input type="checkbox"/> <input type="checkbox"/>	<p>21. Does the management plan include a detailed description of preventive measures and response actions to be taken, including the following:</p> <div style="border: 1px solid black; padding: 5px; margin: 10px 0;"> <p>Did you know? The LEA may select, from the response actions which protect human health and the environment, the least burdensome action (40 CFR § 763.90(a)).</p> </div> <ul style="list-style-type: none"> Methods to be used for any friable ACBM? Locations where such measures and actions will be taken? Reasons for selecting the response action or preventive measure? Schedule for beginning and completing each preventive measure or response action? <p style="text-align: right;">(40 CFR § 763.93(e)(6))</p> <p>Note: For further details on how to conduct response actions, see 40 CFR § 763.90</p> <p>*Tip: See Model AMP Form 11 - Recommended Response Actions</p>	
<input type="checkbox"/> <input type="checkbox"/> <input type="checkbox"/>	<p>22. Does the management plan include one of the following statements for the person or persons who inspected for ACBM and who will design or carry out response actions, except for operations and maintenance, with respect to the ACBM:</p> <ul style="list-style-type: none"> statement that he/she is accredited under the state accreditation program, or that the LEA has used (or will use) persons accredited under another state's accreditation program or an EPA-approved course? <p style="text-align: right;">(40 CFR § 763.93(e)(7))</p> <p>*Tip: See note on Model AMP Form 3 - Designated Persons Assurances</p>	



Yes No N/A <small>N/A - Not Applicable</small>	School:
<input type="checkbox"/> <input type="checkbox"/> <input type="checkbox"/>	<p>23. Does the management plan include a detailed written description of each preventive measure and response action taken for friable and nonfriable ACM and friable and nonfriable suspected ACM assumed to be ACM, including the following:</p> <ul style="list-style-type: none"> • Methods used? • Location where the measure or action was taken? • Reasons for selecting the measure or action? • Start and completion dates of the work? • Names and addresses of all contractors involved and, if applicable, their state of accreditation and accreditation numbers? • If ACM is removed, the name and location of storage or disposal site of the ACM? <p style="text-align: right;">(40 CFR § 763.94(b)(1))</p> <p>Note: Although not required, EPA suggests including in the AMP a copy of the accreditation.</p> <p>*Tip: See Model AMP Form 12 - Implementation of Response Actions</p>
<input type="checkbox"/> <input type="checkbox"/> <input type="checkbox"/>	<p>24. Does the management plan include the following sampling information required to be collected at the completion of certain response actions specified by 40 CFR § 763.90(i):</p> <ul style="list-style-type: none"> • Name and signature of any person collecting any air sample required to be collected? • Locations where samples were collected? • Date of collection? • Name and address of the laboratory analyzing the samples? • Date of analysis? • Results of analysis? • Method of analysis? • Name and signature of the person performing the analysis? • Statement that the laboratory meets the applicable laboratory accreditation requirements of 40 CFR § 763.90(i)(2)(ii)? <p style="text-align: right;">(40 CFR § 763.94(b)(2))</p> <p>*Tip: See Model AMP Form 12 - Implementation of Response Actions</p>
<input type="checkbox"/> <input type="checkbox"/> <input type="checkbox"/>	<p>25. Does the management plan include a detailed description in the form of a blueprint, diagram, or written description, of any ACM or suspected ACM assumed to be ACM that remains in the school once response actions are undertaken under 40 CFR § 763.90 and is the description updated as response actions are completed?</p> <p style="text-align: right;">(40 CFR § 763.93(e)(8))</p>
<input type="checkbox"/> <input type="checkbox"/> <input type="checkbox"/>	<p>26. For each homogeneous area where all ACM has been removed, have records been retained in the management plan for at least 3 years after the next reinspection required under 40 CFR § 763.85(b)(1), or for an equivalent period?</p> <div style="border: 1px solid black; padding: 5px; margin-top: 10px;"> <p>Did you know? Significantly damaged friable surfacing ACM or significantly damaged friable miscellaneous ACM must be immediately isolated and access must be restricted unless isolation is not necessary to protect human health and the environment. Then, this material must be removed, or depending upon whether enclosure or encapsulation would be sufficient to protect human health and the environment, enclosed or encapsulated (40 CFR § 763.90(d)(1) - (2)).</p> </div> <p style="text-align: right;">(40 CFR §§ 763.93(h) and 763.94(a))</p>



Yes No N/A N/A - Not Applicable	School:
Operations and Maintenance	
<input type="checkbox"/> <input type="checkbox"/> <input type="checkbox"/>	<p>27. Does the management plan include a record of each cleaning conducted under 40 CFR § 763.91(c), including the following:</p> <ul style="list-style-type: none"> • Name of each person performing the cleaning? • Date of the cleaning? • Locations cleaned? • Methods used to perform the cleaning? <p style="text-align: right;">(40 CFR §§ 763.93(h) and 763.94(e))</p> <p>Note: For details on initial cleaning after an inspection and before the initiation of any response action, other than O&M activities or repair, see 40 CFR § 763.91(c)(1) and for details on any additional cleaning recommended by the management planner and approved by the LEA, see 40 CFR § 763.91(c)(2).</p> <p>*Tip: See Model AMP Form 16 - Cleaning Record</p>
<input type="checkbox"/> <input type="checkbox"/> <input type="checkbox"/>	<p>28. Does the management plan include a record of each O&M activity and major asbestos activity, with the following information:</p> <ul style="list-style-type: none"> • Name of each person performing the activity? • For a major asbestos activity, the name, signature, state of accreditation and, if applicable, the accreditation number of each person performing the activity? • Start and completion date of each activity? • Location of the activity? • Description of the activity including preventative measures used? • If ACBM is removed, the name and location of the storage and disposal site for the ACM? <p style="text-align: right;">(40 CFR §§ 763.93(h) and 763.94(f) and (g))</p> <p>Note: The response actions for any maintenance activities disturbing friable ACBM, other than small-scale, short-duration maintenance activities, must be designed by persons accredited to design response actions and conducted by persons accredited to conduct response actions (40 CFR § 763.91(e)). Although not required, EPA suggests including in the AMP a copy of the accreditation.</p> <p>*Tip: See Model AMP Form 15 - Operations and Maintenance Activities</p>
<input type="checkbox"/> <input type="checkbox"/> <input type="checkbox"/>	<p>29. Does the management plan include a record of each fiber release episode, whether major or minor, with the following information:</p> <ul style="list-style-type: none"> • Date and location of the episode? • Method of repair? • Preventive measure or response action taken? • Name of each person performing the work? • If ACBM is removed, the name and location of the storage and disposal site of the ACM? <p style="text-align: right;">(40 CFR §§ 763.93(h) and 763.94(h))</p> <p>Note: A major fiber release episode is the falling or dislodging of more than 3 square or linear feet of friable ACBM (40 CFR § 763.91(f)(2)). A minor fiber release episode is the falling or dislodging of 3 square or linear feet or less of friable ACBM (40 CFR § 763.91(f)(1)).</p> <p>*Tip: See Model AMP Form 17 - Major/Minor Fiber Release Episode Log</p>



Yes No N/A N/A - Not Applicable	School:	
Periodic Surveillance		
<input type="checkbox"/> <input type="checkbox"/> <input type="checkbox"/>	<p>30. Does the management plan include a record of each periodic surveillance performed under 40 CFR § 763.92(b), with the following information:</p> <ul style="list-style-type: none"> • Name of person performing the surveillance? • Date of the surveillance? • Any changes in the condition of the material? <p style="text-align: right;">(40 CFR §§ 763.92(b)(2)(ii)-(iii), 763.93(h) and 763.94(d))</p> <p>Note: A periodic surveillance of each school building must be conducted at least once every 6 months after a management plan has been in effect (40 CFR § 763.92(b)).</p> <p>*Tip: See Model AMP Form 18 - Periodic Surveillance Plan/Report</p>	
Notification		
<input type="checkbox"/> <input type="checkbox"/> <input type="checkbox"/>	<p>31. Does the management plan include the following notification information:</p> <ul style="list-style-type: none"> • Description of the steps taken to notify, in writing, at least once a year, parent, teacher and employee organizations of the availability of the management plan for review? • Dated copies of all such management plan availability notifications (e.g., letter, newsletter)? • Description of the steps taken to inform workers and building occupants, or their legal guardians, about inspections, reinspections, response actions, and post-response action activities, including periodic reinspection and surveillance activities that are planned or in progress? (Under 40 CFR § 763.84(c), the LEA must inform them about these activities at least once each school year.) <p style="text-align: right;">(40 CFR §§ 763.93(e)(10) and 763.93(g)(4))</p> <p>*Tip: See Model AMP Form 19 - Plan to Inform</p>	



Appendix A - Glossary

Unless otherwise noted with an asterisk (*), the following definitions contained in this Glossary can be found under 40 CFR § 763.83:

Act means the Toxic Substances Control Act (TSCA), 15 U.S.C. 2601, et seq.

Accessible when referring to asbestos-containing material means that the material is subject to disturbance by school building occupants or custodial or maintenance personnel in the course of their normal activities.

Accredited or *accreditation* when referring to a person or laboratory means that such person or laboratory is accredited in accordance with section 206 of Title II of the Act.

Air erosion means the passage of air over friable asbestos-containing building material (ACBM) which may result in the release of asbestos fibers.

Asbestos means the asbestiform varieties of: Chrysotile (serpentine); crocidolite (riebeckite); amosite (cummingtonite/grunerite); anthophyllite; tremolite; and actinolite.

Asbestos-containing material (ACM) when referring to school buildings means any material or product which contains more than 1 percent asbestos.

Asbestos-containing building material (ACBM) means surfacing ACM, thermal system insulation ACM, or miscellaneous ACM that is found in or on interior structural members or other parts of a school building.

Asbestos debris means pieces of ACBM that can be identified by color, texture, or composition, or means dust, if the dust is determined by an accredited inspector to be ACM.

Damaged friable miscellaneous ACM means friable miscellaneous ACM which has deteriorated or sustained physical injury such that the internal structure (cohesion) of the material is inadequate or, if applicable, which has delaminated such that its bond to the substrate (adhesion) is inadequate or which for any other reason lacks fiber cohesion or adhesion qualities. Such damage or deterioration may be illustrated by the separation of ACM into layers; separation of ACM from the substrate; flaking, blistering, or crumbling of the ACM surface; water damage; significant or repeated water stains, scrapes, gouges, mars or other signs of physical injury on the ACM. Asbestos debris originating from the ACBM in question may also indicate damage.

Damaged friable surfacing ACM means friable surfacing ACM which has deteriorated or sustained physical injury such that the internal structure (cohesion) of the material is inadequate or which has delaminated such that its bond to the substrate (adhesion) is inadequate, or which, for any other reason, lacks fiber cohesion or adhesion qualities. Such damage or deterioration may be illustrated by the separation of ACM into layers; separation of ACM from the substrate; flaking, blistering, or crumbling of the ACM surface; water damage; significant or repeated water stains, scrapes, gouges, mars or other signs of physical injury on the ACM. Asbestos debris originating from the ACBM in question may also indicate damage.

Damaged or significantly damaged thermal system insulation ACM means thermal system insulation ACM on pipes, boilers, tanks, ducts, and other thermal system insulation equipment where the insulation has lost its



structural integrity, or its covering, in whole or in part, is crushed, water-stained, gouged, punctured, missing, or not intact such that it is not able to contain fibers. Damage may be further illustrated by occasional punctures, gouges or other signs of physical injury to ACM; occasional water damage on the protective coverings/jackets; or exposed ACM ends or joints. Asbestos debris originating from the ACBM in question may also indicate damage.

Designated Person means a person appointed by the Local Education Agency (LEA), under 40 CFR § 763.84 (g), who is trained to ensure the proper implementation of AHERA in school buildings. *

Encapsulation means the treatment of ACBM with a material that surrounds or embeds asbestos fibers in an adhesive matrix to prevent the release of fibers, as the encapsulant creates a membrane over the surface (bridging encapsulant) or penetrates the material and binds its components together (penetrating encapsulant).

Enclosure means an airtight, impermeable, permanent barrier around ACBM to prevent the release of asbestos fibers into the air.

Fiber release episode means any uncontrolled or unintentional disturbance of ACBM resulting in visible emission.

Friable when referring to material in a school building means that the material, when dry, may be crumbled, pulverized, or reduced to powder by hand pressure, and includes previously nonfriable material after such previously nonfriable material becomes damaged to the extent that when dry it may be crumbled, pulverized, or reduced to powder by hand pressure.

Functional space means a room, group of rooms, or homogeneous area (including crawl spaces or the space between a dropped ceiling and the floor or roof deck above), such as classroom(s), a cafeteria, gymnasium, hallway(s), designated by a person accredited to prepare management plans, design abatement projects, or conduct response actions.

High-efficiency particulate air (HEPA) refers to a filtering system capable of trapping and retaining at least 99.97 percent of all monodispersed particles 0.3 μm in diameter or larger.

Homogeneous area means an area of surfacing material, thermal system insulation material, or miscellaneous material that is uniform in color and texture.

Local education agency (LEA) means: (1) Any local educational agency as defined in section 198 of the Elementary and Secondary Education Act of 1965 (20 U.S.C. 3381). (2) The owner of any nonpublic, nonprofit elementary, or secondary school building. (3) The governing authority of any school operated under the defense dependent's education system provided for under the Defense Dependents' Education Act of 1978 (20 U.S.C. 921, et seq.).

Miscellaneous ACM means miscellaneous material that is ACM in a school building.

Miscellaneous material means interior building material on structural components, structural members or fixtures, such as floor and ceiling tiles, and does not include surfacing material or thermal system insulation.



Nonfriable means material in a school building which when dry may not be crumbled, pulverized, or reduced to powder by hand pressure.

Operations and maintenance program means a program of work practices to maintain friable ACBM in good condition, ensure clean up of asbestos fibers previously released, and prevent further release by minimizing and controlling friable ACBM disturbance or damage.

Phase contrast microscopy (PCM) refers to the procedure outlined in NIOSH Method 7400 for the evaluation of fibers in air samples.*

Polarized light microscopy (PLM) refers to the method outlined in 40 CFR § 763, Appendix E to Subpart E, for the identification of asbestos in bulk samples.*

Potential damage means circumstances in which: (1) Friable ACBM is in an area regularly used by building occupants, including maintenance personnel, in the course of their normal activities. (2) There are indications that there is a reasonable likelihood that the material or its covering will become damaged, deteriorated, or delaminated due to factors such as changes in building use, changes in operations and maintenance practices, changes in occupancy, or recurrent damage.

Potential significant damage means circumstances in which: (1) Friable ACBM is in an area regularly used by building occupants, including maintenance personnel, in the course of their normal activities. (2) There are indications that there is a reasonable likelihood that the material or its covering will become significantly damaged, deteriorated, or delaminated due to factors such as changes in building use, changes in operations and maintenance practices, changes in occupancy, or recurrent damage. (3) The material is subject to major or continuing disturbance, due to factors including, but not limited to, accessibility or, under certain circumstances, vibration or air erosion.

Preventive measures means actions taken to reduce disturbance of ACBM or otherwise eliminate the reasonable likelihood of the material's becoming damaged or significantly damaged.

Removal means the taking out or the stripping of substantially all ACBM from a damaged area, a functional space, or a homogeneous area in a school building.

Repair means returning damaged ACBM to an undamaged condition or to an intact state so as to prevent fiber release.

Response action means a method, including removal, encapsulation, enclosure, repair, operations and maintenance, that protects human health and the environment from friable ACBM.

Routine maintenance area means an area, such as a boiler room or mechanical room, that is not normally frequented by students and in which maintenance employees or contract workers regularly conduct maintenance activities.

School means any elementary or secondary school as defined in section 198 of the Elementary and Secondary Education Act of 1965 (20 U.S.C. 2854).



School building means: (1) Any structure suitable for use as a classroom, including a school facility such as a laboratory, library, school eating facility, or facility used for the preparation of food. (2) Any gymnasium or other facility which is specially designed for athletic or recreational activities for an academic course in physical education. (3) Any other facility used for the instruction or housing of students or for the administration of educational or research programs. (4) Any maintenance, storage, or utility facility, including any hallway, essential to the operation of any facility described in this definition of "school building" under paragraphs (1), (2), or (3). (5) Any portico or covered exterior hallway or walkway. (6) Any exterior portion of a mechanical system used to condition interior space.

Significantly damaged friable miscellaneous ACM means damaged friable miscellaneous ACM where the damage is extensive and severe.

Significantly damaged friable surfacing ACM means damaged friable surfacing ACM in a functional space where the damage is extensive and severe.

State means a State, the District of Columbia, the Commonwealth of Puerto Rico, Guam, American Samoa, the Northern Marianas, the Trust Territory of the Pacific Islands, and the Virgin Islands.

Surfacing ACM means surfacing material that is ACM.

Surfacing material means material in a school building that is sprayed-on, troweled-on, or otherwise applied to surfaces, such as acoustical plaster on ceilings and fireproofing materials on structural members, or other materials on surfaces for acoustical, fireproofing, or other purposes.

Thermal system insulation (TSI) means material in a school building applied to pipes, fittings, boilers, breeching, tanks, ducts, or other interior structural components to prevent heat loss or gain, or water condensation, or for other purposes.

Thermal system insulation ACM means thermal system insulation that is ACM.

Transmission electron microscopy (TEM) refers to the method outlined in 40 CFR § 763, Appendix A to Subpart E, for the identification of asbestos in air samples.*

Vibration means the periodic motion of friable ACBM which may result in the release of asbestos fibers.



Appendix B - Acronyms

ACM - Asbestos-containing material

ACBM - Asbestos-containing building material

AHERA - Asbestos Hazard Emergency Response Act

DOT - Department of Transportation

DP - AHERA Designated Person

EPA - U.S. Environmental Protection Agency

HEPA - High-efficiency particulate air

LEA - Local Education Agency

NIOSH - National Institute for Occupational Safety and Health

NIST - National Institute of Standards and Technology

NVLAP - National Voluntary Laboratory Accreditation Program

O&M - Operations and maintenance

OSHA - Occupational Safety and Health Administration

PCM - Phase contrast microscopy

PLM - Polarized light microscopy

TEM - Transmission electron microscopy

TSI - Thermal system insulation



APPENDIX E

MANAGEMENT PLANNER TRAINING INFORMATION

MANAGEMENT PLANNER INFORMATION

MANAGEMENT PLANNER: Gregory Hatch

COMPANY: TRC Environmental
814 Broad Street
Weymouth, MA 02189
(781) 337-0016

SIGNATURE  _____

DATE November 15, 2020

Accredited Course: Asbestos Management
Planner Training

State of
Accreditation: Massachusetts

Training
Provided By: Kaselaan & D'Angelo

Refresher Course
Training Provided
By: TRC Environmental

Refresher Course
Certificate #: MA 112019-0002

State Certification #: AP 061534

Date of Certification: 2/21/20

APPENDIX F

MEMO TO PARENTS



September 1, 2020

To: Parents, Guardians, Teachers, Students, Building Occupants, and Employee Organizations

From: Marc Furtado, Director of Finance of the Attleboro School District

Re: AHERA Yearly Notification

In the past, asbestos was used extensively in building materials because of its insulating, sound absorbing, and fire retarding capabilities. Virtually any building constructed before the late 1970s contained some asbestos. Intact and undisturbed asbestos materials generally do not pose a health risk. Asbestos materials, however, can become hazardous when, due to damage or deterioration over time, they release fibers. If the fibers are inhaled, they can lead to health problems such as cancer or asbestosis.

In 1986, Congress passed the Asbestos Hazard Emergency Response Act (AHERA) which requires schools to be inspected to identify any asbestos containing building materials. Suspected asbestos-containing building materials were located, sampled (or assumed) and rated according to condition and potential hazard. Every three years, the Attleboro Public School District has conducted a re-inspection to determine whether the condition of the known or assumed asbestos-containing building materials (ACBM) has changed and to make recommendations on managing or removing the ACBM.

The law further requires an asbestos management plan to be in place by July 1989. The Attleboro Public School District developed a plan, as required, which has been continually updated. The plan has several ongoing requirements: publish a notification on management plan and how to deal with it; notify short term or temporary workers on the locations of the ACBM; post warning labels in routine maintenance areas where asbestos was previously identified or assumed; follow set plans and procedures designed to minimize the disturbance of the ACBM; and survey the condition of the materials every six months to assure that they remain in good condition.

It is the intention of the Attleboro Public School District to comply with all federal and state regulations and to take whatever steps are necessary to ensure students and employees a healthy and safe environment in which to learn and work.

A copy of the AHERA management plan for the Attleboro School District is available for review in the facilities office and the individual school offices during regular school hours. Any inquiries regarding asbestos containing materials in our schools should be directed to our AHERA Designated Person Jason Parenteau, who can be reached at the Facilities Office and at jason.parenteau@sodexo.com or (508) 226-1169 with any questions.

APPENDIX G

SAMPLE ANALYSIS REPORTS



BULK ASBESTOS ANALYSIS REPORT

CLIENT: Attleboro School Department

Lab Log #: 0055969
Project #: 413225.0002.0000
Date Received: 11/12/2020
Date Analyzed: 11/13/2020

Site: Peter Thacher Elementary School, 160 James Street, Attleboro, MA

POLARIZED LIGHT MICROSCOPY by EPA 600/R-93/116

Sample No.	Color	Homogenous	Multi-Layered	Layer No.	Other Matrix Materials		Asbestos %	Asbestos Type
111120-01A	White (4" ceramic tile grout)	Yes	No	--	---		ND	None
111120-01B	White (4" ceramic tile grout)	Yes	No	--	---		ND	None
111120-02A	Off White (4" ceramic tile mudset)	Yes	No	--	---		ND	None
111120-02B	Off White (4" ceramic tile mudset)	Yes	No	--	---		ND	None
111120-03A	Black (mastic)	No	Yes	1	10%	cellulose	ND	None
111120-03A	Yellow (12x12 vinyl floor tile)	No	Yes	2	---		ND	None
111120-03B	Black (mastic)	No	Yes	1	10%	cellulose	ND	None
111120-03B	Yellow (12x12 vinyl floor tile)	No	Yes	2	---		ND	None
111120-04A	Yellow (carpet mastic)	Yes	No	--	---		ND	None
111120-04B	Yellow (carpet mastic)	Yes	No	--	---		ND	None
111120-05A	Black (sink undercoat)	Yes	No	--	20%	cellulose	ND	None
111120-05B	Black (sink undercoat)	Yes	No	--	20%	cellulose	ND	None

TRC LABORATORY ASBESTOS ANALYTICAL ACCREDITATIONS

NVLAP Lab Code 101424-0
RI #PLM0007 TX #300354
CO# AL-15020

AIHA-LAP, LLC #100122 CT #PH-0426
VT #AL910359 LA#05011 VA #3333 000283
PHIL# 461 PA#68-03387

ME LA-0075, LB-0071 MA #AA000052 NY #10980 WV #000622
AZ #A20944 HI #L-09-004 NJ #CT004 CA #2907



POLARIZED LIGHT MICROSCOPY by EPA 600/R-93/116

Sample No.	Color	Homogenous	Multi-Layered	Layer No.	Other Matrix Materials	Asbestos %	Asbestos Type
------------	-------	------------	---------------	-----------	------------------------	------------	---------------

Reporting limit- asbestos present at 1%

ND - asbestos was not detected

Trace - asbestos was observed at level of less than 1%

NA/PS - Not Analyzed / Positive Stop

SNA- Sample Not Analyzed- See Chain of Custody for details

Note: Polarized-light microscopy is not consistently reliable in detecting asbestos in floor coverings and similar non-friable organically bound materials. In those cases, EPA recommends, and certain states (e.g. NY) require, that negative results be confirmed by quantitative transmission electron microscopy.

The Laboratory at TRC follows the EPA's Interim Method for the Determination of Asbestos in Bulk Insulation 1982 (EPA 600/M4-82-020) Bulk Analysis Code 18/A01 and the EPA recommended Method for the Determination of Asbestos in Bulk Building Materials July 1993, R.L. Perkins and B.W. Harvey, (EPA/600/R-93/116) Bulk Analysis Code 18/A03, which utilize polarized light microscopy (PLM). Our analysts have completed an accredited course in asbestos identification. TRC's Laboratory is accredited under the National Voluntary Laboratory Accreditation Program (NVLAP), for Bulk Asbestos Fiber Analysis, NVLAP Code 18/A01, effective through June 30, 2021. TRC is accredited by the AIHA Laboratory Accreditation Programs (AIHA-LAP), LLC in the Industrial Hygiene Program (IHLAP) for PLM effective through October 1, 2020. Asbestos content is determined by visual estimate unless otherwise indicated. Quality Control is performed in-house on at least 10% of samples and QC data related to the samples is available upon written request from client.

This report shall not be reproduced, except in full, without the written approval of TRC. This report must not be used by the client to claim product endorsement by NVLAP or any agency of the U.S. Government. This report relates only to the items tested.

Analyzed by: K. Williamson

Kathleen Williamson, Laboratory Manager

Reviewed by: Joel Corso

Joel Corso, Approved Signatory

Date Issued

11/13/2020

TRC LABORATORY ASBESTOS ANALYTICAL ACCREDITATIONS

NVLAP Lab Code 101424-0
RI #PLM0007 TX #300354
CO# AL-15020

AIHA-LAP, LLC #100122 CT #PH-0426
VT #AL910359 LA#05011 VA #3333 000283
PHIL# 461 PA#68-03387

ME LA-0075, LB-0071
AZ #A20944

MA #AA000052
HI #L-09-004

NY #10980 WV #000622
NJ #CT004 CA #2907

TRC
814 Broad Street
Weymouth, MA 02189
Phone: 781-337-0016

Results to: mmccaffrey@trccompanies.com
ghatch@trccompanies.com
Page 1 of 1
BULK SAMPLE CHAIN OF CUSTODY

<input type="checkbox"/> PCB	AMEN 62	Laboratory ID:
Special Instructions:		email:

[illegible]

SanAir Technologies Laboratory

Analysis Report

prepared for

AEC Laboratories, LLC

Report Date: 11/21/2017
Project Name: Thatcher Elementary
School
Project #: 22427
SanAir ID#: 17046311



NVLAP LAB CODE 200870-0



Certification # 652931



License # LAB0166



804.897.1177

www.sanair.com



SanAir Technologies Laboratory, Inc.

1551 Oakbridge Drive, Suite B, Powhatan, VA 23139
804.897.1177 Toll Free: 888.895.1177 Fax: 804.897.0070
Web: <http://www.sanair.com> E-mail: iaq@sanair.com

AEC Laboratories, LLC
814 Broad Street
Weymouth, MA 02189

November 21, 2017

SanAir ID # 17046311
Project Name: Thacher Elementary School
Project Number: 22427

Dear G. Hatch,

We at SanAir would like to thank you for the work you recently submitted. The 56 sample(s) were received on Tuesday, November 14, 2017 via FedEx. The final report(s) is enclosed for the following sample(s): 11107-01A, 11107-01B, 11107-02A, 11107-02B, 11107-03A, 11107-03B, 11107-04A, 11107-04B, 11107-05A, 11107-05B, 11107-06A, 11107-06B, 11107-07A, 11107-07B, 11107-08A, 11107-08B, 11107-09A, 11107-09B, 11107-10A, 11107-10B, 11107-11A, 11107-11B, 11107-11C, 11107-12A, 11107-12B, 11107-12C, 11107-13A, 11107-13B, 11107-14A, 11107-14B, 11107-15A, 11107-15B, 11107-16A, 11107-16B, 11107-17A, 11107-17B, 11107-18A, 11107-18B, 11107-19A, 11107-19B, 11107-19C, 11107-20A, 11107-20B, 11107-20C, 11107-21A, 11107-21B, 11107-21C, 11107-22A, 11107-22B, 11107-22C, 11107-23A, 11107-23B, 11107-23C, 11107-24A, 11107-24B, 11107-24C.

These results only pertain to this job and should not be used in the interpretation of any other job. This report is only complete in its entirety. Refer to the listing below of the pages included in a complete final report.

Sincerely,

Sandra Sobrino
Asbestos & Materials Laboratory Manager
SanAir Technologies Laboratory

Final Report Includes:

- Cover Letter
- Analysis Pages
- Disclaimers and Additional Information

sample conditions:

3 sample(s) in Discrepancy w/ COC condition 52 sample(s) in Good condition 1 sample(s) in Layer Missing condition



SanAir Technologies Laboratory, Inc.

1551 Oakbridge Drive, Suite B, Powhatan, VA 23139
804.897.1177 Toll Free: 888.895.1177 Fax: 804.897.0070
Web: <http://www.sanair.com> E-mail: iaq@sanair.com

SanAir ID Number

17046311

FINAL REPORT

Name: AEC Laboratories, LLC
Address: 814 Broad Street
Weymouth, MA 02189

Project Number: 22427
P.O. Number:
Project Name: Thacher Elementary School

Collected Date: 11/10/2017
Received Date: 11/14/2017 10:25:00 AM
Report Date: 11/21/2017 2:36:40 PM
Analyst: Wilson, Johnathan

Asbestos Bulk PLM EPA 600/R-93/116

SanAir ID / Description	Stereoscopic Appearance	Components		Asbestos Fibers
		% Fibrous	% Non-Fibrous	
11107-01A / 17046311-001 Storage 0 Room 12X12 VFT	White Non-Fibrous Homogeneous		100% Other	None Detected

SanAir ID / Description	Stereoscopic Appearance	Components		Asbestos Fibers
		% Fibrous	% Non-Fibrous	
11107-01B / 17046311-002 Jan. Closet At Main Lobby 12X12 VFT	White Non-Fibrous Homogeneous		100% Other	None Detected

SanAir ID / Description	Stereoscopic Appearance	Components		Asbestos Fibers
		% Fibrous	% Non-Fibrous	
11107-02A / 17046311-003 Storage 0 Room Mastic	Black Non-Fibrous Homogeneous	3% Cellulose	97% Other	None Detected

SanAir ID / Description	Stereoscopic Appearance	Components		Asbestos Fibers
		% Fibrous	% Non-Fibrous	
11107-02B / 17046311-004 Jan. Closet At Main Lobby Mastic	Black Non-Fibrous Homogeneous	3% Cellulose	97% Other	None Detected

SanAir ID / Description	Stereoscopic Appearance	Components		Asbestos Fibers
		% Fibrous	% Non-Fibrous	
11107-03A / 17046311-005 Extra Tiles In Janitor Storage 12X12 VFT	Blue Non-Fibrous Homogeneous		100% Other	None Detected

SanAir ID / Description	Stereoscopic Appearance	Components		Asbestos Fibers
		% Fibrous	% Non-Fibrous	
11107-03B / 17046311-006 Extra Tiles In Janitor Storage 12X12 VFT	Blue Non-Fibrous Homogeneous		100% Other	None Detected

SanAir ID / Description	Stereoscopic Appearance	Components		Asbestos Fibers
		% Fibrous	% Non-Fibrous	
11107-04A / 17046311-007 Extra Tiles In Janitor Storage 12X12 VFT	Aqua Non-Fibrous Homogeneous		100% Other	None Detected

Certification

Analyst: 

Analysis Date: 11/21/2017

Approved Signatory: 

Date: 11/21/2017

Page 3 of 15



SanAir Technologies Laboratory, Inc.

1551 Oakbridge Drive, Suite B, Powhatan, VA 23139
804.897.1177 Toll Free: 888.895.1177 Fax: 804.897.0070
Web: <http://www.sanair.com> E-mail: iaq@sanair.com

SanAir ID Number

17046311

FINAL REPORT

Name: AEC Laboratories, LLC
Address: 814 Broad Street
Weymouth, MA 02189

Project Number: 22427
P.O. Number:
Project Name: Thacher Elementary School

Collected Date: 11/10/2017
Received Date: 11/14/2017 10:25:00 AM
Report Date: 11/21/2017 2:36:40 PM
Analyst: Wilson, Johnathan

Asbestos Bulk PLM EPA 600/R-93/116

SanAir ID / Description	Stereoscopic Appearance	Components		Asbestos Fibers
		% Fibrous	% Non-Fibrous	
11107-04B / 17046311-008 Extra Tiles In Janitor Storage 12X12 VFT	Aqua Non-Fibrous Homogeneous		100% Other	None Detected

SanAir ID / Description	Stereoscopic Appearance	Components		Asbestos Fibers
		% Fibrous	% Non-Fibrous	
11107-05A / 17046311-009 Extra Tiles In Janitor Storage 12X12 VFT	Green Non-Fibrous Homogeneous		100% Other	None Detected

SanAir ID / Description	Stereoscopic Appearance	Components		Asbestos Fibers
		% Fibrous	% Non-Fibrous	
11107-05B / 17046311-010 Extra Tiles In Janitor Storage 12X12 VFT	Green Non-Fibrous Homogeneous		100% Other	None Detected

SanAir ID / Description	Stereoscopic Appearance	Components		Asbestos Fibers
		% Fibrous	% Non-Fibrous	
11107-06A / 17046311-011 Janitor Storage 12X12 VFT	Various Non-Fibrous Homogeneous		100% Other	None Detected

SanAir ID / Description	Stereoscopic Appearance	Components		Asbestos Fibers
		% Fibrous	% Non-Fibrous	
11107-06B / 17046311-012 Janitor Storage 12X12 VFT	Various Non-Fibrous Homogeneous		100% Other	None Detected

SanAir ID / Description	Stereoscopic Appearance	Components		Asbestos Fibers
		% Fibrous	% Non-Fibrous	
11107-07A / 17046311-013 Jan. Closet At Lobby 2'X2' Textured Ceiling Tile	White Fibrous Homogeneous	70% Cellulose 20% Glass	10% Other	None Detected

SanAir ID / Description	Stereoscopic Appearance	Components		Asbestos Fibers
		% Fibrous	% Non-Fibrous	
11107-07B / 17046311-014 Store Room N 2'X2' Textured Ceiling Tile	White Fibrous Homogeneous	70% Cellulose 20% Glass	10% Other	None Detected

Certification

Analyst: 

Analysis Date: 11/21/2017

Approved Signatory: 

Date: 11/21/2017

Page 4 of 15



SanAir Technologies Laboratory, Inc.

1551 Oakbridge Drive, Suite B, Powhatan, VA 23139
804.897.1177 Toll Free: 888.895.1177 Fax: 804.897.0070
Web: <http://www.sanair.com> E-mail: iaq@sanair.com

SanAir ID Number

17046311

FINAL REPORT

Name: AEC Laboratories, LLC
Address: 814 Broad Street
Weymouth, MA 02189

Project Number: 22427
P.O. Number:
Project Name: Thacher Elementary School

Collected Date: 11/10/2017
Received Date: 11/14/2017 10:25:00 AM
Report Date: 11/21/2017 2:36:40 PM
Analyst: Wilson, Johnathan

Asbestos Bulk PLM EPA 600/R-93/116

SanAir ID / Description	Stereoscopic Appearance	Components		Asbestos Fibers
		% Fibrous	% Non-Fibrous	
11107-08A / 17046311-015 Room 202 2'X2' Ceiling Tile	White Fibrous Homogeneous	70% Cellulose 20% Glass	10% Other	None Detected

SanAir ID / Description	Stereoscopic Appearance	Components		Asbestos Fibers
		% Fibrous	% Non-Fibrous	
11107-08B / 17046311-016 Room 201 2'X2' Ceiling Tile	White Fibrous Homogeneous	70% Cellulose 20% Glass	10% Other	None Detected

SanAir ID / Description	Stereoscopic Appearance	Components		Asbestos Fibers
		% Fibrous	% Non-Fibrous	
11107-09A / 17046311-017 Room 202 Cove Base	Blue Non-Fibrous Homogeneous		100% Other	None Detected

SanAir ID / Description	Stereoscopic Appearance	Components		Asbestos Fibers
		% Fibrous	% Non-Fibrous	
11107-09B / 17046311-018 Room 201 Cove Base	Blue Non-Fibrous Homogeneous		100% Other	None Detected

SanAir ID / Description	Stereoscopic Appearance	Components		Asbestos Fibers
		% Fibrous	% Non-Fibrous	
11107-10A / 17046311-019 Room 202 Mastic	Tan Non-Fibrous Homogeneous		100% Other	None Detected

SanAir ID / Description	Stereoscopic Appearance	Components		Asbestos Fibers
		% Fibrous	% Non-Fibrous	
11107-10B / 17046311-020 Room 201 Mastic	Tan Non-Fibrous Homogeneous		100% Other	None Detected

SanAir ID / Description	Stereoscopic Appearance	Components		Asbestos Fibers
		% Fibrous	% Non-Fibrous	
11107-11A / 17046311-021 Storage Room N Sheetrock, Sheetrock	Off-White Non-Fibrous Homogeneous	10% Cellulose 3% Glass	87% Other	None Detected
11107-11A / 17046311-021 Storage Room N Sheetrock, Plaster	Grey Non-Fibrous Homogeneous		100% Other	None Detected

Certification

Analyst: 

Analysis Date: 11/21/2017

Approved Signatory: 

Date: 11/21/2017

Page 5 of 15



SanAir Technologies Laboratory, Inc.

1551 Oakbridge Drive, Suite B, Powhatan, VA 23139
804.897.1177 Toll Free: 888.895.1177 Fax: 804.897.0070
Web: <http://www.sanair.com> E-mail: iaq@sanair.com

SanAir ID Number

17046311

FINAL REPORT

Name: AEC Laboratories, LLC
Address: 814 Broad Street
Weymouth, MA 02189

Project Number: 22427
P.O. Number:
Project Name: Thacher Elementary School

Collected Date: 11/10/2017
Received Date: 11/14/2017 10:25:00 AM
Report Date: 11/21/2017 2:36:40 PM
Analyst: Wilson, Johnathan

Asbestos Bulk PLM EPA 600/R-93/116

SanAir ID / Description	Stereoscopic Appearance	Components		Asbestos Fibers
		% Fibrous	% Non-Fibrous	
11107-11B / 17046311-022 Janitor Closet Sheetrock, Sheetrock	Off-White Non-Fibrous Homogeneous	10% Cellulose 3% Glass	87% Other	None Detected
11107-11B / 17046311-022 Janitor Closet Sheetrock, Plaster	Grey Non-Fibrous Homogeneous		100% Other	None Detected

SanAir ID / Description	Stereoscopic Appearance	Components		Asbestos Fibers
		% Fibrous	% Non-Fibrous	
11107-11C / 17046311-023 Room 210 Sheetrock, Sheetrock				Not Submitted
11107-11C / 17046311-023 Room 210 Sheetrock, Plaster	Grey Non-Fibrous Homogeneous		100% Other	None Detected

SanAir ID / Description	Stereoscopic Appearance	Components		Asbestos Fibers
		% Fibrous	% Non-Fibrous	
11107-12A / 17046311-024 Storage Room N, Skim Coat	White Non-Fibrous Homogeneous		100% Other	None Detected

SanAir ID / Description	Stereoscopic Appearance	Components		Asbestos Fibers
		% Fibrous	% Non-Fibrous	
11107-12B / 17046311-025 Janitor Closet, Skim Coat	White Non-Fibrous Homogeneous		100% Other	None Detected

SanAir ID / Description	Stereoscopic Appearance	Components		Asbestos Fibers
		% Fibrous	% Non-Fibrous	
11107-12C / 17046311-026 Room 210, Skim Coat	White Non-Fibrous Homogeneous		100% Other	None Detected

SanAir ID / Description	Stereoscopic Appearance	Components		Asbestos Fibers
		% Fibrous	% Non-Fibrous	
11107-13A / 17046311-027 Metal Window / Brick Interior Window Caulk	Black Non-Fibrous Homogeneous	2% Cellulose	98% Other	None Detected

Certification

Analyst: 

Analysis Date: 11/21/2017

Approved Signatory: 

Date: 11/21/2017

Page 6 of 15



SanAir Technologies Laboratory, Inc.

1551 Oakbridge Drive, Suite B, Powhatan, VA 23139
804.897.1177 Toll Free: 888.895.1177 Fax: 804.897.0070
Web: <http://www.sanair.com> E-mail: iaq@sanair.com

SanAir ID Number

17046311

FINAL REPORT

Name: AEC Laboratories, LLC
Address: 814 Broad Street
Weymouth, MA 02189

Project Number: 22427
P.O. Number:
Project Name: Thacher Elementary School

Collected Date: 11/10/2017
Received Date: 11/14/2017 10:25:00 AM
Report Date: 11/21/2017 2:36:40 PM
Analyst: Wilson, Johnathan

Asbestos Bulk PLM EPA 600/R-93/116

SanAir ID / Description	Stereoscopic Appearance	Components		Asbestos Fibers
		% Fibrous	% Non-Fibrous	
11107-13B / 17046311-028 Metal Window / Brick Interior Window Caulk	Black Non-Fibrous Homogeneous	2% Cellulose	98% Other	None Detected

SanAir ID / Description	Stereoscopic Appearance	Components		Asbestos Fibers
		% Fibrous	% Non-Fibrous	
11107-14A / 17046311-029 Room 207 Bulletin Board Wall	White Fibrous Homogeneous	65% Cellulose 20% Glass	15% Other	None Detected

SanAir ID / Description	Stereoscopic Appearance	Components		Asbestos Fibers
		% Fibrous	% Non-Fibrous	
11107-14B / 17046311-030 Room 207 Bulletin Board Wall	White Fibrous Homogeneous	65% Cellulose 20% Glass	15% Other	None Detected

SanAir ID / Description	Stereoscopic Appearance	Components		Asbestos Fibers
		% Fibrous	% Non-Fibrous	
11107-15A / 17046311-031 Room 207 Caulk At Bulletin Board	White Non-Fibrous Homogeneous		100% Other	None Detected

SanAir ID / Description	Stereoscopic Appearance	Components		Asbestos Fibers
		% Fibrous	% Non-Fibrous	
11107-15B / 17046311-032 Room 207 Caulk At Bulletin Board	White Non-Fibrous Homogeneous		100% Other	None Detected

SanAir ID / Description	Stereoscopic Appearance	Components		Asbestos Fibers
		% Fibrous	% Non-Fibrous	
11107-16A / 17046311-033 Room 207 Caulk At Window / Masonry Seam	White Non-Fibrous Homogeneous		100% Other	None Detected

SanAir ID / Description	Stereoscopic Appearance	Components		Asbestos Fibers
		% Fibrous	% Non-Fibrous	
11107-16B / 17046311-034 Room 207 Caulk At Window / Masonry Seam	White Non-Fibrous Homogeneous		100% Other	None Detected

Certification

Analyst: 

Analysis Date: 11/21/2017

Approved Signatory: 

Date: 11/21/2017

Page 7 of 15



SanAir Technologies Laboratory, Inc.

1551 Oakbridge Drive, Suite B, Powhatan, VA 23139
804.897.1177 Toll Free: 888.895.1177 Fax: 804.897.0070
Web: <http://www.sanair.com> E-mail: iaq@sanair.com

SanAir ID Number

17046311

FINAL REPORT

Name: AEC Laboratories, LLC
Address: 814 Broad Street
Weymouth, MA 02189

Project Number: 22427
P.O. Number:
Project Name: Thacher Elementary School

Collected Date: 11/10/2017
Received Date: 11/14/2017 10:25:00 AM
Report Date: 11/21/2017 2:36:40 PM
Analyst: Wilson, Johnathan

Asbestos Bulk PLM EPA 600/R-93/116

SanAir ID / Description	Stereoscopic Appearance	Components		Asbestos Fibers
		% Fibrous	% Non-Fibrous	
11107-17A / 17046311-035 Kitchen Men's Bathroom 2'X2' Sheetrock Ceiling Tile	White Fibrous Homogeneous	65% Cellulose 20% Glass	15% Other	None Detected

SanAir ID / Description	Stereoscopic Appearance	Components		Asbestos Fibers
		% Fibrous	% Non-Fibrous	
11107-17B / 17046311-036 Kitchen Men's Bathroom 2'X2' Sheetrock Ceiling Tile	White Fibrous Homogeneous	65% Cellulose 20% Glass	15% Other	None Detected

SanAir ID / Description	Stereoscopic Appearance	Components		Asbestos Fibers
		% Fibrous	% Non-Fibrous	
11107-18A / 17046311-037 Room 102 Carpet Mastic	White Non-Fibrous Homogeneous	2% Cellulose	98% Other	None Detected

SanAir ID / Description	Stereoscopic Appearance	Components		Asbestos Fibers
		% Fibrous	% Non-Fibrous	
11107-18B / 17046311-038 Room 102 Carpet Mastic	White Non-Fibrous Homogeneous	2% Cellulose	98% Other	None Detected

SanAir ID / Description	Stereoscopic Appearance	Components		Asbestos Fibers
		% Fibrous	% Non-Fibrous	
11107-19A / 17046311-039 Electric Room - Stored Door Wood Door Core Material	White Non-Fibrous Homogeneous	10% Cellulose	90% Other	None Detected

SanAir ID / Description	Stereoscopic Appearance	Components		Asbestos Fibers
		% Fibrous	% Non-Fibrous	
11107-19B / 17046311-040 Electric Room - Stored Door Wood Door Core Material	White Non-Fibrous Homogeneous	10% Cellulose	90% Other	None Detected

SanAir ID / Description	Stereoscopic Appearance	Components		Asbestos Fibers
		% Fibrous	% Non-Fibrous	
11107-19C / 17046311-041 Electric Room - Stored Door Wood Door Core Material	White Non-Fibrous Homogeneous	10% Cellulose	90% Other	None Detected

Certification

Analyst: 

Analysis Date: 11/21/2017

Approved Signatory: 

Date: 11/21/2017

Page 8 of 15



SanAir Technologies Laboratory, Inc.

1551 Oakbridge Drive, Suite B, Powhatan, VA 23139
804.897.1177 Toll Free: 888.895.1177 Fax: 804.897.0070
Web: <http://www.sanair.com> E-mail: iaq@sanair.com

SanAir ID Number

17046311

FINAL REPORT

Name: AEC Laboratories, LLC
Address: 814 Broad Street
Weymouth, MA 02189

Project Number: 22427
P.O. Number:
Project Name: Thacher Elementary School

Collected Date: 11/10/2017
Received Date: 11/14/2017 10:25:00 AM
Report Date: 11/21/2017 2:36:40 PM
Analyst: Wilson, Johnathan

Asbestos Bulk PLM EPA 600/R-93/116

SanAir ID / Description	Stereoscopic Appearance	Components		Asbestos Fibers
		% Fibrous	% Non-Fibrous	
11107-20A / 17046311-042 Generator Room Textured Ceiling	White Non-Fibrous Homogeneous		100% Other	None Detected

SanAir ID / Description	Stereoscopic Appearance	Components		Asbestos Fibers
		% Fibrous	% Non-Fibrous	
11107-20B / 17046311-043 Generator Room Textured Ceiling	White Non-Fibrous Homogeneous		100% Other	None Detected

SanAir ID / Description	Stereoscopic Appearance	Components		Asbestos Fibers
		% Fibrous	% Non-Fibrous	
11107-20C / 17046311-044 Generator Room Textured Ceiling	White Non-Fibrous Homogeneous		100% Other	None Detected

SanAir ID / Description	Stereoscopic Appearance	Components		Asbestos Fibers
		% Fibrous	% Non-Fibrous	
11107-21A / 17046311-045 Generator Room Generator Exhaust	Off-White Non-Fibrous Homogeneous	15% Synthetic	85% Other	None Detected

SanAir ID / Description	Stereoscopic Appearance	Components		Asbestos Fibers
		% Fibrous	% Non-Fibrous	
11107-21B / 17046311-046 Generator Room Generator Exhaust	Off-White Non-Fibrous Homogeneous	15% Synthetic	85% Other	None Detected

SanAir ID / Description	Stereoscopic Appearance	Components		Asbestos Fibers
		% Fibrous	% Non-Fibrous	
11107-21C / 17046311-047 Generator Room Generator Exhaust	Off-White Non-Fibrous Homogeneous	15% Synthetic	85% Other	None Detected

SanAir ID / Description	Stereoscopic Appearance	Components		Asbestos Fibers
		% Fibrous	% Non-Fibrous	
11107-22A / 17046311-048 Boiler Room Boiler Breech Skim Coat	Grey Non-Fibrous Homogeneous	10% Glass	90% Other	None Detected

Certification

Analyst: 

Analysis Date: 11/21/2017

Approved Signatory: 

Date: 11/21/2017

Page 9 of 15



SanAir Technologies Laboratory, Inc.

1551 Oakbridge Drive, Suite B, Powhatan, VA 23139
804.897.1177 Toll Free: 888.895.1177 Fax: 804.897.0070
Web: <http://www.sanair.com> E-mail: iaq@sanair.com

SanAir ID Number

17046311

FINAL REPORT

Name: AEC Laboratories, LLC
Address: 814 Broad Street
Weymouth, MA 02189

Project Number: 22427
P.O. Number:
Project Name: Thacher Elementary School

Collected Date: 11/10/2017
Received Date: 11/14/2017 10:25:00 AM
Report Date: 11/21/2017 2:36:40 PM
Analyst: Wilson, Johnathan

Asbestos Bulk PLM EPA 600/R-93/116

SanAir ID / Description	Stereoscopic Appearance	Components		Asbestos Fibers
		% Fibrous	% Non-Fibrous	
11107-22B / 17046311-049 Boiler Room Boiler Breech Skim Coat	Grey Non-Fibrous Homogeneous	10% Glass	90% Other	None Detected

SanAir ID / Description	Stereoscopic Appearance	Components		Asbestos Fibers
		% Fibrous	% Non-Fibrous	
11107-22C / 17046311-050 Boiler Room Boiler Breech Skim Coat	Grey Non-Fibrous Homogeneous	10% Glass	90% Other	None Detected

SanAir ID / Description	Stereoscopic Appearance	Components		Asbestos Fibers
		% Fibrous	% Non-Fibrous	
11107-23A / 17046311-051 Boiler Room Boiler Breech Insulation	White Non-Fibrous Homogeneous	10% Cellulose	90% Other	None Detected

SanAir ID / Description	Stereoscopic Appearance	Components		Asbestos Fibers
		% Fibrous	% Non-Fibrous	
11107-23B / 17046311-052 Boiler Room Boiler Breech Insulation	White Non-Fibrous Homogeneous	10% Cellulose	90% Other	None Detected

SanAir ID / Description	Stereoscopic Appearance	Components		Asbestos Fibers
		% Fibrous	% Non-Fibrous	
11107-23C / 17046311-053 Boiler Room Boiler Breech Insulation	White Non-Fibrous Homogeneous	10% Cellulose	90% Other	None Detected

SanAir ID / Description	Stereoscopic Appearance	Components		Asbestos Fibers
		% Fibrous	% Non-Fibrous	
11107-24A / 17046311-054 Boiler Room Coating On Fiberglass Ends	White Non-Fibrous Homogeneous	5% Cellulose	95% Other	None Detected

SanAir ID / Description	Stereoscopic Appearance	Components		Asbestos Fibers
		% Fibrous	% Non-Fibrous	
11107-24B / 17046311-055 Boiler Room Coating On Fiberglass Ends	White Non-Fibrous Homogeneous	5% Cellulose	95% Other	None Detected

Certification

Analyst: 

Analysis Date: 11/21/2017

Approved Signatory: 

Date: 11/21/2017

Page 10 of 15



SanAir Technologies Laboratory, Inc.

1551 Oakbridge Drive, Suite B, Powhatan, VA 23139
804.897.1177 Toll Free: 888.895.1177 Fax: 804.897.0070
Web: <http://www.sanair.com> E-mail: iaq@sanair.com

SanAir ID Number

17046311

FINAL REPORT

Name: AEC Laboratories, LLC
Address: 814 Broad Street
Weymouth, MA 02189

Project Number: 22427
P.O. Number:
Project Name: Thatcher Elementary School
Collected Date: 11/10/2017
Received Date: 11/14/2017 10:25:00 AM
Report Date: 11/21/2017 2:36:40 PM
Analyst: Wilson, Johnathan

Asbestos Bulk PLM EPA 600/R-93/116

SanAir ID / Description	Stereoscopic Appearance	Components		Asbestos Fibers
		% Fibrous	% Non-Fibrous	
11107-24C / 17046311-056 Boiler Room Coating On Fiberglass Ends	White Non-Fibrous Homogeneous	5% Cellulose	95% Other	None Detected

Certification

Analyst: 

Analysis Date: 11/21/2017

Approved Signatory: 

Date: 11/21/2017

Page 11 of 15

Disclaimer

The final report cannot be reproduced, except in full, without written authorization from SanAir. Fibers smaller than 5 microns cannot be seen with this method due to scope limitations. The accuracy of the results is dependent upon the client's sampling procedure and information provided to the laboratory by the client. SanAir assumes no responsibility for the sampling procedure and will provide evaluation reports based solely on the sample and information provided by the client. This report may not be used by the client to claim product endorsement by NVLAP or any other agency of the U.S. government.

For NY state samples, method EPA 600/M4-82-020 is performed.

Polarized- light microscopy is not consistently reliable in detecting asbestos in floor covering and similar non-friable organically bound materials. Quantitative transmission electron microscopy is currently the only method that can be used to determine if this material can be considered or treated as non-asbestos containing.

NY ELAP lab ID 11983

17046311

AEC Laboratories, LLC

814 Broad Street

Weymouth, MA 02189

Phone: 781-337-0567

Fax: 781-337-0986

labreports@americanenviro.com

Relinquished by: G. Hatch Date/Time: 11/13/17 12:30
 Received by: Quinn Rose Date/Time: 11/13/17 12:30
 Relinquished by: Quinn Rose Date/Time: 11/13/17 12:30
 Received by: Quinn Rose Date/Time: 11/13/17 12:30

Client Name: Attleboro Public Schools Phone: _____
 Client Address: _____

Project: Attleboro Elementary School
 Proj. Address: Attleboro St Attleboro State (Required): MA

Page 1 of 3
BULK SAMPLE CHAIN OF CUSTODY

Analysis: ☒ PLM ☒ Positive Stop ☐ Qualitative ☐ Point Count ☐ NOB Prep ☐ TEM Chat ☐ Lead ☐ PCB

Turnaround Time: ☐ RUSH ☐ 24 Hour ☐ 48 Hour ☐ 3 Day ☒ 5 Day

Sampled By: G. Hatch Verbal Results: Y(N)

Date: 11/13/17 Cell #: 5001

Results to (PM): G. Hatch Name: Quinn Rose

LAB ID	FIELD ID	LOCATION	SAMPLE DESCRIPTION	Homogen-ous Area	Material Type
	11017-01K	Storage O room	18x12 white w/ green VET		
	-01B	Jan closet at main lobby	Black mastic		
	-02A	Same as 01A			
	-02B	" " 01B			
	-03A	Extra tiles in janitor storage	12x12 Blue VET		
	-03B				
	-04A		12x12 Aqua VET		
	-04B				
	-05A		12x12 Green VET		
	-05B				
	-06A	Janitor storage	12x12 white w/ Aqua VET		
	-06B				
	-07A	Jan closet at lobby	12x12 textured pin hole ceiling tile		
	-07B	Store Room 200 N			
	-08A	Room 200	12x12 smooth speck ceiling tile		
	-08B	Room 201			
	-09A	Room 200	Blue core base		
	-09B	201			
	-10A	200	Mastic		
	-10B	201			
	-11A	Storage Room N	Shed rock		
	-11B	Janitor closet			
	-11C	Room 210			

labreports@americanenviron.com

Date/Time: 11/2/17

Date/Time: 11/13/17 12:30

Date/Time: 11/13/17 *Felix*

Date/Time:

Client Name: Atkins School Phone: 811-5503

Client Address:

Project: Thomas Elementary School
 Proj. Address: 7744 St Atterbury State (Required): MA

Page 1 of 3
BULK SAMPLE CHAIN OF CUSTODY

Analysis: ☒ PLM ☒ Positive Stop ☐ Qualitative ☐ Point Count ☐ NOB Prep ☐ TEM Chat ☐ Lead ☐ PCB

AEC Laboratories ID:

Turnaround Time: ☐ RUSH ☐ 24 Hour ☐ 48 Hour ☐ 3 Day ☒ 5 Day

Sampled By: E. J. J. J.

Verbal Result

Date: 11/20/17

Results to (PM): E. Hatch

Cell #: 2
Name: Q. Y. X.

And even if you can

LAB ID	FIELD ID	LOCATION	SAMPLE DESCRIPTION	Homogeneous Area	Material Type
	11017-12A	Same as 11A	Joint Compound		
	-12B	↓ 11B	Black interior masonry caulk		
	-12C	↓ 11C	Bottom Board wall		
	-12D	Room 100	CAULK at bottom board/cell seam		
	-12E		CAULK the masonry/masonry seam		
	-12F		3"x3" shoddy ceiling tile		
	-12G	Room 100	CAULK mastic		
	-12H	Electric Room - Staircase	Wood floor core material		
	-12I	Generator room	Textured ceiling		
	-12J				
	-12K				
	-12L				
	-12M				
	-12N				
	-12O				
	-12P				
	-12Q				
	-12R				
	-12S				
	-12T				
	-12U				
	-12V				
	-12W				
	-12X				
	-12Y				
	-12Z				

Relinquished by: <u>G. Hatcher</u>	Date/Time: <u>11/13/17</u>
Received by: <u>Antonia Leone</u>	Date/Time: <u>11/13/17 12:30</u>
Relinquished by: <u>Antonia Leone</u>	Date/Time: <u>11/13/17</u>
Received by: _____	Date/Time: _____

Client Name: McLobbers Public Schools Phone: _____

Project: Thacher Elementary School
Proj. Address: 771 Ave St Appleboro State (Required): MA

AEC Laboratories, LLC
814 Broad Street
Weymouth, MA 02189
Phone: 781-337-0567
Fax: 781-337-0986
labreports@americanenvirom.com

AEC Laboratories ID:

Verbal Results:

Special Instructions:

26 | 11/14/17 | 10:28