

Our upgraded Find a Doctor tool makes it easy to find providers in your network — and in your neighborhood. Simply follow the steps below to explore this new tool designed to help you.

Healthcare providers who have contracted with Blue Cross of Idaho agree to provide services at discounted rates to help save you money. You may visit an out-of-network provider; however, your covered benefit level will be lower and you may be billed for any charges above the maximum allowable limits and subjected to your out-of-network deductible. To find an in-network provider, follow these instructions.

STEP 1:

- Visit bcidaho.com. Select **Find a Doctor** on the homepage.



STEP 2:

- For best results, log in to your online member account. Select the blue **Log In** bar.

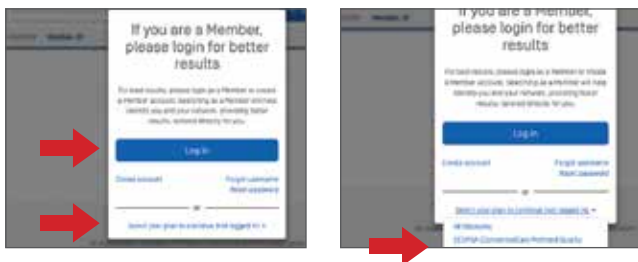

- If you don't want to log in or don't have an online account (creating one is easy), you can still search for a doctor by selecting the **Select your plan to continue** (not logged in) link that will navigate you to a dropdown menu of networks.
- Choose your network. If you don't know your network, select **all networks**

STEP 3:

- Select the type of medical care provider you need.



STEP 4:

- Select the specialty within the type of medical care you are searching.



- Your results will be displayed. Simply select the name of the provider to learn more about him or her.



- Once you select a provider, you can find out what networks he or she accepts, their specialty, education, any practice limitations, read reviews from patients and much more.

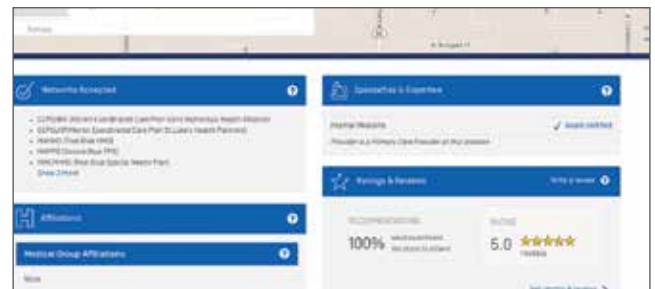

STEP 5:

- To narrow or expand your search results, use the menu on the right side of the screen. You can change the distance from your location, sort by gender, rating, etc.

