

# HEBRON ELEMENTARY SCHOOL

## LEAD WATER EXCEEDANCE

## ADMINISTRATIVE ORDER



# GUEST PRESENTERS



Wayne Durocher, Custodial Foreman, HPS

Brendan Rowley, Certified Water Operation, Hungerford's

Lori J. Mathieu, Public Health Section Chief, CT DPH

Gary Johnson, Enforcement Supervisor, CT DPH

Don Mitchell, Director of Health, Chatham Health District



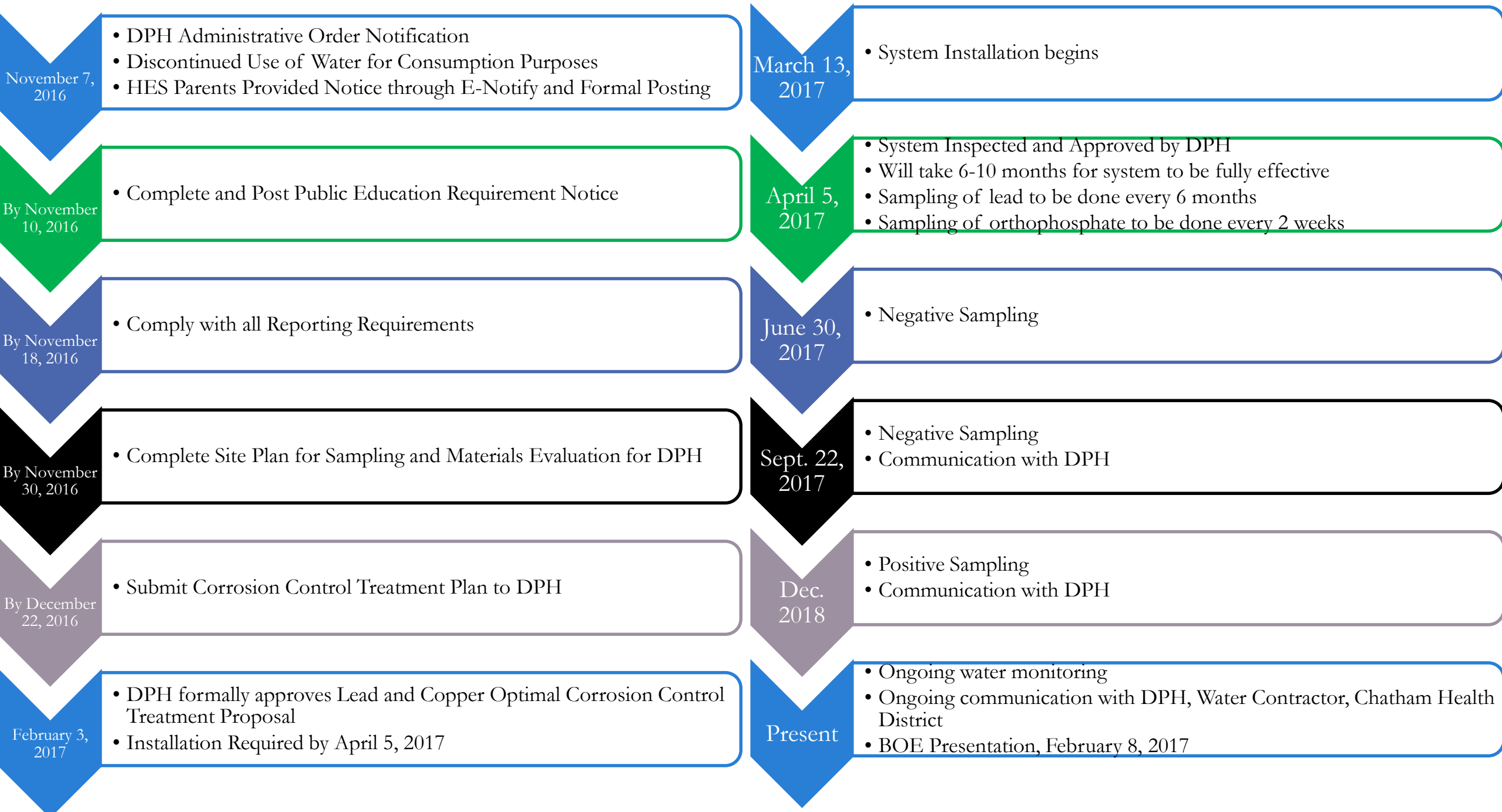



# Hebron Elementary

## Water Treatment Plan

1. 2 wells come into pump house
2. Water flows through a UV (ultra violet lamp) for protection from possible **Bacteria**
3. Water then flows through Calcite filters to increase the **pH** level to combat corrosion of plumbing
4. Water then flows through an Air bubbler system to gas off any **Radon** in the water
5. Water then is injected with Zinc Ortho Phosphate prior to entering the Atmospheric storage tank. The Phosphate coats the inner plumbing to prevent the leaching of **Lead** from the old lead solder in the plumbing

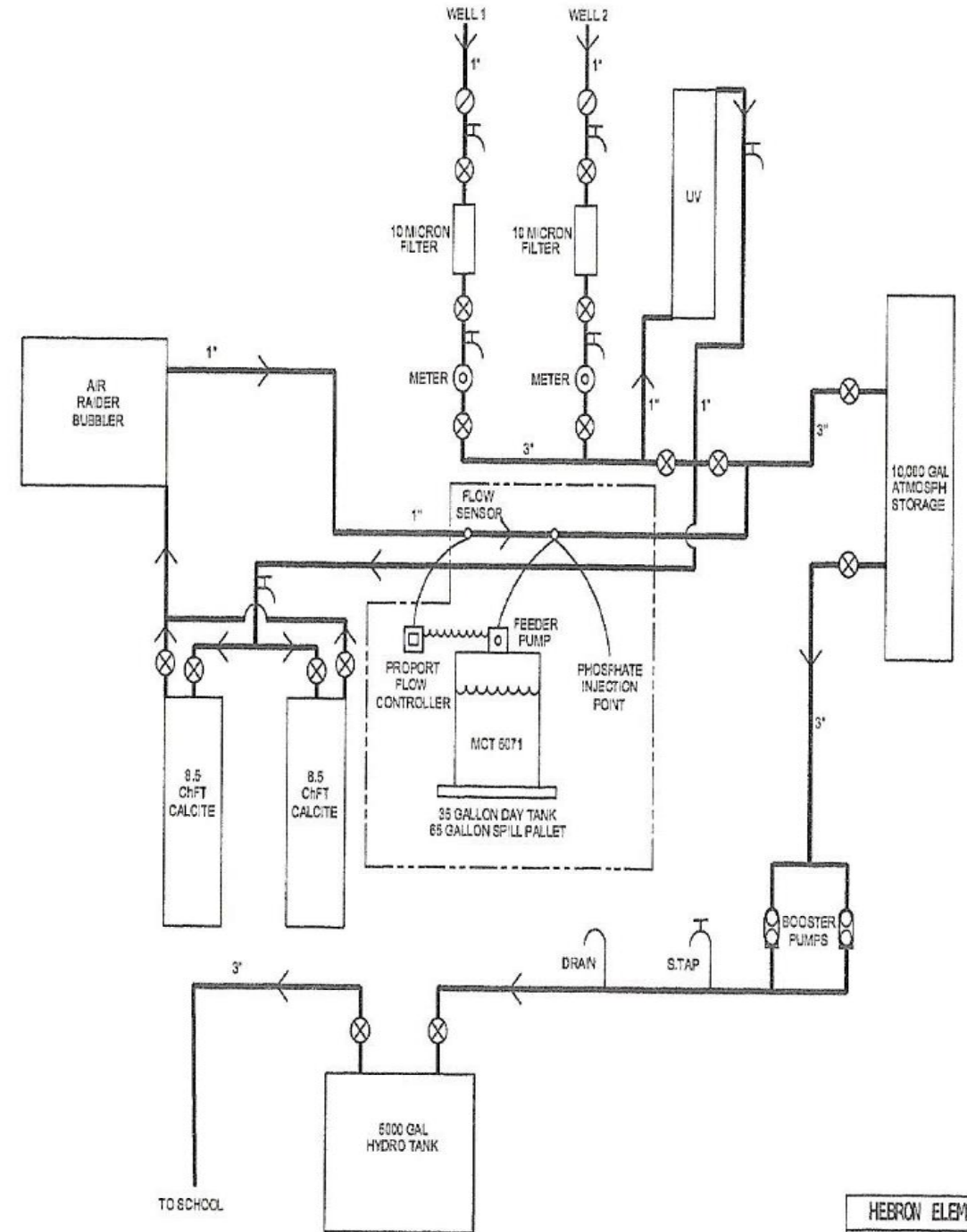



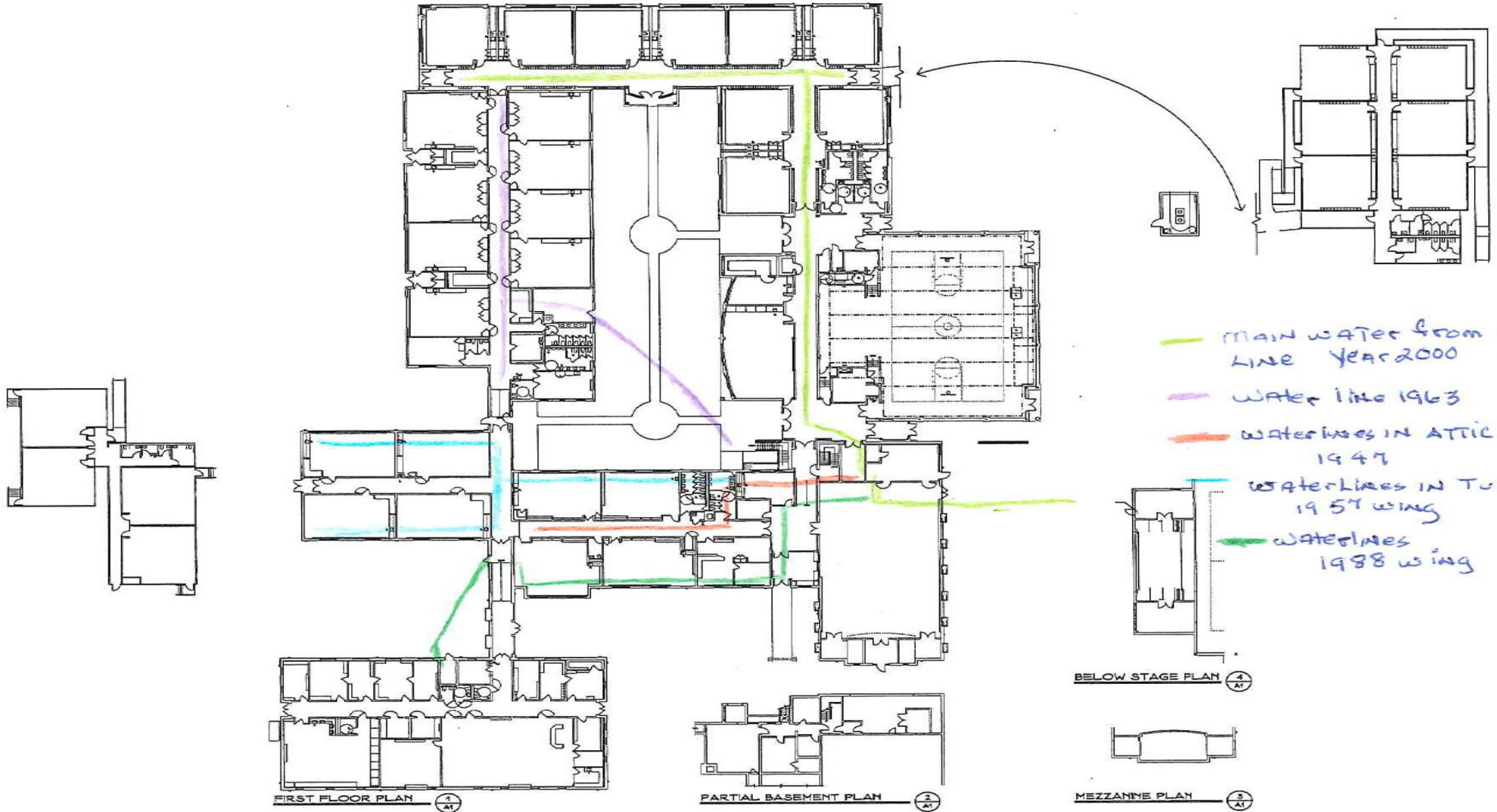

- MAIN WATER from pump house  
LINE YEAR 2000
- WATER LINE 1963
- WATER LINES IN ATTIC  
1947
- WATER LINES IN TUNNELS  
1957 wing
- WATER LINES  
1988 wing

FIRST FLOOR PLAN 1  
A1

PARTIAL BASEMENT PLAN 2  
A1

BELOW STAGE PLAN 4  
A1

MEZZANINE PLAN 3  
A1



Rev.	Description	Date	Drawn By

# Historical Perspective & DPH Administrative Order

1. Flint, Michigan Water Crisis
2. Connecticut Regulation Changes
3. Administrative Order Process
4. Role of Department of Public Health as Regulating Authority

## 3Ts for Reducing Lead in Drinking Water in Schools



*Revised Technical Guidance*