

New Fairfield High School
State Project #: 091-0044N
Technology Equipment – Addendum #1
March 10, 2023

ATTENTION BIDDERS:

The following, as additions to and modifications, will be included in, and become part of Request for Proposal and Statement of Work for the above referenced project. Proposers are, therefore, instructed to take the following into account in rendering any Proposal for this work.

DUE DATE:

The due date remains March 28, 2023.

QUESTIONS SUBMITTED VIA EMAIL:

Q1: TE1.8 Wellness Room: p. 100 says qty: 3 per location, p. 179 & 98 says qty: 1 55' display

A1: *There are three 55" digital signage displays around the perimeter of the room (TE1.4 on the drawing). At the TE1.8 location, this is where the HDMI splitter will be located, and the three 80' cables will be installed to each of the three screens from the TE1.8 location. The one 6' HDMI cable is for an input to the HDMI splitter from a owner-provided source.*

Q2: TE1.1 Small Instructional Spaces: p. 179 states 13 total but plans only show 12

A2: *Per the Room Summary sheets, the quantity of 13 is correct. The TE1.1 tag in Huddle Room 1D13 was inadvertently not shown on the drawing.*

Q3: TE1.4 Small Dig Signage: p. 179 says 8 but 11 found on plans

A3: *The Room Summary sheets should have Wellness Room 2B08 listed as having three TE1.4 (see item Q1 above clarifying Wellness Room A/V).*

Q4: Can we please have a wiring diagram for TE1.1 - TE1.10

A4: *See attached sheet E-514 that is part of the base construction documents package.*

New Fairfield
High School &
Pool Locker
Rooms

54 Gillotti Rd.
New Fairfield, CT 06812

091-0044N &
091-0046CV

JCJ ARCHITECTURE

120 HUYSHOPE AVENUE
SUITE 400
HARTFORD, CT 06106
860.247.9226

© 2020 JCJ Architecture

CONSULTANT:
CJS
Consulting Engineering
Services, Inc.
811 Middle Street
Middletown CT 06457
860.532.1682
ceseng.com
CES #2020128.01

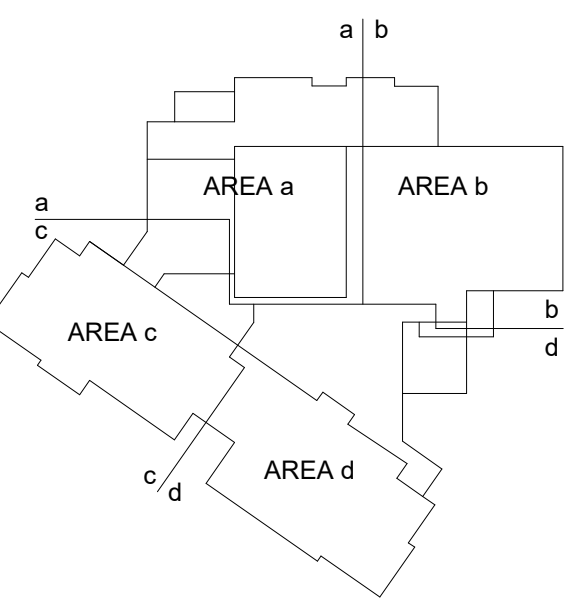

CONFORMED SET
08/18/2021

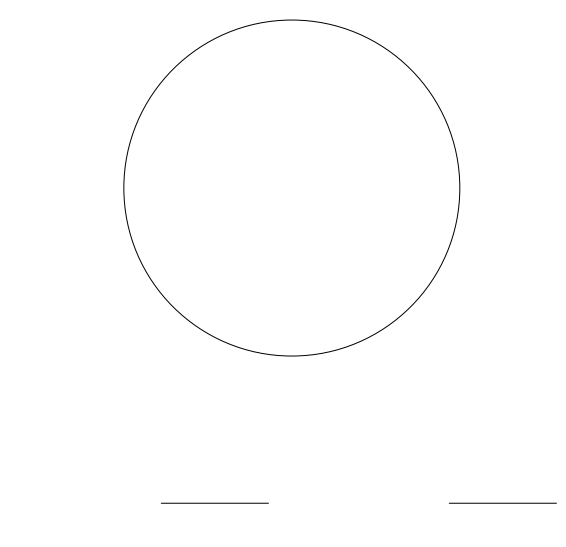

ISSUE ISSUED FOR BID
JOB 2020128.01
DRAWN MAL
SCALE As indicated
REVISIONS

ELECTRICAL DETAILS

E-514

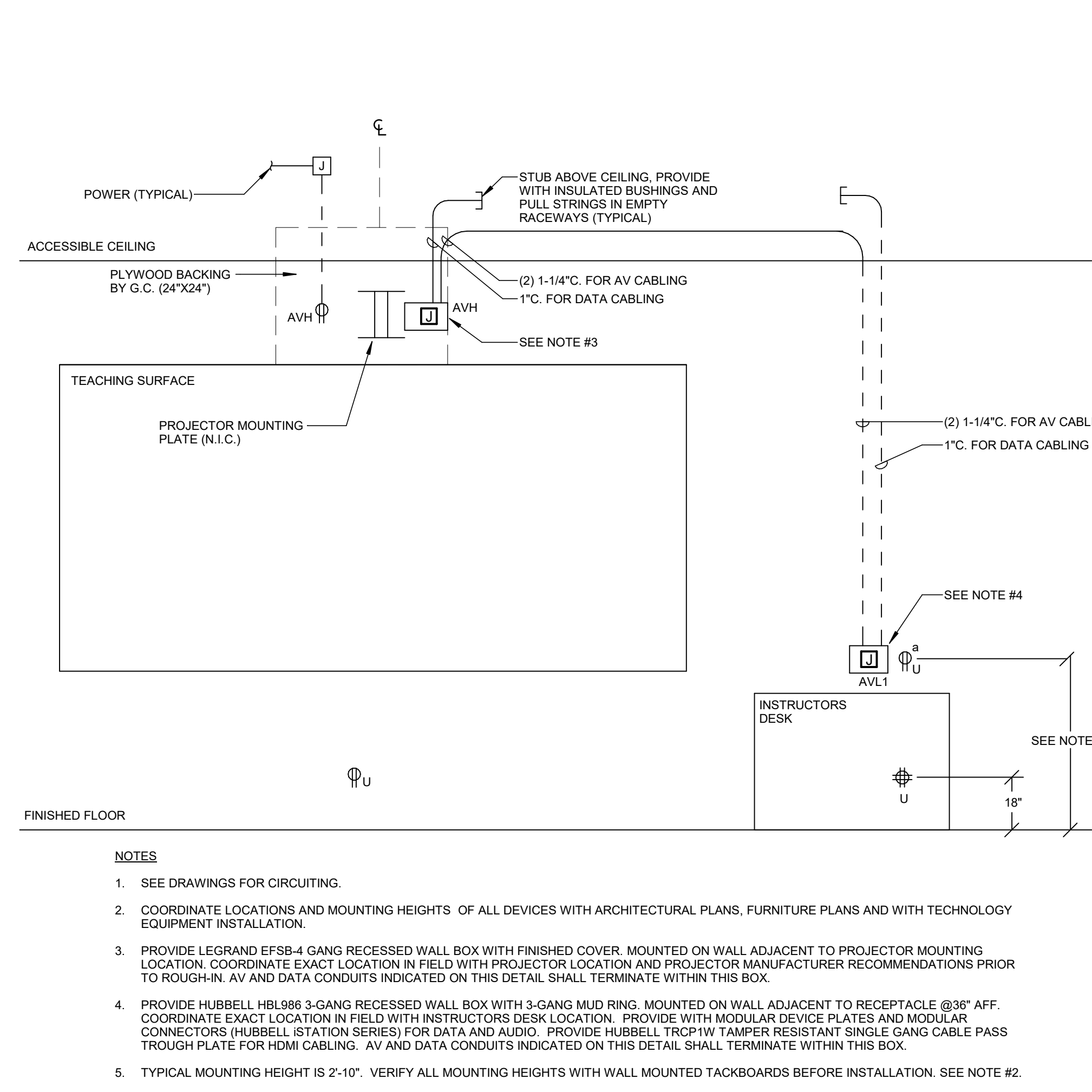

1 TYPICAL INTERACTIVE PROJECTOR ROUGH-IN DETAIL
N.T.S.

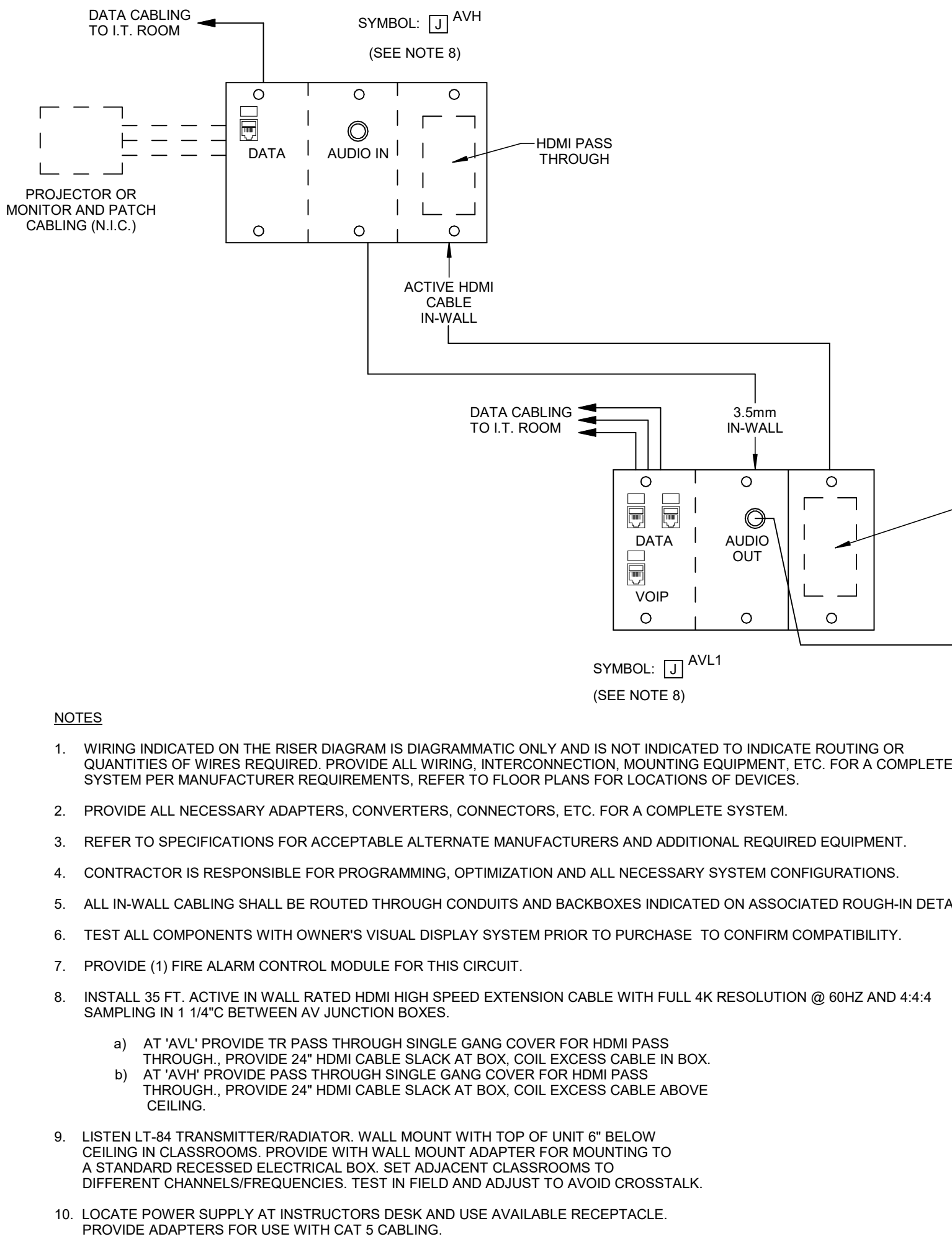

2 TYPICAL INTERACTIVE PROJECTOR AV WIRING DETAIL
N.T.S.

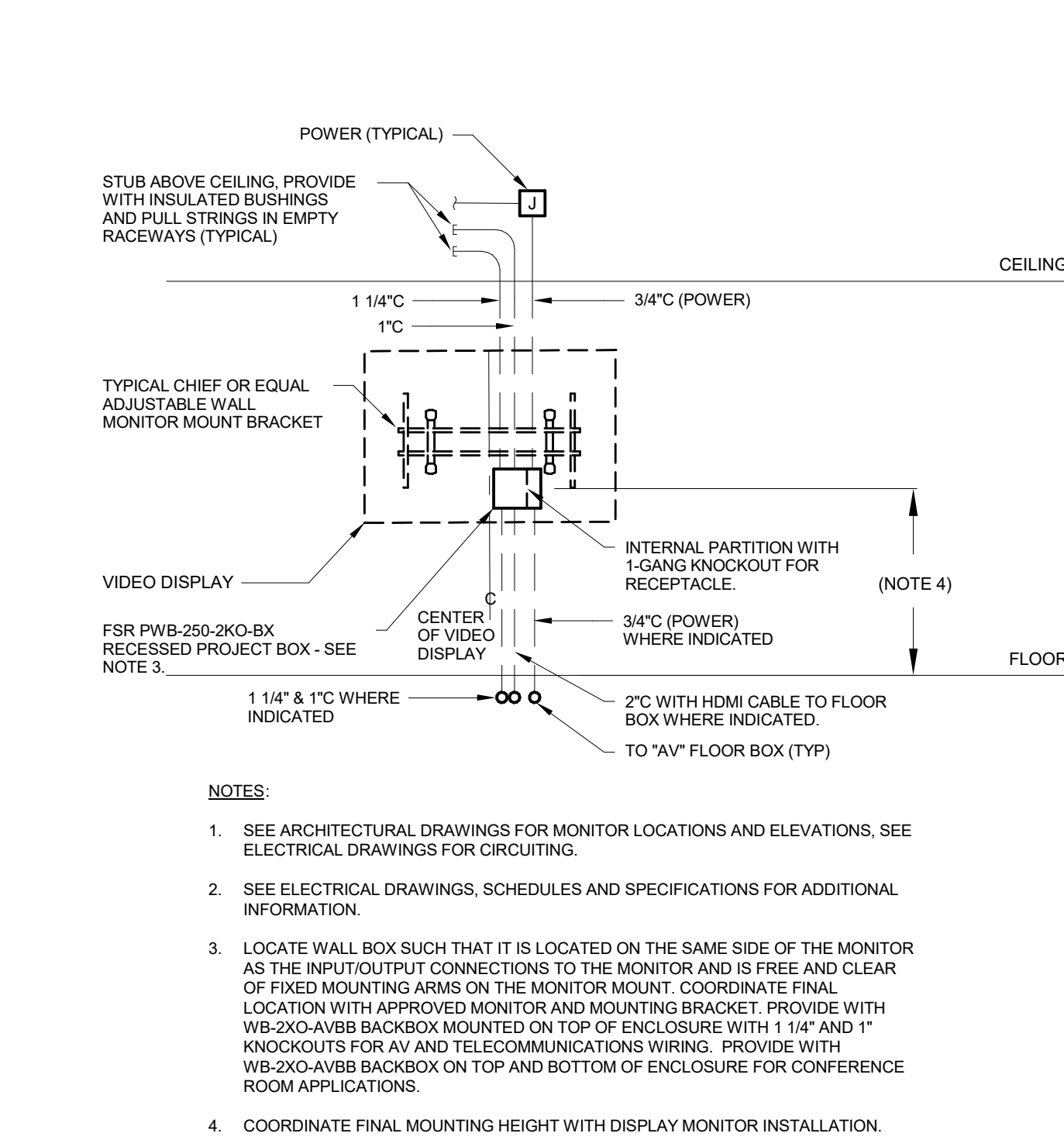

3 TYPICAL VIDEO MONITOR DISPLAY / DIGITAL SIGNAGE ROUGH-IN DETAIL
N.T.S.

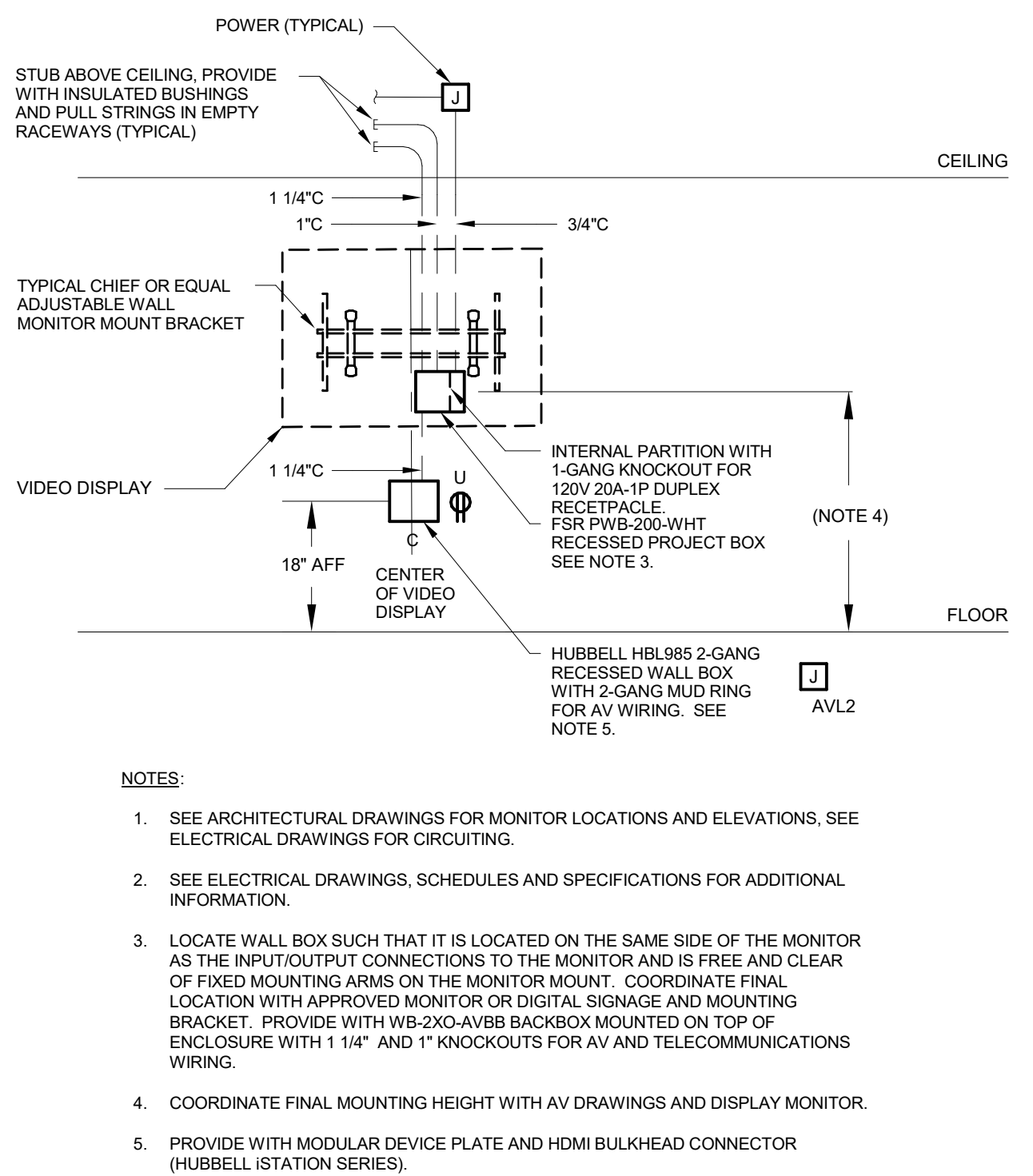

4 TYPICAL INSTRUCTIONAL MONITOR DISPLAY ROUGH-IN DETAIL
N.T.S.

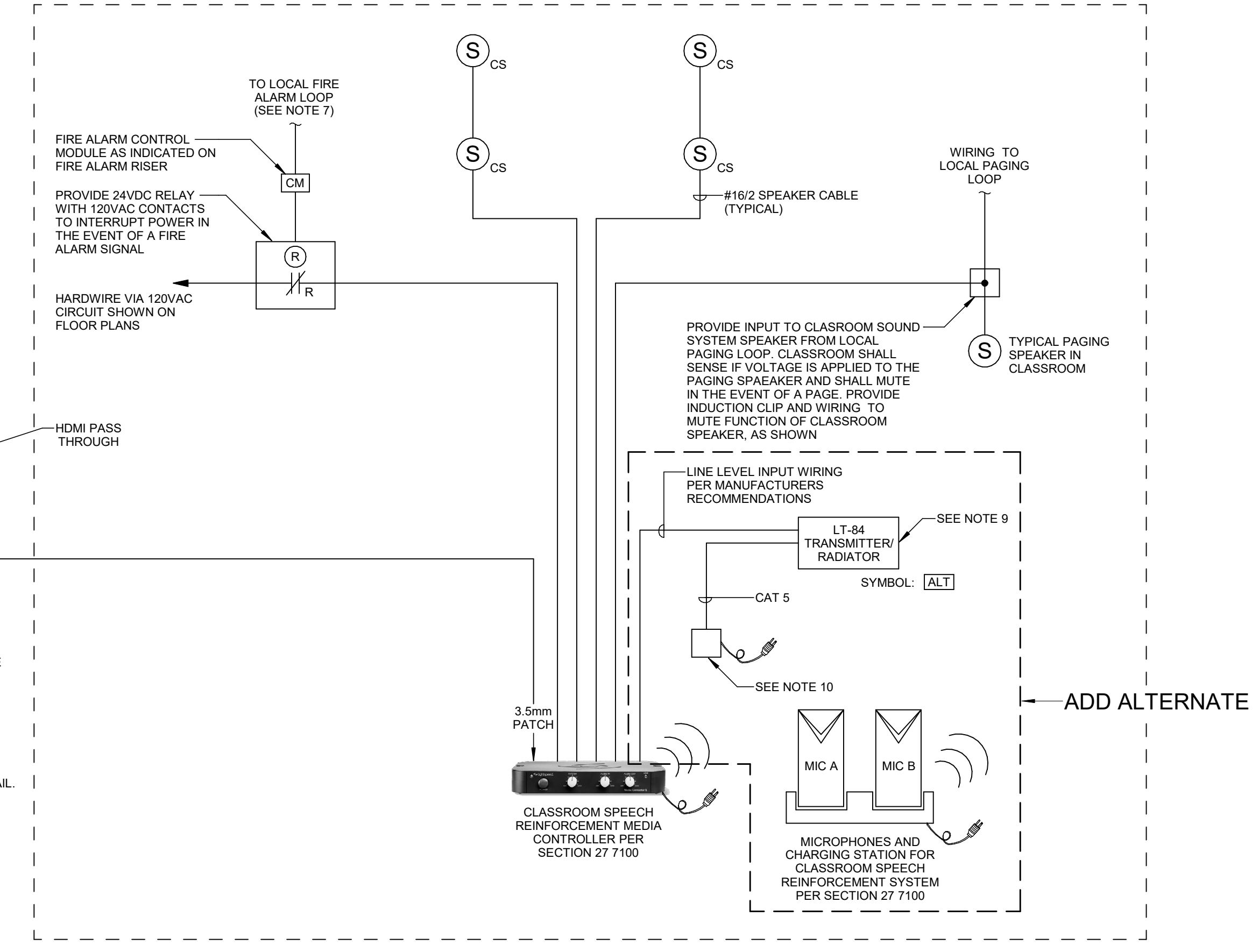

5 PV ZREC METER DETAIL
N.T.S.

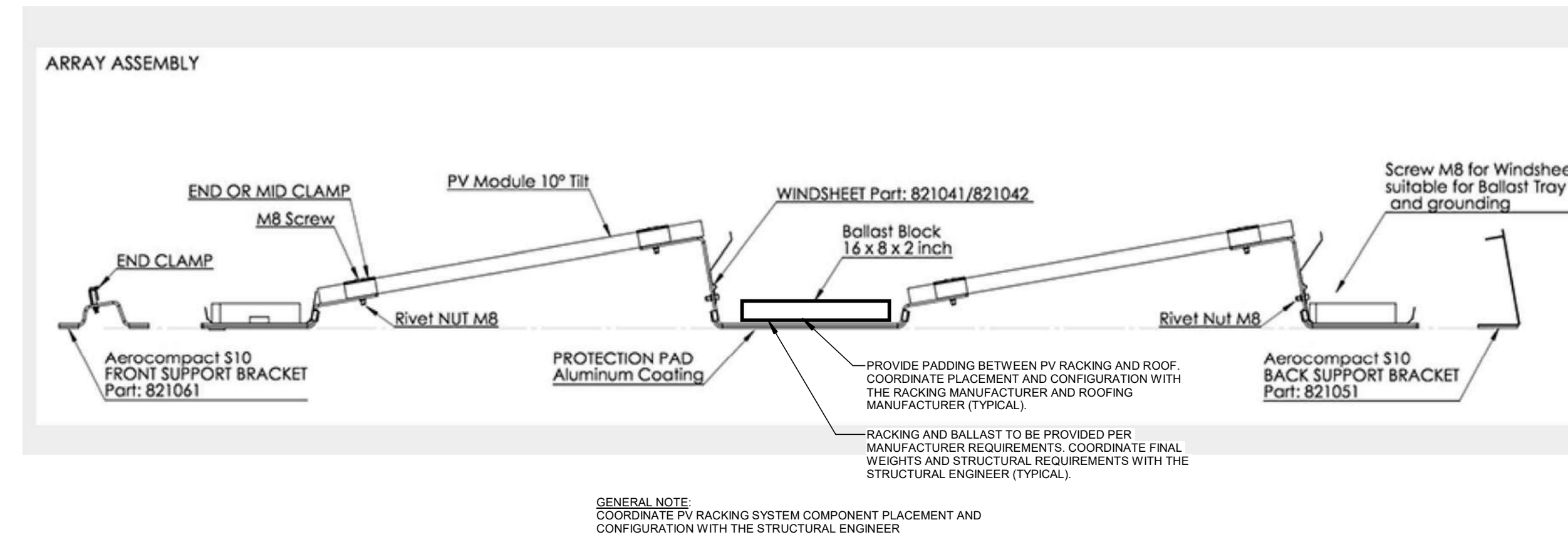

6 ROOF MOUNTED PV ARRAY DETAIL
N.T.S.

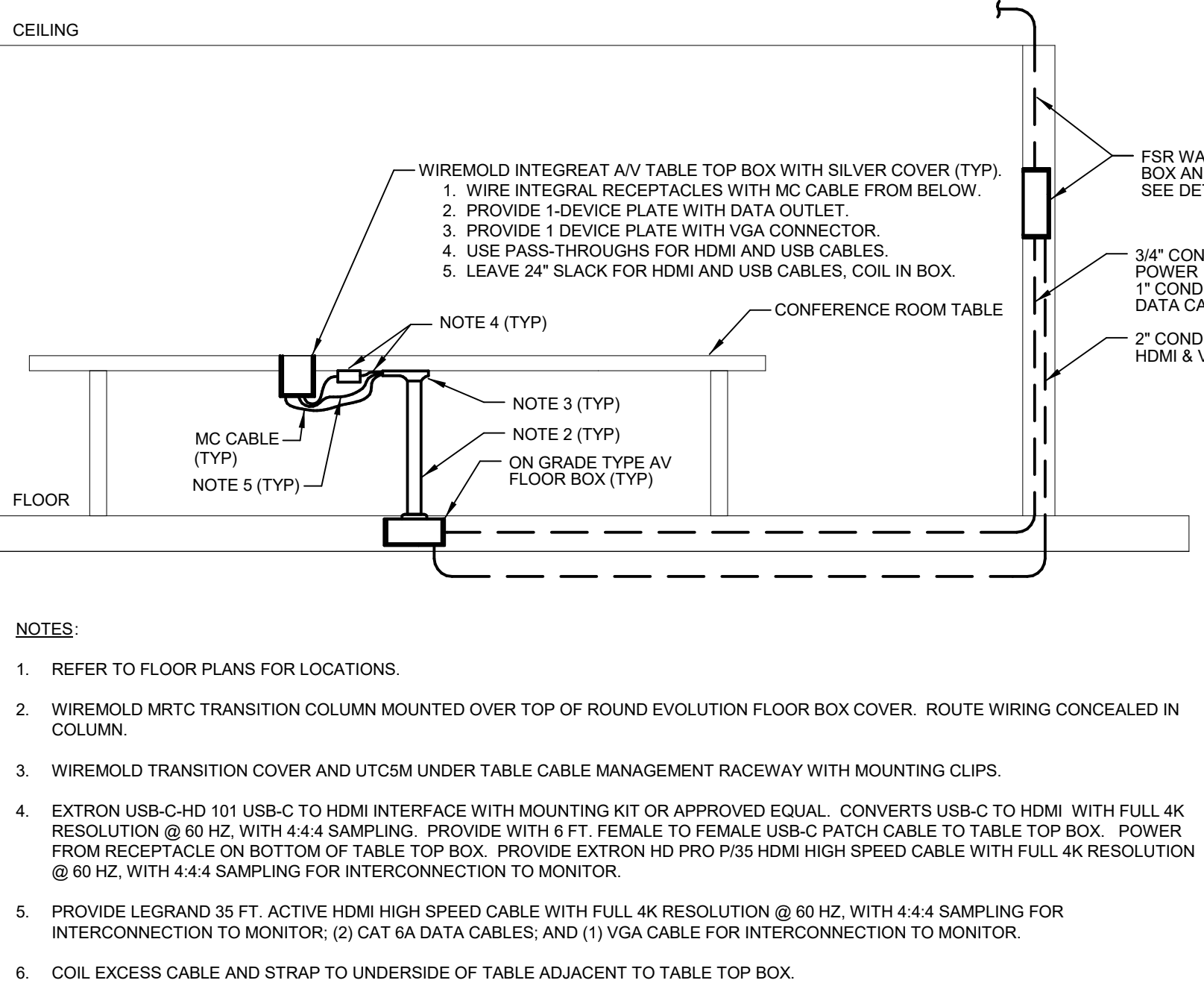

7 TYPICAL CONFERENCE ROOM ON GRADE BOX WIRING DETAIL
N.T.S.

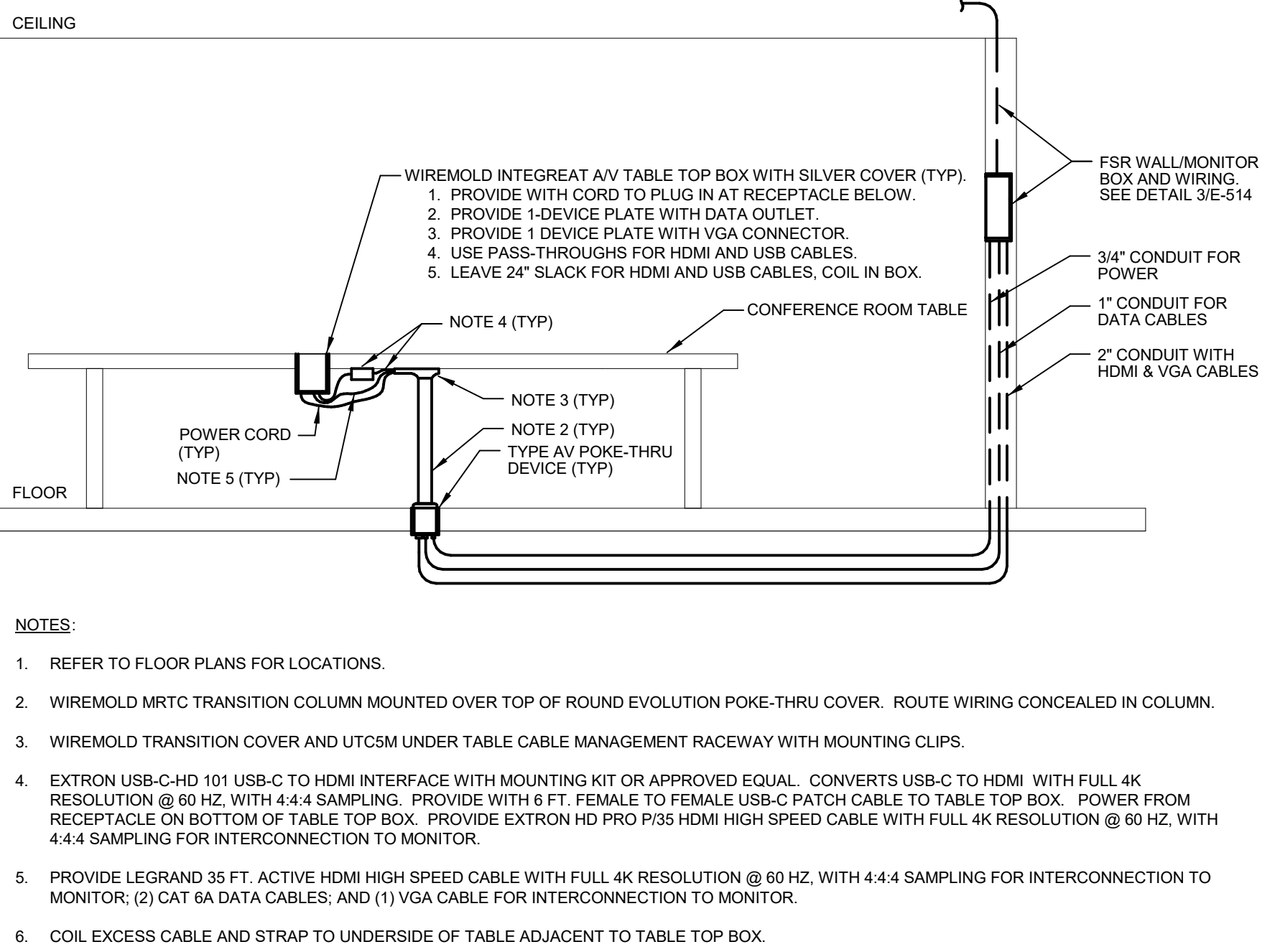

8 TYPICAL CONFERENCE ROOM POKE THRU WIRING DETAIL
N.T.S.