

WESTWOOD HIGH SCHOOL



STUDENT HANDBOOK
2022-23

Warriors

WESTWOOD

High School

AUGUST 2022

S	M	T	W	T	F	S
	1	2	3	4	5	6
7	8	9	10	11	12	13
14	15	16	17	18	19	20
21	22	23	24	25	26	27
28	29	30	31			

SEPTEMBER 2022

S	M	T	W	T	F	S
				1	2	3
4	5	6	7	8	9	10
11	12	13	14	15	16	17
18	19	20	21	22	23	24
25	26	27	28	29	30	

OCTOBER 2022

S	M	T	W	T	F	S
						1
2	3	4	5	6	7	8
9	10	11	12	13	14	15
16	17	18	19	20	21	22
23/ ₃₀	24/ ₃₁	25	26	27	28	29

NOVEMBER 2022

S	M	T	W	T	F	S
		1	2	3	4	5
6	7	8	9	10	11	12
13	14	15	16	17	18	19
20	21	22	23	24	25	26
27	28	29	30			

DECEMBER 2022

S	M	T	W	T	F	S
				1	2	3
4	5	6	7	8	9	10
11	12	13	14	15	16	17
18	19	20	21	22	23	24
25	26	27	28	29	30	31

JANUARY 2023

S	M	T	W	T	F	S
1	2	3	4	5	6	7
8	9	10	11	12	13	14
15	16	17	18	19	20	21
22	23	24	25	26	27	28
29	30	31				

FEBRUARY 2023

S	M	T	W	T	F	S
			1	2	3	4
5	6	7	8	9	10	11
12	13	14	15	16	17	18
19	20	21	22	23	24	25
26	27	28				

MARCH 2023

S	M	T	W	T	F	S
			1	2	3	4
5	6	7	8	9	10	11
12	13	14	15	16	17	18
19	20	21	22	23	24	25
26	27	28	29	30	31	

APRIL 2023

S	M	T	W	T	F	S
						1
2	3	4	5	6	7	8
9	10	11	12	13	14	15
16	17	18	19	20	21	22
23/ ₃₀	24	25	26	27	28	29

MAY 2023

S	M	T	W	T	F	S
	1	2	3	4	5	6
7	8	9	10	11	12	13
14	15	16	17	18	19	20
21	22	23	24	25	26	27
28	29	30	31			

JUNE 2023

S	M	T	W	T	F	S
				1	2	3
4	5	6	7	8	9	10
11	12	13	14	15	16	17
18	19	20	21	22	23	24
25	26	27	28	29	30	

JULY 2023

S	M	T	W	T	F	S
						1
2	3	4	5	6	7	8
9	10	11	12	13	14	15
16	17	18	19	20	21	22
23/ ₃₀	24/ ₃₁	25	26	27	28	29

AUGUST 2022
 4..... School Starts 27..... SAT for Grades 11, 12

SEPTEMBER 2022
 5..... Labor Day, No School 10..... ACT for Grades 11, 12
 30..... End of First Grading Period, Early Release

OCTOBER 2022
 1..... SAT for Grades 11, 12 11..... School Resumes
 3-7..... October Break, No School 12..... PSAT/NMSQT for Grades 10, 11
 22..... ACT for Grades 11, 12
 10..... Professional Learning Day, No School

NOVEMBER 2022
 5..... SAT for Grades 11, 12 23-25..... Thanksgiving Break, No School
 11..... Veterans Day, No School

DECEMBER 2022
 3..... SAT for Grades 11, 12 16..... End of Second Grading Period, First Semester, Early Release
 10..... ACT for Grades 11, 12 19-Jan 2..... Winter Break, No School

JANUARY 2023
 3..... Professional Learning Day, No School 16..... MLK/Civil Rights Day, No School
 4..... School Resumes

FEBRUARY 2023
 11..... ACT for Grades 11, 12 20..... Presidents Day, No School

MARCH 2023
 10..... End of Third Grading Period, Early Release 13-17..... Spring Break, No School
 11..... SAT for Grades 11, 12 20..... School Resumes

APRIL 2023
 1..... ACT for Grades 11, 12 7..... Spring Holiday, No School

MAY 2023
 6..... SAT for Grades 11, 12 25..... Last Day of Classes, High School Graduation
 24-25..... Half Days, Final Exams 29..... Memorial Day

JUNE 2023
 3..... SAT for Grades 11, 12 10..... ACT for Grades 11, 12

JULY 2023
 4..... Independence Day 15..... ACT for Grades 11, 12

AUGUST 2023
 3..... First Day of Classes

DATES SUBJECT TO CHANGE. CHECK WITH STUDENT ADVISEMENT OFFICE FOR OFFICIAL DATES.

WESTWOOD HIGH SCHOOL

945 W. Rio Salado Parkway • Mesa, AZ 85201-3902

Phone: (480) 472-4400 • Fax: (480) 472-4509

Hours of Operation: 7:00 a.m. – 3:30 p.m.

Westwood High School MISSION STATEMENT

The mission of Westwood High School Community is to develop the knowledge, skills and attitudes necessary to prepare all students to become lifelong learners and productive members of our diverse society.

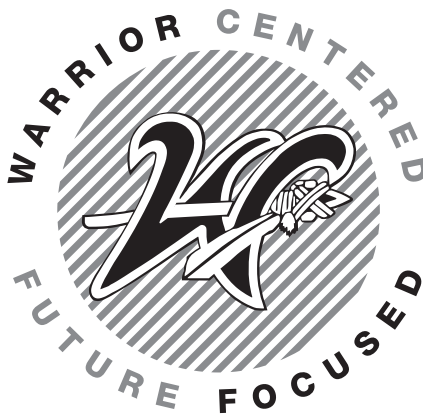

Principal

Chris Gilmore

Assistant Principal

Katie Gardner

Assistant Principal

Vatricia Harris

Assistant Principal

Sue Campbell

Assistant Principal

Tera Geyer

Assistant Principal

Brady Pond

FIGHT SONG

Go, Westwood, go!
We're going to fight;
We're fighting right;
And right we'll play.
Go, Westwood, go!
Our spirits high;
We're going to try;
We're on our way.
Go, Westwood, go!
The blue and orange shining ever through
Onward we'll roll,
O mighty, Westwood Warriors, Go!

"OUR WESTWOOD HIGH"

ALMA MATER

Westwood, our Westwood High
With glorious colors orange and blue.
Westwood, our Westwood High,
Will guide our footsteps safely through.
These radiant years of faith and youth,
Are full of hope for peace and truth.
We'll give our hearts, and hands, and mind,
A brighter future help us find.
Westwood, O Westwood,
We'll trust in thee, O Westwood High

Westwood High School 2022-23 BELL SCHEDULE

MONDAY, TUESDAY, THURSDAY, FRIDAY

	START TIME	END TIME
A Hour	6:59	8:09
1st Hour	8:15	9:12
2nd Hour/Announcements	9:19	10:20
3rd Hour	10:27	11:24
4th Lunch	11:24	12:03
5th Hour	12:10	1:07
4th Hour	11:31	12:28
5th Lunch	12:28	1:07
6th Hour	1:14	2:11
7th Hour	2:18	3:15

WESTWOOD TRIPLE ASSEMBLY

	START TIME	END TIME
A Hour	6:59	8:09
1st Hour	8:15	11:02
1st Assembly	8:20	9:10
2nd Assembly	9:17	10:07
3rd Assembly	10:12	11:02
2nd Hour	11:09	11:44
3rd Hour	11:49	12:24
4th Hour (Lunch)	12:31	1:06
5th Hour (Lunch)	1:13	1:48
6th Hour	1:55	2:30
7th Hour	2:37	3:15

END OF SEMESTER

	START TIME	END TIME
A Hour	6:59	8:05
1st Hour	8:15	9:30
2nd Hour	9:40	10:55
3rd Hour	11:05	12:20
Lunch	12:20	12:30

WEDNESDAY

	START TIME	END TIME
No A Hour		
1st Hour	8:15	8:55
2nd Hour	9:01	9:41
3rd Hour	9:47	10:27
4th/5th Hour	10:33	11:13
6th Hour	11:19	11:59
7th Hour	12:05	12:45
Lunch	12:45	1:00

END OF 1ST & 3RD QUARTER

	START TIME	END TIME
A Hour	6:59	8:09
1st Hour	8:15	8:52
2nd Hour	8:58	9:35
3rd Hour	9:41	10:18
4th/5th Hour	10:24	11:01
6th Hour	11:07	11:44
7th Hour	11:50	12:27
Lunch	12:27	1:15

END OF SEMESTER

	START TIME	END TIME
A Hour	6:59	8:05
1st Hour	8:15	9:30
2nd Hour	9:40	10:55
3rd Hour	11:05	12:20
Lunch	12:20	12:30

Portrait of a MPS Graduate

ESSENTIAL SKILLS - I CAN STATEMENT

COLLABORATOR

Learns from and contributes to the learning of others while working toward a common goal.

- I can work with others toward a common goal.
- I can monitor my own and the team's learning.
- I can learn from others and contribute to the learning of others.
- I can work as part of a diverse team and value my teammates' contributions.
- I can support the outcomes of collaboration.

COMMUNICATOR

Listens and shares ideas clearly and effectively, keeping the audience and purpose in mind.

- I can actively listen to others.
- I can value other voices and ideas.
- I can respectfully express my thoughts clearly.
- I can give, receive and act upon feedback.
- I can clearly express my ideas in a variety of formats.

COMMUNITY CONTRIBUTOR

Brings people together and contributes to the community and world.

- I can serve as an active participant in a larger society.
- I can contribute to solutions that address the needs of a broader community.
- I can build global awareness and demonstrate empathy, compassion and respect for fellow community members.

CREATIVE THINKER & INNOVATOR

Uses curiosity and imagination to inspire new ideas or build upon existing ones.

- I can generate new ideas and build on existing ones.
- I can ask questions, be flexible in my thinking and learn from experimentation.
- I can pursue imaginative approaches and solutions to challenges.
- I can embrace risk and failure as opportunities to learn and grow.
- I can synthesize and evaluate information, seek patterns and connections, and apply knowledge in authentic ways.

CRITICAL THINKER & PROBLEM SOLVER

Investigates, learns and sees more than one way to solve a problem.

- I can generate, evaluate, and apply ideas and information.
- I can assess relevance and authenticity.
- I can identify the root cause of a problem.
- I can craft potential solutions

Portrait of a Graduate

The essential attitudes and skills students need to graduate ready for college, career and community.



ESSENTIAL ATTITUDES

Ethical

- Acts with character
- Is of service to others
- Takes responsibility for one's words and actions

Inclusive

- Finds common ground
- Invites and seeks to understand the ideas of others
- Sees strength in differences

Resilient

- Adaptable
- Learns from mistakes
- Is willing to risk trying again

ESSENTIAL SKILLS

Collaborator

Learns from and contributes to the learning of others while working toward a common goal

Communicator

Listens and shares ideas clearly and effectively, keeping the audience and purpose in mind

Community Contributor

Brings people together and contributes to the community and world

Creative Thinker & Innovator

Uses curiosity and imagination to inspire new ideas or build upon existing ones

Critical Thinker & Problem Solver

Investigates, learns and sees more than one way to solve a problem

Perfil de un Graduado

Las actitudes y habilidades esenciales que los estudiantes necesitan para graduarse listos para la universidad, carrera y comunidad.



ACTITUDES ESENCIALES

Ética

- Actúa con carácter
- Sirve a los demás
- Asume la responsabilidad de sus propias palabras y acciones

Inclusividad

- Encuentra puntos en común
- Invita y busca entender las ideas de los demás
- Ve la fuerza en las diferencias

Flexibilidad y Persistencia

- Adaptable
- Aprende de los errores
- Está dispuesto a arriesgarse a intentarlo nuevamente

HABILIDADES ESENCIALES

Colaboración

Aprende de y contribuye al aprendizaje de los demás mientras trabaja hacia un objetivo común

Comunicación

Escucha y comparte ideas de manera clara y efectiva, tomando en cuenta la audiencia y el propósito

Contribución a la Comunidad

Une a personas y contribuye a la comunidad y al mundo

Pensamiento Creativo e Innovador

Utiliza la curiosidad y la imaginación para inspirar nuevas ideas o construye sobre las existentes

Pensamiento Crítico y Solución de Problemas

Investiga, aprende y ve más de una forma de resolver un problema

Westwood High School

INFORMATION & GUIDELINES

ATHLETICS

Eligibility:

- Student Athletes must complete an AIA physical form and register online at repthewood.com before being eligible to compete in interscholastic athletics.
- The student athlete must have passed all classes (minimum of 5, unless a 12th grader on track to graduate) at the end of each grading period. Student must be enrolled in five classes (unless a 12th grader on track to graduate).

Fall Sports

Badminton
Cross Country
Football
Golf
Swim/Dive
Girls' Volleyball
Cheer/Pom
Girls' Flag Football
Unified Badminton
Boys' Beach Volleyball

Winter Sports

Basketball
Soccer
Wrestling
Cheer/Pom
Unified Basketball

Spring Sports

Baseball
Softball
Tennis
Track
Boys' Volleyball
Girls' Beach Volleyball
Unified Track

ATTENDANCE

There is a direct relationship between academic achievement and school attendance. According to Arizona's compulsory attendance laws, students must be in school until they reach the age of 16 or successfully complete the 10th grade. Mesa District attendance policy states students must attend at least 90 percent of class sessions in a semester to receive a passing grade or credit. A student who obtains 10 absences in any class may automatically receive a grade of NO CREDIT. However, they must still attend class pending an [attendance appeal](#). If the student loses credit due to absences, [they must continue to attend class](#). The teacher may assign a grade of "F" at the end of the semester if the student is failing.

Note:

- **Parents/guardians have one day to excuse an absence. After that time, it will remain unexcused.**
- **Students who need to leave campus during the school day MUST check out in the Attendance office before leaving. This includes attendance at assemblies.**
- **Only Parents/Guardians can check out a student in person or notify the Attendance office that they are giving permission for someone else to check out the student.**

ACADEMIC PROGRAMS

AVID – Designed to prepare under-served students for college eligibility.

Advanced Placement – Courses that prepare students to take the National Advanced Placement examination. Students may be granted AP status and or college credit based on their performance on their tests.

Concurrent Enrollment – Concurrent enrollment credits from a college or university course may be granted if prior approval has been granted. Concurrent enrollment credits are earned at a college or university campus.

Dual Enrollment – Students who are enrolled in a dual enrollment class at the high school may be granted college or university credit along with the high school credit. Dual credit courses require the payment of college tuition and successful completion of a test.

International Baccalaureate – IB courses prepare students to take IB exams. Students can earn the IB diploma for successful completion of the entire IB curriculum and qualifying scores on the IB exams.

Scholars Program – The goal of this program is to provide the students with the tools necessary to be successful in college admissions through leadership, service and college readiness skills. Application required.

SHIELD – A program that provides intensive support to Native American students who may be in need of core (required) classes.

Credit Recovery – On campus computer based learning for credit recovery.

BOOKSTORE

The bookstore is operated for the benefit of the students of Westwood High School. Classroom materials, school supplies, student I.D.s, dance tickets, t-shirts, fundraising deposits, lost and found, textbook accountability and parking permits are all handled in the bookstore. Student I.D.s will be required for all transactions! The bookstore is open from 7:15 a.m. – 3:45 p.m.

All debts must be paid before a student can participate in extra curricular activities. This includes field trips, dances, the purchase of yearbooks, parking permits, and activity cards.

BUSES

Those students riding buses are expected to follow district transportation rules and regulations. The safety of you, your friends and other students depend on your proper conduct. Violation of bus rules may result in loss of bus riding privileges.

CAFETERIA

The Warrior Cafe is a service provided to students. Students are expected to be orderly, polite and take care of equipment and facilities. The student I.D. must be shown for a purchase.

CELL PHONES/ELECTRONIC DEVICES

Cell phones and electronic devices are allowed on campus but are to be used for academic and educational purposes. If they interfere or disrupt the educational process or environment, they may be confiscated and then taken to the administration office. **Multiple offenses may result in disciplinary action. Westwood is not responsible for loss or theft of any of these items.**

CLOSED CAMPUS DURING LUNCH

All high schools in the Mesa School district will have a closed lunch campus. We will follow the procedures listed below as stated in the district directives.

- Seniors who are scheduled to graduate in the spring will be the only students allowed to leave campus during lunch. Seniors must show appropriate ID at the walk-off gates and at the drive-off gates. Senior status is defined as anyone who begins the fall semester with 15 or more credits. No juniors, sophomores and freshman will be allowed to drive or walk off campus.
- Parking for seniors will be designated at the north end of the student parking lot. Juniors and sophomores will park at the south end of the student parking lot.
- Freshman, sophomore and junior students may leave at lunch only if a parent comes to school and checks them out through the attendance office.

CLUBS

Any students who are interested in starting a club, please reach out to the Activities office (Mrs. Dewey and Mrs. Gardner) to get started!

Academic Decathlon	African-American Leadership
Anime Club	Auto Club
AVID Club	Be a Leader
Biology Olympiad	Black Student Union
Book Club/Outloud	Chess Club
Chick-Fil-A Leadership Academy	Chinese Culture Club
Culinary Club	Dance
DECA	Dodgeball Club
Drama Club	Earth Club
FFA	French Club
GSA	H.Y.P.E. Little Warriors
History Club	IB Social
Interact Club	Interpreters Club
J.O.O.I. Club	Key Club International
LatinX Club	Math Club
Mesa Youth Strength Council	Mock Trial/Speech
Model UN	Mural & Mosaic Club
National Honor Society	Native American Club
Poetry Slam	Polynesian Club
Robotics	ROTC
Silent Friends	Social and Racial Justice Club
Student Council	Video Production
Warrior Council	Weightlifting Club
Working Warriors	Yearbook

DELIVERIES TO STUDENTS

Our offices do not make flower or balloon (birthday or occasion) deliveries to students. Additionally, the office does not accept food deliveries from services such as Uber Eats, Door Dash, Postmates, Grubhub, etc. These deliveries will be refused.

DRESS CODE

(See back of book for District Dress Code Policy)

Compliance With Standards

Secondary students who violate the dress and grooming standards must correct the violation. Appropriate remedies include:

- Changing to appropriate clothing.
- Removing offending jewelry or accessory.
- Students who refuse or are unable to correct the violation will spend the remainder of the school day in the school's alternative learning classroom. Subsequent violations will be addressed in accordance with the district's Information & Guidelines for Student Behavior.
- Exceptions to the application of the dress and grooming standards may be made for the purpose of religious or disability accommodation.

Adopted: May 9, 2006

DRIVING & PARKING

Parking Regulations:

- Students wishing to park on campus must purchase a parking permit in the bookstore.
- All vehicles must be registered with the school and display a current decal on the front, lower passenger window.
- Parking registration for the school year is \$30.00 for 1 vehicle, and \$5.00 for each additional vehicle.
- Please provide the following documents when registering a vehicle.
 1. A valid drivers license
 2. Proof of current insurance
 3. Proof of current registration
 4. A completed parking permit application
 5. Must have parent signature on back of form.
- Students applying for and receiving parking privileges are responsible for knowing and complying with following regulations:
 1. Students are to park their automobiles in the student designated areas. This is the area east of the cafeteria and the area south of the varsity baseball field. Under no circumstances are students to park in lots reserved for faculty, staff, or visitors.
 2. Parking in red-curbed areas (fire lanes) or handicap-designated spaces is illegal. Vehicles illegally parked there will be issued citations by the Mesa Police Department.
 3. Tree wells, medians, sidewalks, lawn areas, outdoor basketball courts, yellow-curbed loading zones, and gated-entries are not parking spaces. Vehicles parking in these areas are prohibited and may result in disciplinary action.
 4. Falsely obtaining a parking sticker or falsifying information on a parking permit will result in serious disciplinary action.

Failure to comply with parking regulations:

1. Administration reserves the right to sticker or boot cars parked inappropriately.
2. May result in the loss of parking privileges.

Driving Regulations:

1. The on campus speed limit shall be posted at 7 mph.
2. The vehicle must be operated in a safe and courteous manner at all times.
3. Individuals may ride in vehicles only in numbers that the vehicle is designated to carry.
4. Individuals may ride in vehicles only in locations designated to safely carry human passengers.
5. All students must be licensed and covered by insurance. The school is not responsible for the automobile or its contents.
6. There is no loitering in the parking lot.
7. Students vehicles may be subject to search if there are reasonable grounds to believe that drugs, alcohol, stolen property or other contraband might be present in that vehicle.
8. Vehicles with signs reflecting the acceptability of drugs, liquor, sexual promiscuity, tobacco, or racial undertones will not be allowed.
9. Failure to comply with driving/parking regulations may result in loss of driving privileges and/or your vehicle being subject to a wheel lock device.

DROP OFF ZONE FOR STUDENTS

Parents are requested to drop students off in the student lot near the football stadium. Students should not be dropped off on Westwood Street or in the front office parking lot.

GOOD NEIGHBOR POLICY/ OFF CAMPUS JURISDICTION

State law allows schools to become involved in appropriate incidents where students are en-route to school or en-route home. School administrators can discipline students involved in such incidents.

Students of Westwood High School are not permitted to gather or loiter in the residential area surrounding our school where they constitute a nuisance to its residents. Such restrictions are in effect on all school days from 7:00 a.m. to 4:00 p.m. In accordance with state laws, school rules and other reasonable expectations of acceptable student behavior are extended to include student conduct while off campus during the regular school day. This includes the student's conduct while going to and from school, during lunch and released periods. Violations in conduct by students going to and from school functions could result in disciplinary action.

HALL PASSES

Students are expected to be in class when the tardy bell rings. When a teacher grants a student permission to leave class, the student must show their I.D. The teacher will completely fill out a hall pass. Hall passes are not to be used for vending machines or to send students to the parking lot.

HEALTH OFFICE

The Health Office, located in the front office, provides care for students as well as staff. It is open from 7:30 a.m. to 3:00 p.m. The nurse and health assistant are available to help with various illnesses, injuries or to dispense medication.

Please go to the Health Office if you:

- Feel sick or are injured
- Have prescription medication
- Have a health issue that the nurse should be made aware of

MEDIA CENTER

Library Information for Students

Remember: Our staff is here to help you use the many resources available. If you need assistance, please ask at the front desk.

The Library is open from 7:00 a.m. - 3:30 p.m. Monday - Friday

When can I come to the library?

Students may come with their class during scheduled class times. Students may also come before school, during lunch and after-school to access the library and the computer lab.

What do I need to know to use the library on my own?

All students must sign in and present a current school ID upon entering the Library Resource Center. You may use an assigned computer, the wireless Internet service from your laptop, or check out a book.

All food and drink must be left at the front counter.

Students on release time must present their I.D.s with the proper RT identifiers or a copy of their schedule for that hour at the circulation desk.

How do I check out a book?

Students may check out up to **3** books at a time. The loan period is **21** days (Books may be renewed for another 21 days unless there is a hold pending on the book). **You may not check out a book if you have overdue books or outstanding lost or damaged book fines.** We do not charge overdue fines; however, lost books do have a fine based on the book price. **It is important to take care of any fines as soon as possible. Seniors may not claim their diplomas until all fines are paid including lost book charges.**

Students may print in black and white from any computer at a cost of \$.05 per page. There is a copier that can be used to copy or enlarge for \$.10 per page. We also have a color laser printer that students may use. Students need to talk to someone at the front desk to be assigned to a computer that is linked to that printer (not all are). The cost for color printing is \$.20 - \$1.00 per page depending on the size of the color picture. We will help you to use

the printer, enlarge pictures, etc.

Student use of the library is a privilege. Appropriate behavior is expected. Talking is permitted as long as it is in a soft, low voice. Respect for classes and other students who have come to complete school work is very important. Cell phone use and music players are not permitted in the Media Center. Inappropriate behavior can result in being asked to leave immediately.

PERSONAL ARTICLES

Westwood High School and Mesa School District are not responsible for lost or stolen personal articles.

SCHEDULE CHANGES

Changes will be made only for the following reasons:

- A. Student failed in the prerequisite course
- B. Student failed the class and it needs to be retaken
- C. Student has previously failed the class with that teacher
- D. Student already passed the class listed (i.e. summer school)
- E. Student is entering a special program **MUST HAVE TEACHERS PERMISSION.**

Move Up

"Move Up" refers to getting better every day. Westwood expects every student to "Move Up" educationally and individually. Because of this, students will be discouraged from dropping a class. Westwood supports students staying in class to improve their grades and benefit from information the teacher will be covering throughout the year. We encourage student to remain on track to receive the credits needed to satisfy graduation requirements and ensure success on Civics Exam and AZ Merit tests. There are several interventions in place throughout our academic advising department to promote classroom success. To ensure that students are placed in appropriate classes, transcripts and test scores are reviewed over the summer. After reviewing each student's information, each student is placed in a specific English, reading and/or math classes.

When students withdraw from School/Courses

If a student withdraws from school to enter another school, the transcript will reflect the grades earned at the date of withdrawal. Students requesting to withdraw from a course while remaining enrolled in MPS must receive administrative approval. Freshman, Sophomores and Juniors are expected to enroll in six (6) courses per semester. Seniors must be enrolled in at least four (4) courses per semester and maintain progress toward high school graduation in three years.

Approved withdrawals from courses will be posted on the student's transcript according to the following timeline:

- Schedule changes within the first twenty (20) of the semester will not be reflected on the transcript.
- Withdrawals after the 20th day to the end of the quarter in each semester will be posted with a "W".
- Withdrawals between the quarter of the semester to twenty (20) days prior to the end of the semester will be posted as "W/P" or "W/F".
- No withdrawals are permitted within the last twenty (20) days of the semester.
- For more specifics, please refer to the course catalog.

Release Time

Students who do drop a class will not be given "Release Time" on their schedules during the middle of the day. All "Release Time" hours (not including seminary) will be placed at the beginning or end of the student's schedule. To accommodate this, students may risk having their classes moved and/or teachers reassigned to accommodate the dropped class. All "Release Time" will occur at the beginning or end of the academic day. During release time, students are expected to be OFF campus or in an approved campus location.

SEARCH AND SEIZURE

School administrators have the right to search students and seize the property including school property temporarily assigned to students when there is reasonable suspicion to believe that some material or item is detrimental to the health, safety, and welfare of the student(s), and is in their possession or control. Searches may include a student's personal property such as backpacks or pockets. Any search will be reasonable in scope and not excessively intrusive on the student considering the age, gender, and nature of the infraction.

SKATEBOARDS, BIKES, AND SCOOTERS

Students may ride skateboards, bikes, and scooters to school, but are not allowed to ride them on campus. If they are used on campus, they may be confiscated and subject to additional consequences. These should all be stored in the appropriate areas on campus.

*Westwood High School is not responsible for any of these stolen items.

STUDENT COUNCIL

Student Council is the governing body of the school. These students are elected to their positions by the student body or their respective class. They meet daily to plan, organize, prepare, and facilitate the activities of the school. They are the student leaders of Westwood High School.

The student council represents the student body with the school administration, teachers and staff. The council is charged with the management of students funds, to ensure that they are used appropriately and according to the law, district policy and school regulations.

The council works hard and puts in many hours beyond the school day to create a fun and active atmosphere for Westwood. If you are interested in this type of challenge and in becoming a leader, ask a student council member or follow the announcements for how to get involved.

Student Body President	<i>Kylie Kimes-Hulen</i>
Student Body Vice President	<i>Daniella Lopez Espinoza</i>
Student Body Secretary	<i>Karina De La Cruz Beltran</i>
Student Body Treasurer	<i>Jae Vormbrock</i>
Senior Class President	<i>Ramon Gastelum</i>
Senior Class Vice President	<i>Deziree Quezada</i>
Senior Class Representative	<i>Nahomy Rueda</i>
Junior Class President	<i>Leiny Vidal Diaz</i>
Junior Class Vice President	<i>Nalani Spitzel</i>
Junior Class Representative	<i>Desiree Hall</i>
Sophomore Class President	<i>Kyndra Blumer</i>
Sophomore Class Vice President	<i>Dulce Perez</i>
Sophomore Class Representative	<i>Sydnee Pierson</i>
Freshman Class President	<i>TBD</i>
Freshman Class Vice President	<i>TBD</i>
Freshman Class Representative	<i>TBD</i>
Director of Clubs & Organizations	TBA
Director of Clubs & Organizations	<i>Josie Allen</i>
Director of Correspondence	<i>Jacqueline Madrid Chairez</i>
Director of Cultural Affairs	<i>Vanessa Gastelum</i>
Director of Rallies & Traditions	<i>Natassja Nava</i>
Director of Social Events	<i>Melody Mancinas (Mel)</i>
Director of Special Services	<i>Sheyla Espinoza</i>
Director of Student and Faculty Recognition	<i>Valeria Moya Contreras</i>
Historian	<i>Phoenix Easton</i>
Publicity Director	<i>Iris Alarcòn</i>
Sports Director	<i>Olivia Powell</i>
Spirit Commissioner	<i>Julissa Herrera Delgado</i>
Advisor	<i>Mr. Chavez</i>
Advisor	<i>Ms. Lopez</i>

STUDENT I.D. CARDS

All students are required to carry their current I.D. card while on campus and at all school activities. The replacement cost is \$4.00. This card serves as an I.D. card and it allows you to attend Westwood activities and regular season athletic events without charge or at a reduced rate. * Sports Family Passes are available in the bookstore.

Students are required to show their I.D. card according to the following guidelines:

- upon request by any staff member.
- upon entering the library and for checking out books.
- at a teacher request to receive a pass out of class.
- at all school activities including (but not limited to) dances and athletic events.
- To enter state testing areas.
- To purchase lunch in the cafeteria.
- Seniors must show I.D. to leave campus during lunch.
- check out textbooks

Students who do not carry their I.D. cards are subject to disciplinary action.

STUDENT STORE

The student store provides a variety of items for sale daily, such as food, drink, T-shirts and spirit items. The Student Store is not open during class time.

TARDY POLICY

- Students are expected to follow classroom and school procedures regarding tardies and attendance.
- In order for the student to be admitted to class with an excused tardy slip, the parent must excuse the student, in person by signing the student in at the attendance desk. Phone calls are not an acceptable method of excusing a tardy student. Students may excuse themselves from being late to class with a note from a doctor, dentist or court official only. Phone calls and notes are not an acceptable method and notes are not an acceptable method to **excuse a tardy**.
- Students are expected to be in the classroom when the tardy bell rings and in accordance with expectations of the teacher. A student is considered tardy during the first 5 minutes of class. After 5 minutes, students will be sent to the ALC room. After 10 minutes, it will be considered an absence.

TEEN LIFELINE

If you feel like giving up, please DON'T! There is help and there is hope. Call Teen Lifeline at 602-248-8336 (TEEN) 24/7 or text the same number between 3:00 p.m. - 9:00 p.m. You are not alone."

TOBACCO/VAPING

Arizona Revised Statutes (H.B. 2701) prohibits tobacco products on school grounds, in school buildings, in school parking lots or playing fields, in buses or other vehicles or at off campus events sponsored by the school. Students caught in possession of tobacco will face disciplinary action.

VANDALISM/TAGGING

Any student engaging in graffiti or tagging is subject to disciplinary action, criminal charges, and financial responsibility.

VISITORS

Student visitors are not allowed at Westwood between 7:00 a.m. - 3:30 p.m. All other visitors must sign in at the front office to gain permission to be on campus.

Westwood High School HISTORY & TRADITIONS

HISTORY

Westwood High School opened in 1962. Westwood has a long history of pride, service and tradition. The motto of Westwood is “Where everybody is somebody”. The mascot is the “Warrior”.

The first principal of Westwood H.S. was **Mr. E.R. Brimhall**. He served from 1962-1969. The football field is dedicated to him.

Other principals include:

- **Mel Sizemore**..... 1969-1970
- **James S. Studervant** 1970-1981
- **Jack Joyce**..... 1981-1996
(known for his school spirit)
- **Harold Crenshaw** 1996-2002
(known for his spirit of unity)
- **Helen Riddle**..... 2002-2012
- **Tim Richard** 2012-2013
- **Shawn Lynch**..... 2013-2018
- **Chris Gilmore**2018-Present

Eula Harris was the first principal’s secretary. An award is given every year to an outstanding teacher in her memory.

Rulon T. Shepherd – Superintendent in 1962 when the school opened. The Westwood auditorium is named after him.

“War Eagle!” “Tear ‘em up Westwood!” The story behind the saying – In 1968 Westwood Football had lost a few games and school spirit was down. Coach Gates wanted to boost school spirit and so one day at lunch he got up on a table and shouted “War Eagle” (from a school he once attended) and the students responded “Tear ‘em up Westwood”. Since that day the saying has been used by sports teams at Westwood and is still used today.

The History of Move Up

In the late 60’s the school’s basketball Coach Tom Bennet made a commitment to his players to help them move up. He stated in an interview that he told his players, “We’re going to get better every time...as players and as individuals.” The cheerleaders at that time made a large arrow out of paper that said “Move Up.” They continued to do this for several years after to remind the players to continue to get better. Soon after large lighted “Move Up” sign was purchased and placed in the gym as a constant reminder. Westwood continues to focus on Coach Bennet’s message to “Move Up” encouraging students and staff to get better every day.

Mutt Ford – Coach Edgar “Mutt Ford” taught in Mesa since 1945. He was the first football coach and received the dedication of the first yearbook. His first season was undefeated. He contributed to the character and morale of Westwood High through participation in and support of high school athletics. An award is given each year to an athlete in memory of the first football coach.

Natani Points – Awarded throughout the year for the class that shows the most spirit. Points can be earned at assemblies, class competitions and Student Council sponsored fundraisers and events. The award is presented to the winning class at the end of the year awards assembly.

Westwood High School **HISTORY & TRADITIONS**

TRADITIONS

Every Friday is spirit day! Wear BLUE & ORANGE!!!

The first week of school Student Council makes "W's" & apples for the halls of the academic building. Each W has the name of a Westwood student and each apple has the name of a teacher.

Spirit Weeks – There is always one Spirit Week in the Fall & Spring. During Spirit Week there are fun dress up days, lunchtime activities and class competitions.

Bonfire – takes place before the Mesa High football game in the fall. The day of the bonfire Student Council hides stuffed bunnies around the campus for students to collect and bring to the bonfire. That night, at the Annex, all the football players, cheerleaders, band, Student Council, and the students of Westwood gather for a pep rally. A large bunny made by Student Council is placed on wooden crates and burned in a large bonfire.

Blood Drives – During the year, Vitalant Services comes to Westwood and gets student & staff volunteers to donate blood and help those in need. Students 16 and older can get forms in the bookstore.

Homecoming Week – takes place the week of homecoming. Student Council prepares spirit activities throughout the week. Friday there is an assembly in the morning and a parade & tailgate party before the football game. The homecoming king & queen will be announced at the football game. On Saturday the Homecoming Dance will take place in the gym.

Curtain Time is a talent show that all Westwood students can audition for.

Canticles & Carols is a winter concert put on by Westwood choirs. There is one show on a Sunday in December.

Holiday Tree Competition – Student Council places trees in the front office. Each class decorates a tree for Natani Points.

Holiday Doors – Each homeroom decorates their door. Student Council judges and awards a prize for the best decorated door.

Cultural Week – A week set aside to celebrate Westwood's diversity. The week ends with a cultural assembly made up of acts representing the many cultures of Westwood.

During February – Student Council makes hearts to hang in the main hall of the academic building with all the student's names.

Grad Caps – Paper graduation caps with senior names are hung in the main hallway of the academic building the last week of school in May.

Senior Varieties – A talent show held in May that consists of only senior performances.

Dances – Homecoming, Winter Formal, Sadie Hawkins & Prom

Awards – Department Awards Breakfast, Personal Choice Awards Breakfast, Scholarship & Awards assembly.

Westwood High School DEVICE PROTECTION PLAN (DPP)

As part of the district's 1:1 technology initiative, parents have the option to enroll in the district's Device Protection Plan (DPP). Enrollment in the plan will minimize the potential repair and/or replacement costs associated with the device.

By selecting this plan on the Technology Device User Agreement, you agree to pay an annual fee of \$30 to be enrolled in the DPP. If a device becomes damaged, your student will take it to the school's repair center and pay a \$20 fee for repair. If the device is lost or stolen, a fee of \$200 will be assessed. These fees apply to each occurrence. Enrollment in the DPP does not begin until the annual \$30 payment has been received.

What's covered under the plan

- Accidental damage, such as cracked screens or cases, broken keyboards, etc.
- Battery replacement (if it is determined that the battery is malfunctioning)
- Loss of power cord or stylus
- Replacement of lost or stolen device. If the device is stolen, a police report must be filed with a copy of the report sent to the district.

Intentional damage to the device is not covered under the plan.

Device Protection Plan

Skyline, Westwood, Red Mountain & Dobson

Repair & Replacement Costs - Lenovo		
	With DPP	Without DPP
Device Replacement	\$200.00	\$575.00
Motherboard	\$20.00	\$200.00
Screen repair or replacement	\$20.00	\$125.00
Battery (internal)	\$20.00	\$50.00
Power Cord	\$10.00	\$15.00
Keyboard Cover	\$20.00	\$30.00
Cover (top or bottom)	\$10.00	\$25.00
Keyboard	\$10.00	\$20.00
Stylus	\$10.00	\$25.00
SD Reader **	\$20.00	\$40.00

Mountain View & Mesa High

Repair & Replacement Costs - Dell		
	With DPP	Without DPP
Device Replacement	\$200.00	\$430.00
Motherboard	\$20.00	\$208.00
Screen repair or replacement	\$20.00	\$130.00
Battery (internal)	\$10.00	\$15.00
Power Cord	\$20.00	\$35.00
Keyboard Cover	\$10.00	\$15.00
Cover (top or bottom)	\$5.00	\$8.00
Keyboard	\$5.00	\$7.00
Stylus	\$10.00	\$20.00
SD Reader **	\$20.00	\$208.00

**Built into Motherboard

The above prices are estimates, as exact costs for each repair will be made upon further inspection of the damaged device.

Parents and students who choose not to purchase the Device Protection Plan are responsible for 100 percent of all repair and replacement costs for the device.

Should your student's device become damaged, they will be provided a loaner device while their assigned device is being repaired. This loaner device may not be of equivalent performance or features.

***** All repairs must be made by MPS certified technicians *****

Westwood High School

LAPTOP ETIQUETTE

DO

- Charge your 1:1 laptop at home nightly
- Bring your fully charged 1:1 laptop to school every day
- Conduct all communication in a responsible, ethical and polite manner. Appropriate language should be used in all communication at all times.
- Respect the district rules for Internet filtering and security measures.
- Use technology for school-related purposes only during the instructional day.
- Respect copyright laws and fair use guidelines and only download or import music, video or other content that is legally permissible by law.
- Make available for inspection by an administrator or teacher any messages or files sent or received to or from any location using your laptop. Files stored on district-owned technology are not private insofar as they may be viewed, monitored or archived by the district at any time.
- Do not run with the laptop, or carry it around when open.
- Place the laptop securely on your desk, not hanging over the edge
- Make sure your hands are clean and dry before handling laptop or touching the screen
- Use only your laptop, and keep it safe, secure and in good working order
- Follow the Mesa Public School Computer Ethics policy

DON'T

- Don't eat or drink while using the laptop.
- Don't mark, deface, or place stickers on your laptop.
- Don't reveal or post personal information through communication with unknown persons on the Internet
- Don't attempt to override, bypass or otherwise change the Internet filters installed by the district
- Don't use another person's account or password, and don't share your information
- Don't loan out your laptop, leave it unattended, or leave it in a vehicle unattended
- Don't leave your stylus on the table, always replace in the holder
- Don't download and/or install any programs, files or games from the internet or other sources. This includes viruses or other malicious software.
- Don't attempt to locate, view, share or store any material that is unacceptable in a school setting

THESE GUIDELINES APPLY TO LAPTOP USE AT HOME AND AT SCHOOL



Mesa Public Schools supports dress and grooming standards that ignite a culture of learning and well-being. Students are expected to dress in a manner that is appropriate for the school day or for any school-sponsored event. Dress and grooming standards will be applied consistently and enforcement of these standards will minimize the loss of educational time.

General requirements

- Clothing must include a top and a bottom (such as pants, skirt, shorts or the equivalent), or a one-piece outfit (such as a dress or jumpsuit).
- Clothing must cover the entire midriff, with material that covers the front, back and sides.
- Clothing must cover all private body parts and/or undergarments and must not be see-through.
- Tops and one-piece outfits must be secured with material at the shoulders or neck.
- Clothing may not cover a student's face to the extent that the student is not identifiable (except clothing worn for health and safety, medical, or religious purposes).
- Footwear such as shoes, sandals or boots shall be worn in the school buildings at all times, and must be both safe and non-destructive to school property.
- Headwear, including but not limited to hats, hoodies and bandanas are permitted in school buildings. All headwear must allow the ears and face to be visible and not interfere with the line of sight to any student or staff (except clothing/headwear worn for health and safety, medical or religious purposes).

Prohibited apparel and items

Students are not permitted to wear clothing, jewelry or personal items that:

- Substantially disrupt or materially interfere with the learning process
- Contribute to a hostile or intimidating environment
- Advocate or promote
 - Violence or acts of terror
 - Criminal activity
 - Pornography
 - Use of drugs or alcohol
- Use or depict hate speech
- Threaten the health or safety of any other student or staff member

For additional information, please visit mpsaz.org/students/dresscode

Escuelas Públicas de Mesa

Vestimenta y Cuidado Personal



Las Escuelas Públicas de Mesa apoyan los estándares de vestimenta y cuidado personal que fomentan una cultura de aprendizaje y bienestar. Se espera que los estudiantes se vistan de una forma apropiada para el día escolar o para cualquier evento patrocinado por la escuela. Los estándares de vestimenta y cuidado personal se aplicarán de manera consistente y el cumplimiento de estos estándares minimizará la pérdida de tiempo educativo.

Requerimientos generales

- La ropa debe incluir una prenda superior y una prenda inferior (como pantalones, falda, pantalones cortos o su equivalente) o un atuendo de una sola pieza (como un vestido o un mono pantalón).
- La ropa debe cubrir todo el abdomen, con material que cubra el frente, la espalda y los costados.
- La ropa debe cubrir todas las partes privadas del cuerpo y/o la ropa interior y no debe ser transparente.
- Las prendas superiores y los conjuntos de una sola pieza deben asegurarse con material a los hombros y el cuello.
- La ropa no puede cubrir el rostro de un estudiante a la medida de que el estudiante no sea identificable (excepto la ropa que se usa con fines de salud y seguridad, médicos o religiosos).
- El calzado como zapatos, sandalias o botas se debe usar en los edificios escolares en todo momento y debe ser seguro y no destructivo para la propiedad escolar.
- Los accesorios en la cabeza son permitidos, incluyendo pero no limitados a sombreros, sudaderas con capucha y pañuelos. Todos los accesorios en la cabeza deben permitir que las orejas y la cara sean visibles y no interfieran con la línea de visión de ningún estudiante o personal docente (excepto ropa, accesorios en la cabeza usados por motivo de salud y seguridad, médicos o religiosos).

Ropa y artículos antirreglamentarios

No se permite que los estudiantes usen ropa, joyas o artículos personales que:

- Interrumpen sustancialmente o interfieren materialmente con el proceso de aprendizaje.
- Contribuyen a un entorno hostil o intimidante
- Abogen o promueven
 - Violencia o actos de terror
 - Actividad criminal
 - Pornografía
 - Uso de drogas o alcohol
- Usen o representen un discurso de odio.
- Amenacen la salud o seguridad de cualquier otro estudiante o miembro del personal.

Para mayor información, visite mpsaz.org/students/dresscode



IT'S YOUR SCHOOL.
YOU DESERVE A SAFE PLACE TO LEARN.

TAKE A STAND

Do you know of someone
who could hurt you or others?

CALL

480-472-STOP

STOP the drugs | STOP the violence | STOP the weapons

Report weapons or crimes anonymously.
Give as much information as you can.

480-472-7867 • 24 HOURS A DAY

A SILENT WITNESS
PROGRAM

mesa
PUBLIC SCHOOLS

WESTWOOD HIGH SCHOOL



ADMINISTRATION

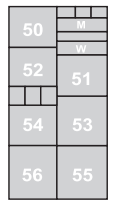
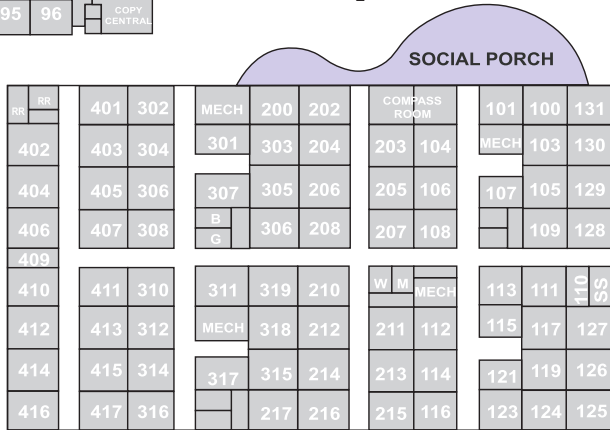
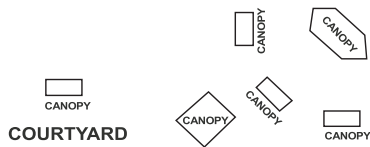
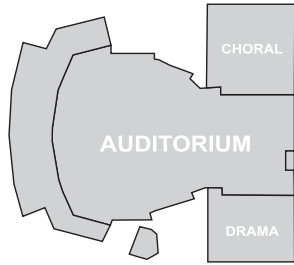
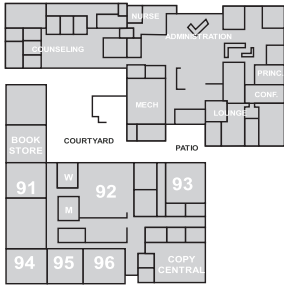

SCIENCE BLDG

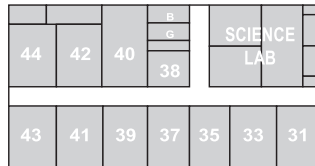

SPORTS ANNEX

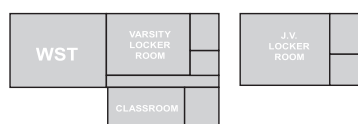

MUSIC

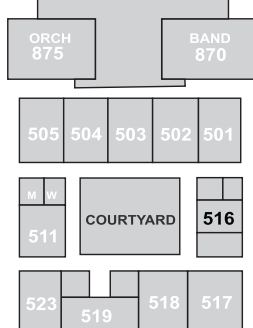

FINE ARTS

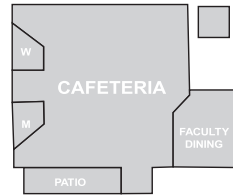

RAMADA

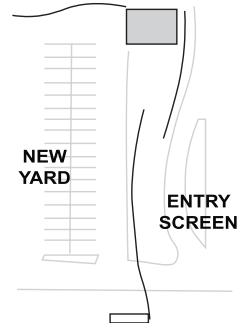
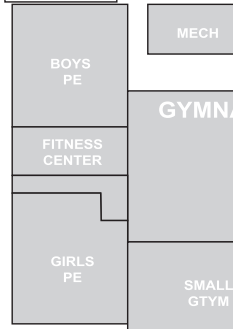

900 PATHWAY

AG / BIO TECH / AUTO SHOP

