

April 25, 2018

**WILLINGBORO TOWNSHIP BOARD OF EDUCATION  
SPECIAL MEETING - REORGANIZATION  
WEDNESDAY APRIL 25, 2018**

The Special Meeting/Re-Organization of the Willingboro Board of Education was held on Wednesday April 25, 2018 in the Board Room of the Country Club Administration Building. The meeting was called to order by Board President Tonya Brown at 6:03 PM.

The opening statement was read as follows:

In compliance with the Open Public Meetings Act, this is to announce that adequate notice of this meeting has been satisfied.

On April 19, 2018 advanced written notice of this meeting was posted on the bulletin board outside the Board Secretary's Office.

On April 19, 2018 advanced written notice of this meeting was emailed to the Courier Post, 301 Cuthbert Blvd., Cherry Hill and the Trenton Times, 413 Riverview Plaza, Trenton, NJ.

On April 19, 2018 advanced written notice of this meeting was filed with the Township Clerk.

The Board Secretary shall enter into the minutes of this meeting, this public announcement.

**PLEDGE OF ALLEGIANCE**

**ROLL CALL**

|                       |          |                |                 |               |         |
|-----------------------|----------|----------------|-----------------|---------------|---------|
| Sarah Holley          | -        | Present        | Felicia Hopson  | -             | Absent  |
| Gary Johnson          | -        | Present        | Grover McKenzie | -             | Present |
| Jennifer Noble-Slaton | -        | Present        | Dennis Tunstall | -             | Absent  |
| Debra Williams        | -        | Absent         | Kimbrali Davis  | -             | Absent  |
| Tonya Brown           | -        | Present        |                 |               |         |
| <b>9 Members</b>      | <b>5</b> | <b>Present</b> | <b>4</b>        | <b>Absent</b> |         |

Debra Williams arrived @ 6:09 (PM)

Dennis Tunstall arrived @ 6:18 (PM)

Kimbrali Davis arrived @ 6:23 (PM)

Administrators Present: Dr. Ronald G. Taylor, Superintendent of Schools, Kelvin L. Smith, Business Administrator/Board Secretary, Dr. Dale Talbert, Deputy Assistant Superintendent, Teresa-Anne Lucas, Assistant Superintendent, Dr. Melody Alegria, Director of Special Services, Stacey Robinson, Director of Personnel, Dr. Adrian Cora-Waters, Director of Special Projects, Ron Zulika, Director of Curriculum and Instruction, Shannon Carey, Comptroller, Kim Belin, Board Attorney/Solicitor and Evelyn Holland, Assistant to Board Secretary.

April 25, 2018

## **APPROVAL OF DRAFT AGENDA**

Be it resolved that the Willingboro Board of Education approves the draft agenda.

Moved by Sarah Holley

## **APPROVAL OF DRAFT AGENDA**

Seconded by Grover McKenzie

A roll call resulted as follows:

|                 |   |     |                       |   |     |
|-----------------|---|-----|-----------------------|---|-----|
| Sarah Holley    | - | Yes | Gary Johnson          | - | Yes |
| Grover McKenzie | - | Yes | Jennifer Noble-Slaton | - | Yes |
| Tonya Brown     | - | Yes |                       | - |     |

5 Voting: 5 Affirmatives, 0 Negatives, 0 Abstentions

## **MOTION PASSED**

## **BOARD MEETING COMMENTS**

### **Board President's Statement**

Often times it may appear to members of our audience that the Board of Education takes action with very little comment and in many cases a unanimous vote. Before a matter is placed on the agenda at a public meeting, the administration has thoroughly reviewed the matter with the Superintendent of Schools/Chief School Administrator (CSA). If the Superintendent of Schools/Chief School Administrator is satisfied that the matter is ready to be presented to the Board of Education, it is then referred to the appropriate board committee. The members of the board committee work with administration and the Superintendent to assure that the members fully understand the matter. When the committee is satisfied with the matter, it is presented to the Board of Education for discussion before any final action is taken. Only then, is it placed on the agenda for action at a public meeting.

## **SUPERINTENDENT**

- Dr. Taylor acknowledges the tragic fire that took place in community on Monday. He mentioned that there were staff and students displaced by the incident and that Alpha Baptist Church along with the PTA's will be collecting donations for families. Each school will have a collection. Any monetary donations should be given directly to the church. Rev. Scotton has agreed to partner with the school district. Please keep those effected in your prayers.
- He also mentioned he had a chance to meet with the school leadership team at Willingboro High School and the body president Ms. Patel was unable to meet. However, she did send a note that Willingboro High School was also collecting goods, clothing and toiletries for those who were affected by the fire, up until May 25<sup>th</sup>.

## **RE-ORGANIZATION PRESENTATION**

Dr. Taylor began with a slide show of the presentation which included the following:

### **Purpose**

- Re-organization Possibilities for 2018-2019 SY
- Enrollment
- Special Education
- Transportation
- Staffing
- Options
- Alternative School/TOPS

Dr. Taylor discussed some options for re-organization of district. Last meeting board made request to look at other options. He mentioned he received recommendations from members of the public as well as members of the administration.

- The 160-180 students that are supposed to go to Benjamin Banneker, we have to make assumption that they will attend.
- With enrollment not including the charter school, we see a trend of reduction of students over a 10 year span.
- Showed a breakdown of the remaining three elementary schools and how many classes needed and how many students in each class. Also showed how many teachers would be needed. This break down included special education students.
- Discussed that transportation would be going out for bid and it would be based on the current design which is  $\# \text{ of routes} \times \text{cost} \times \# \text{ of days}$ . Students receive busing if they are more than 2 miles from school. However, zones overlap and most boundaries are less than 2 miles.
- All kindergarten students attending J. C. Stuart Early Childhood Center would be bused. Pre-K busing isn't mandatory unless special education or unsafe crossing areas.
- District is responsible for busing of Benjamin Banneker students if more than 2 miles.

**RE-ORGANIZATION PRESENTATION (cont'd)**



**2018-2019 Re-Org Possibilities  
Willingboro Public Schools**

**Dr. Ronald G. Taylor  
Superintendent of Schools**

**RE-ORGANIZATION PRESENTATION (cont'd)**

# **Purpose**

---

- ▶ **To discuss re-organization possibilities for the 2018-2019 school year including:**
  - ▶ **Enrollment;**
  - ▶ **SPED;**
  - ▶ **Staffing;**
  - ▶ **Transportation;**
  - ▶ **Options A, B, C & D; and**
  - ▶ **Alt School/TOPS.**

RE-ORGANIZATION PRESENTATION (cont'd)

Current Enrollment  
and  
Building Capacities

**RE-ORGANIZATION PRESENTATION (cont'd)**

**Current School Building  
Specs and Enrollment**

---

| <b>School</b> | <b># of Classrooms</b> | <b># of Students *</b> |
|---------------|------------------------|------------------------|
| JCS           | 36                     | 423                    |
| GFE           | 34                     | 371                    |
| TWH           | 31                     | 357                    |
| VRJ           | 30                     | 435                    |
| Haw           | 30                     | 458                    |

**RE-ORGANIZATION PRESENTATION (cont'd)**

**\*Current Enrollment by Grade Level**

---

| Pre K | K   | 1 <sup>st</sup> | 2 <sup>nd</sup> | 3 <sup>rd</sup> | 4 <sup>th</sup> | 5 <sup>th</sup> | 6 <sup>th</sup> | 7 <sup>th</sup> | 8 <sup>th</sup> | 9 <sup>th</sup> | 10 <sup>th</sup> | 11 <sup>th</sup> | 12 <sup>th</sup> |
|-------|-----|-----------------|-----------------|-----------------|-----------------|-----------------|-----------------|-----------------|-----------------|-----------------|------------------|------------------|------------------|
| 213   | 267 | 295             | 301             | 309             | 342             | 316             | 265             | 232             | 239             | 203             | 176              | 164              | 193              |

\*180 Students are targeted to be enrolled at BBPrep in sy 2018-2019 - grades 1<sup>st</sup> – 6<sup>th</sup>



**RE-ORGANIZATION PRESENTATION (cont'd)**

**Enrollment Trends  
(not including Charter Expansion for 2018-2019)**

| <b>YEAR</b>      | <b>K to 5</b> | <b>6 to 8</b> | <b>9 to 12</b> | <b>Total</b> |
|------------------|---------------|---------------|----------------|--------------|
| <b>2008-2009</b> | 2120          | 1048          | 1142           | 4341         |
| <b>2009-2010</b> | 2146          | 1012          | 963            | 4419         |
| <b>2010-2011</b> | 2007          | 1037          | 938            | 4286         |
| <b>2011-2012</b> | 2006          | 1033          | 881            | 4233         |
| <b>2012-2013</b> | 2004          | 870           | 826            | 3976         |
| <b>2013-2014</b> | 2011          | 791           | 800            | 3888         |
| <b>2014-2015</b> | 1898          | 819           | 792            | 3737         |
| <b>2015-2016</b> | 1888          | 803           | 756            | 3686         |
| <b>2016-2017</b> | 1917          | 793           | 752            | 3683         |
| <b>2017-2018</b> | 1822          | 739           | 754            | 3532         |

**RE-ORGANIZATION PRESENTATION (cont'd)**

# Enrollment Trends (not including Charter Expansion for 2018-2019)

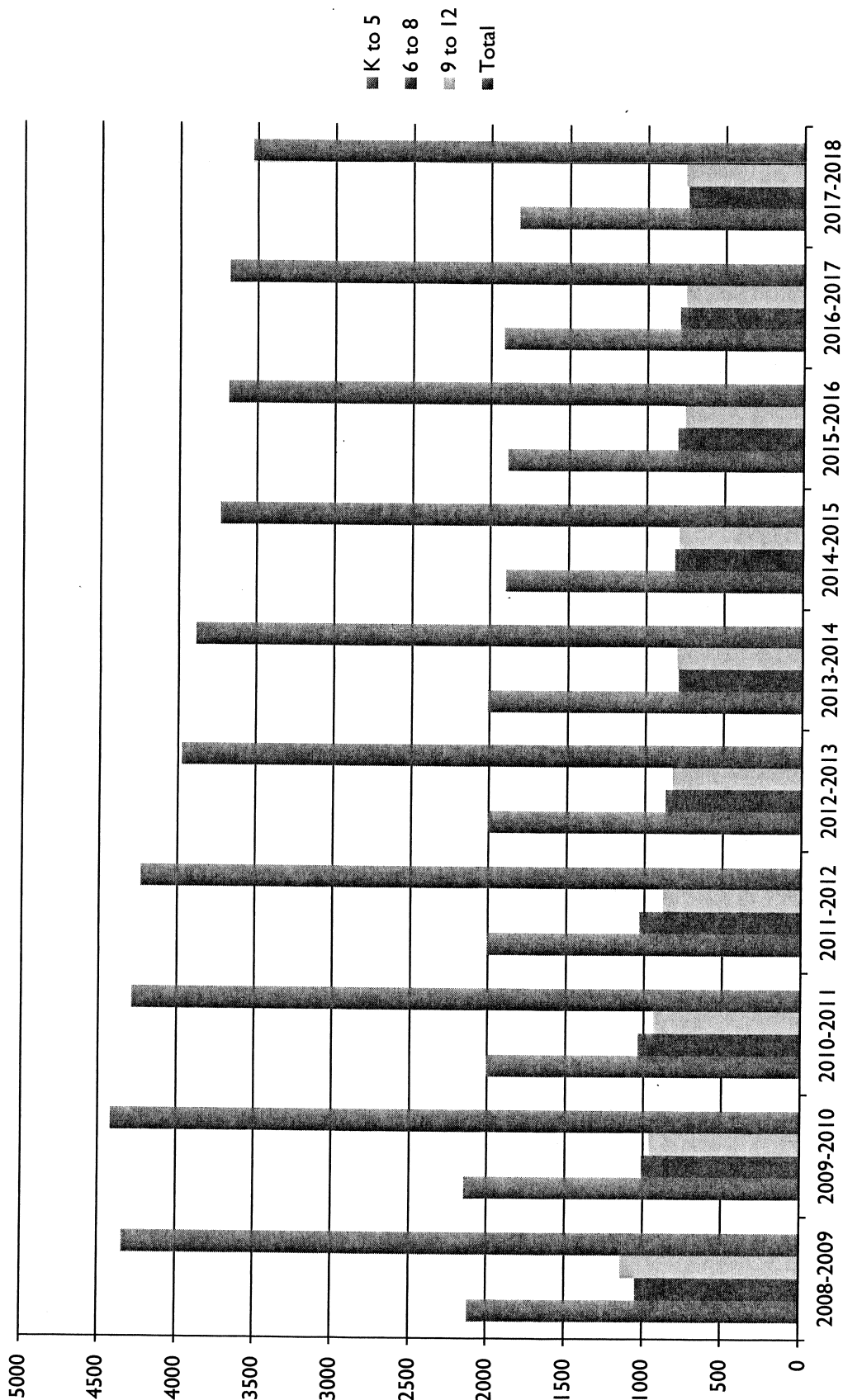

**RE-ORGANIZATION PRESENTATION (cont'd)**

**Population Trends –NJ Counties\***

| Location   | Data Type | 2011    | 2012    | 2013    | 2014    | 2015    |
|------------|-----------|---------|---------|---------|---------|---------|
| Atlantic   | Number    | 63,026  | 62,646  | 61,824  | 60,845  | 60,132  |
| Bergen     | Number    | 202,266 | 201,282 | 202,419 | 202,136 | 201,429 |
| Burlington | Number    | 102,341 | 100,920 | 99,733  | 97,552  | 96,373  |
| Camden     | Number    | 123,159 | 121,732 | 120,761 | 119,156 | 118,299 |
| Cape May   | Number    | 17,854  | 17,571  | 17,274  | 17,005  | 16,672  |
| Cumberland | Number    | 37,464  | 37,525  | 37,493  | 37,009  | 36,586  |
| Essex      | Number    | 193,366 | 192,607 | 191,819 | 192,201 | 191,267 |

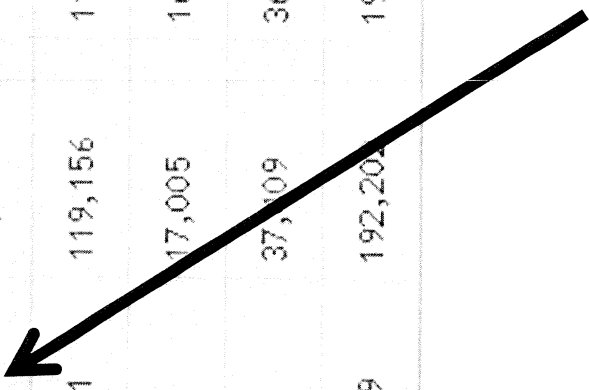

\*kidscount.org

**RE-ORGANIZATION PRESENTATION (cont'd)**

**Special Education**

RE-ORGANIZATION PRESENTATION (cont'd)

**Re-Org Concerns and Special Needs**

- ▶ Approximately 34 SPED Classrooms are going to be needed in our ECHC and 3 remaining Elementary Schools:

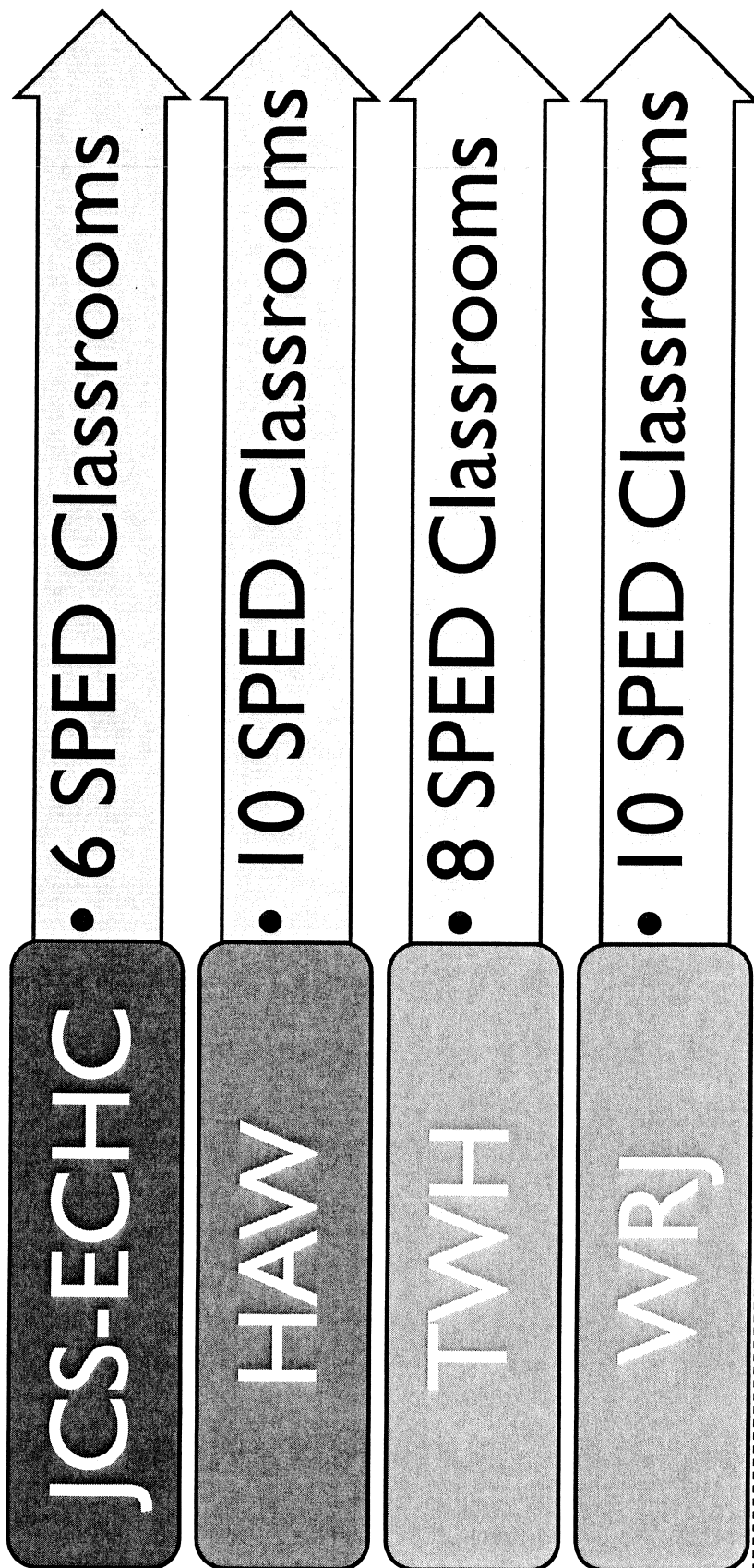

RE-ORGANIZATION PRESENTATION (cont'd)

## Re-Org Concerns and Special Needs

Approximately 34 SPED Classrooms are going to be needed in our ECHC and 3 remaining Elementary Schools:

- ▶ There are approximately 457 SPED students who would require service (1830 current K-5 x 25%);
- ▶ Divided evenly that is approximately 152 SPED students per building elementary school-(worst case scenario).
- ▶ That leaves approximately **310 students on average** per the three elementary schools estimate (1<sup>st</sup> thru 5<sup>th</sup>); and,
- ▶ At 22 students per general education class, divide by 310 total general education students results in a need for 15 general education classrooms on average.

**RE-ORGANIZATION PRESENTATION (cont'd)**

**Re-Org Concerns and Special Needs**

- ▶ “22 students per general education class, divided by 310 total general education students, results in a need for 15 general education classrooms on average.”

| School | Total Classrooms | Classrooms Required for Special Needs | Remaining classrooms for General ED |
|--------|------------------|---------------------------------------|-------------------------------------|
| JCS*   | 36 classrooms    | 6 SPED                                | 30 Available                        |
| TWH    | 31 classrooms    | 8 SPED                                | 23 Available                        |
| WRJ    | 30 classrooms    | 10 SPED                               | 20 Available                        |
| HAW    | 30 classrooms    | 10 SPED                               | 20 Available                        |

\*Early Childhood Grant methodology applied

**RE-ORGANIZATION PRESENTATION (cont'd)**

# Staffing



**RE-ORGANIZATION PRESENTATION (cont'd)**

**Current Teacher K-8**

---

- ▶ **K - 5<sup>th</sup> Grade**
- ▶ **80 General Ed (K-5)**
- ▶ **28 Specialists**  
**(PE/Art/Computer/Music/library)**
  
- ▶ **6<sup>th</sup>- 8<sup>th</sup> Grade**
- ▶ **36 General Ed (6-8)**
- ▶ **11 Specialists**  
**(PE/Art/Computer/Music/library)**

**RE-ORGANIZATION PRESENTATION (cont'd)**

## Currently Teacher K-8

---

- ▶ 11 Kindergarten teachers subtracted for ECHC, leaves 69 General ED Teachers 1<sup>st</sup> thru 5<sup>th</sup> Grade (Currently); and,
- ▶ When Special Education Students are removed, that leaves approx 930 General Education 1<sup>st</sup> thru 5<sup>th</sup> Grade Students (310 per school GE & 152 SPED);

RE-ORGANIZATION PRESENTATION (cont'd)

## Currently Teacher K-8

---

- ▶ 930 students divided by the current 69 General Ed 1<sup>st</sup> thru 5<sup>th</sup> grade teachers equals approx 13.5 students to teacher ratio; and,
- ▶ If reduced by 10 Teachers (some through attrition already), the remaining General Education ratio would be less than 16 students to each teacher.
- ▶ That leaves 4 teacher cuts to be taken from specialists and/or secondary positions.

**RE-ORGANIZATION PRESENTATION (cont'd)**

# Transportation

RE-ORGANIZATION PRESENTATION (cont'd)

## Context...

- ▶ In 2010 when our school district was re-organized, the Transportation Coordinator went out for a bid and received a 3 year contract that saved the District approx \$300k per year;
- ▶ This was achieved by having just a few minutes difference in start times to and fluidity between the schedules of school types i.e. Elementary, Middle and High; and,
- ▶ With that being said, the estimated increases in transportation for each option that follows is a **worst case scenario** and does not represent what could possibly be saved when we went out for a 're-bid' (Approved by the Board on 4/24/18).
  - ▶ Transportation formula is # of bus routes x cost per route (\$150) x 180 days per school year.

RE-ORGANIZATION PRESENTATION (cont'd)

# Reorganization Plan Needs

---

Additional busing will be required to accommodate students living more than two miles from school.

1. Significant numbers of Kindergarten students attending J.C. Stuart School will require busing (if parents choose this option);
  2. All students added to the expansion for busing to Benjamin Banneker Prep. Charter School require busing (if eligible);
  3. Any student assigned to an elementary (W.R. James, Hawthorne, and Twin Hills) and is more than two miles away would require busing to be offered; and,
  4. If 5<sup>th</sup> graders attend school at the Levitt building, busing would emulate the current setup for 6<sup>th</sup> graders.
-

RE-ORGANIZATION PRESENTATION (cont'd)

# J.C. Stuart School



- The map is a sample of what to expect for the upcoming school year. Students living outside of the **Non-Eligibility Zone (NEZ)** would need to be offered busing to school.
- An estimated 110 students would need busing. Each bus will be staffed with an extra bus aide to effectively work with this younger population of students

RE-ORGANIZATION PRESENTATION (cont'd)

# W.R. James, Twin Hills & Hawthorne

---

- A district map would need to be established to identify what schools students shall be assigned to;
  - The NEZ's for each school overlap the other two. With the proper planning, busing will be kept to a minimum if students are assigned to a school that is not more than two miles away from their residences; and,
  - It is projected that each school may require at least one bus for eligible students.
-



RE-ORGANIZATION PRESENTATION (cont'd)

# Benjamin Banneker Prep Charter School

---

The number of BB Prep students will be doubling for the upcoming school year.

- Students residing more than two miles from school will be offered busing (by law);
  - Currently there are three bus routes providing busing to BB Prep's locations; and,
  - It is projected that an additional three routes will need to be provided to accommodate the school's growth.
-

RE-ORGANIZATION PRESENTATION (cont'd)

# Levitt School

Should the 5<sup>th</sup> grade attend school at this location (Option B), busing would be increased to follow the same pattern that has been in place for the 6<sup>th</sup> grade Academy.

- Currently there are ten bus routes providing busing for 6<sup>th</sup>, 7<sup>th</sup>, and 8<sup>th</sup> graders;
- It is projected that an additional four routes will need to be provided to accommodate the 5<sup>th</sup> grades; and,
- In order to properly tier bus routes to maximize the efficiency of the bus and driver, the school's times would need to remain unchanged for the upcoming school year.

RE-ORGANIZATION PRESENTATION (cont'd)

# Budget Impact

- Since the entire transportation needs of the district must be put through the bidding process, the impact will not be fully known until the results are in. To minimize this impact, a entirely new system of tiered routes has been created to provide busing to our students.
- Each tier has been setup to provide busing to at least three schools in most cases. The total number of buses and drivers needed to complete our daily transportation would be close to the current setup:
  - Currently 45 vehicles are necessary to operate 82 routes;
  - The new plan requires 46 vehicles to operate 94 routes.
- The entire plan was conceived to provide the best service to our student's while keeping a tight control over the additional buses needed to execute it.

RE-ORGANIZATION PRESENTATION (cont'd)

**Option A:  
Reduction of  
School(s) to match  
Charter Expansion  
(Least Aggressive)**

**RE-ORGANIZATION PRESENTATION (cont'd)**

**Elementary Re-Org-  
Tentatively Approved**

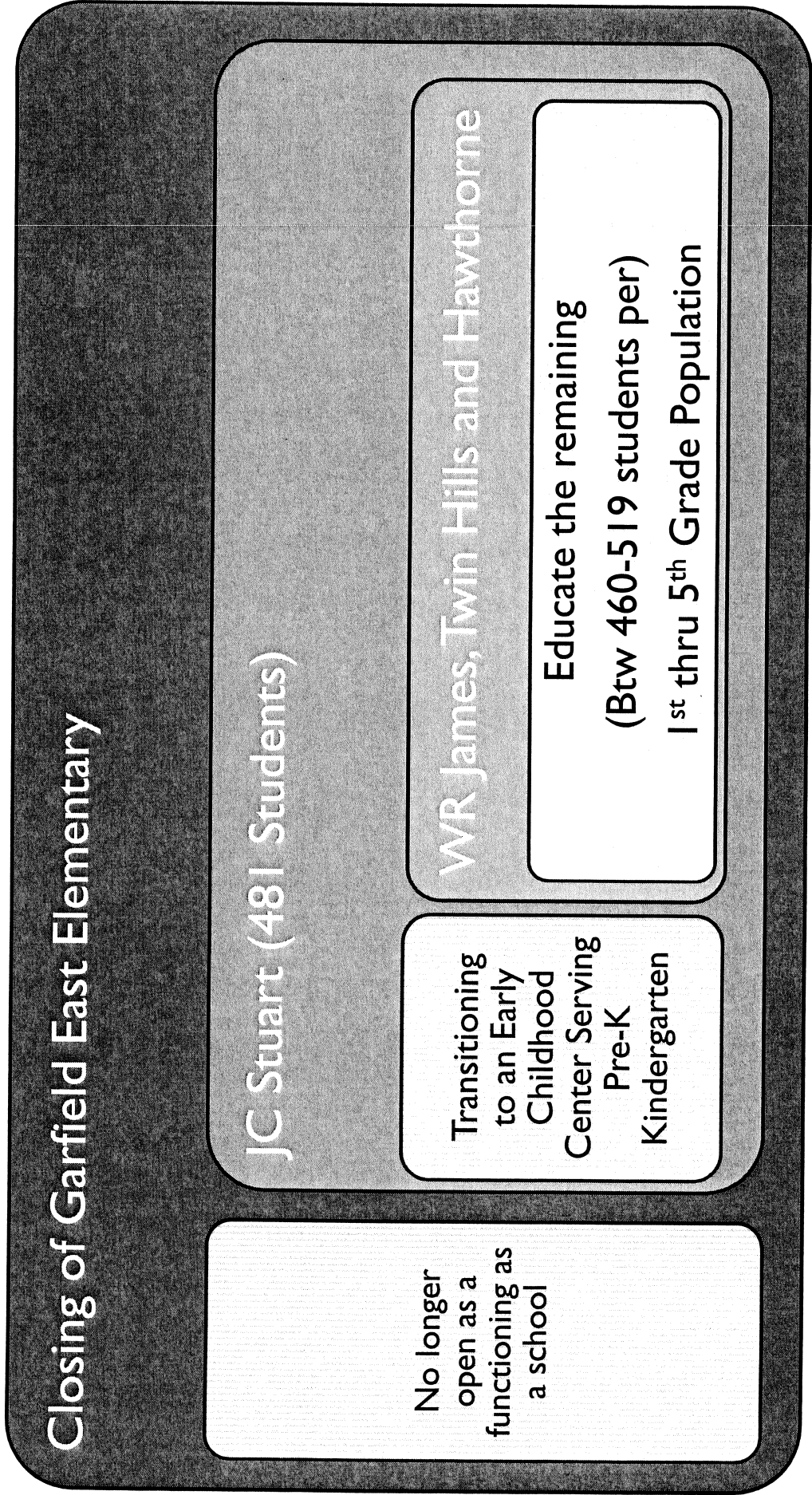

**RE-ORGANIZATION PRESENTATION (cont'd)**

# Option A

JC ECHC  
481 (PreK-K)

HAW  
(Btw 460-519 students  
per)  
1<sup>st</sup> thru 5<sup>th</sup> Grade  
Population

WRJ  
(Btw 460-519 students  
per)  
1<sup>st</sup> thru 5<sup>th</sup> Grade  
Population

TWH  
(Btw 460-519 students  
per)  
1<sup>st</sup> thru 5<sup>th</sup> Grade  
Population

**RE-ORGANIZATION PRESENTATION (cont'd)**

# Elementary Re-Org- Tentatively Approved

## **Pros**

- ▶ Creating an Early Childhood Center;
- ▶ Some what maintaining neighborhood/park school design;
- ▶ Much more efficient use of buildings;
- ▶ Most leadership stays consistent and in place;
- ▶ More resources for each of the remaining Elementary schools;
- ▶ Budget is balanced; and,
- ▶ Reconstituting addresses elementary achievement gap.

## **Cons**

- ▶ Who moved my cheese;
- ▶ Boundary lines will have to be redesigned;
- ▶ Elementary schools will have a dense population...If BBPrep doesn't take what is expected, over crowding could be an issue;
- ▶ Growth (General Ed or SPED) could cause future issue...i.e. no room to grow;
- ▶ Small but significant Bumping and shuffling of staff; and,
- ▶ Small increase in transportation over current year (approx \$189k-worst case scenario)

RE-ORGANIZATION PRESENTATION (cont'd)

Option B:  
Better Use of Levitt to  
lessen Elementary  
Density  
(Aggressive)



**RE-ORGANIZATION PRESENTATION (cont'd)**

**Elementary Re-Org-  
Option-B\***

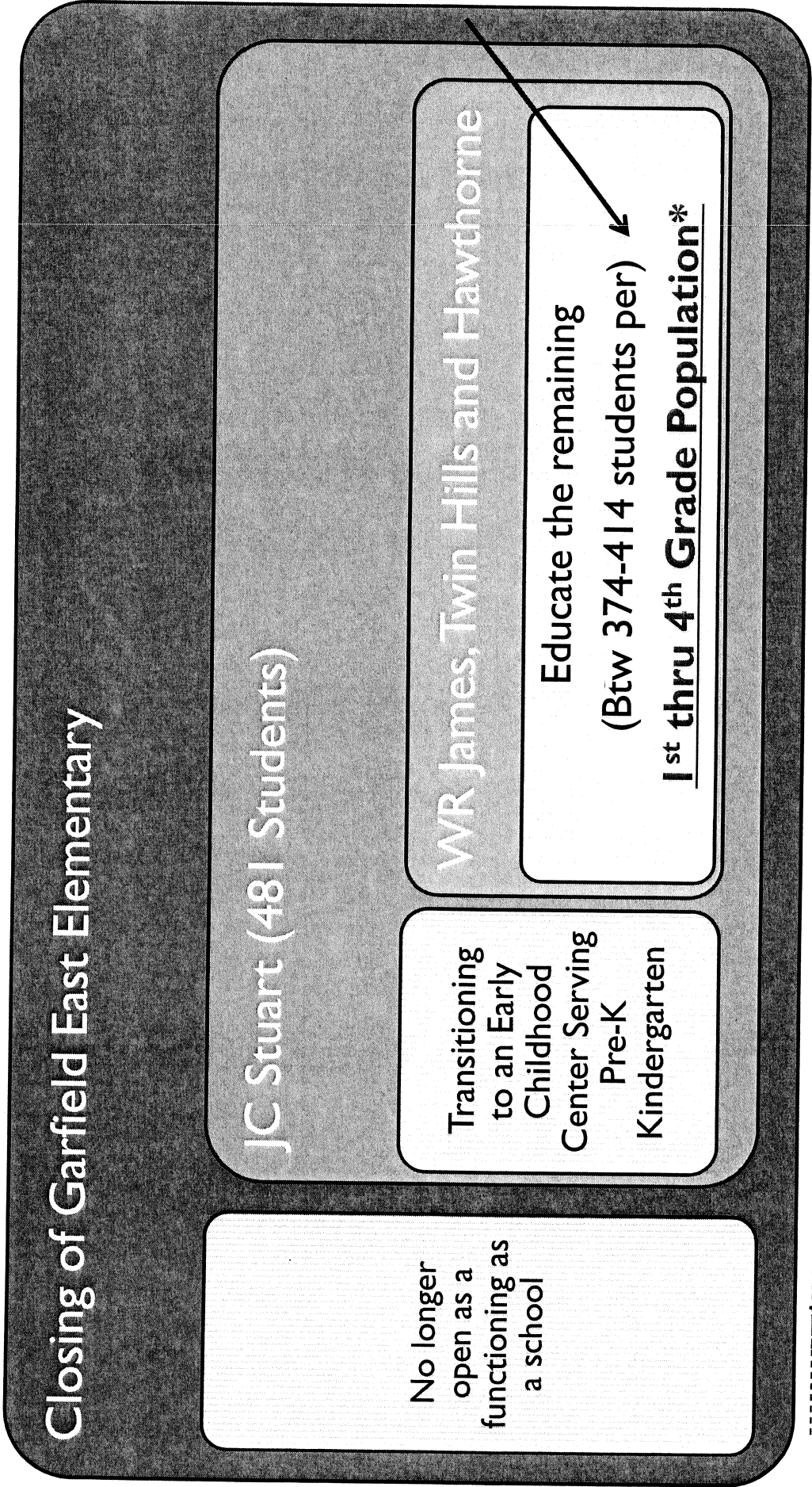

▲ 30 **\*5<sup>th</sup> Grade transitions to Levitt making Levitt a 5<sup>th</sup> and 6<sup>th</sup> grade school-  
Btw 551-581 students**

RE-ORGANIZATION PRESENTATION (cont'd)

# Option B-Less Dense Elementary & Creation of Upper Elementary

---

JCECHC  
481 (PreK-K)

HAW  
(Btw 374-414  
students per)  
1<sup>st</sup> thru 4<sup>th</sup> Grade  
Population\*

WRJ  
(Btw 374-414  
students per)  
1<sup>st</sup> thru 4<sup>th</sup> Grade  
Population\*

TWH  
(Btw 374-414  
students per)  
1<sup>st</sup> thru 4<sup>th</sup> Grade  
Population\*

Levitt  
Btw 551-581  
5<sup>th</sup> and 6<sup>th</sup> Grade  
Population

**RE-ORGANIZATION PRESENTATION (cont'd)**

**Elementary Re-Org-  
Option-B\* (recommended for consideration)**

**Pros**

- ▶ Creates an Early Childhood Center;
- ▶ Less likelihood of overcrowding concerns in Elementary Schools;
- ▶ Levitt Principal position would be created/restored, 6<sup>th</sup> grade Academy Asst Principal would remain (additional oversight);
- ▶ Creation of a new school (Levitt Upper-Ele);
- ▶ Some what maintaining neighborhood/park school design (Levitt much closer to capacity);
- ▶ More efficient use of buildings;
- ▶ Most leadership stays in place;
- ▶ Budget is balanced;
- ▶ Reconstituting addresses achievement gap; and,
- ▶ Room to grow in elementary schools (in case of B.B. Prep students returning, SPED student population increasing, demographics etc.)

**Cons**

- ▶ Who moved my cheese;
- ▶ Boundary lines will have to be redesigned;
- ▶ Cost of one additional Principal restored (approx 100k)
- ▶ Definite possible increase in transportation over current year to transport 5<sup>th</sup> graders (approx \$378k- worst case) total; and,
- ▶ More significant Bumping and shuffling of staff.

RE-ORGANIZATION PRESENTATION (cont'd)

**Option C:  
Make larger schools  
More efficiency=  
More Resources  
(Most Aggressive)**

**RE-ORGANIZATION PRESENTATION (cont'd)**

**Elementary Re-Org-  
Option-C\***

**All 1<sup>st</sup> thru 4<sup>th</sup> Graders go to Levitt – Three  
(3) Elementary Buildings not utilized...**

**JC Stuart (481 Students)**

Transitioning  
to an Early  
Childhood  
Center Serving  
Pre-K  
Kindergarten

**Memorial**

Educate the remaining (800 students)  
**5<sup>th</sup> thru 7<sup>th</sup> Grade Population\***

Between  
1080  
and 1200  
students  
to Levitt

▲ <sup>34</sup> \*8<sup>th</sup> thru 12<sup>th</sup> will attend WHS...Alt School would occupy an Elementary Building-  
940 students (WHS)

RE-ORGANIZATION PRESENTATION (cont'd)

# Option C-Larger Schools

JC ECHC  
481 (PreK-K)

Levitt  
(Btw 1080 and 1200  
students to Levitt)  
1<sup>st</sup> thru 4<sup>th</sup> grade

WHS  
8<sup>th</sup> thru 12<sup>th</sup> will attend  
WHS...  
(Approx 940 students)

Memorial  
(Approx 800 students)  
5<sup>th</sup> thru 7<sup>th</sup> Grade  
Population

**RE-ORGANIZATION PRESENTATION (cont'd)**

**Elementary Re-Org-  
Option-C\* (not recommended)**

**Pros**

- ▶ Creates an Early Childhood Center;
- ▶ Significant savings of school-based leadership cost;
- ▶ Significant savings of essential personnel school based costs;
- ▶ Less likelihood of overcrowding concern in Elementary;
- ▶ Creation of a new school/grade level distribution design;
- ▶ More efficient use of buildings;
- ▶ Budget is balanced;
- ▶ Reconstituting addresses achievement gap; and,
- ▶ More consistency of instruction (more efficient).

**Cons**

- ▶ Who moved my cheese;
- ▶ Boundary lines will have to be redesigned;
- ▶ Bumping and shuffling of both leadership and staff;
- ▶ Total Loss of neighborhood/park school design (State Funded improvements);
- ▶ More empty buildings in the community;
- ▶ Uncertainty of such a large Elementary settings; and,
- ▶ Very significant transportation costs increases by \$648k-worst case scenario.

RE-ORGANIZATION PRESENTATION (cont'd)

**Option D:  
Princeton Plan(ish)  
(Aggressive &  
Innovative)**



**RE-ORGANIZATION PRESENTATION (cont'd)**

# Princeton(ish)

---

JC ECHC  
481 (Prek-K)

HAW  
Btw 415-450  
(1<sup>st</sup> 2<sup>nd</sup> & 3<sup>rd</sup>)

WRJ  
Btw 415-450  
(1<sup>st</sup> 2<sup>nd</sup> & 3<sup>rd</sup>)

TWH  
Btw 312-342  
4<sup>th</sup> Grade

Levitt  
Btw 551-581  
5<sup>th</sup> and 6<sup>th</sup>

RE-ORGANIZATION PRESENTATION (cont'd)

Elementary Re-Org-  
Option-D\* (not recommended)

**Pros**

- ▶ Creates an Early Childhood Center;
- ▶ Less likelihood of overcrowding concern in Elementary;
- ▶ Creation of a new school/grade level distribution design;
- ▶ More efficient use of buildings;
- ▶ Budget is balanced;
- ▶ Reconstituting addresses achievement gap; and,
- ▶ More consistency of instruction (more efficient).

**Cons**

- ▶ Who moved my cheese;
- ▶ Boundary lines will have to be redesigned;
- ▶ Bumping and shuffling of both leadership and staff;
- ▶ Somewhat loss of neighborhood/park school design (State Funded improvements **less effected**) and,
- ▶ Significant transportation costs that could increase by \$486k-worst case scenario.

RE-ORGANIZATION PRESENTATION (cont'd)

**TOPS and Alt School  
Scenarios**

**RE-ORGANIZATION PRESENTATION (cont'd)**

## TOPS and ALT School

---

- ▶ **TOPS-**
- ▶ If option A or B is selected, the TOPS program (3 teachers) will be sent to the remaining three (3) elementary schools where they will serve duties as both G&T Teachers, as well as Instructional Support Teachers (1 per school); and,
- ▶ There would be nominal transportation savings (\$9,000), however it does provide additional in-house targeted academic support that is very valuable.

RE-ORGANIZATION PRESENTATION (cont'd)

## TOPS and ALT School

---

- ▶ **Alternative School-**
- ▶ If 5<sup>th</sup> Graders are added to Levitt we do have the ability to (1) leave the Alt School at Levitt (recommended), (2) move it to Memorial or the (3) High School;
- ▶ The High School and Memorial would not be the best case scenario because of obvious reasons (not seen as a consequence, not separate etc.); and,
- ▶ Lastly, the Alt School could move to an un-used elementary school, however there would be the cost of a nurse, a custodian etc.

**RE-ORGANIZATION PRESENTATION (cont'd)**

# Levitt Building Design

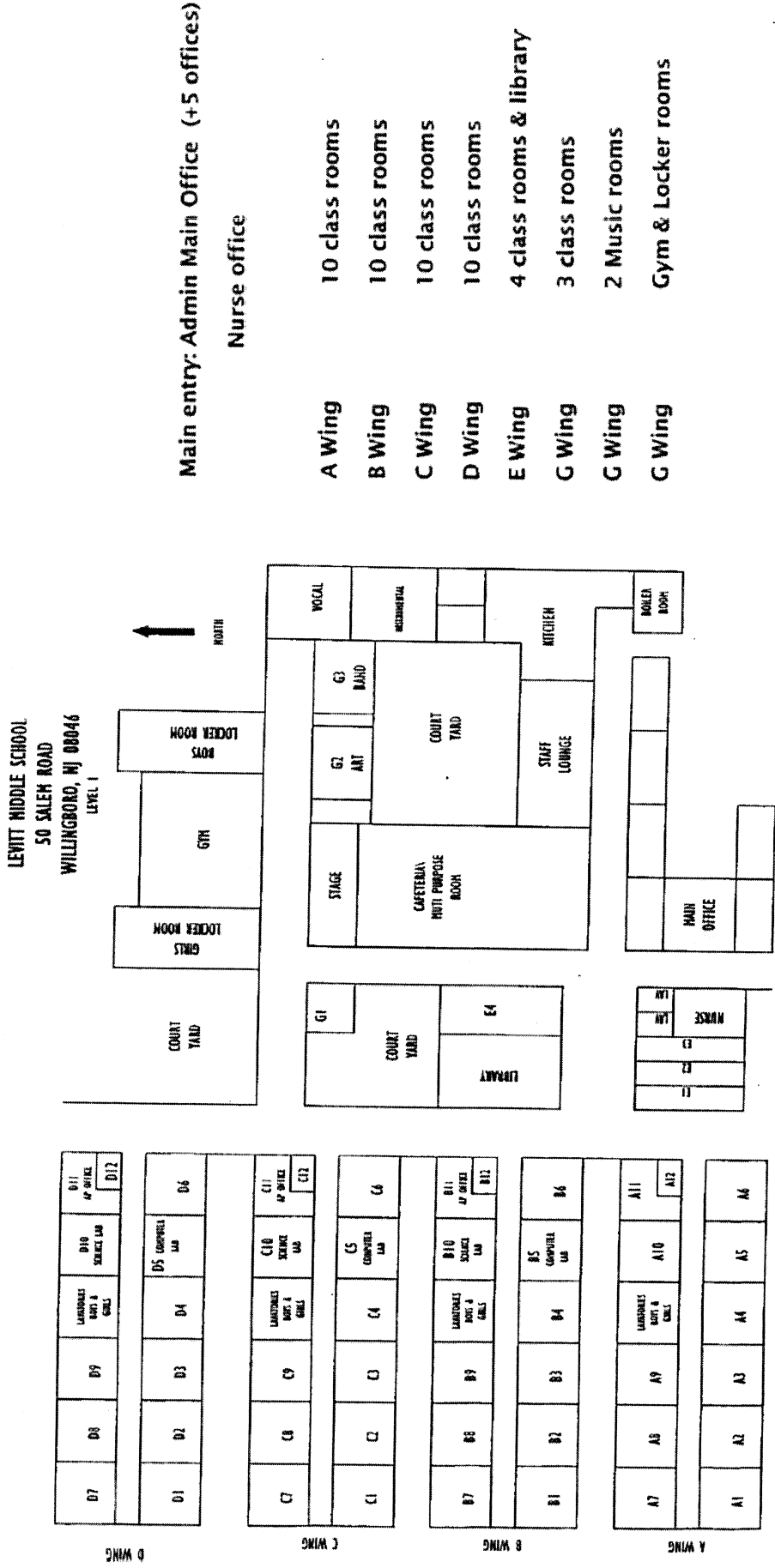

**RE-ORGANIZATION PRESENTATION (cont'd)**

**Current \* School Building Specs and Enrollment**

| School | # of Classrooms | # of Students * |
|--------|-----------------|-----------------|
| JCS    | 36              | 423             |
| GFE    | 34              | 371             |
| TVWH   | 31              | 357             |
| VRJ    | 30              | 435             |
| Haw    | 30              | 458             |

**RE-ORGANIZATION PRESENTATION (cont'd)**

**\*Current Enrollment by Grade Level**

---

| Pre K | K   | 1 <sup>st</sup> | 2 <sup>nd</sup> | 3 <sup>rd</sup> | 4 <sup>th</sup> | 5 <sup>th</sup> | 6 <sup>th</sup> | 7 <sup>th</sup> | 8 <sup>th</sup> | 9 <sup>th</sup> | 10 <sup>th</sup> | 11 <sup>th</sup> | 12 <sup>th</sup> |
|-------|-----|-----------------|-----------------|-----------------|-----------------|-----------------|-----------------|-----------------|-----------------|-----------------|------------------|------------------|------------------|
| 213   | 267 | 295             | 301             | 309             | 342             | 316             | 265             | 232             | 239             | 203             | 176              | 164              | 193              |

\*180 Students are targeted to be enrolled at BBPrep in sy 2018-2019 - grades 1<sup>st</sup> – 6<sup>th</sup>



**RE-ORGANIZATION PRESENTATION (cont'd)**

# Purpose

---

- ▶ To discuss re-organization possibilities for the 2018-2019 school year including:
  - ▶ Enrollment;
  - ▶ SPED;
  - ▶ Staffing;
  - ▶ Transportation;
  - ▶ Options A,B,C &D; and
  - ▶ Alt School/TOPS.

RE-ORGANIZATION PRESENTATION (cont'd)

Thoughts...  
ideas...  
discussions???

April 25, 2018

## **BOARD MEMBER COMMENT**

Dennis Tunstall:

- Asked the Superintendent if it was his recommendation to move the 5<sup>th</sup> grade to Levitt or not and he replied that he would recommend Option B and for the Alternative School to stay where it was.

Gary Johnson:

- Problems with some of numbers as you are aware and I don't see this as the maximum utility of our resources. There was a piece in the local newspaper where the governor and legislator was getting together to talk about school funding and while Willingboro hasn't been mentioned, and I really think unless we're going to do this repeatedly, we need to get down to a sustainable configuration for our schools, and right now, not convinced that Option B is more sustainable for our schools.

Sarah Holley:

- Asked Mr. Johnson what is he proposing. I understand you have a question with Option B, I would like to know for clarity what you are proposing. Explore the idea of (8<sup>th</sup> – 12) at the High School, with (5, 6, 7) at Levitt, (1<sup>st</sup> – 4<sup>th</sup>) in Memorial and (Pre-K & K) J. C. Stuart.

Jennifer Noble-Slaton:

- So with option C you would be recommending to close two additional schools. I don't recommend.

Grover McKenzie:

- I do recall having upper elementary design here in the Township and we moved away from that. Concerned with your recommended option is taking us back to a place we have been. Concerned about the impact on 6<sup>th</sup> grade academy. It has been successful program and successful offering for transitioning kids from the elementary school to middle school, and I also think it has helped us retain students.

Jennifer Noble Slaton:

- Asked the Superintendent to explain why Garfield East was the school selected to be closed as supposed to any other elementary school that might be more desirable to sell the property or do something with the property.

Debra Williams:

- Asked when we shut down a building how much does it cost to maintain?
- Wanted to know if the closing of Garfield East was temporary solution or if down the line if enrollment increased, would it re-open?
- How would the building be maintained?

Gary Johnson:

- Recommended that the Early Childhood Center be at Garfield East instead of J. C. Stuart because it is a residential area and more safe.

April 25, 2018

## **BOARD MEMBER COMMENT (cont'd)**

Dennis Tunstall:

- Board members if you take the time to review the plan carefully, Option B has the least amount of impact on the community and it also gives opportunity to recover if numbers are off, in terms of Benjamin Banneker. I grew up here and nobody wants to close schools. However we have to take the best option presented to us with the least amount of impact on the community and at this time Option B is the best option.

Sarah Holley:

- Comparing Garfield East with J. C. Stuart, for me I wouldn't want to close any school, but financially if you have to look at the number of classrooms at Stuart vs. the number of classrooms at Garfield East. There are more classroom at Stuart so it makes more sense to have the Early Childhood Center there.

Kimbrali Davis:

- My question if with Mr. McKenzie. My son was enrolled in 5<sup>th</sup> and 6<sup>th</sup> when it was at Memorial and I do remember when we moved the 5<sup>th</sup> graders back to elementary and a lot of parents were very thankful, and saying the main reason we kept our kids here in school was because we moved them back, that would be a concern.
- Moving to Levitt, I was a big advocate for 6<sup>th</sup> grade academy, very hopeful. When we finished the renovations for Memorial, at one time we were looking at because it was a temporary thing were we going to move the 6<sup>th</sup> graders back to Memorial once the renovations were done because it can hold all three grades. I was a big advocate to keeping 6<sup>th</sup> grade academy stand-alone transitionally and what it did was able to afford, create a 7<sup>th</sup> grade academy and 8<sup>th</sup> grade academy. With this particular plan I will consider if there is a way to have a 5<sup>th</sup> grade academy and a 6<sup>th</sup> grade academy and they still be separate.

Grover McKenzie:

- Things happen that allow for contract to be re-opened. Seems that this is an opportunity for a partnership with the bargaining unit. Invite them in and partner as we go through this design. The only way this can work if changes we make have an impact on money, because this is all about money and that's why I bring up retirements and possibly re-opening contracts.

Debra Williams:

- Best option would be to get 3 million dollars and not have to close Garfield East.
- Only been on board for a short time and I don't really know my board members too well but I do know that nobody wants to close schools and the best option would be Option B because opening up 100 spaces at each of the elementary schools.
- Looking at other districts in the area, Mt. Laurel and Morristown both have the upper elementary format and their operating unsuccessfully so I don't see why the 5<sup>th</sup> and 6<sup>th</sup> graders being together.

**MOTION FOR 5 MINUTE RECESS @ 7:17**

Moved by Sarah Holley

**MOTION FOR 5 MINUTE RECESS**

Seconded by Dennis Tunstall

A roll call resulted as follows:

|                 |   |     |                       |   |     |
|-----------------|---|-----|-----------------------|---|-----|
| Sarah Holley    | - | Yes | Gary Johnson          | - | Yes |
| Grover McKenzie | - | Yes | Jennifer Noble-Slaton | - | Yes |
| Dennis Tunstall | - | Yes | Debra Williams        | - | Yes |
| Tonya Brown     | - | Yes |                       |   |     |

7 Voting: 7 Affirmatives, 0 Negatives, 0 Abstentions

**MOTION PASSED**

**MOTION TO COME BACK FROM 5 MINUTE RECESS @ 7:22**

Moved by Grover McKenzie

**MOTION FOR 5 MINUTE RECESS**

Seconded by Gary Johnson

A roll call resulted as follows:

|                 |   |     |                       |   |     |
|-----------------|---|-----|-----------------------|---|-----|
| Sarah Holley    | - | Yes | Gary Johnson          | - | Yes |
| Grover McKenzie | - | Yes | Jennifer Noble-Slaton | - | Yes |
| Dennis Tunstall | - | Yes | Debra Williams        | - | Yes |
| Tonya Brown     | - | Yes |                       |   |     |

7 Voting: 7 Affirmatives, 0 Negatives, 0 Abstentions

**MOTION PASSED**

**PUBLIC COMMENT OPENED @ 7:31P.M.**

Dori Hoffman – 23 Garrett Lane:

- When other districts make plans to close schools it usually takes two years. Why not take a whole year to get input from everyone.
- What about moving cost? What will it cost for construction for Pre-K classrooms and bathrooms.
- Will there be time for staff to pack and un-pack, or will it be left counting down to the wire.
- Do we loose money with bond issues?
- Think about the time it will take for 1<sup>st</sup> and 2<sup>nd</sup> grade students to walk. Think about families who have more than one child at a school.
- Autism classes at Stuart, will they be moved or will they be separated up.
- Playground at Garfield East will it be moved, it was just put in.
- It is very difficult with change when people weren't considered. Knew moving in this direction, how come there wasn't a plan?

Jackie Mack – Maplewood Lane:

- Lived in Willingboro for fifty-seven years. Never came to a meeting and been given this. This is unfair to the community. You said this when you tried to push the Princeton Plan.
- Thought tonight we would be talking about Security and Para Professionals with privatizing them.
- My suggestion is to keep things the way they are and maybe move staff from Country Club to Levitt where they use to be and close this building.

April 25, 2018

**PUBLIC COMMENT (cont'd).**

Sherri Fitzpatrick – 34 Tanglewood Drive, Merchantville, NJ:

- Science teacher but would like to take the time to give a history lesson. Been a teacher in the middle schools in Willingboro for over 20 years.
- Was part of the fantastic 5<sup>th</sup> and 6<sup>th</sup> grade building that opened prior to Dr. Taylor coming here, and each grade level had teams which included special education classes on both grade level that met the needs of all types of learning.
- The enrollment in the 5/6 school was high and the test scores increased over the years. It was ran by three phenomenal principals. The 5/6 school was housed at Memorial and the 7/8 school was at Levitt. Dr. Taylor came here and convinced the board that the enrollment was low and decreasing and the test scores were low and decreasing and that the public was unhappy with the 5/6 school. Dr. Taylor was unhappy with the 5/6/ school.
- In reality the decrease in students came when they went to the 7/8 school and that I believe is around the same time Benjamin Banneker was on the table to open and was only open at the time for 7<sup>th</sup> and 8<sup>th</sup> graders.
- Don't understand why we fixed wasn't broken with the 5/6 school. Now want to go back to 5/6 school. Proud to say that the 6<sup>th</sup> grade academy is a huge success and I've been there the entire time. My concern is that the 6<sup>th</sup> graders currently take up the B wing and C wing with all of their classes. How do you plan to fit all of 5<sup>th</sup> and 6<sup>th</sup> graders into three wings.
- What will a schedule look like for a 5/6 school at Levitt? Can't wait until July. Should've started a year ago. What will happen with special areas, and how will it fit in with 5<sup>th</sup> and 6<sup>th</sup> graders.
- What about modified block? Six graders use it but not 5<sup>th</sup> grade. There are a lot of questions that have yet to be answered.
- Need to look at logistics as to how this will work.

Mary Ricker – 400 Wood Street, Burlington, NJ:

- First time came to a board meeting was when she received a resolution that Garfield East was recommended as a Governor's school of excellence signed by Ms. Holley. At that time there were people on the board who had children at Garfield East who now think that their children deserved the quality education and no one else children does. A board that thinks a school is no more than brick and utility bills and students are nothing more than numbers on a power point presentation.
- I volunteer over at Levitt and do see the 6<sup>th</sup> grade academy working well.
- Need to remind the board that staff and students are just like them, which are people of the community.

Vicki Benedict – 16 Palfrey Lane:

- Was at the budget meeting when they voted at last meeting when they voted for the budget, 7 to 1 and 1 abstention.
- Tired of getting beat up about the Governor's meeting. Chesterfield and Kingsway was organized because they've been under funded forever and we found out five day ahead of time that a school was closing.
- Kingsway superintendent grab the major up and said I need some money. I'm sorry but I missed Dr. Taylor being there and there were 10 or 11 WEA members present so leave us alone about the governor because Kingsway and Chesterfield had issues for years.

April 25, 2018

- **PUBLIC COMMENT (cont'd)**
- She quoted that figures don't lie but liars figure.
- So this is all about the budget. The salaries and benefits of the paras, security and teachers slated to be cut, the districts total was about 4 million and mine was about 3 million. At the last meeting Dr. Taylor said the cost for benefits is about \$40,000. It shows that the average for security it's 14k and for paras it's 15k on the document it has every teacher taking the highest plan so how do you know those being cut have a family plan. You giving us numbers but we have to contribute, Chapter 78 we have to contribute towards our benefits, so how much are we really cutting?
- We talk about privatizing para but guess what if you look at these documents in the health benefits line item says we have 2.2 million dollars in it. Remember Mr. Cominski that everyone hates talked about stash money.
- This is the budget that was submitted to the County for the 2018-2019 school year. All of the highlighted items are para professional so are we cutting them or keeping them? Why are security salaries still in there? Why is the supervisor salary going up 200k? So tell me are we privatizing are we not privatizing?
- How can we trust any of these numbers when we know they aren't correct?
- 2/3 of people you want to lay-off live in the community and pay taxes. How about taking a year and talk about it and then decide.

Kara Keefe - 3068 Harper Drive, Willingboro, NJ:

- Have a question about para professionals. If going through an outside source, are those paras going to be trained like the ones we have now. Also, are we guaranteed to have the same paras every day. Right now we can't get the same people two days in a row, so I don't know how we're going to get people here for my autistic students who need consistency.
- Also, it shows that there are 28 Specialist in the elementary schools. I'm a specialist and I can tell you that there are 24, so if you're cutting four in the elementary grades you are cutting 4 that doesn't exist.

Katherine Wiseman –

- Apparently made a racist statement at last meeting and would like to apologize. My attention was to say that we can't go back in time when we looked at the color of a person's skin or the differences that exist between us. I said it differently and offended some people and I would like to thank the members of the community who brought it to my attention.
- As a white American who work with minorities, I need your support to change who I am and I believe all lives matter especially African American lives.
- Possible option to regards to distributing children in our schools. Worked in education for 15 year, (California, New York and Trenton) as a bilingual teacher. I work with some of the most needy children in the United States. I have IEP students who haven't received services, so I understand the school districts. Want to make sure you make the best decision for the kids.

April 25, 2018

**PUBLIC COMMENT (cont'd)**

- I would suggest you make a K-8<sup>th</sup> grade school. Have worked in that setting had integrated co teaching. It had special education students alongside regular education students.
- My ideal is that Garfield East becomes a Pre-K thru 8<sup>th</sup> grade school and it has a significant amount of bathrooms already for the students and you have 8<sup>th</sup> graders who become role models for the younger students. Now they have a responsibility and they don't have to act out and be the top dog in their group. Work side by side to create integrated system to promote advancement in learning. Seen the benefits with older children with younger children. Not for Princeton Plan. Parents need to have a choice. Those who don't want to go to Memorial will have a choice and won't have to go to Benjamin Banneker.

Crystal Wilson – 35 Somerset Drive:

- Most questions answered at last meeting was still unanswered, even after listing to the slide.
- Since you plan to cut teachers, it will increase class sizes and is there currently a cap on class sizes in grades 1<sup>st</sup> thru 8<sup>th</sup> and high school, and if so what is the class sizes? In the slide you mentioned a ration 16 to 1 for general education, how does your special education fit in.
- Busing for the closing of Garfield East and the reorg of Stuart will require busing. What will be the additional cost and why wasn't it added into the budget?
- The start time for students, when will parents be told?
- You mentioned bus aides. Why wasn't that cost added into the proposed budget?
- You mentioned busing not required for Pre-K. Does that mean no busing at all?
- What preparations are being made to make sure all the buildings are up to code and fully equipped?
- Curriculum Writing and training for teachers was approved. When do you plan on giving them there assignments and training and is professional development already in the budget?
- If you privatize paras when will they be trained and will 1 on 1 paras be privatized and what qualifications will they have when dealing with our special needs students. What accountability will they be held to.
- What will happen to Garfield East's money for the upcoming school year and the air conditioning units at Garfield, will they be moved.
- Give teachers the resource they need and students material they need.

Sharon Bronner – 78 Executive Lane:

- Recently moved here a little under a year. My house is about two doors down from Garfield, so if closed my property value will go down and I hear my taxes going up.
- Don't have any students here but here because I'm a concerned parent and community member.
- Wanted to know if Garfield could become a Magnet School, that's when you honor kids and gifted kids in there.
- Wanted to know how it came about that this district was chosen for a charter school and why do we have a 3 billion dollar deficit.



April 25, 2018

**PUBLIC COMMENT (cont'd)**

- If the charter schools can do well, how come the public school can't?
- Would like to know what you receive or what are the benefits of having a charter school here. Would like to see paperwork on expansion of charter school.
- Concerned about 1<sup>st</sup> graders and 5<sup>th</sup> graders having to walk 2 miles to school.
- How is all the students going to fit in the charter school when you said it's only 180 slots and whose the founder of Benjamin Banneker. When I researched on line how charter school was started it states by a parent, community leader or social enterprise or business. So I want to know how did it get started.

Mr. Marino – 73 W. Alston Drive, Bridgeton, NJ:

- Stated he drives 53 miles every day because he loves his job. Started teaching here in 1972 and Willingboro was the greatest place to live and work. It's changed and that's unfortunate. Changes are being made everywhere.
- We are supposed to be here for the kids. It's a shame kids have to deal with this from the social and emotional aspect. Willingboro has the highest foster parent rate in the state and if you look at some of the things they have to deal with even before they get to school, you would think these kids are being failed because they're not getting the support they need.
- In terms of numbers, so many needs. It's not about the money. It should be about the kids.
- I heard a board member say it's about the money. It shouldn't be about the money it should be about the kids.
- So many times pulled out of class because of no subs. By law kids are supposed to have gym. It becomes exhausting and when it's a special ed. classroom, I think there should be 15 paras in a class to help out. What will happen when we lose our paras?
- Don't believe Insight nor Source 4 teachers are doing the job that you hired them to do.

Deidre Jackson – 15 Peppermint Lane:

- I see proposed plan and I understand if you sustain a trend that is declining, we will have only one school because you are going to continue to close them. My question is where do you see our schools in five years if you do not promote a plan that enhances our education and schools then the trend will continue.
- Pre-K is an excellent program, but Willingboro already has pre-K 3 which has a waiting list, I know because I'm on it. How many people are waiting for that because I know it's an increase. So if that is going up, I know you might need the ECC but if that is going up, what are you doing to accommodate the other grades?
- As this board moves from year to year, because that's what you have to do for financial management, where do you see our school in five years if you close another school. I don't see a solution because we can only promote increasing our schools by a better education. Nobody will want to pick public schools over charter if education doesn't improve. It's a parent's point of view.

April 25, 2018

**PUBLIC COMMENT (cont'd)**

- What plans or how do you forecast any of the other school reopening. What programs do you predict will help create a new school to open. Right now we are going by a trend that is decreasing and we can't afford to do that because it will close more schools and next year we will be here saying we lost more students.  
Asking the board where do you see the community in five years with closing of schools, and lost of teachers. Staff is an essential part of community and I understand business but we need to work harder and go after other resources.
- What can the community contribute towards the funds besides taxes?

Ms. Baez – 2 Trinity Lane:

- Came from Jersey City Public school system. When I went there it was Pre-K thru 8<sup>th</sup>. Attended Seton Hall has a bachelor degree and went on to get other degrees.
- If the Township was able to get 10 million to build a fire house, why can't we rebuild our school to one building and where can we get that money from. Where can you foresee in getting that money and save the community money because our taxes pay for the majority of educational services and if you look at the pie chart money is going more to the schools than anywhere else in the township.
- If the students went to a pre-k thru 8<sup>th</sup> grade school, would busing be a possibility? I think we can find someone to bus pre-k through 8<sup>th</sup> and possibly beyond for the safety of our kids.
- What are we doing with the troubled teachers, what are the plans. Are they also moving to the schools that are considered better suited for the teachers. If you put a good apple with a barrel of bad apples that school will become bad. Parents are concerned about some of the bad apples that are tenured.

Ms. Loving – 59 Baldwin Lane:

- Currently have two children in school here. One is in 5<sup>th</sup> grade who will be changing schools this year. I have a straight A student who has never been in trouble. He plays football with the Willingboro Panthers and he also wrestles and holds the national title.
- If you think for one minute I'm going to let my child walk along Van Schiever Parkway to Hawthorne School you have another thing coming. They are long blocks with no crossing guards. I've traveled during rush hour traffic and it's not safe. Didn't want them to walk from Baldwin Lane to J.C. Stuart, it was a transition for them. However, we did take a look at there is a crossing guard there every morning.
- Tried to get both children into Benjamin Banneker. Sorry but there lottery audience puts this audience to shame. It was out the door and the people of Willingboro is looking out for their own children, they were there and I was surprised it was that many there.
- Been a teacher at charter school for 17 years. Currently a math teacher and had 3 years of increasing test scores, double digit scores and it helped my school become a turn around school. I teach 3<sup>rd</sup> grade and Brandon is 3<sup>rd</sup> grade when I showed him what was on the test he couldn't answer the math questions that my students could.

April 25, 2018

**PUBLIC COMMENT (cont'd)**

- Want to know what are your plans to increase your math curriculum? If you don't do something to get the math scores up the state is going to come in anyway.

Elaine Paton – 55 Sunset Road:

- Here tonight a little sad. Wish you guys would give it a year before you move were you're going.
- Found out about it right before spring break, and let me tell you about J. C. Stuart. It has grandmoms and grandpops who take and pick up students because parents work and no one else can. How are they going to walk? Can she make it 2 miles because they can't drive.
- I see this like a fifty year old couple and the wife says to the husband I'm pregnant; what, no type of planning. All asking for you guys to do, seriously, Dr. Taylor you see teachers out her and I'm very proud to work with them and look forward to be there with my co-workers every day.
- Seniors got together and are the neighborhood watch for J. C. Stuart. Parents know they have a place to bring their child if they have a doctor's appointment or somewhere to go.
- Just saying give it a little more time for people to digest it. Know it will take time to get it in order, but let's do it right.

Jennifer Gross – 27 Bucknell Lane:

- Been a resident for ten years now. Husband was the last graduating class in 1989 and have seen the district change considerably. Have a
- 1<sup>st</sup> grader and Pre-K students. Both daughters were to attend Twin Hills this year but at last minute told they would be in two separate schools.
- No I have to get them to two different schools and make sure they're on time. Now you tell me that my 1<sup>st</sup> grader will be going back to Twin Hills and the kindergartner will go to Stuart. How will I do that? Are you going to be busing the kindergartners. I don't know how that is going to happen or look but you need to talk to your teachers, and you will lose a lot of residents as well. Dr. Taylor your truly, truly need to rethink this budget because I just found out and I found out about it on face book.
- Didn't grow up here. Grew up in the Midwest. We had a k-5 and 6-8 and it was a big deal when entering high school. I think I turned out all right.
- I don't think you're looking at the children in the long run, I believe you're thinking about money. I want to know where the stash fund is.

Cheryl Lewis – 57 Budhollow Lane:

- New to the area, been here about 7 months, still don't know how all this works. Do know that I have a child that I just enrolled in school and now I have to take her out and make arrangements for change. My issue is everything being said by school board, great slides and different information but still no information where money is coming in for reorganization and the bathroom issues. All these questions have been asked before and I just would like an answer.
- I'm also concerned about the nepotism piece regarding Benjamin Banneker and it's affiliation with the major and someone on the school board. That is a concern because that's conflict of interest and ties into how my child is being treated.

April 25, 2018

**PUBLIC COMMENT (cont'd)**

- When I heard the comments made by some of the students who attend Willingboro High School it doesn't sound like they're concerned about the budget but more concerned about their education, and their problem isn't with money but with teachers. I might not be favored for this statement but if it doesn't apply let it fly. When it comes down to budgeting it's about cutting cost when necessary, so when you need to cut the cost when it comes down to teachers, you should use the evaluation method. The budget problems could possibly be reduced or minimized by eliminating some of the teachers that these students talked about on Monday night.
- Teachers don't take offense to it because you should let your accolades and your student's successes speak for your achievements. Your performance wouldn't be on the chopping block as long as you show you're doing what you need to do. I've come across some teachers at Garfield East who are doing what they need to do. They go above and beyond. Will you be bringing those teachers to J. C. Stuart?
- For me it's not so much about the building but my child's education and wellbeing, and I'm sure for the rest of the parents as well. When you're busing little ones, you need a car seat and how are you paying for the aides on the bus?
- Where I come from if you do poor or a job or if your test scores are low you don't get bonuses. You don't get accolades or promotions, so where is that money going? So I would like to know about the money issues too, so if the man last week lied then you show me and tell me the truth.

Ted Nixon:

- Spending a tremendous amount of time on how to close schools because we're losing students, but I wonder if we are spending the same amount of time on how to keep students.
- In competition with 2 school 3 schools, (Benjamin Banneker & BCIT) need to come up with a plan to be competitive. We need to compete and it doesn't have to be everybody in the State.
- We are losing money, students, time, and people because we aren't coming up with a solution to the problem and again I'm asking what are we doing about it. Is it a plan? Are you going to come back and say this is what we plan to do to reclaim our students.
- What is the plan to reclaim the 800 kids we lose each year to these other schools.

**SUPERINTENDENT COMMENTS:**

Dr. Taylor commented to the public's comments.

**BOARD MEMBERS COMMENTS:**

- Sarah Holley:  
Tonight, I'm going to do some house cleaning and it's from Monday night's meeting. There's an elephant in the room, actually two and the best way to introduce an elephant is to address the two elephants. The comments are especially for you Ms. Hensley and Ms. Lewis.
- Point #1 – Major Holley's involvement with Benjamin Banneker School served on the board during the first year of its existence which was 2014, that was four years ago.

April 25, 2018

**PUBLIC COMMENT (cont'd)**

- Where were all of you when Dr. McMann was desecrating the district to make way for the charter schools to be established. Where were the green shirts then? You were employed in the district but there were only sounds of crickets. Contrary to what you believe, Mayor Holley was not the mayor during the time of service as a board member at Benjamin Banneker nor was he on City Counsel and I wasn't on this Board of Education. As the mother of the mayor I'm proud of his services not only to the charter school but to the Willingboro community at large, so stop complaining about someone else's service and go out and find a way for yourself to give back to the community. Let's talk about nepotism. Mayor Holley was proudly born, proudly raised and educated in Willingboro Public Schools. He owns a home here, pays taxes here and plan to raise his children here and educate them through the Willingboro Public School system. He punches a time clock at Helen A. Ford Middle School in Pemberton, New Jersey. He wasn't paid when he was on the board at the charter school just like we are not paid to be on the board. If you are really interested in the facts, and if you want to sanctionize this, there is a site that publishes who gets paid by all non-profit organizations. It's called Guide Star.org and I challenge you to do so. Start doing your own research and stop allowing certain people to lead you like lambs to slaughter. Mayor Holley doesn't need nepotism to get a job. He is highly educated and extremely intelligent and has been employed since his graduation from college. Matter of fact he was offered a job at his first interview after college and he got that job.
- Elephant # 2 in the room, there were two vacant seats on the board, the board appointed Ms. Noble-Slaton to the board and although she wasn't a member at the time she was the most qualified with her extensive work with the PTA. There were three losers in the board of elections, Parker, Worthy and Holley, so just because the loser you wanted to get appointed to the second seat wasn't selected in your mind that's an example of cronyism. Only the loser to your standards should have been appointed to the vacancy. Could it had been the board took in consideration my knowledge of board interaction, my educational background and forty years of experience in education, or was it my exceptional expertise in board governance or is it because I'm the most qualified of the three losers. Maybe the board understood what it took for me to become a certified board member or my extraordinary knowledge on legal updates.

Gary Johnson:

- My comment is this, I was unhappy with the budget process and I'm unhappy with this. I appreciate having this meeting, but looking at the numbers we have been given and trying to understand where they came from. I've had some disagreements with the superintendent which I have made known about some of the numbers and I still do. I was told that the kindergarten and special education students would be in the 1-5 but they weren't in any of the numbers we included and that's about 67 students. I really don't think we've thought this through and I'm looking at the plan recommended and it leaves 7<sup>th</sup> and 8<sup>th</sup> at Memorial. It's something like 400 and something students that can hold at least three times that. Really don't think we're adequately using the facilities that we have and my problem with this that we're doing this because were in a financial bond.

April 25, 2018

**PUBLIC COMMENT (cont'd)**

- We knew from the second budget meeting this year that we didn't have enough revenue.
- I think it needs more work, I think plan B is doable, but I don't think it's the best utilization of the facilities.

Grover McKenzie:

- I just want to say by listening to Mr. Johnson's comments. I think he made a good point to my earlier comment. We need to do what we need to and if the issue is money, I agree with you Dr. Taylor this is an emergency situation and being able to afford what we can do this year. If it comes down to money you have to look at your budget and see where is it going and if it's salary and benefits you have to reduce it.

Jennifer Noble-Slaton:

- Look into plan with Pre-K – 8<sup>th</sup> (Magnet School). Have another meeting to discuss other options.
- Send proposal in Friday packet for board members to review. More detailed information to form a consensus on which one you support.

Kimbrali Davis:

- Would like to thank everyone for coming out tonight.
- We had 73,536,405 million in budget. What we approved is that amount. We as a board was given a breakdown of the budget that clearly gave the breakdown of it. 54% is in salaries and benefits alone for 2018-2019 add in the tuition for BCIT and Benjamin Banneker and we're at 76%. We are legally locked and obligated through contractual agreements and through tuition that is send to us by the state on how much we have to get.
- When we talk about stash money, let's talk. This isn't the first time we've gone through financial crisis and we're not the first school district to go through financial crisis.
- I'm a Communications Worker of America union member and a shop steward for 15 years, I've been working, but not ready to do union work.
- Before Governor Murphy and Christie, we had Corzine. 1.5% contribution went towards health benefits. New Jersey budget in crisis. Unions negotiated a 4 year contract and state had to close a 9 billion state fall. Union petitioned and wore shirts and went to governor. No lay-offs made, saved 7,000 jobs and 9 billion short fall wage increase was postponed for 18 months. Did it for the protection of members jobs and state workers contributed 10 farlow days.
- Need to negotiate to save guards and para. Come together and save jobs.
- Had no idea that charter school was going to be improved for an expansion. 73 million locked in and we can't touch.

Gary Johnson:

- The closing of two schools that are used for polling places, need to consult the township.

April 25, 2018

**PUBLIC COMMENT (cont'd)**

Tonya Brown:

- Stated that this is disheartening process for the teachers, parents, students, board and administration. It isn't easy, but easy to place blame.
- Last year there were no changes to the budget, it was flat. Year before that, paras were being laid off and we worked it out. We don't want to do this, it's an emergency situation. How do you prepare for this. We were moving forward and now it's putting a damper on what we're trying to do. We were moving in the right direction and now it feels like we're drowning.
- Students go to school to learn and the teachers take credit for that, but who takes credit when they're not doing well.
- Everyone wants to blame Dr. Taylor for Benjamin Banneker expansion. All teachers can't teach. Take the bad apples out, but we can't do that.
- With the expansion going forward, it is a major setback. We were happy to see all the changes made last year.
- It hurts when you say we don't care. My child was sick and I still attended every meeting. When I'm committed to something, I'm committed. My daughter is being pressured because of decision being made here. I hate this budget, I hate the fact that people are losing jobs and schools are closing. Stash money makes it seem as if we are lying. None of the board members do anything half way. My integrity means everything. My name is all I have and I have to answer to God. Best believe that I'm looking at the budget and care about your kids, and I do believe that the kids are our future
- Don't have all the facts, get the facts, because the children are repeating what they hear.
- I appreciate you coming out and voicing your opinions.

**APPROVAL OF RESOLUTION TO GO INTO CLOSED EXECUTIVE SESSION**

**WHEREAS**, the Board of Education is now assembled at a public meeting, and

**WHEREAS**, the Board of Education now determines to go into closed/executive session for the purpose of discussing the following:

[Personnel and Negotiations]

**NOW, THEREFORE BE IT RESOLVED THAT** pursuant to the terms and conditions of the Open Public Meeting Act, N.J.S.A. 10:4-1, et.seq., that the Board of Education exclude the public, and enter into closed/executive session. It is estimated that these closed discussions might be disclosable to the public at the expiration of two (2) years from the date of the closed session, if not then legally privileged.

At the conclusion of this closed/executive session, it is anticipated that the Board will not reconvene in public session.

This resolution is adopted at 9:30 PM on April 25, 2018.

---

Tonya Brown  
Board President

**Attested To By:**

April 25, 2018

**APPROVAL OF RESOLUTION TO GO INTO CLOSED EXECUTIVE SESSION (cont'd)**

Moved by Dennis Tunstall

**APPROVAL OF RESOLUTION TO GO INTO CLOSED EXECUTIVE SESSION**

Seconded by Sarah Holley

A roll call resulted as follows:

|                 |   |     |                       |   |     |
|-----------------|---|-----|-----------------------|---|-----|
| Sarah Holley    | - | Yes | Gary Johnson          | - | Yes |
| Grover McKenzie | - | Yes | Jennifer Noble-Slaton | - | Yes |
| Debra Williams  | - | Yes | Dennis Tunstall       | - | Yes |
| Kimbrali Davis  | - | Yes | Tonya Brown           | - | Yes |

8 Voting: 8 Affirmatives, 0 Negatives, 0 Abstentions

**MOTION PASSED**

**APPROVAL TO COME OUT OF CLOSED EXECUTIVE SESSION @ 10:55**

Moved by Kimbrali Davis

**APPROVAL TO COME OUT OF CLOSED EXECUTIVE SESSION**

Seconded by Dennis Tunstall

A roll call resulted as follows:

|                 |   |     |                       |   |     |
|-----------------|---|-----|-----------------------|---|-----|
| Sarah Holley    | - | Yes | Gary Johnson          | - | Yes |
| Grover McKenzie | - | Yes | Jennifer Noble-Slaton | - | Yes |
| Debra Williams  | - | Yes | Dennis Tunstall       | - | Yes |
| Kimbrali Davis  | - | Yes | Tonya Brown           | - | Yes |

8 Voting: 8 Affirmatives, 0 Negatives, 0 Abstentions

**MOTION PASSED**



April 25, 2018

**RECOMMENDATION FOR CONSENSUS FOR OPTION B AND TO USE THE INTERPRISE FUND FOR A PRINCIPAL AND MATH SUPERVISOR**

Moved by Kimbrali Davis

**RECOMMENDATION FOR CONSENSUS FOR OPTION B AND TO USE THE INTERPRISE FUND FOR A PRINCIPAL AND MATH SUPERVISOR**

Seconded by Dennis Tunstall

A roll call resulted as follows:

|                 |   |     |                       |   |     |
|-----------------|---|-----|-----------------------|---|-----|
| Sarah Holley    | - | Yes | Gary Johnson          | - | Yes |
| Grover McKenzie | - | Yes | Jennifer Noble-Slaton | - | Yes |
| Debra Williams  | - | Yes | Dennis Tunstall       | - | Yes |
| Kimbrali Davis  | - | Yes | Tonya Brown           | - | Yes |

8 Voting: 8 Affirmatives, 0 Negatives, 0 Abstentions

**MOTION PASSED**

**MOTION TO ADJOURN**

- The motion to adjourn @ 10:56 was unanimous

5-11-18

Date

  
Kelvin L. Smith  
Business Administrator/Board Secretary