



# Referendum Open House

March 15, 2022 | 6:00 p.m. | Wild Rose Middle/High School





# District Planning Partners

- Bray Architects
- Miron Construction Co., Inc.
- R.W. Baird



## Our Mission

The School District of Wild Rose, in partnership with students, parents, and community, will provide a challenging education to prepare our students to be knowledgeable, resourceful, resilient, and productive members of our ever changing world.



**#WildRoseWildcats**



# Why now?

- Some aging building systems need updating
- No major educational improvement projects since 1997
- Improve safety and security
- Improve educational spaces to reflect a collaborative and flexible environment
- Proactively planning to upgrade the “bones” of the buildings (infrastructure)
- Provide more hands-on / CTE skills for our MS/HS students
- As good stewards of taxpayer resources, we recognize the financial window of opportunity



# What are the needs?

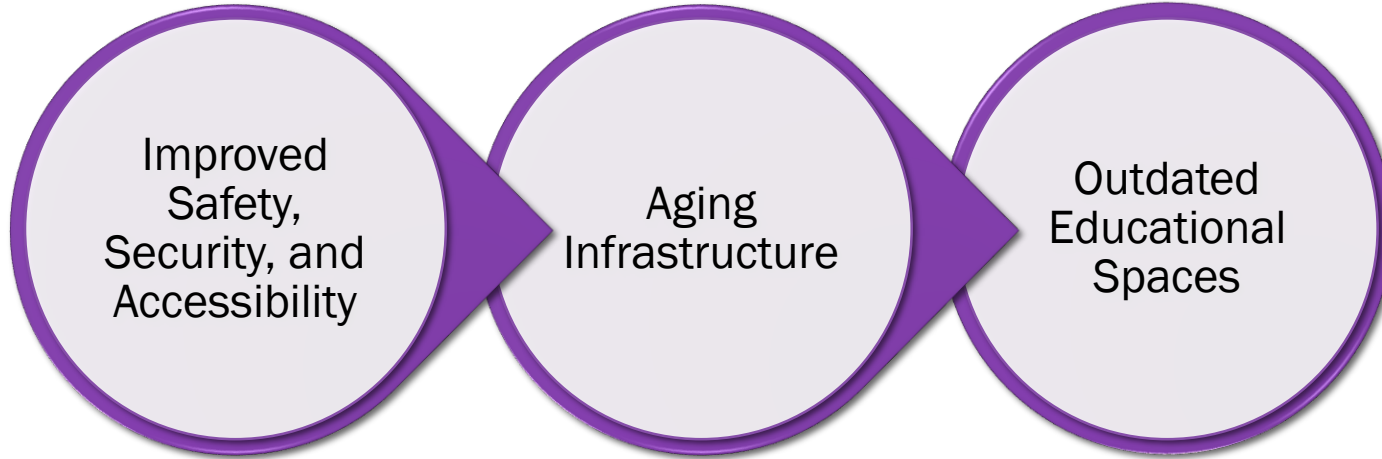

# Facilities Planning Timeline 2021-2022

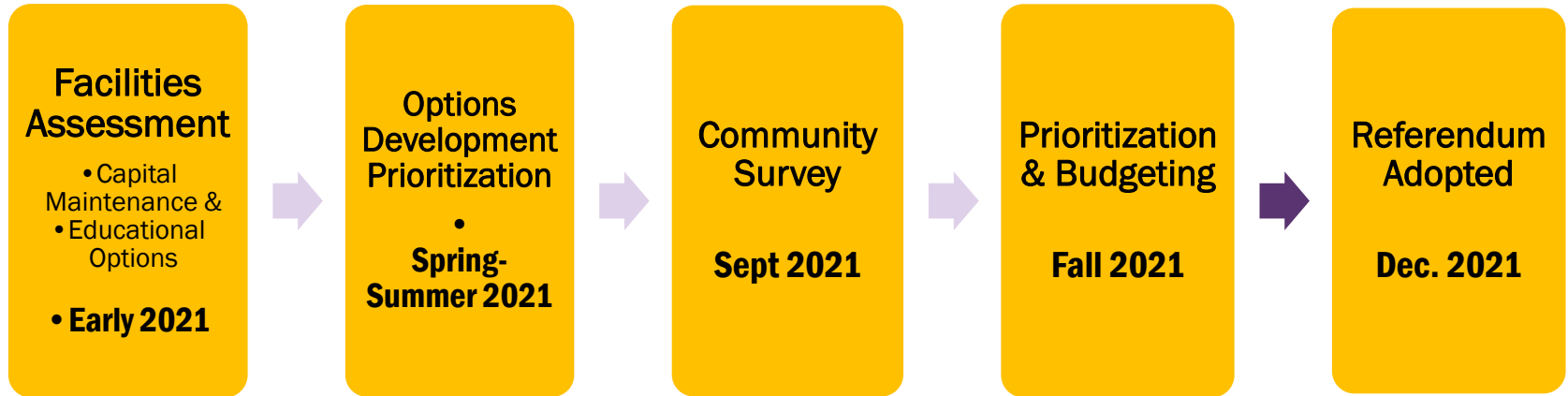



# Survey Says: Community Feedback

68%

of all resident respondents would support a referendum to fund the recommended plan

68%

of all resident respondents would support funding air conditioning at the Middle/High School



# Did You Know...?

The District's share of property taxes is calculated using a mill rate. Since 2013-14, our tax mill rate has dropped **nearly 25%**.

## MILL RATE DROP

 **25%**





# 2021-22 Mill Rate Comparison

Our tax rate compared to schools in our conference is near the bottom, and is well below the state K-12 average of \$8.67.

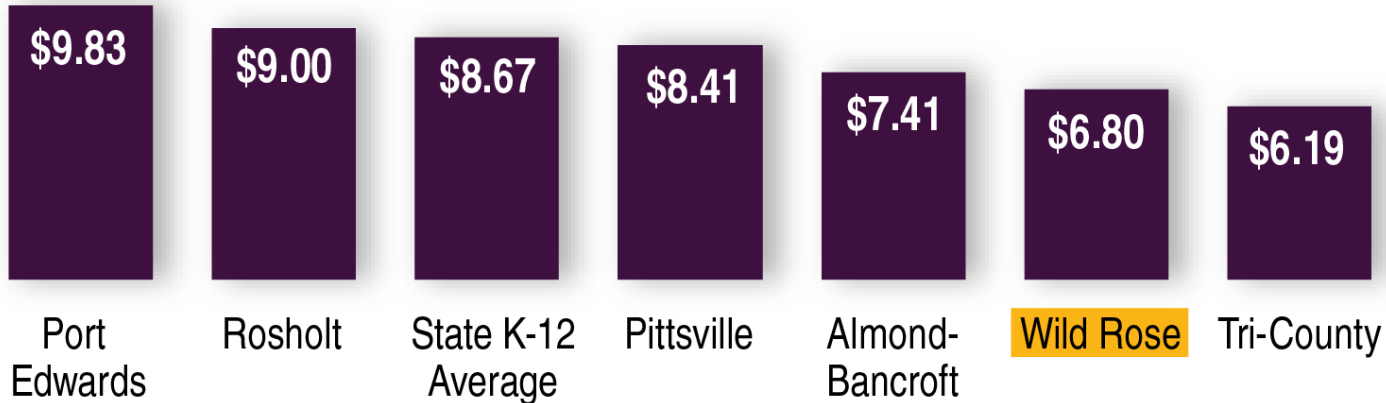



# What is the recommended plan?

The proposed referendum plan addresses the identified needs in our facilities planning and impacts all students at both school buildings.

**Question 1** addresses improved safety, security, and accessibility; aging infrastructure, and outdated educational spaces at both the Elementary and Middle/High Schools.

**Question 2** is for HVAC work and air conditioning at the Middle/High School.



# Two Questions on the April 5 Ballot

**Question 1 - \$15,600,000** for educational improvements, including a classroom addition, renovations, safety, and security improvements, building infrastructure and site improvements at the Elementary School; as well as renovations, safety and security improvements, accessibility updates, and infrastructure, site and outdoor athletic facility improvements at the Middle/High School.

**Question 2 - \$2,300,000** for HVAC upgrades including air conditioning at the Middle/High School.



## What is the estimated tax impact?

If voters approve both measures, the combined estimated maximum tax impact is \$0.78 per \$1,000 of fair market property value, or \$78.00 a year on a home valued at \$100,000.

# School District of Wild Rose Historical and Projected Mill Rate

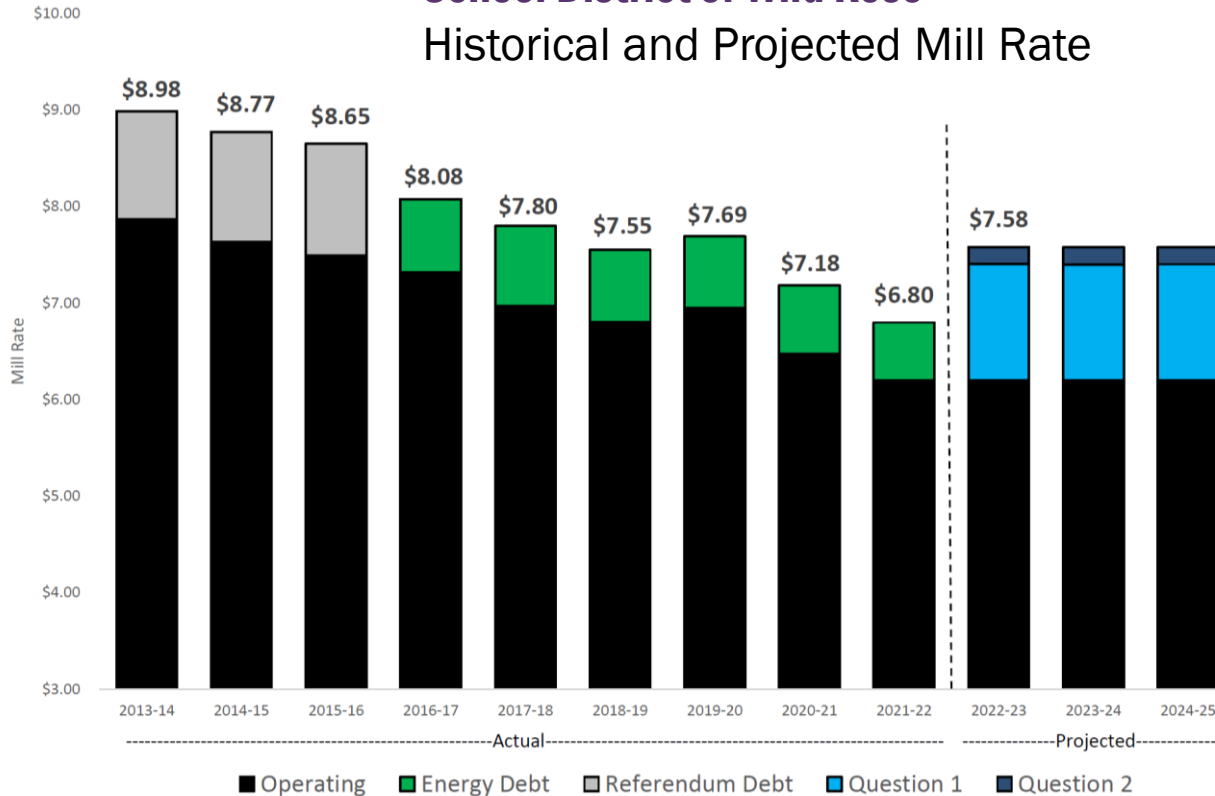

The District made its final debt payment on prior debt this year. If the referendum is successful, the District tax mill rate will have an estimated \$0.78 increase. This means that the portion of property taxes that are allocated to the School District would increase by an estimated \$78 annually (or \$6.50 monthly) per \$100,000 of fair market property value. This increase would be reflected on the December 2022 tax bill.

Debt issue are amortized over 20 years at a planning interest rate of 3.75%.  
Mill rate based on 2020 Equalized Valuation (TID-OUT) of \$868,239,570 with annual growth of 1.00% thereafter.

# Estimated Tax Impact



	Question 1		Question 2	
Referendum Amount	\$15.6 million		\$2.3 million	
Mill Rate Impact per \$1,000	\$0.60		\$0.18	
Fair Market Property Value	PER YR	PER MO	PER YR	PER MO
\$100,000	\$60.00	\$5.00	\$18.00	\$1.50
\$200,000	\$120.00	\$10.00	\$36.00	\$3.00
\$300,000	\$180.00	\$15.00	\$54.00	\$4.50

*Debt borrowings are amortized over 20 years at a planning interest rate of 3.75%. Mill rate based on 2021 Equalized Valuation (TID-OUT) of \$868,239,570 with annual growth of 1.00% thereafter. Impact represents the change in the mill rate over the projected 2021-22 mill rate of \$0.60 for the energy efficiency exemption levy. Because state aid is not a major source of revenue for the District, the financing plan does not incorporate a potential impact to state aid. The District currently receives aid on expenditures at a tertiary rate of -108.46% (2021-22 October 15 certification). Planning estimates only. Significant changes in market conditions will require adjustments to current financing plan.*



# Wild Rose Elementary Projects

Relocate/renovate Main Office to create a secure entrance to better monitor and control visitor access.

Renovate the current office space into a hands-on-learning lab.

Add classroom space, conference room, restrooms, and building storage.

Replace entire roof and repair building envelope, floors, and ceilings.

Upgrade lighting to improve energy efficiency (LED).

Update classroom furniture to create more flexible learning environments.

Resurface asphalt playground.

Site work and resurfacing the front driveway.

# Elementary Preliminary Plan



**Key:**

- ① Relocate/renovate Main Office to create a secure entrance.
- ② Renovate the current office space into a hands-on learning lab.
- ③ Classroom and flexible space addition (including restrooms).

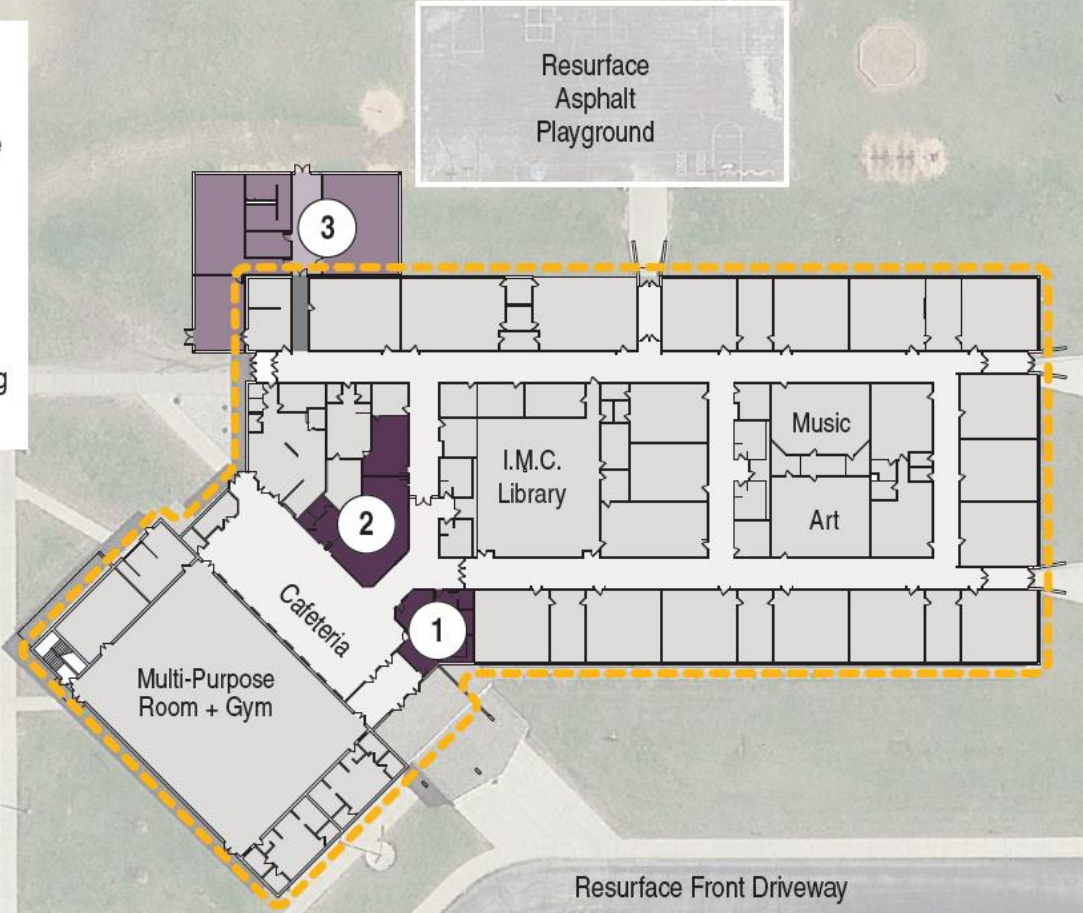

**Scope of Work**

-  Existing
-  New Construction
-  Renovation
-  Capital Improvements, including Complete Roof Replacement





# Wild Rose MS/HS Projects

Secure entrance and office renovations

Upgrade classroom spaces in the 1960, 1968, and 1978 portions of the building

Tech ed (STEM)/Family and consumer education (FACE)/Art/6th grade science classroom renovations

Site work and parking lot resurfacing

Restrooms/locker room renovations

Track resurfacing

Replace baseball/softball backstops

Air conditioning

# MS/HS Preliminary Plan

### Key:

- ① Relocate Middle/High School Office to create a secure entrance.
- ② Renovate District Office to create a secure entrance.
- ③ Renovate the current Middle/High School Office space into classrooms.
- ④ Renovate outdated Tech Ed (Shop)/Family and Consumer Science (Home Economics) areas.
- ⑤ Renovate Art and 6th grade science areas.
- ⑥ Renovate restrooms and locker rooms to comply with Americans with Disability Act (ADA) requirements and add energy efficient fixtures.

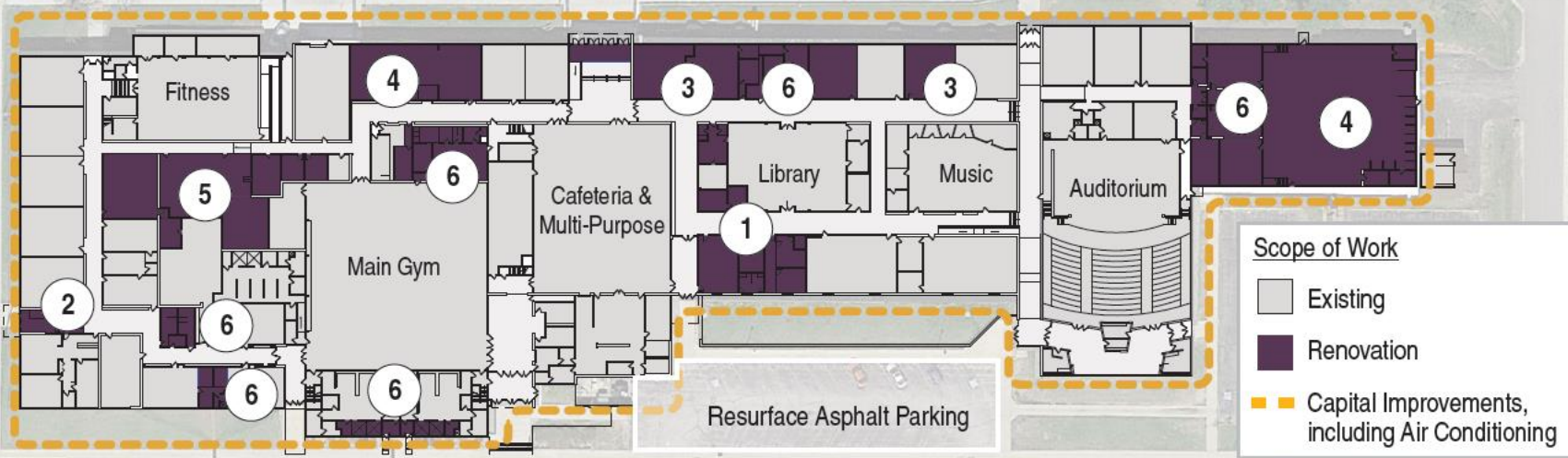



# Estimated Project Timeline

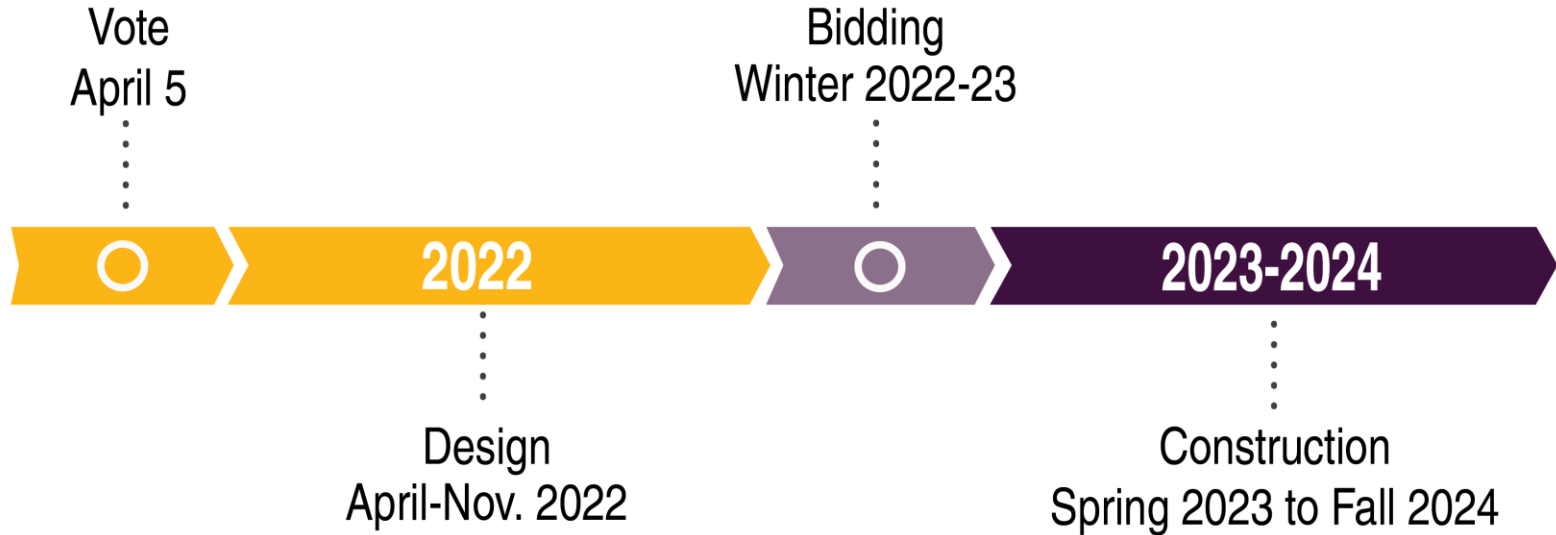



# Voting Information

**Tuesday, April 5th is Election Day.**

**Polls will be open from 7:00 a.m. to 8:00 p.m.**



MyVote Wisconsin is the state's official source for voting information, with resources to help you cast your ballot on Election Day: <https://myvote.wi.gov/en-us/>.

You can use the site to review your voting information, check your polling place, register to vote, request an absentee mail ballot, and more. Don't forget your Photo ID!



# Make an Informed Decision



## Tour & Referendum Open House

March 15, 2022, 6:00 - 7:30 p.m. at Wild Rose MS/HS



## Questions?

CALL the District Office at (920) 622-4203

EMAIL [referendum@wildroseschools.org](mailto:referendum@wildroseschools.org)

VISIT [www.wildrose.k12.wi.us/page/referendum-spring-2022](http://www.wildrose.k12.wi.us/page/referendum-spring-2022)