

**ELECTION DAY**  
**APRIL 5, 2022**  
 Polls are open  
 7:00 a.m. to 8:00 p.m.



**Voter Information**  
 MyVote Wisconsin is the state's official source for voting information, with resources to help you cast your ballot on Election Day. Go to <https://myvote.wi.gov/en-us/>.

Use the MyVote Wisconsin site to review your voting information, check polling place locations and times, register to vote, or request an absentee mail ballot.

**To receive an absentee ballot, request it by 5 p.m. on Thursday, March 31, 2022.**



The cast, crew, and orchestra from the Middle/High School production of "All Shook Up."

## What is on the April 5 Ballot? Two Questions

Based on the positive feedback from the district-wide community survey, the School District of Wild Rose School Board unanimously approved **two referendum questions** for the April 5, 2022 ballot.

**Question 1** authorizes \$15,600,000 for educational improvements, including a classroom addition, renovations, safety, and security improvements, building infrastructure and site improvements at the Elementary School; as well as renovations, safety and security improvements, accessibility updates, and infrastructure, site and outdoor athletic facility improvements at the Middle/High School.

**Question 2** authorizes \$2,300,000 for HVAC upgrades, including air conditioning, at the Middle/High School.

## What is the Tax Impact?

Referendum Amount	Question 1 \$15.6 million		Question 2 \$2.3 million	
Mill Rate per \$1,000	\$0.60		\$0.18	
Fair Market Property Value	PER YR	PER MO	PER YR	PER MO
\$100,000	\$60.00	\$5.00	\$18.00	\$1.50
\$200,000	\$120.00	\$10.00	\$36.00	\$3.00
\$300,000	\$180.00	\$15.00	\$54.00	\$4.50

Assumptions: Debt borrowings are amortized over 20 years at a planning interest rate of 3.75%. Mill rate based on 2021 Equalized Valuation (TID-OUT) of \$868,239,570 with annual growth of 1.00% thereafter. Impact represents the estimated change in the mill rate over the projected 2021-22 mill rate of \$0.60 for the energy efficiency exemption levy. Prepared by RW Baird.

**MILL RATE DROP:** The District's share of property taxes is calculated using a mill rate. Since 2013-14, our tax mill rate has dropped **nearly 25%**. Our tax rate compared to schools in our conference is near the bottom, and is well below the state K-12 average of \$8.67.

2021-22 MILL RATE COMPARISON

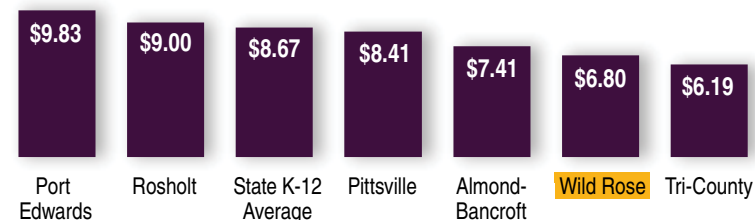

# REFERENDUM NEWSLETTER

MARCH 2022



## Dear School District of Wild Rose Residents:

Over the past year, the School District and the School Board conducted long-range facilities planning to better understand the current state of our buildings and grounds, infrastructure, and learning spaces. Although both the Elementary and Middle/High Schools are well-maintained and structurally sound, significant educational and capital maintenance needs were identified in the comprehensive facilities study.

**On April 5, 2022, District residents will have the opportunity to vote on two referendum questions to address these needs:**

**Question 1** – \$15,600,000 to address improved safety, security, and accessibility, aging infrastructure, and outdated educational spaces at both the Elementary and Middle/High Schools.

**Question 2** – \$2,300,000 for HVAC upgrades including air conditioning at the Middle/High School.

## Why Now?

- No major educational improvement projects since 1997
- Aging building systems such as roofs and mechanicals need updating
- Improve the safety and security of both building entrances
- Improve educational spaces to reflect current teaching and learning
- Provide more hands-on / career-ready skills for our MS/HS students
- A financial window of opportunity with existing debt falling off

## Community Survey Feedback

The plan is also based on staff and community input from the Fall 2021 survey:

- **68% of all resident respondents** to the community survey indicated support for a referendum to fund the recommended plan.
- **68% of all resident respondents** to the community survey would support a referendum to fund air conditioning at the Middle/High School.

## What's Inside

- Plan Details
- Elementary School Projects and Plans
- Middle/High School Projects and Plans
- Estimated Tax Impact
- Design and Construction Schedule
- Voting Information

## Learn More

**CALL** the District Office at (920) 622-4203

**EMAIL** us referendum@wildroseschools.org

**VISIT** our website, [www.wildrose.k12.wi.us/page/referendum-spring-2022](http://www.wildrose.k12.wi.us/page/referendum-spring-2022)

**LIKE US** on Facebook



## Wild Rose Elementary Projects



- Relocate/renovate Main Office to create a secure entrance to better monitor and control visitor access.
- Renovate the current office space into a hands-on-learning lab.
- Add classroom space, conference room, restrooms, and building storage.
- Replace entire roof and repair building envelope, floors, and ceilings.
- Upgrade lighting to improve energy efficiency (LED).
- Update classroom furniture to create more flexible learning environments.
- Resurface asphalt playground.
- Site work and resurfacing the front driveway.

## Elementary Preliminary Plan

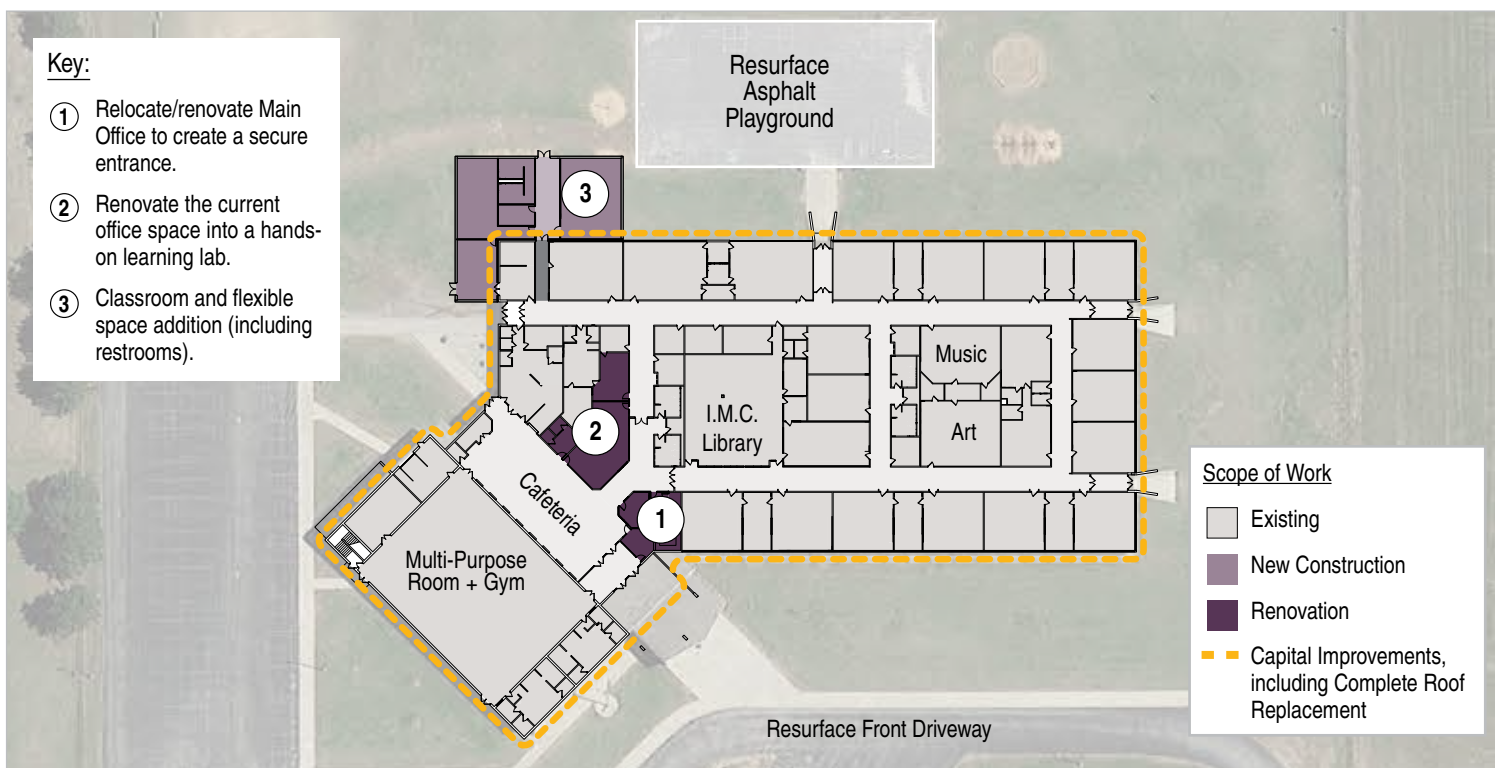

## Project Timeline

If voters approve the referendum questions on April 5, 2022, the District will begin the architectural design process right away. The entire project is expected to take approximately two years to complete with targeted key milestones along the way.

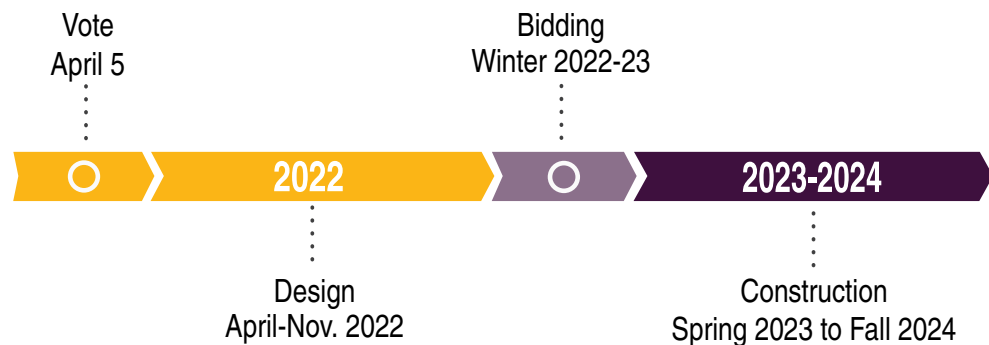

## Wild Rose Middle/High Projects

- Relocate the Middle/High School Office to create a secure entrance to better monitor and control visitor access.
- Renovate District Office to create a secure entrance to better monitor and control visitor access.
- Renovate the current Middle/High School Office space into classrooms.
- Renovate outdated Tech Ed (Shop)/ Family and Consumer Science (Home Economics) areas to provide hands-on-learning opportunities and prepare students for the trades.
- Renovate Art and 6th grade Science areas.
- Site work and resurfacing the South parking lot.
- Renovate restrooms and locker rooms to comply with Americans with Disabilities Act (ADA) requirements and add energy efficient fixtures.
- Replace flooring, roof sections, and ceilings where needed.
- Upgrade original plumbing fixtures and improve ADA accessibility.
- Install emergency generator and replace fire alarm.
- Replace baseball and softball backstops.
- Resurface the track.
- HVAC work including air conditioning building-wide.

## MS/HS Preliminary Plan

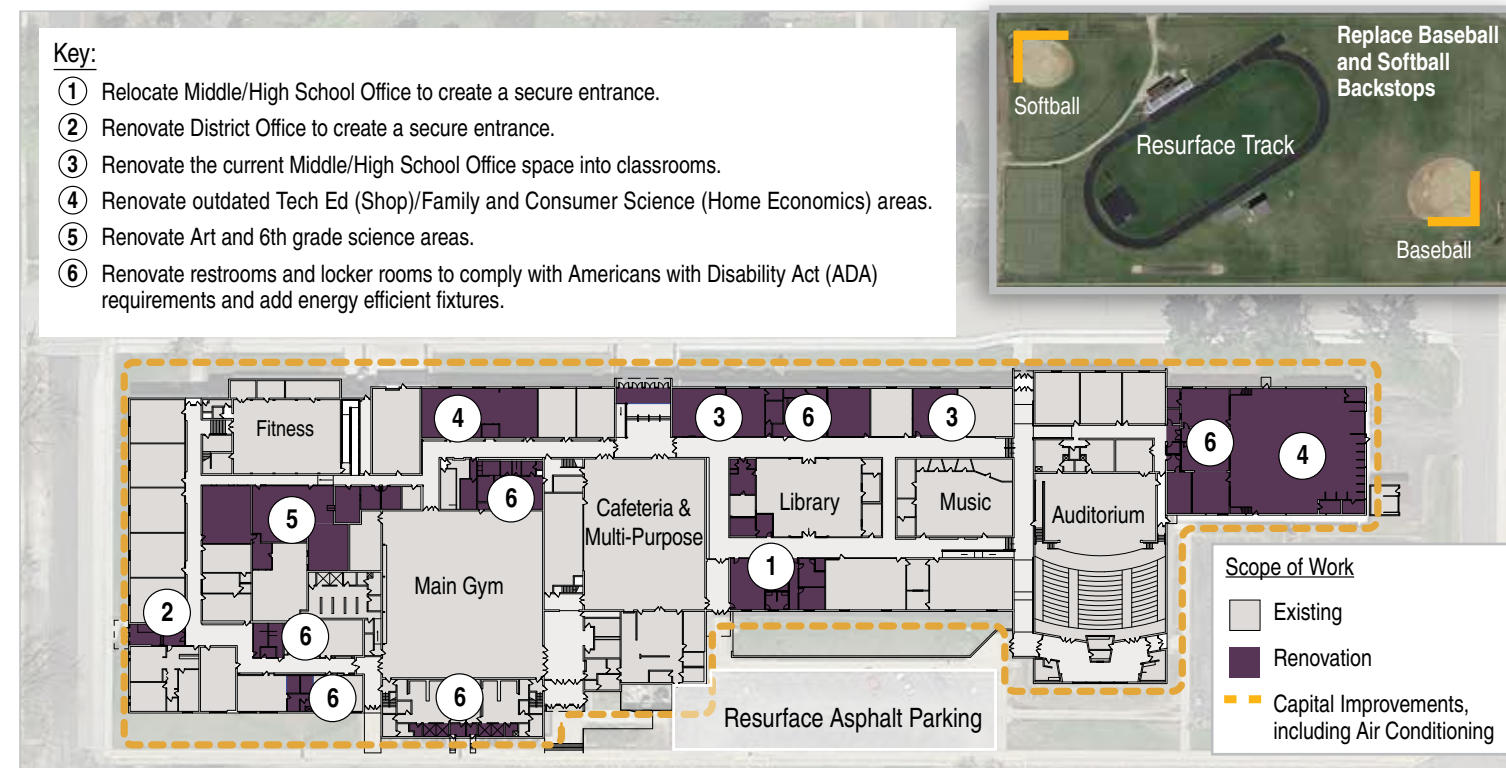

Creating smoothies in FACE class

## Building Career-Ready Skills

At the Middle/High School, the Family and Consumer Science classroom will be renovated to continue to support a traditional food curriculum while also providing space and equipment to support commercial culinary instruction. The Technical Education (Shop) space will be significantly renovated to align the configuration of the space with the curriculum goals for supporting and developing career pathways in the trades. Our goal with this proposed referendum plan is to create more opportunities for technical education and better academic environments for all Wild Rose students.