



Presentation for

REGIONAL SCHOOL UNIT NO. 10

Concept Design Straw Poll

Rumford and Mexico, Maine

March 14, 2022

Design Statement: A welcoming and collaborative learning environment where we plant the seeds and nurture the roots for a strong tomorrow.



AGENDA

- The Question
- Process and Schedule
- Concept Site & Building Design
- Local Option
- Project Budget
- Two-Year Operating Cost
- Questions
- Straw Poll





The Question

Design Statement: A welcoming and collaborative learning environment where we plant the seeds and nurture the roots for a strong tomorrow.

STRAW VOTE QUESTION

Do you support the proposed Concept Design for the new RSU 10 Pre-K-8 School Project, with an estimated total project cost of **\$92,680,676**, to be funded as follows:

- \$91,459,083 (98.3%) in State subsidy;
- \$10,000 in locally funded bonds for permitting costs; and
- \$1,211,593 of donations and grants for a fitness room.



Process and Schedule

Design Statement: A welcoming and collaborative learning environment where we plant the seeds and nurture the roots for a strong tomorrow.

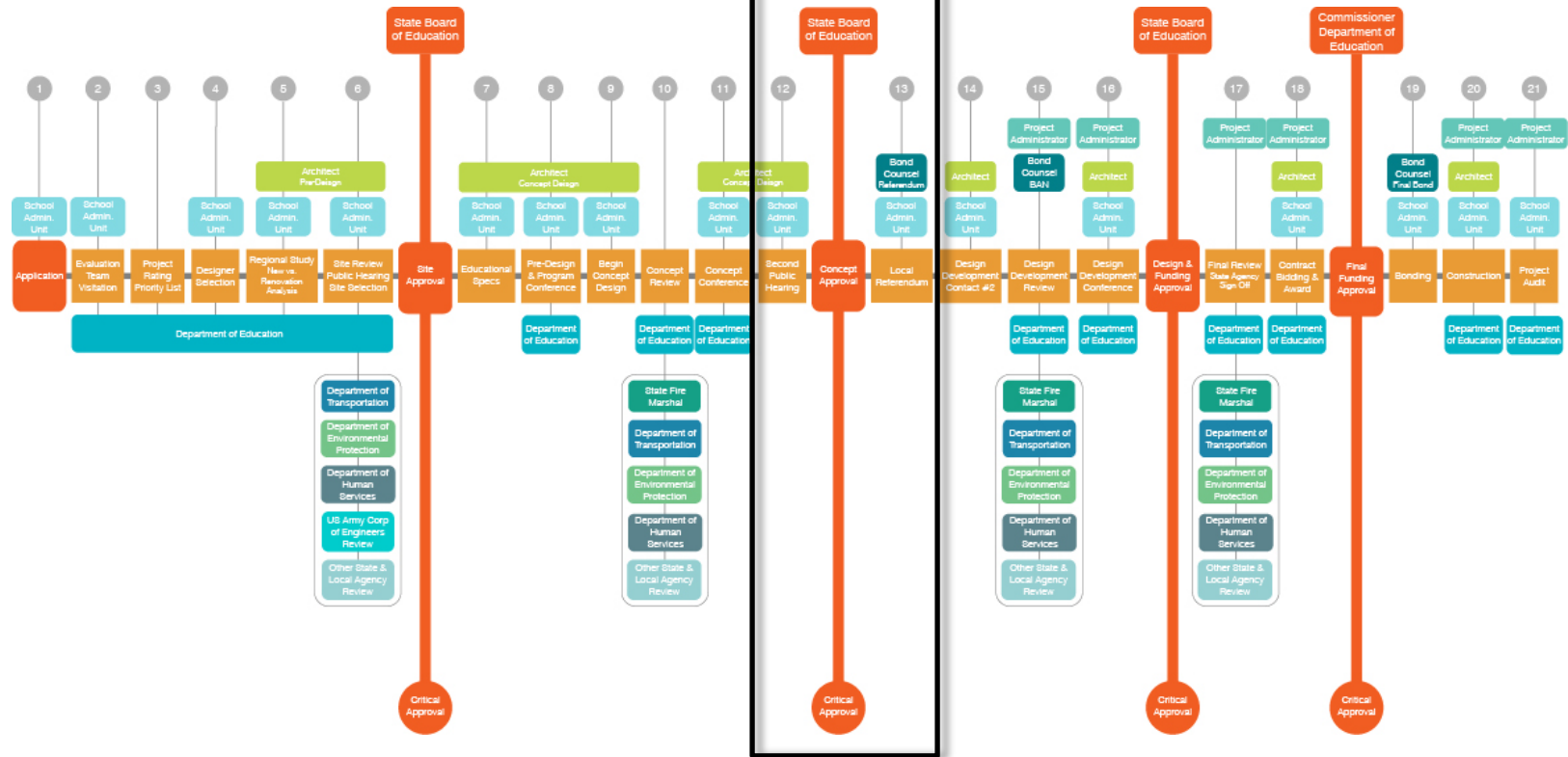

PROCESS: Department of Education (DOE) Major Capital Improvement Program

School Construction Review and Approval Process / Design-Bid-Build Project Delivery Method

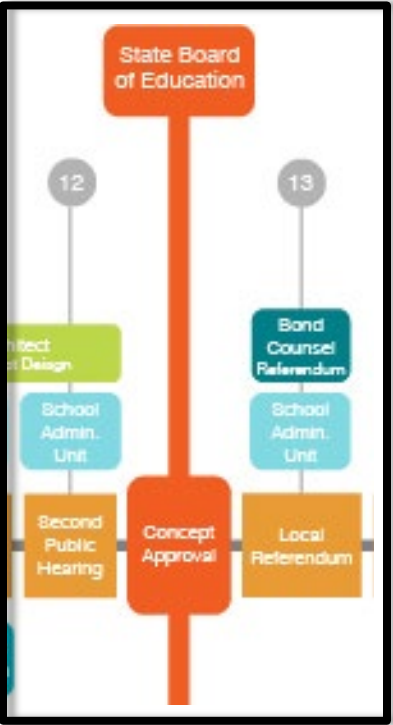

School Construction Review and Approval Process / Design-Bid-Build Project Delivery Method

School Construction Review and Approval Process / Design-Bid-Build Project Delivery Method

PUBLIC HEARING /STRAW POLL

MARCH 14, 2022

DOE Final Concept Design Submission Due

March 16, 2022

DOE Construction Committee to DOE State Board

March 25, 2022

DOE State Board

April 13, 2022

PUBLIC REFERENDUM

JUNE 14, 2022

PROCESS: Steps to Referendum

TOP PRIORITIES DESIGN PATTERNS

1
2
3
4
5

Secure and Welcoming Entry



Engaging the Natural World



Hands on Learning



Gathering Hubs

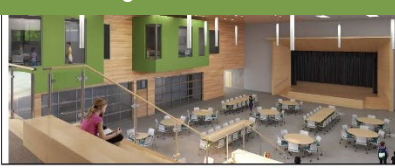

Push-in Special Education

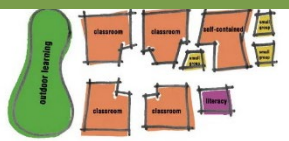

Learning Commons



Classroom Communities



FUTURE READY LEARNING GOALS

PORTRAIT OF A GRADUATE COMPETENCIES

1. Critical Thinking (56)
2. Communication (45)
3. Problem Solving (43)
4. Empathy (42)
6. Adaptability (36)
7. Integrity (35)

PROCESS: Project Visioning Session

1

3 Words to Capture the Essence of the RSU 10 PK-8 School:

- **Nature/Connection to Outdoors**
- **Resilient**
- **Collaborative**

3

DESIGN STATEMENT:

A welcoming and collaborative learning environment where we plant the seeds and nurture the roots for a strong tomorrow.

2

Top Images to Capture the Essence of the RSU 10 PK-8 School:

Engaging the Natural World



Gathering Hub

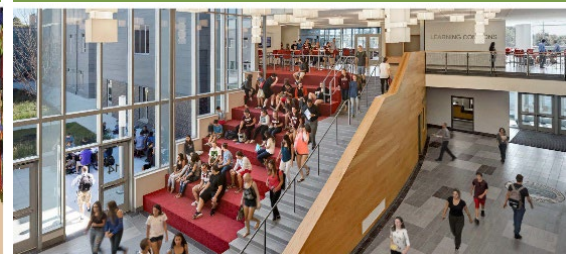

Secure and Welcoming Entry



Learning through Movement + Play



PROCESS: Project Design Statement



Concept Site & Building Design

Design Statement: A welcoming and collaborative learning environment where we plant the seeds and nurture the roots for a strong tomorrow.

- 1 NEW SCHOOL
- 2 PARKING
- 3 TRACK
- 4 MULTI-PURPOSE
- 5 BASEBALL
- 6 SOFTBALL
- 7 PLAY AREAS
- 8 PRACTICE FIELD

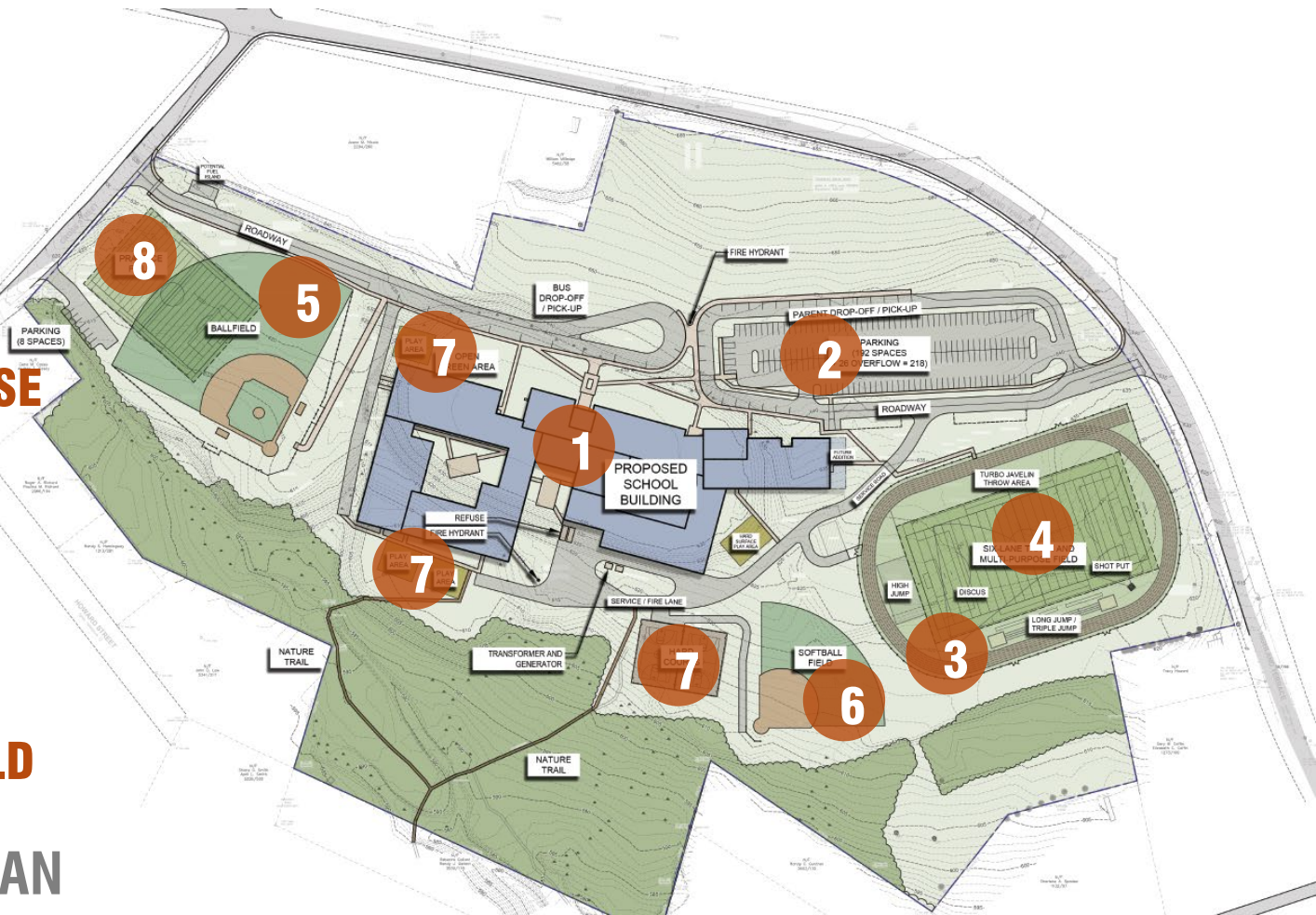

CONCEPT SITE PLAN

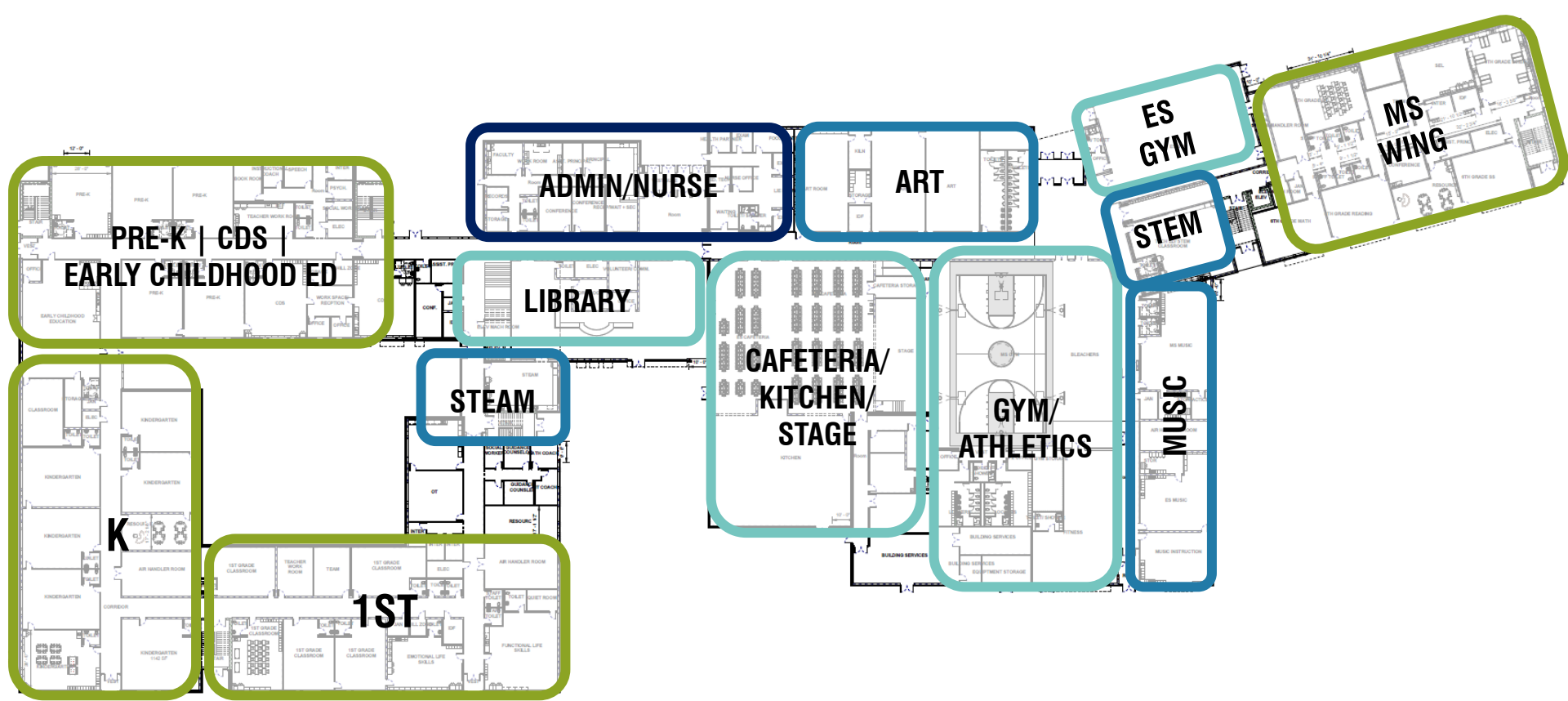

FIRST FLOOR

CONCEPT FLOOR PLANS: FRAMEWORK

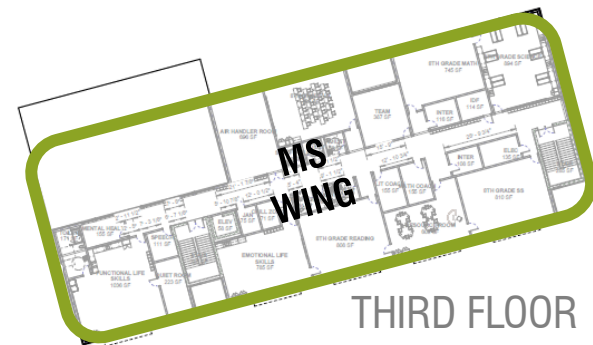
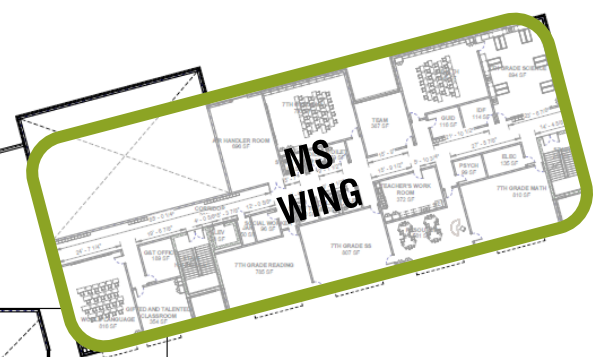
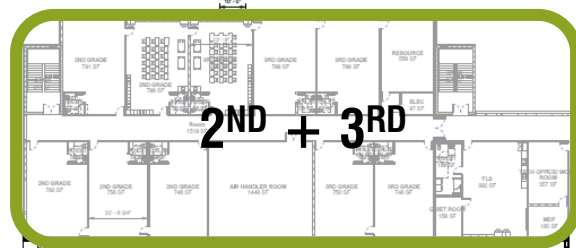

SECOND FLOOR

CONCEPT FLOOR PLANS: FRAMEWORK

THIRD FLOOR

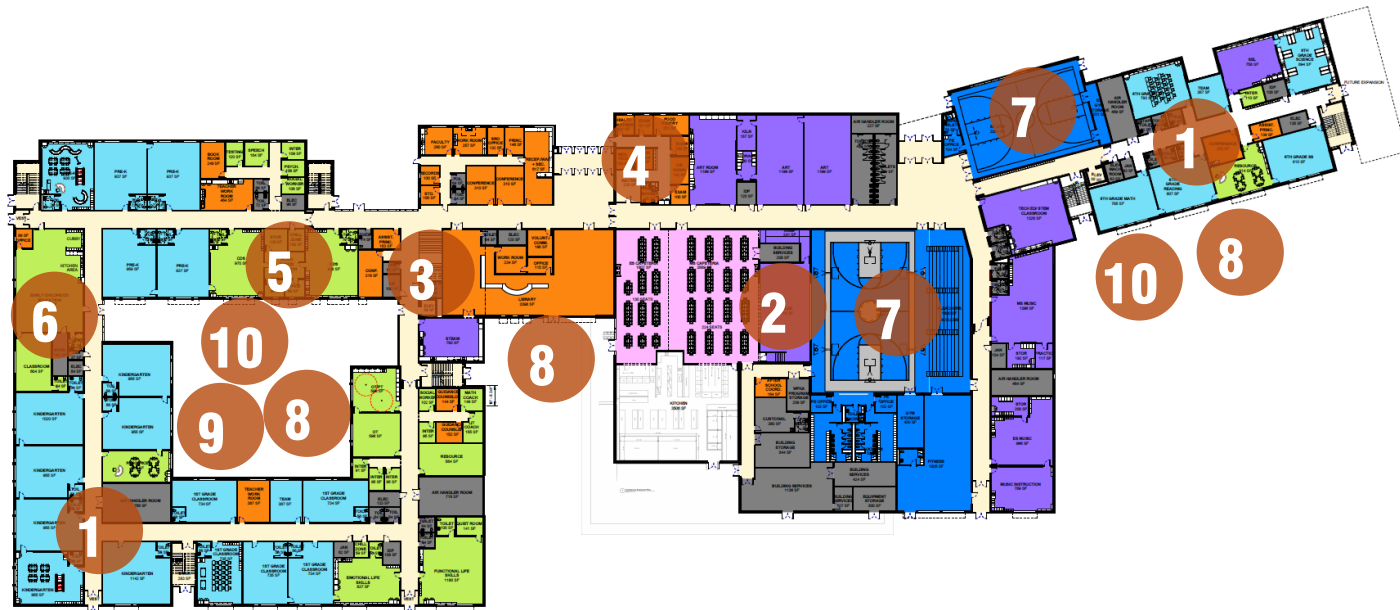

DEPARTMENT LEGEND

- ADMINISTRATIVE / LIBRARY
- ARTS
- ATHLETICS
- AUXILIARY
- CAFETERIA / KITCHEN
- CLASSROOM
- EGRESS
- SPECIAL SERVICES

- 1 SCHOOL WITHIN A SCHOOL MODEL**
- 2 STAGE**
- 3 COMMUNITY STAIR**
- 4 COMMUNITY HEALTH PROGRAM**
- 5 CDS**
- 6 REGION 9 ECE CTE**
- 7 MULTIPLE GYMS**
- 8 CONNECTION TO NATURE**
- 9 COURTYARD**
- 10 OPTIMAL DAYLIGHTING**

FIRST FLOOR

CONCEPT FLOOR PLANS

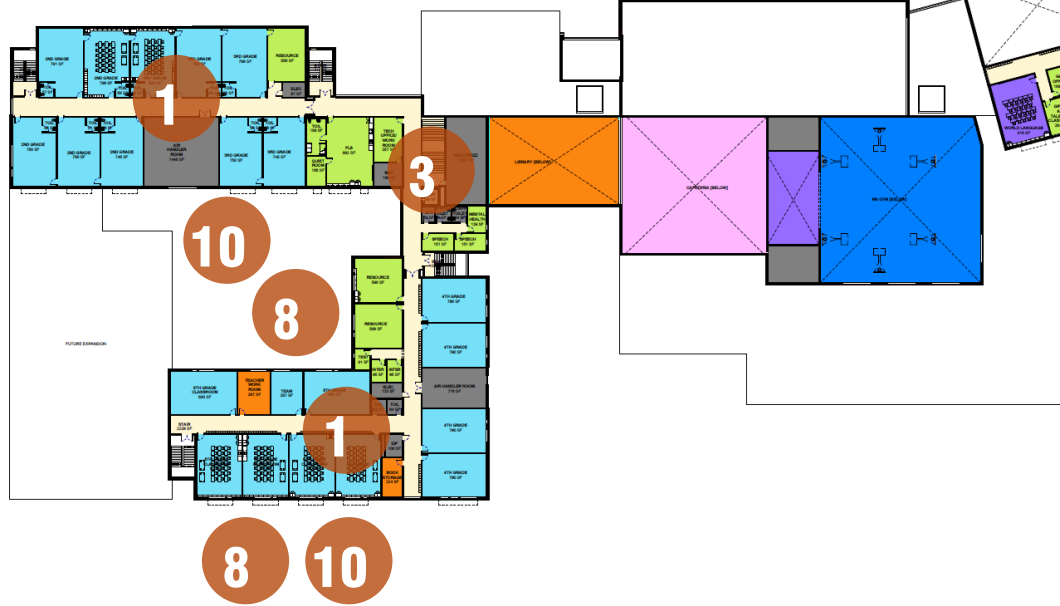

SECOND FLOOR
CONCEPT FLOOR PLANS

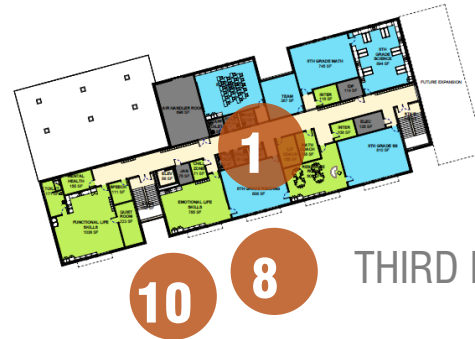

THIRD FLOOR

- 1 SCHOOL WITHIN A SCHOOL MODEL
- 2 STAGE
- 3 COMMUNITY STAIR
- 4 COMMUNITY HEALTH PROGRAM
- 5 CDS
- 6 REGION 9 ECE CTE
- 7 MULTIPLE GYMS
- 8 CONNECTION TO NATURE
- 9 COURTYARD
- 10 OPTIMAL DAYLIGHTING



Local Option

Design Statement: A welcoming and collaborative learning environment where we plant the seeds and nurture the roots for a strong tomorrow.

LOCAL OPTION

FITNESS ROOM

- Estimated construction cost:
\$1,211,593
- Cost to be funded by donations and grants





Project Budget

Design Statement: A welcoming and collaborative learning environment where we plant the seeds and nurture the roots for a strong tomorrow.

PROJECT BUDGET

	State/Local	Local Only	Other Funding	Total
Total Project Cost	\$91,459,083	\$10,000	\$1,211,593	\$92,680,676

- \$91,459,083 (98.68%) in State subsidy;
- \$10,000 in locally funded bonds for permitting costs; and
- \$1,211,593 of donations and grants for a fitness room.



Two-Year Operating Cost

Design Statement: A welcoming and collaborative learning environment where we plant the seeds and nurture the roots for a strong tomorrow.

TWO-YEAR OPERATING COST

Actual hours of operation, temperature settings, equipment operation and maintenance, and lighting utilization will impact these numbers. In addition, the unpredictability of the energy market can make it difficult to predict what energy costs will actually be for more than one budget year. The estimates are for budgeting purposes only.

Other utility and non-utility items to be considered for yearly operational expenses but not included above: Building insurance, building maintenance and supplies, equipment maintenance, landscape maintenance, security and monitoring services, trash removal, telephone service, internet service, cable or satellite TV service.

Electric & Fossil Fuel	Annual Dollars 2025-2026	Annual Dollars 2026-2027	Area (Sq Ft)
New School ⁴	\$195,600	\$197,800	178,000
Existing Schools (including portables)	\$253,900	\$256,800	180,265

Water/Sewer	Annual Dollars 2025-2026	Annual Dollars 2026-2027	Area (Sq Ft)
New School	\$14,700	\$14,900	178,000
Existing Schools (including portables)	\$15,400	\$15,600	180,265

- 1) Assumes 1% electrical rate inflation
- 2) Assumes 2% inflation for other utility costs
- 3) Projected costs rounded to nearest 100
- 4) Assumes fully air-conditioned building



Questions?

Design Statement: A welcoming and collaborative learning environment where we plant the seeds and nurture the roots for a strong tomorrow.



Straw Vote

Design Statement: A welcoming and collaborative learning environment where we plant the seeds and nurture the roots for a strong tomorrow.

STRAW VOTE

Do you support the proposed Concept Design for the new RSU 10 Pre-K-8 School Project, with an estimated total project cost of **\$92,680,676**, to be funded as follows:

- \$91,459,083 (98.3%) in State subsidy;
- \$10,000 in locally funded bonds for permitting costs; and
- \$1,211,593 of donations and grants for a fitness room.