

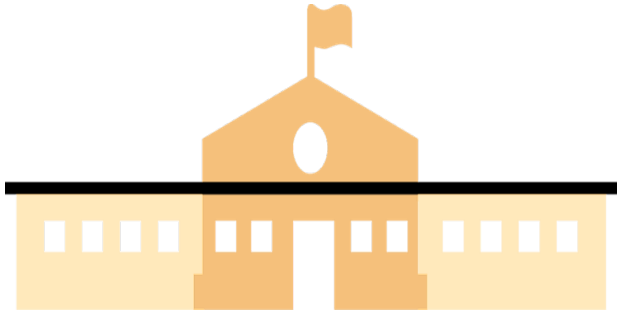

TYLER ISD  
**BOND**  
2022

# DISTRICT SNAPSHOT



28

Schools

15

Elementary  
Schools

2

Choice  
Schools

5

Middle  
Schools

4

High  
Schools

2

Innovative  
Programs

## STUDENT ENROLLMENT

18,147

## STUDENT DEMOGRAPHICS

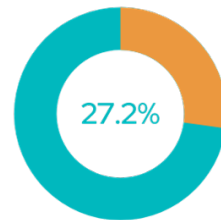

African  
American

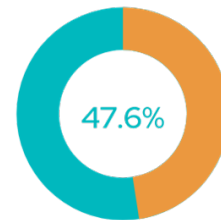

Hispanic

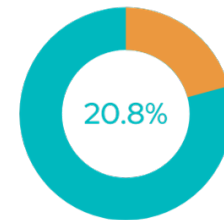

White

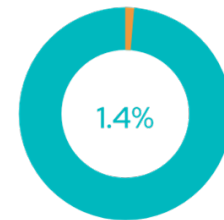

Asian

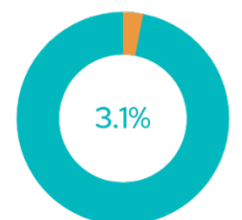

Other

# WHAT IS A BOND ELECTION?

Public schools rely on the support of local taxpayers to fund the operations and facilities of the school district.



Similar to homeowners borrowing money in the form of a mortgage, a school district borrows to finance the design, construction, expansion, and renovations of schools and facilities.

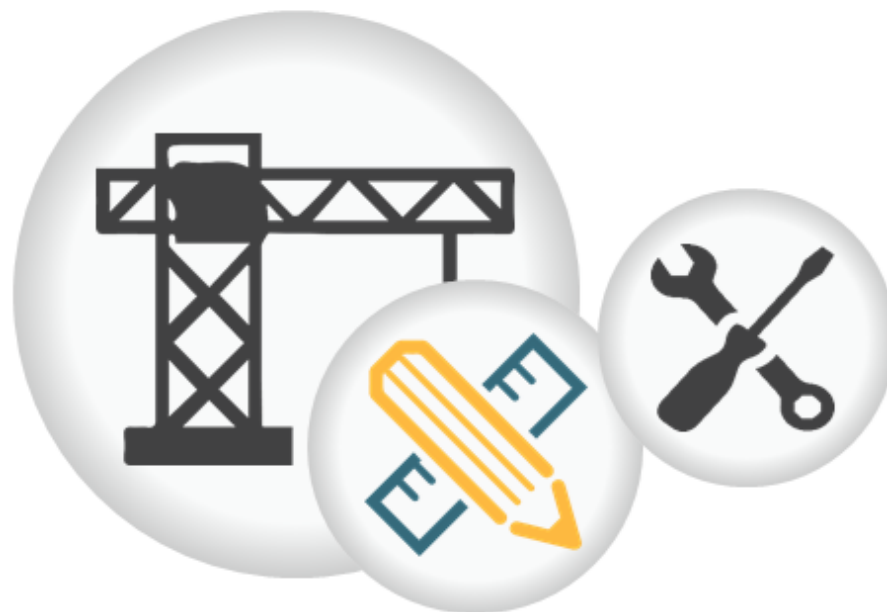

Voters must approve these funds through a bond election.



# ESTIMATED TAX IMPACT

Tyler ISD's current debt tax rate is 33.5 cents.

**The bond will not increase tax rates.**

These statements assume the District does not take on any additional debt in subsequent years or that property tax values do not decline.

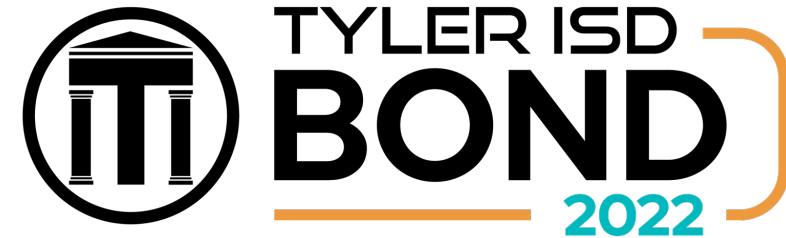

# NEW HUBBARD MIDDLE SCHOOL





# NEW HUBBARD MIDDLE SCHOOL





# NEW HUBBARD MIDDLE SCHOOL





# NEW EARLY COLLEGE HIGH SCHOOL





# NEW EARLY COLLEGE HIGH SCHOOL





# NEW EARLY COLLEGE HIGH SCHOOL

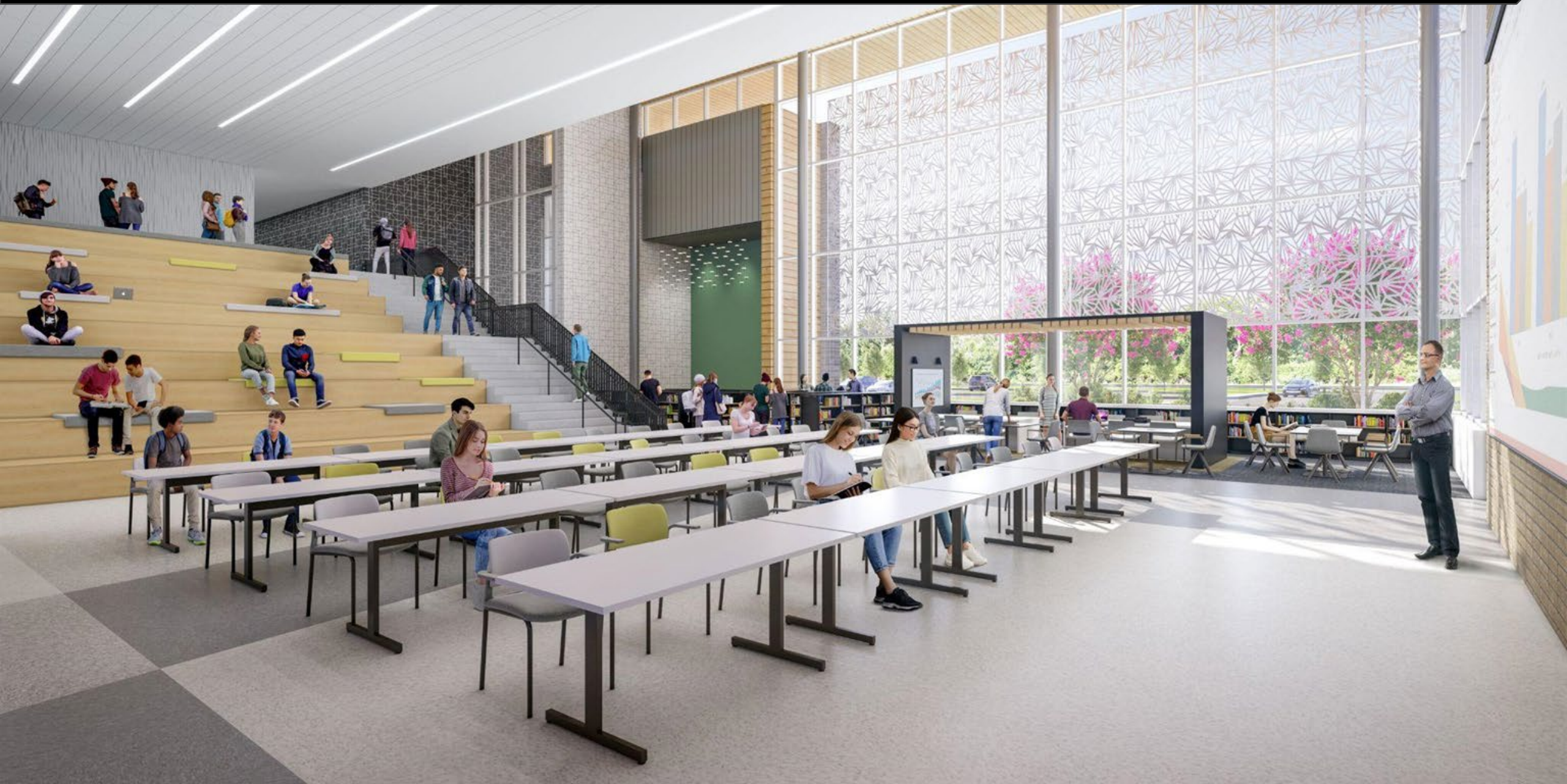





**Ranked nationally on the U.S. News & World Report list of Best High Schools.**

**Scored 97.02 out of 100, ranking 82nd out of 1,524 in the state  
and 532nd out of 17,857 in the nation.**

# HOGG MIDDLE SCHOOL

- 92 years old and limits 21<sup>st</sup> Century educational opportunities
- Building and site only 1/3 of the size needed for new middle school

## We ARE committed to ...

- Preserve and maintain the historical integrity of the building
- Facility used for administrative offices as well as community and student extra curricular programming
- Eventually assign students to zoned schools
- High school attendance zones are NOT being adjusted



# 2022 PROPOSED BOND PROJECTS

Proposed Items	Estimated Cost
<b>Hubbard Middle School</b>	<b>\$63 Million</b>
<b>Early College High School</b>	<b>\$26 Million</b>
<b>Total</b>	<b>\$89 Million</b>

# VOTING INFORMATION

## Early Voting

April 25 – 30, 2022

May 2 & 3, 2022

## Election Day

May 7, 2022



TYLER ISD  
**BOND**  
2022



QUESTIONS?

