

MILLAGE INFORMATION

OTHER AREA SCHOOL DISTRICT MILLAGES

Mountainburg	43.4
Alma	43.4
Van Buren	42.6

MPV SCHOOLS MILLAGE

Current	36.4
Proposed	39.9

MATCHING FUNDS AVAILABLE FOR PROJECTS

Safe Room at High School (FEMA)	\$659,519.00
Old Main Interior Remodel at Pleasant View (ESSER 2)	\$602,932.93
Old Agri & Current Maintenance Remodel (ARP ESSER)	\$371,279.46

IMMEDIATE NEEDS

1. Matching Funds for Saferoom	\$620,000.00
2. Complete PV Old Main Interior	\$600,000.00
3. Baseball & Softball Complex	\$2,000,000.00
4. Tech Center Renovation	\$1,000,000.00
5. New Bus & Maint. Building	\$1,000,000.00

HIGH NEEDS

1. Locker Room Improvements	\$50,000.00
2. High School Remodel	\$750,000.00
3. PV Remodel & Improvements	\$250,000.00
4. Asphalt Paving at Marvin & PV	\$200,000.00
5. Marvin Building B & C Soffits	\$75,000.00
6. New Seating at HS Gym	\$250,000.00

NEEDS TOTAL **\$6,795,000.00**

FINANCIAL MEANS

3.5 Mill School Mill Increase	\$5,000,000.00
Grant Funds Already Awarded	\$1,633,731.39
Current Available Building Funds	\$200,000.00
TOTAL FUNDED	\$6,833,731.39

PROPERTY TAX INFORMATION FOR MULBERRY/PLEASANT VIEW BI-COUNTY SCHOOL DISTRICT

NEW DEBT SERVICE MILLS

For an individual living within the Mulberry/Pleasant View Bi-County School District and within the city limits, the current total millage rate for real and personal property appears below:

School District	36.40
City of Mulberry	5.00
County - General	7.30
Total Current Millage	48.70

TAX IMPACT TABLE FOR 3.50 INCREASE IN DEBT SERVICE MILLS

Appraised Value of Real Estate	20% Assessed Valuation	Current 48.7 Mills Per Year	3.50 Increase in Mills Per Year	Diff. Per Month
\$100,000	\$20,000	\$947.00	\$70.00	\$5.83
\$125,000	\$25,000	\$1,217.50	\$87.50	\$7.29
\$150,000	\$30,000	\$1,461.00	\$105.00	\$8.75
\$175,000	\$35,000	\$1,704.50	\$122.50	\$10.21
\$200,000	\$40,000	\$1,948.00	\$140.00	\$11.67

Note: If your property qualifies for the Amendment 79 Homestead Property Tax Credit, you receive \$350

VOTE ON FEBRUARY 8th, 2022!

Presented By:

mahg
architecture



**MULBERRY/
PLEASANT VIEW BI-
COUNTY SCHOOL DISTRICT**
2022 PROPOSED MILLAGE
PROJECTS

SHATTER THE NEGATIVE PERCEPTIONS OF OUR SCHOOL SYSTEM & BUILD FOR THE FUTURE!

ATHLETICS

NEW SOFTBALL & BASEBALL COMPLEX & RENOVATIONS OF GYMS

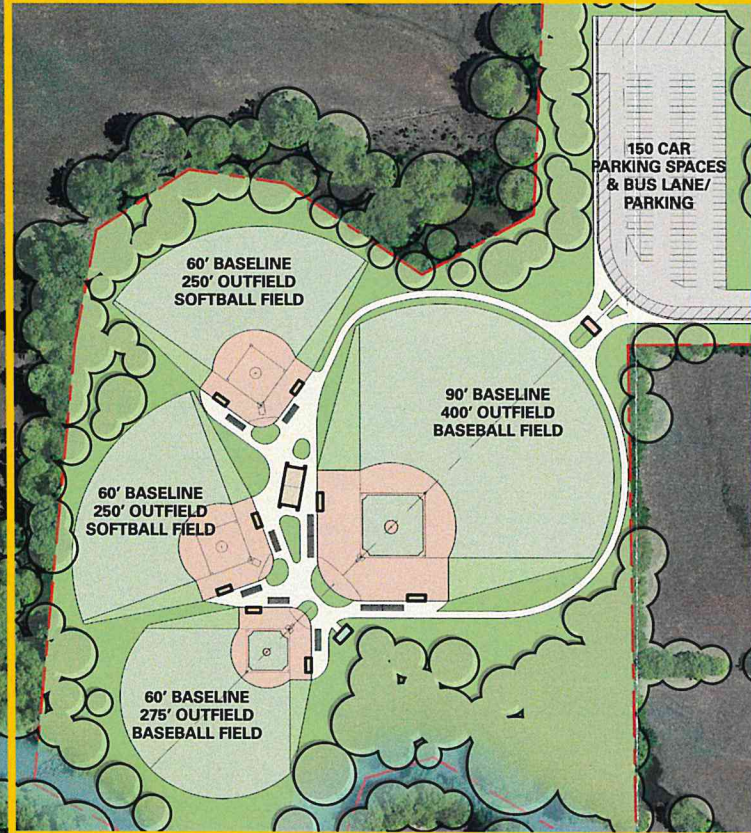

MARVIN ELEMENTARY CAMPUS

REPAIRS
BUILDING B & C
SOFFITS

REPAIRS
ASPHALT PARKING
LOTS & DRIVES

SAFETY

NEW SAFEROOM & WEIGHTROOM AT MULBERRY HIGH SCHOOL

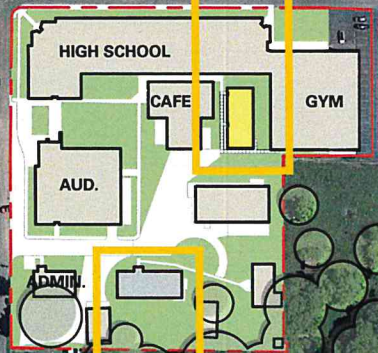

TECHNOLOGY

RENOVATION OF OLD AGRI BUILDING INTO TECHNOLOGY CENTER

TRANSPORTATION & MAINTENANCE

NEW TRANSPORTATION & MAINTENANCE FACILITY

S - SAFETY NEW SAFE ROOM AT HIGH SCHOOL AND ASK FOR A NEW ONE AT PLEASANT VIEW

H - HEALTH REMODEL OLD MAIN TO INCLUDE EXPANDED NURSE & COUNSELOR AREAS

A - ATHLETICS NEW SOFTBALL AND BASEBALL COMPLEX & CONTINUED RENOVATIONS OF GYMS

T - TECHNOLOGY RENOVATE OLD AGRI BUILDING INTO TECHNOLOGY CENTER

T - TRANSPORTATION & MAINTENANCE NEW TRANSPORTATION & MAINTENANCE FACILITY

E - EDUCATION RENOVATE OLD MAIN TO PROVIDE NEW CLASSROOMS & VIRTUAL OPPORTUNITIES

R - REPAIRS AT ALL CAMPUSES, INCLUDING LOCKER ROOM RENOVATIONS, ASPHALTING PARKING LOTS, ETC.

MULBERRY CAMPUS

PLEASANT VIEW CAMPUS

EDUCATION + HEALTH

RENOVATE OLD MAIN TO PROVIDE NEW CLASSROOMS, VIRTUAL OPTIONS & EXPANDED NURSE & COUNSELOR AREAS

REPAIRS
ASPHALT PARKING
LOTS & DRIVES