



# NORMANGEE ISD

## BOND 2021

### What is included in this bond?

#### Phase I

- Ag Shop Renovation and Expansion  
Shop addition; complete renovation of classrooms, restrooms, office, shop and storage; new computer lab, equipment, overhang, and façade improvements with new entrance
- New Green House
- Classroom Connector between High School, Junior High School and Band Hall  
New science lab and storage, computer lab, restrooms, and classrooms
- Red Brick Building Renovation into CTE Classes and Lab  
Floral lab and classroom addition, updated restroom and façade improvements
- Old Gym Renovations and Weight Room  
façade improvements and renovations
- Kitchen and Cafeteria Renovation and Improvements
- New Elementary Playground
- Districtwide Drainage Improvements

#### Phase II\*

\*As determined by enrollment and tax base growth

- Classroom Additions
- Cafeteria Expansion

#### Enrollment Trends

Year	Enrollment
2014 - 2015	527
2015 - 2016	554
2016 - 2017	570
2017 - 2018	603
2018 - 2019	592
2019 - 2020	614
2020 - 2021	611
2021 - 2022	622

### Why did Normangee ISD call a bond?

Normangee ISD is growing! As a result of this growth, the NISD Board asked its Facility Committee, comprised of community members, business owners, parents and staff, to review the District's facilities and financial status.

Over the course of nearly a year, the Committee met to review a comprehensive needs assessment of the district, tour existing campuses, and discuss the current conditions of the facilities. As a result, the Committee recommended that the Board call a bond election on November 2, 2021, in the amount of **\$20 million**.

### How will this impact my taxes?

#### Residential Homestead Tax Impacts

Home Value	Homestead Exemption	Taxable Value	Annual Increase	Monthly Increase
\$50,000	\$10,000	\$15,000	\$15.00	\$1.25
\$100,000	\$20,000	\$55,000	\$55.00	\$4.58
\$150,000	\$30,000	\$95,000	\$95.00	\$7.92
\$200,000	\$40,000	\$135,000	\$135.00	\$11.25
\$250,000	\$50,000	\$175,000	\$175.00	\$14.58

#### Agricultural Tax Impacts

Acres	Taxable per Acre*	Taxable Value	Annual Increase	Monthly Increase
100	\$120.00	\$12,000	\$12.00	\$1.00
500	\$120.00	\$60,000	\$60.00	\$5.00
1,000	\$120.00	\$120,000	\$120.00	\$10.00
1,500	\$120.00	\$180,000	\$180.00	\$15.00
2,000	\$120.00	\$240,000	\$240.00	\$20.00

\*Depending on the agricultural land classification (i.e. native pasture), this rate varies

#### Proposed Tax Rate

Year	M&O Rate	I&S Rate	Total
2022	0.9634	0.4800	<b>1.4434</b>

\*Projected tax impacts are based on an increase of \$0.10 per \$100 taxable assessed valuation to the debt service (I&S) tax rate. All tax impacts are based on the most reliable information currently available to the district.

### Voters 65+ \$0 TAX IMPACT

**NO TAX INCREASE** on homesteads for those having an Age 65 Homestead Exemption Affidavit. For questions on how to apply, contact Leon CAD at (903) 536-2252 or file online at [leoncad.org](http://leoncad.org).

**For more information contact:**

Mark Ruffin, Superintendent | (936) 396-2204

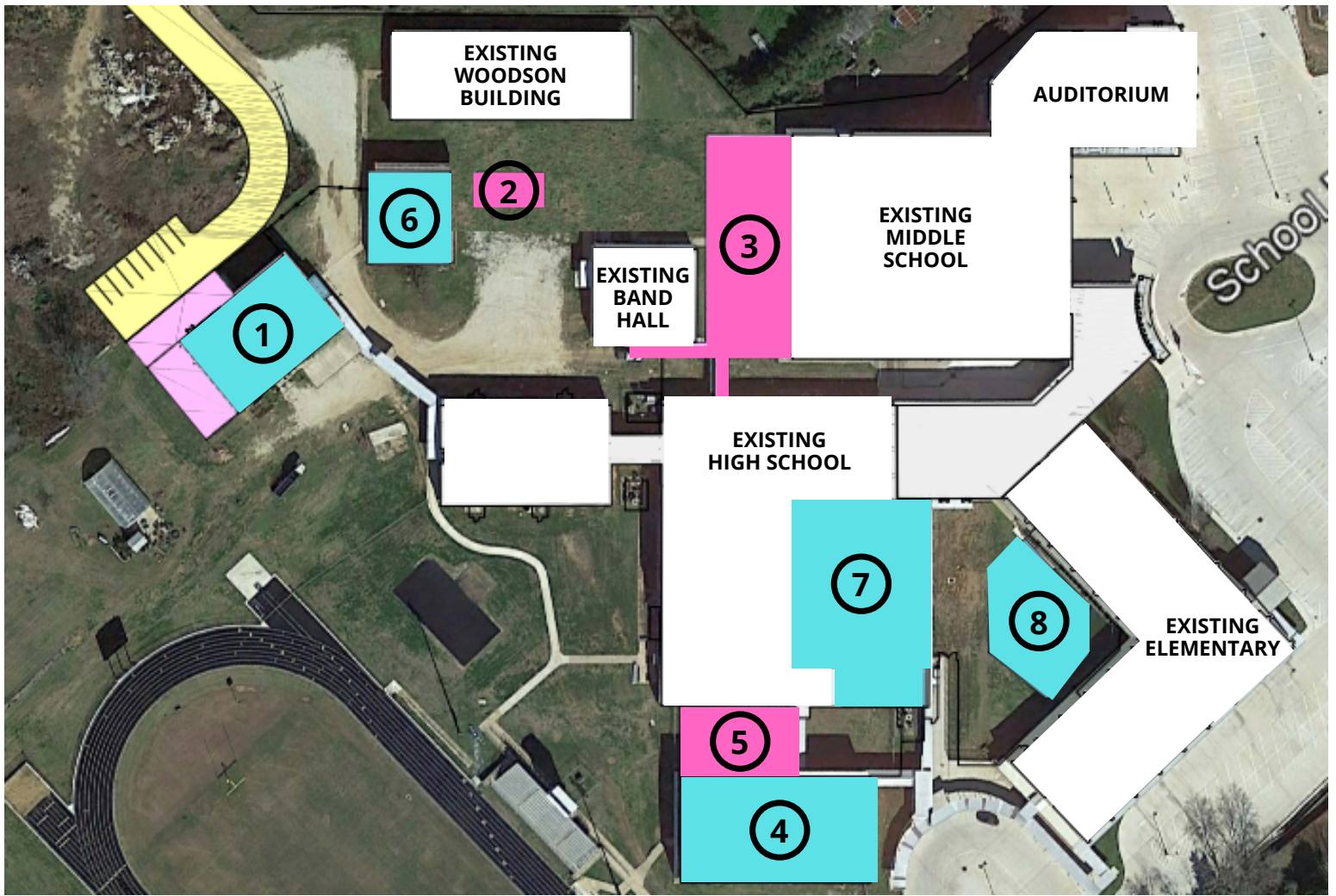

- ① Ag Shop Renovation
- ② Green House
- ③ Classroom Connection between HS, JH & Band Hall
- ④ Old Gym Renovation
- ⑤ New Weight Room
- ⑥ Red Brick Building Renovation
- ⑦ Kitchen and Cafeteria Improvements and Expansion
- ⑧ New Playground with Inclusive Equipment

### Ballot Language

#### NORMANGEE INDEPENDENT SCHOOL DISTRICT PROPOSITION A

THE ISSUANCE OF \$20,000,000 OF BONDS BY THE NORMANGEE INDEPENDENT SCHOOL DISTRICT FOR SCHOOL FACILITIES, BUSES AND VEHICLES AND LEVYING THE TAX IN PAYMENT THEREOF. THIS IS A PROPERTY TAX INCREASE.

FOR

AGAINST

**EARLY VOTING** • **ELECTION DAY**  
**WEEKDAYS** • **NOV 2<sup>ND</sup>, 2021**  
**OCT 18 - 28** • **7:00AM - 7:00PM**

**For more information contact:**  
 Mark Ruffin, Superintendent | (936) 396-2204