

### CONSTRUCTION BUDGET

| ITEM                    | QTY    | UNITS | UNIT COST | EXTENDED            |
|-------------------------|--------|-------|-----------|---------------------|
| ELEM RENOVATION         | 5,810  | SF    | \$100     | \$ 581,000          |
| CONNECTION ADDITION     | 15,290 | SF    | \$250     | \$ 3,822,500        |
| CANOPIES                |        | LS    |           | \$ 225,000          |
| <b>TOTAL CONST COST</b> |        |       |           | <b>\$ 4,628,500</b> |

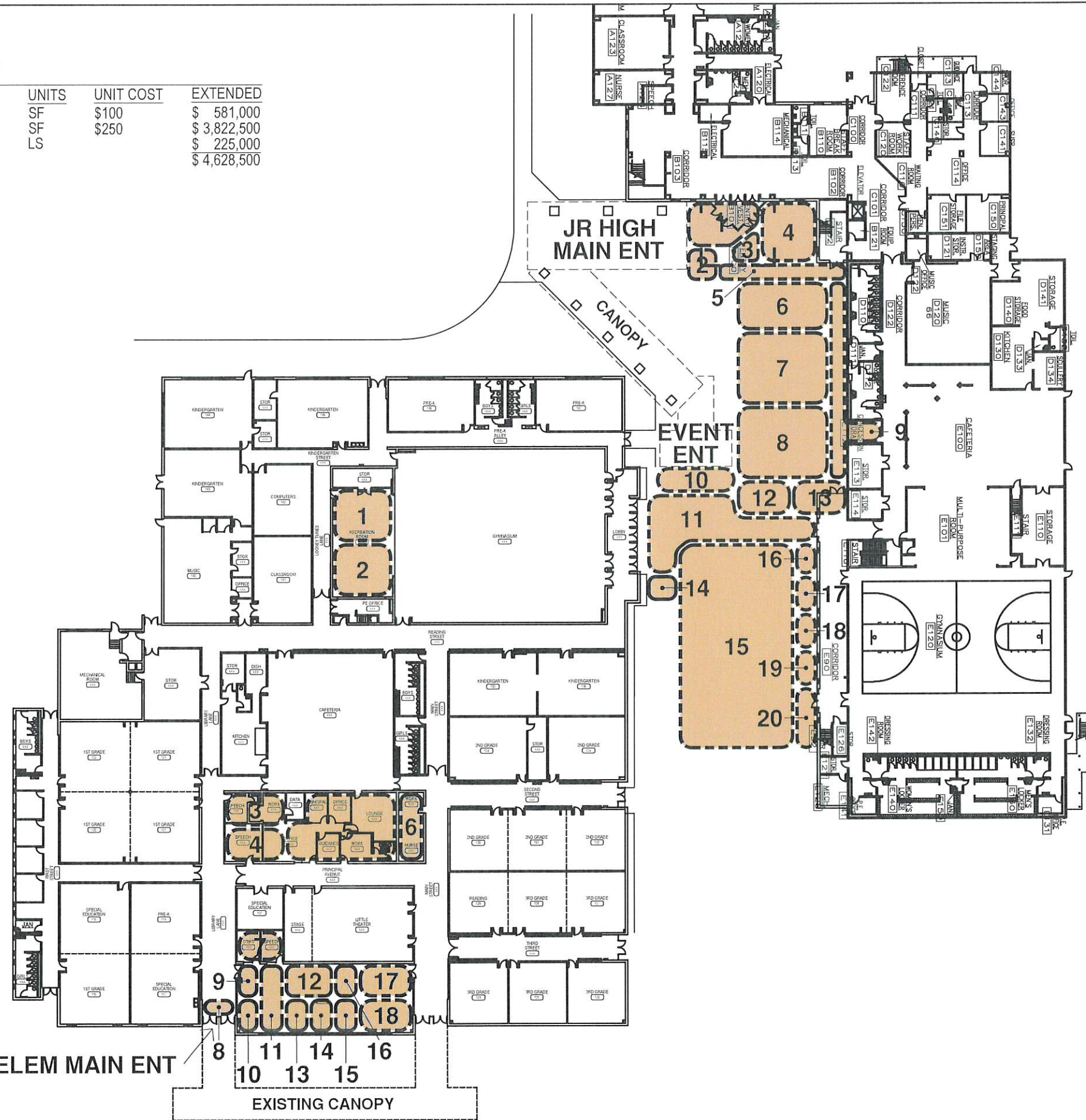

### ELEM RENOVATION

|                           |                  |
|---------------------------|------------------|
| 1. CLASSROOM              | -640 SF          |
| 2. CLASSROOM              | -640 SF          |
| 3. GANG TOILET            | -400 SF          |
| 4. GANG TOILET            | -400 SF          |
| 5. LIBRARY / MEDIA CENTER | -640 SF          |
| 6. LOUNGE / WK RM         | -340 SF          |
| 7. NURSE                  | -280 SF          |
| 8. SECURE VESTIBULE       | -115 SF          |
| 9. WAITING                | -145 SF          |
| 10. SECURE MAN LOCK       | -145 SF          |
| 11. RECEPTION             | -340 SF          |
| 12. CONFERENCE            | -340 SF          |
| 13. GUIDANCE              | -165 SF          |
| 14. ASST PRINCIPAL        | -165 SF          |
| 15. PRINCIPAL             | -165 SF          |
| 16. STORAGE               | -150 SF          |
| 17. TITLE ROOM 1          | -370 SF          |
| 18. TITLE ROOM 2          | -370 SF          |
| <b>TOTAL ELEM RENOV</b>   | <b>-5,810 SF</b> |

### CONNECTION ADDITION

|                            |                   |
|----------------------------|-------------------|
| 1. SECURE ENT VESTIBULE    | -615 SF           |
| 2. VISITOR MANLOCK/WAITING | -250 SF           |
| 3. CLASSROOM STORAGE       | -150 SF           |
| 4. CLASSROOM               | -685 SF           |
| 5. EXIT PASSAGEWAY         | -470 SF           |
| 6. CLASSROOM               | -915 SF           |
| 7. CHORUS                  | -1,370 SF         |
| 8. TLC CLASSROOM           | -1,370 SF         |
| 9. CONNECTION CORR         | -860 SF           |
| 10. EVENT VESTIBULE        | -435 SF           |
| 11. EVENT LOBBY            | -1,515 SF         |
| 12. GANG TOILET            | -395 SF           |
| 13. GANG TOILET            | -395 SF           |
| 14. STORAGE/VESTIBULE      | -170 SF           |
| 15. MULTI-PURPOSE          | -4,775 SF         |
| 16. CONCESSIONS            | -145 SF           |
| 17. STORAGE                | -165 SF           |
| 18. STORAGE                | -165 SF           |
| 19. STORAGE                | -165 SF           |
| 20. CORRIDOR EXTENSION     | -280 SF           |
| <b>TOTAL ADDITION</b>      | <b>-15,290 SF</b> |

NEW ELEM MAIN ENT

EXISTING CANOPY

### PROPOSED FLOOR PLAN

1" = 50'-0"

NOTES: NOT FOR CONSTRUCTION. SCHEMATIC PLAN SQUARE FOOTAGES ARE GROSS AREAS.