

Transfers dated from 06/01/17 to 06/30/17

## PENNNSVILLE BOARD OF EDUCATION

## TRANSFER LIST

<u>Date</u>	<u>Description</u>		<u>Amount</u>	<u>Remarks</u>
06/30/17	Transfer from 11-000 -100 -561 -00	to 11-000 -100 -563 -00	8,838.00	
06/30/17	Transfer from 11-000 -100 -561 -00	to 11-000 -100 -565 -00	60,000.00	
06/30/17	Transfer from 11-000 -100 -566 -00	to 11-000 -100 -565 -00	37,000.00	
06/30/17	Transfer from 11-000 -100 -568 -00	to 11-000 -100 -565 -00	17,000.00	
06/30/17	Transfer from 11-000 -100 -569 -00	to 11-000 -100 -565 -00	10,000.00	
06/30/17	Transfer from 11-000 -216 -100 -06	to 11-000 -100 -565 -00	100,000.00	
06/30/17	Transfer from 11-000 -217 -320 -06	to 11-000 -100 -565 -00	70,000.00	
06/30/17	Transfer from 11-190 -100 -500 -00	to 11-000 -100 -565 -00	30,000.00	
06/30/17	Transfer from 11-190 -100 -610 -05	to 11-000 -100 -565 -00	20,000.00	
06/30/17	Transfer from 11-190 -100 -610 -40	to 11-000 -100 -565 -00	14,000.00	
06/30/17	Transfer from 11-212 -100 -106 -30	to 11-000 -100 -565 -00	23,744.00	
06/30/17	Transfer from 11-000 -262 -621 -00	to 11-000 -100 -566 -00	47,085.00	
06/30/17	Transfer from 11-000 -217 -320 -06	to 11-000 -217 -106 -06	1,967.00	
06/30/17	Transfer from 11-000 -218 -104 -07	to 11-000 -218 -104 -05	1.00	
06/30/17	Transfer from 11-000 -221 -105 -61	to 11-000 -221 -104 -61	9,000.00	
06/30/17	Transfer from 11-000 -218 -600 -17	to 11-000 -221 -104 -61	17,769.00	
06/30/17	Transfer from 11-000 -230 -100 -00	to 11-000 -230 -530 -00	2,489.00	
06/30/17	Transfer from 11-000 -230 -100 -00	to 11-000 -230 -610 -00	116.00	
06/30/17	Transfer from 11-000 -230 -100 -00	to 11-000 -240 -105 -10	7,835.00	
06/30/17	Transfer from 11-000 -240 -103 -05	to 11-000 -240 -600 -10	253.00	
06/30/17	Transfer from 11-000 -251 -340 -00	to 11-000 -251 -600 -00	169.00	
06/30/17	Transfer from 11-000 -291 -270 -00	to 11-000 -262 -300 -00	31.00	
06/30/17	Transfer from 11-000 -270 -503 -00	to 11-000 -270 -518 -00	19,000.00	
06/30/17	Transfer from 11-000 -270 -511 -00	to 11-000 -270 -518 -00	15,000.00	
06/30/17	Transfer from 11-000 -270 -512 -00	to 11-000 -270 -518 -00	26,000.00	
06/30/17	Transfer from 11-000 -270 -513 -00	to 11-000 -270 -518 -00	29,737.00	
06/30/17	Transfer from 11-000 -291 -260 -00	to 11-000 -291 -220 -00	16,000.00	
06/30/17	Transfer from 11-000 -291 -290 -00	to 11-000 -291 -220 -00	9,000.00	
06/30/17	Transfer from 11-120 -100 -101 -05	to 11-000 -291 -220 -00	5,212.00	
06/30/17	Transfer from 11-000 -291 -270 -00	to 11-000 -291 -220 -00	3,740.00	
06/30/17	Transfer from 11-110 -100 -101 -07	to 11-000 -291 -250 -00	16,157.00	
06/30/17	Transfer from 11-000 -262 -300 -00	to 11-000 -291 -270 -00	58,000.00	
06/30/17	Transfer from 11-000 -262 -520 -00	to 11-000 -291 -270 -00	37,000.00	
06/30/17	Transfer from 11-000 -261 -420 -00	to 11-000 -291 -270 -00	100,000.00	
06/30/17	Transfer from 11-000 -261 -610 -00	to 11-000 -291 -270 -00	20,000.00	
06/30/17	Transfer from 11-212 -100 -106 -30	to 11-000 -291 -270 -00	9,402.00	

Transfers dated from 06/01/17 to 06/30/17

<u>Date</u>	<u>Description</u>	<u>Amount</u>	<u>Remarks</u>
06/30/17	Transfer from 11-000 -240 -105 -05	440.00	
06/30/17	Transfer from 11-000 -240 -105 -08	195.00	
06/30/17	Transfer from 11-000 -240 -105 -40	781.00	
06/30/17	Transfer from 11-000 -240 -500 -07	500.00	
06/30/17	Transfer from 11-000 -240 -500 -08	500.00	
06/30/17	Transfer from 11-000 -240 -500 -10	43.00	
06/30/17	Transfer from 11-000 -240 -500 -40	500.00	
06/30/17	Transfer from 11-000 -240 -500 -62	2,000.00	
06/30/17	Transfer from 11-000 -240 -600 -05	4,083.00	
06/30/17	Transfer from 11-000 -240 -600 -07	1,344.00	
06/30/17	Transfer from 11-000 -240 -600 -08	9,087.00	
06/30/17	Transfer from 11-000 -240 -600 -10	8,124.00	
06/30/17	Transfer from 11-000 -240 -800 -40	36.00	
06/30/17	Transfer from 11-000 -240 -600 -40	38,407.00	
06/30/17	Transfer from 11-120 -100 -101 -07	16,859.00	
06/30/17	Transfer from 11-120 -100 -101 -05	3,000.00	
06/30/17	Transfer from 11-120 -100 -101 -07	20,000.00	
06/30/17	Transfer from 11-120 -100 -101 -08	7,000.00	
06/30/17	Transfer from 11-190 -100 -320 -10	8,000.00	
06/30/17	Transfer from 11-190 -100 -320 -23	3,000.00	
06/30/17	Transfer from 11-190 -100 -500 -00	15,829.00	
06/30/17	Transfer from 11-190 -100 -500 -00	724.00	
06/30/17	Transfer from 11-190 -100 -500 -00	214.00	
06/30/17	Transfer from 11-000 -291 -270 -00	5,716.00	
06/30/17	Transfer from 11-000 -291 -270 -00	3,669.00	
06/30/17	Transfer from 11-402 -100 -100 -00	5,592.00	
06/30/17	Transfer from 11-401 -100 -930 -00	14,000.00	
06/30/17	Transfer from 11-401 -100 -930 -00	10,000.00	
06/30/17	Transfer from 11-401 -100 -100 -00	3,128.00	
06/30/17	Transfer from 20-231 -200 -200 -00	849.00	
06/30/17	Transfer from 20-231 -200 -200 -00	1,004.00	
06/30/17	Transfer from 20-508 -210 -320 -00	1,491.00	
06/30/17	Transfer from 20-509 -210 -320 -00	10,926.00	
06/30/17	Transfer from 20-507 -210 -330 -00	2,198.00	
06/30/17	Transfer from 20-506 -210 -320 -00	2,198.00	

PENNSYLVANIA BOARD OF EDUCATION

## TRANSFER LIST

8/16/2017 2:36:04 PM

Page 3 of 3

<u>Amount</u>	<u>Remarks</u>
---------------	----------------

06/30/17	Transfer	from 20-507	-210	-330	-00	to 20-509	-210	-320	-00	8,728.00
06/30/17	Transfer	from 30-000	-400	-500	-00	to 30-000	-400	-334	-00	158,916.00
06/30/17	Transfer	from 30-000	-400	-450	-71	to 30-000	-400	-334	-71	3,565.00
06/30/17	Transfer	from 30-000	-400	-500	-00	to 30-000	-400	-450	-00	2,506.00
06/30/17	Transfer	from 70-992	-320	-500	-00	to 70-992	-320	-100	-00	180.00

*David*

19

Handwritten signature: *Handwritten signature*

**June 30, 2017**  
**REPORT OF THE TREASURER**

FUNDS & ACCOUNTS	BEGINNING BALANCE	RECEIPTS	DISBURSED	ENDING BALANCE
GENERAL FUND-10	\$ 1,725,402.32	\$ 1,766,148.24	\$ 3,489,420.83	\$ 2,129.73
ARRA FUND-18	\$ -	\$ -	\$ -	\$ -
SPECIAL REVENUE-20	\$ 287,225.62	\$ 11,687.91	\$ 105,109.42	\$ 193,804.11
CAPITAL PROJECTS FUND-30	\$ 20,272,855.53	\$ 2,369.65	\$ 7,202,006.48	\$ 13,073,218.70
DEBT SERVICE-40	\$ (0.91)	\$ 1.00	\$ -	\$ 0.09
PERMANENT FUND- 50	\$ 88,720.22	\$ -	\$ -	\$ 88,720.22
ENTERPRISEFUND- 60	\$ (636.90)	\$ 80,456.49	\$ 77,759.35	\$ 2,060.24
INTERNAL SERVICE FUND- 70	\$ 269,957.89	\$ 6,771.00	\$ 27,204.15	\$ 249,524.74
 TOTAL GOVERNMENT FUNDS	 <u>\$ 22,643,523.77</u>	 <u>\$ 1,867,434.29</u>	 <u>\$ 10,901,500.23</u>	 <u>\$ 13,609,457.83</u>
 PAYROLL	 \$ 102.27	 \$ 938,783.09	 \$ 938,885.36	 \$ -
PAYROLL AGENCY	<u>\$ 36,060.80</u>	<u>\$ 1,279,714.19</u>	<u>\$ 1,279,623.53</u>	<u>\$ 36,151.46</u>
 TOTAL OTHER FUNDS	 <u>\$ 36,163.07</u>	 <u>\$ 2,218,497.28</u>	 <u>\$ 2,218,508.89</u>	 <u>\$ 36,151.46</u>
 TOTAL ALL FUNDS	 <u><u>\$ 22,679,686.84</u></u>	 <u><u>\$ 4,085,931.57</u></u>	 <u><u>\$ 13,120,009.12</u></u>	 <u><u>\$ 13,645,609.29</u></u>

**RECONCILIATION OF ACCOUNTS**

**BANK BALANCES- GOVERNMENTAL FUNDS:**

GENERAL FUND	A/C# 10278	\$ 1,438,923.46
SCHOLARSHIP FUND	A/C# 224820	\$ 88,720.22
CAPITAL PROJECT ACCOUNT	A/C# 0584	\$ 17,489,500.06
PLUS: DEPOSITS IN TRANSIT		
LESS: OUTSTANDING CHECKS		\$ 5,407,685.91
LESS: BANK ERROR		
 BALANCE- GOVERNMENTAL FUNDS		 <u>\$ 13,609,457.83</u>

**BANK BALANCES- OTHER FUNDS:**

PAYROLL ACCOUNT	A/C# 10464	\$ 47,305.05
AGENCY ACCOUNT	A/C# 10308	\$ 113,324.06
PLUS: DEPOSITS IN TRANSIT		
LESS: OUTSTANDING CHECKS		\$ 124,477.65
 BALANCE- OTHER FUNDS		 <u>\$ 36,151.46</u>
 BALANCE- June 30, 2017		 <u><u>\$ 13,645,609.29</u></u>

Respectfully Submitted,

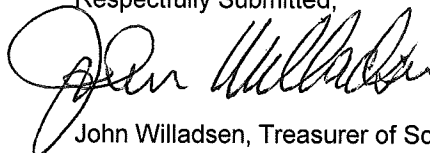

John Willadsen, Treasurer of School Monies

## **BOARD SECRETARY'S CERTIFICATION**

Pursuant to N.J.A.C. 6A:23A-16.10(c)3, I certify that as of June 30, 2017, no budgetary line item account has obligations and payments (contractual orders) which in total exceed the amount appropriated by the Pennsville Board of Education pursuant to N.J.S.A. 18A:22-8.1 and N.J.S.A. 18A:22-8.2 and no budgetary line item account has been over-expended in violation of N.J.A.C. 6A:23A-16.10(c)4. And in accordance with N.J.A.C. 6A:23A-16.10(c)2, it is certified that there are no changes in anticipated revenue amounts and sources for the month ending June, 2017.

A handwritten signature in black ink, appearing to read "Richard Davidson", is written over a horizontal line.

Richard Davidson  
Board Secretary

August 28, 2017

## Statement of Assurance Regarding the Use of Paraprofessional Staff 2017-18 School Year

### Instructions:

Complete and sign the biannual Statement of Assurance and submit to the County Office of Education no later than **September 30, 2017 and January 31, 2018.**

- Districts, charter and renaissance school projects must maintain a list of paraprofessional employees and their titles.
- Approved Private Schools for Students with Disabilities must also submit a list of paraprofessional staff and their titles along with the completed Statement of Assurance.

### Contact Information

County:	Salem
District:	Pennsville
Superintendent:	Dr. Michael Brodzik, Ed.D.
Phone:	856.540.6200 x 7118
Email:	mbrodzik@pv-eagles.org

### Compliance with State Regulatory Requirements: Check yes, no or N/A:

<input type="checkbox"/> Yes <input type="checkbox"/> No <input type="checkbox"/> N/A	Paraprofessional staff, as defined in N.J.A.C. 6A:9, were hired as instructional, health and safety personnel in accordance with the requirements of individualized educational programs, N.J.A.C. 6A:32-4.2 and N.J.A.C. 6A:23A-18.
<input checked="" type="checkbox"/> Yes <input type="checkbox"/> No <input type="checkbox"/> N/A	Job descriptions for special education classroom aides have been previously submitted and approved by the County Office of Education in accordance with N.J.A.C. 6A:14-4.1(e). Any changes to previously approved job descriptions or new job descriptions are attached to this SOA. If no special education aides are used, check N/A.

### Compliance with Federal Title I Requirements: Check yes, no or N/A:

<input checked="" type="checkbox"/> Yes <input type="checkbox"/> No <input type="checkbox"/> N/A	Paraprofessional staff supported in whole or in part by Title I or Title I blended funds meet the <i>Every Student Succeeds Act (ESSA)</i> requirements: completed at least two years of study at an institution of higher education; obtained an associate's (or higher) degree; or met a rigorous standard of quality and demonstrated, through a formal state or local academic assessment, knowledge of and the ability to assist in instructing, reading, writing and mathematics (or, as appropriate), reading readiness, writing readiness and mathematics readiness in accordance with the 34 CFR §200.58. If no Title I funded aides are used, check N/A.
--	--

Dr. Michael Brodzik, Ed. D.

Name of Superintendent

Signature

08/23/2017

Date

**APPLICATION FOR DUAL USE OF EDUCATIONAL SPACE**  
**2017-18 SCHOOL YEAR**

Attachment "K"  
August 28, 2017

This form is to be used when educational space is required but limited. Dual use of educational spaces is permitted under limited circumstances wherein two small group classes of similar nature separated by a movable divider are operating simultaneously within the same educational space. Permission to operate a dual use educational space must be obtained from the county superintendent annually.

County: Salem District: Pennsville

School: Central Park Elementary School

Room Number/Name: 114 State Approved Use: classroom

Requested Use: small group instruction  
reading coaches And: small group instruction  
basic skills instruction

Number of students and teachers (total) in each group: 9 And: 9

Description of movable divider used (e.g. height, length, bookshelf, acoustical, etc.):  
6' high, 15' long divider

**Submit the following with this application:**

**A sketch of the space showing room size, location of exit doors, fire detection systems, ventilation systems and divider, must accompany this form.**

The Board of Education approved the Dual Use Application for the 2017 - 2018 school year on  
August 28, 2017 (Date).

**\*\*\*A COPY OF RESOLUTION FROM MINUTES MUST BE ATTACHED\*\*\***

Certified by: \_\_\_\_\_  
(Chief School Administrator) (Date)

\_\_\_\_\_  
(School Business Administrator) (Date)

**FOR COUNTY SUPERINTENDENT'S USE ONLY:**

Date of Inspection by County Office: \_\_\_\_\_

Inspected by: \_\_\_\_\_

\_\_\_\_\_  
Approved as is \_\_\_\_\_ Not approved  
Approved subject to the following conditions: \_\_\_\_\_

\_\_\_\_\_  
(County Superintendent) (Date)

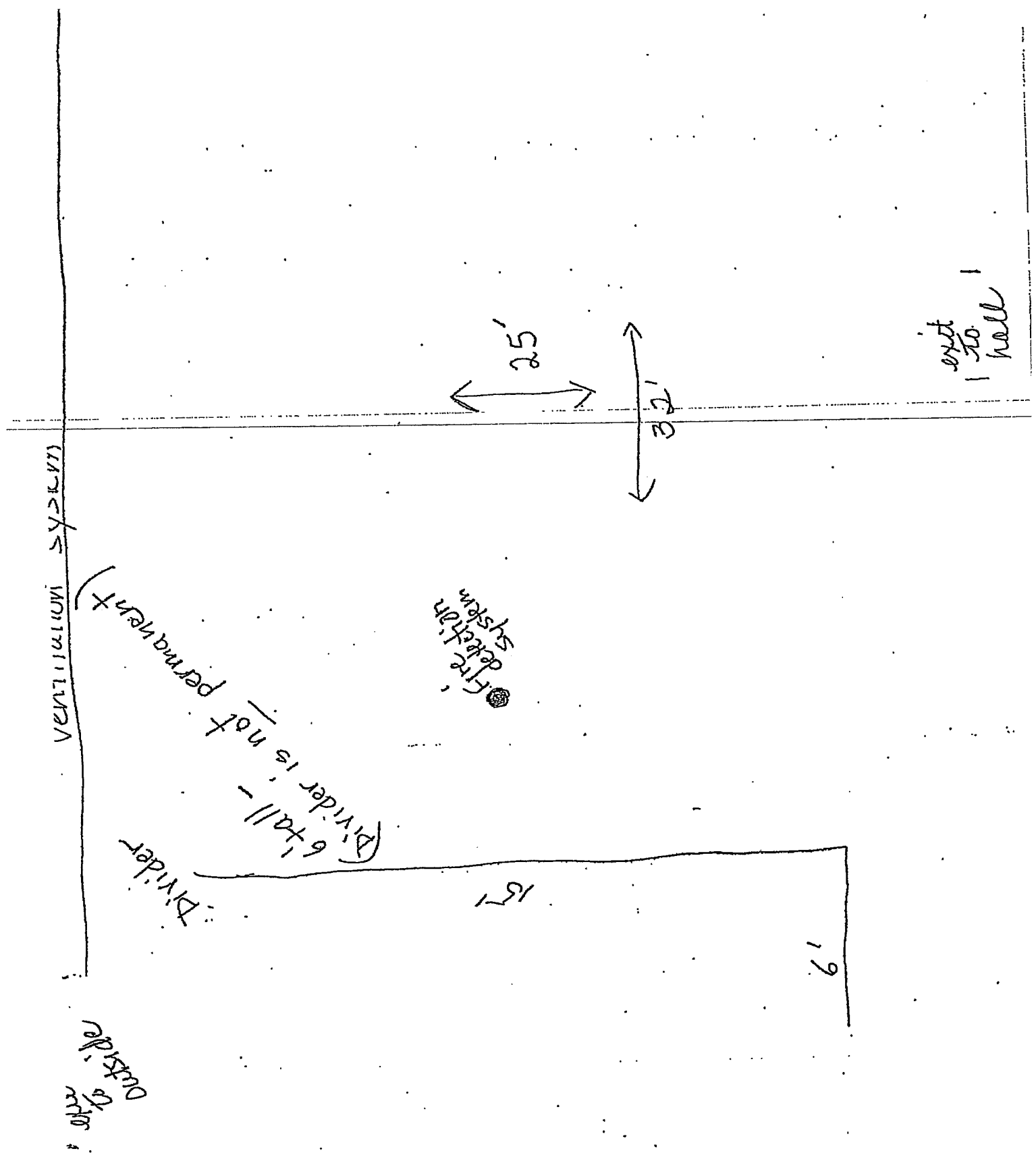



**APPLICATION FOR DUAL USE OF EDUCATIONAL SPACE**  
**2017-18 SCHOOL YEAR**

This form is to be used when educational space is required but limited. Dual use of educational spaces is permitted under limited circumstances wherein two small group classes of similar nature separated by a movable divider are operating simultaneously within the same educational space. Permission to operate a dual use educational space must be obtained from the county superintendent annually.

County: Salem District: Pennsville

School: Central Park Elementary School

Room Number/Name: 123 State Approved Use: classroom

Requested Use: small group instruction And: small group instruction  
special education grade 2 special education grade 3

Number of students and teachers (total) in each group: 9 And: 9

Description of movable divider used (e.g. height, length, bookshelf, acoustical, etc.): \_\_\_\_\_

**Submit the following with this application:**

**A sketch of the space showing room size, location of exit doors, fire detection systems, ventilation systems and divider, must accompany this form.**

The Board of Education approved the Dual Use Application for the 2017 -2018 school year on August 28, 2017 (Date).

**\*\*\*A COPY OF RESOLUTION FROM MINUTES MUST BE ATTACHED\*\*\***

Certified by: \_\_\_\_\_  
(Chief School Administrator) (Date)

\_\_\_\_\_  
(School Business Administrator) (Date)

**FOR COUNTY SUPERINTENDENT'S USE ONLY:**

Date of Inspection by County Office: \_\_\_\_\_

Inspected by: \_\_\_\_\_

\_\_\_\_\_ Approved as is \_\_\_\_\_ Not approved

\_\_\_\_\_ Approved subject to the following conditions: \_\_\_\_\_

\_\_\_\_\_  
(County Superintendent) \_\_\_\_\_ (Date)

Rm 123  
Dual Use

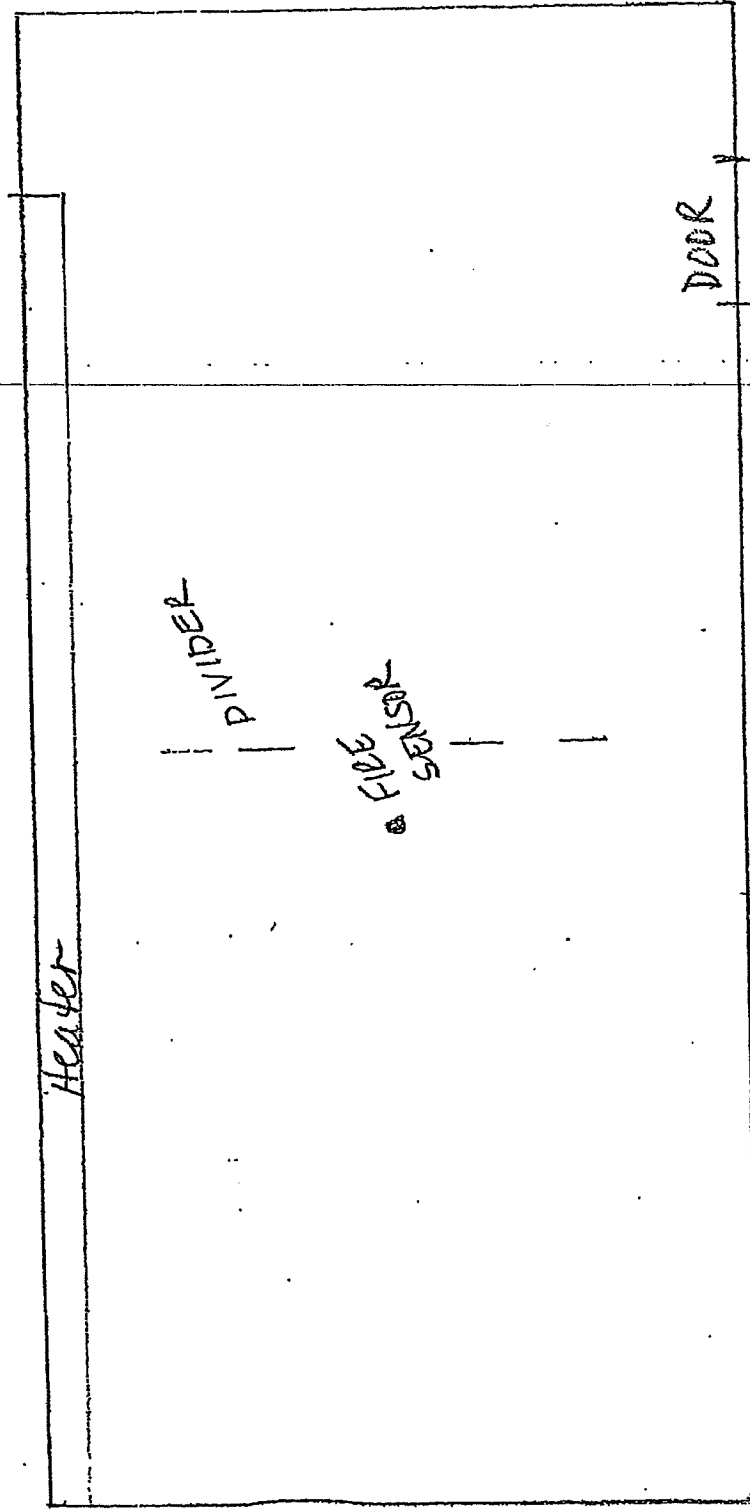

21' 6"

30' 3"

**APPLICATION FOR DUAL USE OF EDUCATIONAL SPACE**  
**2017-18 SCHOOL YEAR**

This form is to be used when educational space is required but limited. Dual use of educational spaces is permitted under limited circumstances wherein two small group classes of similar nature separated by a movable divider are operating simultaneously within the same educational space. Permission to operate a dual use educational space must be obtained from the county superintendent annually.

County: Salem District: Pennsville

School: Central Park Elementary School

Room Number/Name: 143 State Approved Use: classroom

Requested Use: small group instruction And: small group instruction  
special education grade 2 special education grade 3

Number of students and teachers (total) in each group: 9 And: 9

Description of movable divider used (e.g. height, length, bookshelf, acoustical, etc.):  
6' high, 15' long divider approximately

**Submit the following with this application:**

**A sketch of the space showing room size, location of exit doors, fire detection systems, ventilation systems and divider, must accompany this form.**

The Board of Education approved the Dual Use Application for the 2017-2018 school year on  
August 28, 2017 (Date).

**\*\*\*A COPY OF RESOLUTION FROM MINUTES MUST BE ATTACHED\*\*\***

Certified by: \_\_\_\_\_  
(Chief School Administrator) (Date)

\_\_\_\_\_  
(School Business Administrator) (Date)

**FOR COUNTY SUPERINTENDENT'S USE ONLY:**

Date of Inspection by County Office: \_\_\_\_\_

Inspected by: \_\_\_\_\_

\_\_\_\_\_  
Approved as is \_\_\_\_\_ Not approved  
Approved subject to the following conditions: \_\_\_\_\_

\_\_\_\_\_  
(County Superintendent) \_\_\_\_\_ (Date)

Rm 143

Dual Use

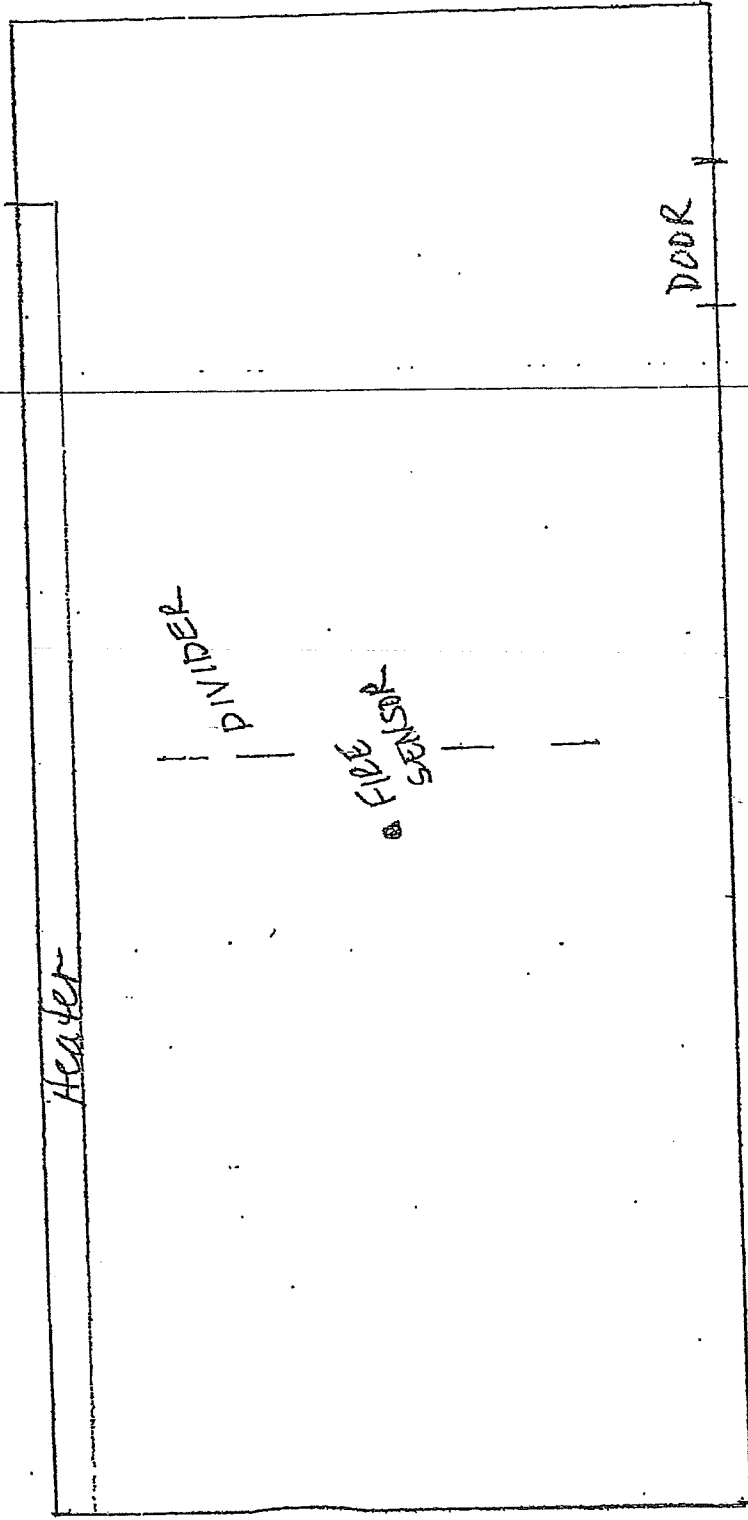

**PRINCIPALS**

Edward Vernick, PE, CME, President  
Craig F. Remington, PLS, PP, Vice President  
Michael D. Vena, PE, PP, CME (deceased 2006)  
Edward J. Walberg, PE, PP, CME, CFM  
Thomas F. Beach, PE, CME  
Richard G. Arango, PE, CME  
Kim Wendell Bibbs, PE, CME  
Marc DeBlasio, PE, PP, CME, CPWM, CEP  
Alan Dittenhofer, PE, PP, CME  
Leonard A. Faiola, PE, PP, CME  
Christopher J. Fazio, PE, CME  
Terence Vogt, PE, PP, CME  
Dennis K. Yoder, PE, PP, CME

**SENIOR ASSOCIATES**

Charles E. Adamson, PLS, AET  
John J. Cantwell, PE, PP, CME  
Richard B. Czekanski, PE, CME, BCEE  
Annina Hogan, PE, RA, CME, CPWM, LEED-AP  
Kenneth C. Ressler, PE, CME  
Frank J. Seney, Jr., PE, PP, CME, NBS  
Gregory J. Sullivan, PE, PP, CME, CEA

**PLEASE REPLY TO THE NOTED OFFICE**

**Remington & Vernick Engineers**  
232 Kings Highway East  
Haddonfield, NJ 08033  
☐ (856) 795-9595

51 Haddonfield Road, Suite 260  
Cherry Hill, NJ 08002  
☐ (856) 795-9595

**Remington, Vernick  
& Vena Engineers**  
9 Allen Street  
Toms River, NJ 08753  
☐ (732) 286-9220

3 Jocama Boulevard, Suite 300-400  
Old Bridge, NJ 08857  
☐ (732) 955-8000

**Remington, Vernick  
& Walberg Engineers**  
845 North Main Street  
Pleasantville, NJ 08232  
☐ (609) 645-7110

4907 New Jersey Avenue  
Wildwood City, NJ 08260  
☐ (609) 522-5150

Melford Plaza I, Suite 400  
16701 Melford Boulevard  
Bowie, MD 20715  
☐ (240) 544-5382

**Remington, Vernick  
& Beach Engineers**  
922 Fayette Street  
Conshohocken, PA 19428  
☐ (610) 940-1050

1000 Church Hill Road, Suite 220  
Pittsburgh, PA 15205  
☐ (412) 263-2200

Univ. Office Plaza, Bellevue Building  
262 Chapman Road, Suite 105  
Newark, DE 19702  
☐ (302) 266-0212

**Remington, Vernick  
& Arango Engineers**  
The Presidential Center, Lincoln Building  
Suite 600, 101 Route 130,  
Cinnaminson, NJ 08077  
☐ (856) 303-1245

One Harmon Plaza, Suite 210  
Secaucus, NJ 07094  
☐ (201) 624-2137

August 24, 2017

Mr. Richard Davidson, Business Administrator  
Pennsville Public School District  
Administrative Offices  
30 Church Street  
Pennsville, NJ 08070

**Re: Pennsville Board of Education  
Various School MEP & Toilet Room Improvements – Phase 2  
Change Order Recommendation #1  
Our File #1709C050-C060**

Dear Mr. Davidson:

Please find enclosed Falasca Mechanical Change Order Requests for the above referenced project for the requested improvements for the home economics classroom (room 310) conversion to Art/Graphic Arts.

This was an owner requested scope change for wall and floor improvements post demolition as well as required electrical relocations for the proposed new use.

We obtained cost proposals from the Contractor to make these additional improvements. Remington & Vernick Engineers has reviewed the proposals and finds the cost for the associated work to be reasonable and just. We therefore recommend approval of the change order in the amount of \$19,053.59 (\$14,242.79 for the general construction improvements and \$4,810.80 for the necessary electrical modifications).

Please confirm through board action if you are in agreement so that we may formally advise the Contractor. If you should have any further questions or require additional information, please contact our office.

Sincerely yours,  
**REMINGTON & VERNICK ENGINEERS, INC.**

  
Annina M. Hogan, P.E., R.A., LEED AP

AMH/cy  
Enclosure



August 22, 2017

Remington & Vernick Engineers  
232 Kings Highway – East  
Haddonfield, NJ 08033

Attn: Annina Hogan

Re: Various School and Toilet Room Improvements – Phase II

Subj: Change Order #36

Dear Ms. Hogan:

Listed below find the costs associated with providing general construction work at Room 310 for the Pennsville High School.

**Subcontractor (See Attached)**

General Construction – Porretta Builders	\$13,364.10
5% Overhead and Profit	\$ 668.21
1.5% Bonds / Insurance Additive	\$ 210.48
<b>Total</b>	<b>\$14,242.79</b>

Please contact the undersigned if you have any additional questions or comments regarding this matter.

Sincerely,

Aldo Falasca  
Project Manager

AF/hlg

## Aldo Falasca

---

**From:** Annina Hogan <annina.hogan@rve.com>  
**Sent:** Monday, July 31, 2017 12:47 PM  
**To:** Aldo Falasca; Dave Porretta  
**Cc:** Christy Yoder; Andrew Yoder  
**Subject:** Pennsville - Various MEP & Toilet Rooms Project - Change Order Request PMHS - Home Economics Conversion Change Order

**Importance:** High

Aldo/Dave,

Please see below for the scope of requested finish improvements to Room 310:

1. Remove older fin tube behind cabinetry on window wall (confirm capped before cutting)
2. At end wall exposed upon cut, finish with 1" red oak, clear satin semi-gloss finish (2 coats)
3. Patch missing floor tile area with VCT tile – Armstrong 51858 – Sandrift White
4. Plaster Patch 2 walls – window wall (including dryer vent area) & side wall (without cabinetry)
5. For corridor wall run 2-1/2" stud wall & drywall from under soffit to floor. End return just prior to switches by door so as not to disturb
6. Paint all 4 walls/soffits – Sherwin Williams 7569 – Stucco

Work to be completed this summer. Please provide COR in draft to expedite. Thanks!

Annina Hogan, P.E., R.A., LEED AP  
Principal, Executive Vice President  
Director of Engineering & Planning for Municipal Services  
Remington, Vernick & Affiliates  
232 Kings Hwy East  
Haddonfield, NJ 08033

annina.hogan@rve.com  
Ph. (856) 216 1890 x1087  
Fax(856) 216 0919

**DISCLAIMER:** This message and any documents attached contain confidential information and are intended only for the individual(s) named. If you are not the named addressee you should not disseminate, distribute or copy this e-mail and any attached documents. Please notify the sender immediately by e-mail if you have received this e-mail by mistake and delete this e-mail from your system. E-mail transmission cannot be guaranteed to be secure or error-free as information could be intercepted, corrupted, lost, destroyed, arrive late or incomplete, or contain viruses. The sender therefore does not accept liability for any errors or omissions in the contents of this message, which arise as a result of e-mail transmission. If verification is required please request a hard-copy version. Remington & Vernick Engineers, Inc., 232 Kings Highway East, Haddonfield, NJ 08033, [www.rve.com](http://www.rve.com).

Joseph Pometta Builders

Change Order Request

Change Order Request Number:

Change order Description:

Total Cost:

Breakdown

Contract

Contract Name:

Pennsville Bathrooms 2017

\* Install 1" Red Oak on end of 1/2 wall exposed

Finish oak with clear satin semi gloss

\* patch missing Floor Tile area with UCTile Armstrong 51858

\* plaster patch holes in walls as needed

\* Corridor wall install new studs & drywall wall boundary soffit to floor

\* Paint all walls 150 sq ft with Sherwin Williams 7569-

Sub-Subcontractor Costs		Cost	
Schwall painting	1 define scope		3,500
	2		
	3		
	4		
	5		
	6		
Total Subcontractor Costs		50%	3,500
			175
			\$3,675

Labor		Hours	Rate	Cost
1 Carpenter Foreman	Oak cap	2	108.45	216.90
1 Carpenter Foreman	1 plaster patch	16	108.45	1,735.20
1 Carpenter Foreman	2 Frame wall	4	108.45	433.80
1 Carpenter Foreman	3 Drywall / spackle	8	108.45	867.60
1 Superintendent	4	8	108.45	867.60
1 Carpenter Foreman	5 Uct work	16	108.45	1,735.20
1 Carpenter Foreman	Floor patch	8	108.45	867.60
Overhead / profit			15%	\$1,008.59
Total Labor				6,723.90
				\$7,732.49

Material		Units	Unit Cost	Total
Red oak		0		
Plaster patch material	2	0	\$	112.25
Metal studs / track	3	0	\$	100.00
Drywall	4	0	\$	126.87
Fasteners / consumables	5	0	\$	89.28
UCT & patch materials	6	0	\$	75.00
Overhead / profit				500.00
Total Material			15%	1,003.40
				150.51
				\$1,153.91

Equipment - misc		Hours	Rate	Cost
Truck / tools	1	54	0 \$ 12.00	648
general conditions	2		0 \$	
	3		0 \$	50
	4		0 \$	
Subtotal				
Overhead / profit				698
Total Equipment			15%	104.70
				\$802.70

Summary	Mark Up	Mark up total	Totals
Total Subcontractor	15%	\$	\$
Total Labor	15%	\$	\$
Total Material	15%	\$	\$
Total Equipment / misc	15%	\$	\$

Total Cost

Total add \$ 13,364.10





August 22, 2017

Remington & Vernick Engineers  
232 Kings Highway – East  
Haddonfield, NJ 08033

Attn: Annina Hogan

Re: Various School and Toilet Room Improvements – Phase II

Subj: Change Order #35

Dear Ms. Hogan:

Listed below find the costs associated with providing additional electrical work at former Home Economics Room at Pennsville High School.

**Subcontractor (See Attached)**

Electrical	\$4,514.00
5% Overhead and Profit	\$ 225.70
1.5% Bonds / Insurance Additive	\$ 71.10
<b>Total</b>	<b>\$4,810.80</b>

Please contact the undersigned if you have any additional questions or comments regarding this matter.

Sincerely,

  
Aldo Falasca  
Project Manager

AF/hlg

# CHAMMINGS ELECTRIC, INC.

NJ LICENSE #11203

DE LICENSE #5837

PHILLY LICENSE #36633



## REQUEST FOR CHANGE ORDER #15

Date: 8/17/17

Attn: Aldo Falasca

Re: Pennsville HS Home EC. Floor Conduit

271 West Elmer Road  
Vineland, NJ 08360  
P.O. Box 789  
Vineland, NJ 08362-0789  
Phone: 856-691-0653  
Fax: 856-691-6225

Aldo

Rework existing floor conduit so the existing circuits are functioning normal the follow work will take place:

- 1—Sawcut a 6"x12" area and cut existing couplings so the conduit can be reworked to new floor boxes.
- 2—Sawcut (2) areas 8"x4" square cut couplings and install (2) floor boxes.
- 3—Sawcut to join (2) new floor boxes.

Total cost for the above.....\$4,514.00

Electrically Yours,

Michael Patane  
President  
Chammings Electric Inc.  
[MikePatane@ChammingsElectric.com](mailto:MikePatane@ChammingsElectric.com)  
[ChammingsElectric.com](http://ChammingsElectric.com)

# PRICING SHEET

JOB H/S Home EC, Reman  
 WORK Install Floor Boxes.

ESTIMATE NO. \_\_\_\_\_  
 Sheet No. \_\_\_\_\_ Of \_\_\_\_\_ Sheets

ESTIMATED BY \_\_\_\_\_ PRICED BY \_\_\_\_\_ EXTENDED BY \_\_\_\_\_ CHECKED BY \_\_\_\_\_ DATE \_\_\_\_\_

	MATERIAL	QUANTITY	MATERIAL PRICE	PER	MATERIAL EXTENSION	LABOR UNIT	PER	LABOR EXTENSION
1	DEMO Floor Boxes	2						
2	Jacobell Floor Box							
3								
4	SPUD CUT Trench	4/s.						
5	CUT/Rework Conduit	4/s.						
6								
7	Floor Box/Cover	2						
8	Conduit/Couplings/wire	4/s.						
9								
10	MISC	4/s.						
11								
12								
13								
14								
15	Material + 15%	1,610						
16	Labor @ 12/m.	2,904						
17		<del>4,514</del>						
18								
19								
20								
21								
22								
23								
24								
25								
26								
27								
28								
29								
30								
31								
32								
33								
34								

Totals This Sheet Transferred To Recap By-INITIAL

MATERIAL 1400
 LABOR 24

**PRINCIPALS**

Edward Vernick, PE, CME, President  
Craig F. Remington, PLS, PP, Vice President  
Michael D. Vena, PE, PP, CME (deceased 2006)  
Edward J. Walberg, PE, PP, CME, CFM  
Thomas F. Beach, PE, CME  
Richard G. Arango, PE, CME  
Kim Wendell Bibbs, PE, CME  
Marc DeBlasio, PE, PP, CME, CPWM, CEP  
Alan Dittenhofer, PE, PP, CME  
Leonard A. Falola, PE, PP, CME  
Christopher J. Fazio, PE, CME  
Terence Vogt, PE, PP, CME  
Dennis K. Yoder, PE, PP, CME

**SENIOR ASSOCIATES**

Charles E. Adamson, PLS, AET  
John J. Cantwell, PE, PP, CME  
Richard B. Czekanski, PE, CME, BCEE  
Annina Hogan, PE, RA, CME, CPWM, LEED-AP  
Kenneth C. Ressler, PE, CME  
Frank J. Seney, Jr., PE, PP, CME, NBIS  
Gregory J. Sullivan, PE, PP, CME, CEA

**PLEASE REPLY TO THE NOTED OFFICE**

**Remington & Vernick Engineers**  
232 Kings Highway East  
Haddonfield, NJ 08033  
☐ (856) 795-9595

51 Haddonfield Road, Suite 260  
Cherry Hill, NJ 08002  
☐ (856) 795-9595

**Remington, Vernick  
& Vena Engineers**  
9 Allen Street  
Toms River, NJ 08753  
☐ (732) 286-9220

3 Jocama Boulevard, Suite 300-400  
Old Bridge, NJ 08857  
☐ (732) 955-8000

**Remington, Vernick  
& Walberg Engineers**  
845 North Main Street  
Pleasantville, NJ 08232  
☐ (609) 645-7110

4907 New Jersey Avenue  
Wildwood City, NJ 08260  
☐ (609) 522-5150

Melford Plaza I, Suite 400  
16701 Melford Boulevard  
Bowie, MD 20715  
☐ (240) 544-5382

**Remington, Vernick  
& Beach Engineers**  
922 Fayette Street  
Conshohocken, PA 19428  
☐ (610) 940-1050

1000 Church Hill Road, Suite 220  
Pittsburgh, PA 15205  
☐ (412) 263-2200

Univ. Office Plaza, Bellevue Building  
262 Chapman Road, Suite 105  
Newark, DE 19702  
☐ (302) 266-0212

**Remington, Vernick  
& Arango Engineers**  
The Presidential Center, Lincoln Building  
Suite 600, 101 Route 130,  
Cinnaminson, NJ 08077  
☐ (856) 303-1245

One Harmon Plaza, Suite 210  
Secaucus, NJ 07094  
☐ (201) 624-2137

August 24, 2017

Mr. Richard Davidson, Business Administrator  
Pennsville Public School District  
Administrative Offices  
30 Church Street  
Pennsville, NJ 08070

**Re: Pennsville Board of Education  
Various School MEP & Toilet Room Improvements – Phase 2  
Change Order Recommendation #2  
Our File #1709C050-C060**

Dear Mr. Davidson:

Please find enclosed Falasca Mechanical Change Order Requests for the above referenced project for the requested improvements for the connection of new Refrigerator and Freezer circuitry and generator panel connection.

This was an owner requested scope change for above referenced equipment.

We obtained cost proposals from the Contractor to make these additional improvements. Remington & Vernick Engineers has reviewed the proposals and finds the cost for the associated work to be reasonable and just. We therefore recommend approval of the change order in the amount of \$5,094.29.

Please confirm through board action if you are in agreement so that we may formally advise the Contractor. If you should have any further questions or require additional information, please contact our office.

Sincerely yours,  
**REMINGTON & VERNICK ENGINEERS, INC.**

  
Annina M. Hogan, P.E., R.A., LEED AP

AMH/cy  
Enclosure



August 14, 2017

Remington & Vernick Engineers  
232 Kings Highway – East  
Haddonfield, NJ 08033

Attn: Annina Hogan

Re: Various School and Toilet Room Improvements – Phase II

Subj: Change Order #32

Dear Ms. Hogan:

Listed below find the costs associated with providing electrical work for (2) Refrigerators and (2) Freezers at the above referenced project.

**Subcontractor (See Attached)**

Electrical – Chamings Electric, Inc.	\$4,780.00
5% Overhead and Profit	\$ 239.00
1.5% Bonds / Insurance Additive	\$ 75.29
<b>Total</b>	<b>\$5,094.29</b>

Please contact the undersigned if you have any additional questions or comments regarding this matter.

Sincerely,

  
Aldo Falasca  
Project Manager

AF/hlg

# CHAMMINGS ELECTRIC, INC.

NJ LICENSE #11203

DE LICENSE #5837

PHILLY LICENSE #36633



## REQUEST FOR CHANGE ORDER #14

Date: 8/10/17

Attn: Aldo Falasca

Re: Penn Beach Refrigerators & Freezers Power Feeds

271 West Elmer Road  
Vineland, NJ 08360  
P.O. Box 789  
Vineland, NJ 08362-0789  
Phone: 856-691-0633  
Fax: 856-691-6225

Aldo—The cost to supply raceway, wire, breakers and labor to feed (2) refrigerators and (2) Freezers.

Total Cost for the above.....\$4,780.00

Electrically Yours,

Michael Patane  
President  
Chammings Electric Inc.  
[MikePatane@ChammingsElectric.com](mailto:MikePatane@ChammingsElectric.com)  
[ChammingsElectric.com](http://ChammingsElectric.com)

CONTRACTORS-INDUSTRIAL-INSTITUTIONAL-COMMERCIAL CONSTRUCTION & MAINTENANCE-OVERHEAD & UNDERGROUND LINE  
CONSTRUCTION-SUBSTATION ERECTION-CONTROL PANELS-DESIGN & FABRICATION-COMMUNICATION & FIBER OPTIC SYSTEMS  
EQUAL OPPORTUNITY EMPLOYER

# PRICING SHEET

JOB PENN BENCH  
 WORK Refridge & Freezer Room

ESTIMATE NO. \_\_\_\_\_  
 Sheet No. \_\_\_\_\_ Of \_\_\_\_\_ Sheets

ESTIMATED BY \_\_\_\_\_ PRICED BY \_\_\_\_\_ EXTENDED BY \_\_\_\_\_ CHECKED BY \_\_\_\_\_ DATE \_\_\_\_\_

	✓	MATERIAL	QUANTITY	MATERIAL PRICE	PER	MATERIAL EXTENSION	LABOR UNIT	PER	LABOR EXTENSION
1		Refridge (2) Door	2	23.00		46.00	1		2
2		Freezer (3) Door	2	27.00		54.00	1		2
3									
4		3/4" ENT w/(3) #10	100'	2.00		200.00	10		10
5		10/2 MC	400'	.75		300.00	025		10
6		Bricks	20	5.00		100.00	10		2
7		Breakers	4	6.25		25.00	25		1
8						9.00			2
9		MISC	L.S.			60.00			3
10									
11									
12									
13									
14									
15		material + 15%	1,150						
16		Labor @ 121 hr	3,630						
17			\$4,780						
18									
19									
20									
21									
22									
23									
24									
25									
26									
27									
28									
29									
30									
31									
32									
33									
34									

Totals This Sheet Transferred To Recap By-INITIAL



MATERIAL



1000

LABOR



30

August 28, 2017

*Professional Excellence Since 1901*

**PRINCIPALS**

Edward Vernick, PE, CME, President  
Craig F. Remington, PLS, PP, Vice President  
Michael D. Vena, PE, PP, CME (deceased 2006)  
Edward J. Walberg, PE, PP, CME, CFM  
Thomas F. Beach, PE, CME  
Richard G. Arango, PE, CME  
Kim Wendell Bibbs, PE, CME  
Marc DeBlasio, PE, PP, CME, CPWM, CEP  
Alan Dittenhofer, PE, PP, CME  
Leonard A. Faiola, PE, PP, CME  
Christopher J. Fazio, PE, CME  
Terence Vogt, PE, PP, CME  
Dennis K. Yoder, PE, PP, CME

**SENIOR ASSOCIATES**

Charles E. Adamson, PLS, AET  
John J. Cantwell, PE, PP, CME  
Richard B. Czekanski, PE, CME, BCEE  
Annina Hogan, PE, RA, CME, CPWM, LEED-AP  
Kenneth C. Ressler, PE, CME  
Frank J. Seney, Jr., PE, PP, CME, NBIS  
Gregory J. Sullivan, PE, PP, CME, CEA

PLEASE REPLY TO THE NOTED OFFICE

**Remington & Vernick Engineers**  
232 Kings Highway East  
Haddonfield, NJ 08033  
☐ (856) 795-9595

51 Haddonfield Road, Suite 260  
Cherry Hill, NJ 08002  
☐ (856) 795-9595

**Remington, Vernick  
& Vena Engineers**  
9 Allen Street  
Toms River, NJ 08753  
☐ (732) 286-9220

3 Jocama Boulevard, Suite 300-400  
Old Bridge, NJ 08857  
☐ (732) 955-8000

**Remington, Vernick  
& Walberg Engineers**  
845 North Main Street  
Pleasantville, NJ 08232  
☐ (609) 645-7110

4907 New Jersey Avenue  
Wildwood City, NJ 08260  
☐ (609) 522-5150

Melford Plaza I, Suite 400  
16701 Melford Boulevard  
Bowie, MD 20715  
☐ (240) 544-5382

**Remington, Vernick  
& Beach Engineers**  
922 Fayette Street  
Conshohocken, PA 19428  
☐ (610) 940-1050

1000 Church Hill Road, Suite 220  
Pittsburgh, PA 15205  
☐ (412) 263-2200

Univ. Office Plaza, Bellevue Building  
262 Chapman Road, Suite 105  
Newark, DE 19702  
☐ (302) 266-0212

**Remington, Vernick  
& Arango Engineers**  
The Presidential Center, Lincoln Building  
Suite 600, 101 Route 130,  
Cinnaminson, NJ 08077  
☐ (856) 303-1245

One Harmon Plaza, Suite 210  
Secaucus, NJ 07094  
☐ (201) 624-2137

August 24, 2017

Mr. Richard Davidson, Business Administrator  
Pennsville Public School District  
Administrative Offices  
30 Church Street  
Pennsville, NJ 08070

**Re: Pennsville Board of Education  
Various School MEP & Toilet Room Improvements – Phase 2  
Change Order Recommendation #3  
Our File #1709C050-C060**

Dear Mr. Davidson:

Please find enclosed Falasca Mechanical Change Order Requests for the above referenced project for the requested improvements for the installation of an additional storm inlet at the base of the auditorium ramp and connection to the existing storm system.

This was an owner requested scope change for above referenced equipment.

We obtained cost proposals from the Contractor to make these additional improvements. Remington & Vernick Engineers has reviewed the proposals and finds the cost for the associated work to be reasonable and just. We therefore recommend approval of the change order in the amount of \$8,837.20

Please confirm through board action if you are in agreement so that we may formally advise the Contractor. If you should have any further questions or require additional information, please contact our office..

Sincerely yours,  
**REMINGTON & VERNICK ENGINEERS, INC.**

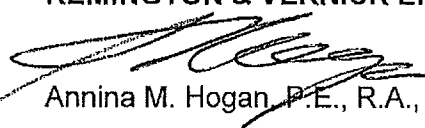
  
Annina M. Hogan, P.E., R.A., LEED AP

AMH/cy  
Enclosure





August 16, 2017

Remington & Vernick Engineers  
232 Kings Highway – East  
Haddonfield, NJ 08033

Attn: Annina Hogan

Re: Various School and Toilet Room Improvements – Phase II

Subj: Change Order #34

Dear Ms. Hogan:

Listed below find the costs associated with installing storm drain at exterior Auditorium ramp for the above referenced project.

**Subcontractor (See Attached)**

Site Work – FM Schiavone	\$8,292.00
5% Overhead and Profit	\$ 414.60
1.5% Bonds / Insurance Additive	<u>\$ 130.60</u>
<b>Total</b>	<b>\$8,837.20</b>

Please contact the undersigned if you have any additional questions or comments regarding this matter.

Sincerely,

A handwritten signature in dark ink, appearing to read 'Aldo Falasca', is written over a horizontal line.

Aldo Falasca  
Project Manager

AF/hlg



**GENERAL CONTRACTOR**  
**P.O. Box 416**  
**Malaga, NJ 08328**  
**PHN: 856-697-4558 FAX: 856-697-9612**

**August 15, 2017**

**Falasca Mechanical**  
**3329 North Mill Road**  
**Vineland, NJ 08360**

**Re: Pennsville HS Bleachers & Stadium Renovations**  
**COR #3 Trench Drains at Ramp**

**Attn: Aldo Falasca**

**The following is our Scope for the above:**

**Install 8" Trench Drains in landing at bottom of ramp at High School and tie into existing storm drain pipe. Not to exceed 10' from drain connection.**

**Includes:**

- **8" trench drain with cast iron grates**
- **Core Drill Wall**
- **6" SDR 35 pipe**
- **Tie to existing pipe with saddle connection**
- **Restoration**

**Excludes:**

- **Dewatering**
- **O.T. After Hours**
- **Check Valve / Back Flow Preventer**

**Total**

**\$8,292.00**

**Fred M Schiavone Construction**