



DRAGON DAILY ANNOUNCEMENTS

THURSDAY, AUGUST 26th

- *DRAGON INFORMATION*
- *DRAGON RULES*
- *DRAGON CLUBS*
- *DRAGON COUNSELING NEWS*

THE OPPORTUNITY IS HERE

THE FIRE IS WITHIN

DRAGON INFORMATION



LOCKERS

**If you need a locker for the 21-22 school year,
see Mrs. Gum in the Dean's office!**



Lockers will be assigned in B-C.

2021-2022

RED PARKING PASSES

- If you are in need of a pass fill out the google form on the Pekin High Website.
- Plan on picking up your permit the week of August 23rd thru August 27th at the table that will be set up in the lunchroom. DO NOT PICK THEM UP IN THE DEAN'S OFFICE!
- After August 27th you will receive an email indicating your permit is ready for pick up in the Dean's Office. Be sure to watch  your emails daily!



DRAGON RULES



Parking Lot Rules

NO Student Parking
is permitted
in **Green** Dot Spaces

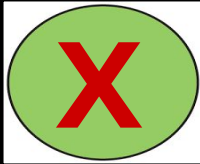

(\$25 fine if found parked in the **Green** Dot Space)



PCHS DRESS CODE

See Student Handbook
for more on Dress and Grooming

Clothing, accessories, make-up, and hair color should in no way distract from the learning environment at school or school activities nor should they create a danger to the health and safety of the students.

School personnel reserve the right to make determinations on acceptable appearance and dress.

- Masks are required, and must be worn over the nose and mouth.
- Shirts with sleeves covering the entire torso and shoulders are required.
- Pants, jeans, shorts, dresses, and skirts must extend to at least mid-thigh.
- When wearing leggings (including knit jeggings) and yoga pants, the top must cover the pelvic region and buttocks.
- No pants may have holes above mid-thigh.
- No undergarments of any kind may be exposed.
- Pajamas/pajama pants are not acceptable attire.
- As a health and safety measure, all students must wear shoes. (slippers are not allowed)

Students who choose to dress in a manner not appropriate for school will be instructed to change their clothing before they will be admitted to class.

Do you meet dress code?



Shorts are
mid- thigh length



Holes are
below mid-thigh



No holes above mid thigh



Shorts
must be
mid thigh
or longer



Do you meet dress code?



No hats



No hoods up



**Shirts must
cover the
entire torso**

Hallway Social Distancing



- Stay to your right
- Obey one way hallways
- Stay 6 feet apart
- Wear your mask

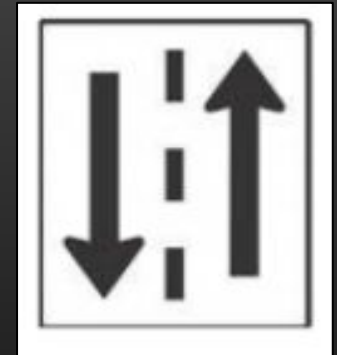

G

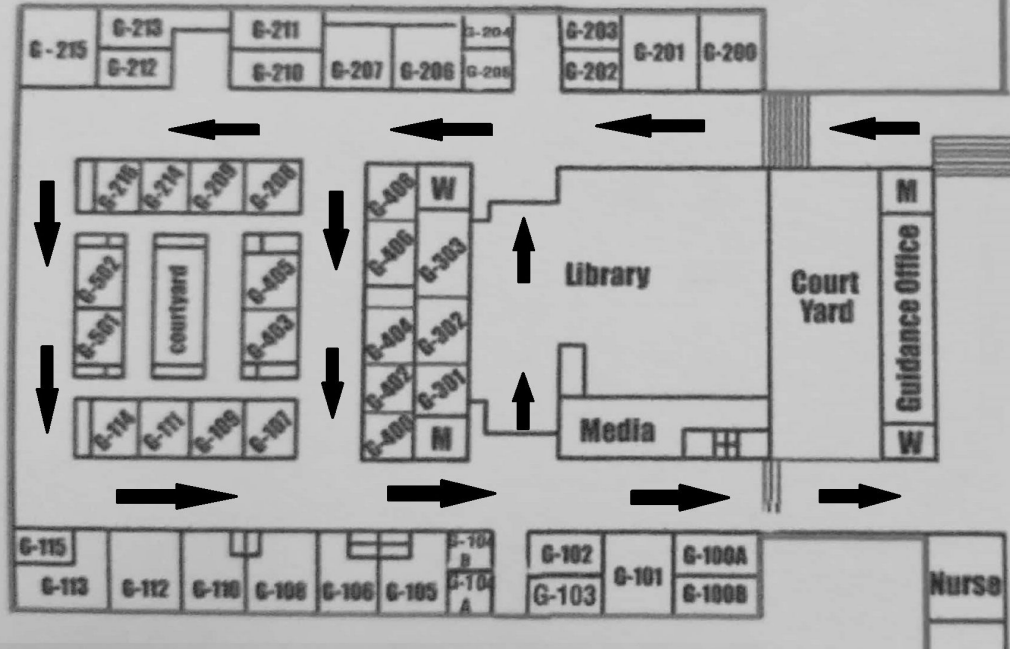

G Building One Way Halls

TRAFFIC FLOW

To aid with Social Distancing during Passing Periods, a few areas in G Building will now be considered "ONE WAY"

DRAGON OPPORTUNITIES



BEST BUDDIES®



BEST BUDDIES

Informational Meeting

Wednesday, September 1

ROOM - B220

3:15 pm

**Signup and learn about
Leadership Opportunities**

KEY CLUB



A Club
dedicated to
Volunteering
and
Acts of
Community Service!

Meetings will begin
September 1st in
Ms. Del Valle's Room (G404)

Our volunteers meet every
1st and 3rd Wednesday,
right after school!

EVERYONE IS WELCOME
to join our
Dedicated Volunteers!

Join our Reminder 
by texting pchs-key to 81010

BASS FISHING TEAM



INFORMATIONAL MEETING

Any current PCHS student interested
in the Bass Fishing Club may attend!

Tonight!

6:00 to 7:00 pm in Room A145.

Enter through the Holeman Center doors.

A Sanctuary for Koholā - Humpback Whales

Born in Hawaii!
The waters around Hawaii are important habitat for the North Pacific population of humpback whales, known as koholā in Hawaiian. After being hunted to near extinction, they were afforded international protection. This population is recovering, and about 10,000 humpback whales return every year to Hawaii. Still, whales face threats from humans, including entanglement and vessel strikes.

Long-distance Travelers
From November through April, humpbacks are found in Hawaii where they organically mating, birthing and nursing their young. They swim about 5,000 miles to waters near Alaska where they spend the summer months feeding on krill and small fish.

A Special Place
The Hawaiian Islands Humpback Whale National Marine Sanctuary was originally created to promote management, research, and monitoring for the protection of the endangered humpback whale and its habitat. The sanctuary is jointly managed by NOAA and the State of Hawaii to protect whales and other marine life.



Makapu'u Lookout - Kaiwi State Scenic Shoreline
STATE OF HAWAII / Department of Land and Natural Resources / Division of State Parks

BEE a part of the solution!

Only ONE EARTH!

**COME AND JOIN US FOR
ENVIRONMENTAL CLUB
BEGINNING AUGUST 31ST!
TUESDAYS, 3:10 - 4:00 pm
ROOM G112**

*A Good Planet
is
hard to find!!*

*Keep Calm and
GO GREEN*

FALL PLAY AUDITIONS!

- If you are interested in auditioning for this year's fall play, *Witness for the Prosecution*, please grab an audition packet from **Mr. Holt** in **G-201**!
- Auditions are on Monday, Tuesday, and Wednesday (August 30, 31, and September 1). Sign up for an audition time outside of G-201!
- Interested **crew members** will also need to grab an **audition form**. These are due September 1.
- *Do not miss a chance to be a part of this exciting show! Please reach out to Mr. Holt @ nholt@pekinhigh.net if you have any questions!*



Speech Team Auditions!!!

September 21st and 22nd
G 101 (Pyle's Room)
3:30 PM



Go to the Speech Team [website](#) to fill out an [audition form](#), find [audition material](#), and information about the different high school [speech events](#).

No prior acting or public speaking experience is needed!



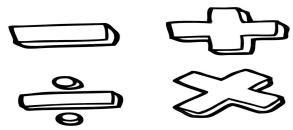

MATH CLUB

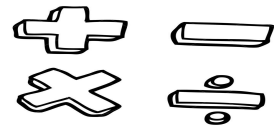

Who's PUMPED to make some
Mathemagic!?



Email- aslobidsky@pekinhigh.net
or
Stop in Room C313 with questions

DRAGON COUNSELING NEWS



UPCOMING COLLEGE REP VISITS

Paul Mitchell The School - Normal	September 16th - 10:45am/4th Hour
Eastern Illinois University	September 29th - 9:40/3rd Hour
Methodist College of UnityPoint Health	September 29th - 1:20pm/6th hour
Greenville University	October 4th - 1:20pm/6th Hour
Missouri State University	October 5th - 1:20pm/6th Hour



Juniors &
Seniors only

Sign up in
the
Counseling
Office

AP EXAM REGISTRATION -- Aug 19th-Oct. 15th!!

- ❖ Any student enrolled in an AP course has had the AP exam fee(s) added to their Skyward Account.
- ❖ The total cost **per exam** is \$87.
(unless you are on free/reduced for lunch)
- ❖ Fees need to be **paid in-full no later than Oct. 15th.**
- ❖ Any students **NOT** wanting to take their AP Exam(s) will need to inform **Mrs. Bisping or Mrs. Solver** in the Counseling Office by the Oct. 15th deadline.
- ❖ Any **FEES NOT PAID** by Oct. 15th will result in an exam **NOT** being ordered for students to take the exam.

DRAGON ATHLETICS



BLACKOUT IS BACK

AND T-SHIRTS ARE FOR SALE!!

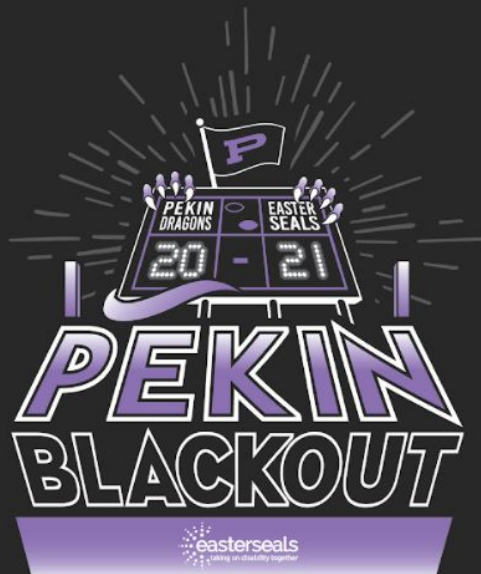

BLACKING OUT FRIDAY NIGHT
TO TURN ON THE LIGHTS FOR



A SPECIAL THANKS TO OUR SPONSORS!

GOLD SPONSORS



SILVER SPONSORS



BRONZE SPONSORS



GET YOUR T-SHIRTS AT THE STUDENT
COUNCIL BOOTH AT LUNCH OR BFO FROM
AUG. 30 - SEPT. 10

SHORT SLEEVE:

S-XL: \$10
2XL & 3XL: \$12
4XL & 5XL: \$15

LONG SLEEVE:

S-XL: \$15

OUR DRAGONS:

WEAR MASKS

SOCIAL DISTANCE

WASH HANDS FREQUENTLY

