



DRAGON DAILY ANNOUNCEMENTS

THURSDAY, AUGUST 19TH

- *DRAGON INFORMATION*
- *DRAGON RULES*
- *DRAGON CLUBS*
- *DRAGON COUNSELING NEWS*

THE OPPORTUNITY IS HERE

THE FIRE IS WITHIN

DRAGON INFORMATION



Sophomore, Junior, and Senior PHOTOS

August 20TH

PHOTOS WILL BE
TAKEN IN THE
SMALL GYM
DURING

PE
DANCE
HEALTH
JROTC
BAND

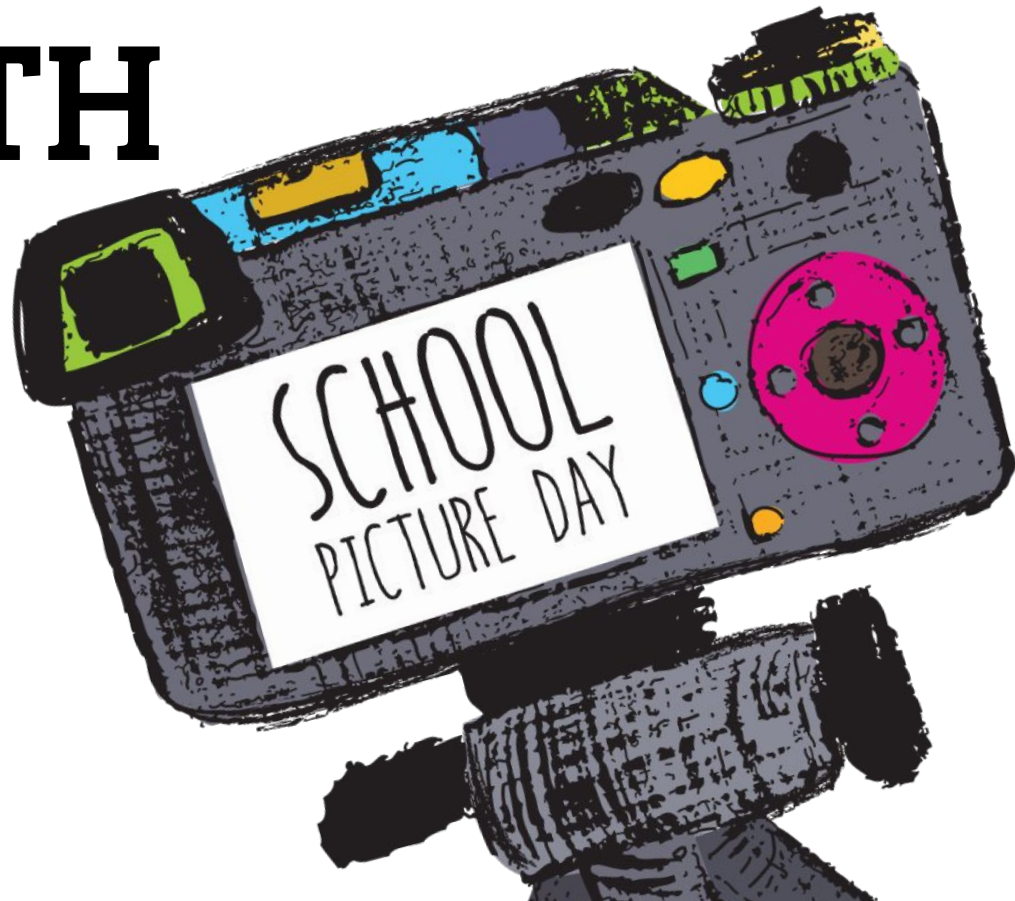



320 Stadium Drive
Pekin, IL 61554

School Meals Announcement

Pekin Community High School #303 is excited to announce participation in the Seamless Summer Option (SSO) for School Year 2021-22. This means that meals will be available at no cost to all enrolled students. SSO is administered by the Illinois State Board of Education (ISBE) and funded by the U.S. Department of Agriculture (USDA). SSO is traditionally a program option for schools during the summer but flexibilities due to the pandemic make it available for the upcoming year.

SSO meals are a healthy balanced selection of grains, vegetables, milk, fruits, and protein foods. Check out this [MyPlate Guide to School Lunch](https://fns-prod.azureedge.net/sites/default/files/tn/SI_Infographic_81216a.pdf) (https://fns-prod.azureedge.net/sites/default/files/tn/SI_Infographic_81216a.pdf) and [MyPlate Guide to School Breakfast](https://fns-prod.azureedge.net/sites/default/files/tn/SB_Infographic_81216a.pdf) (https://fns-prod.azureedge.net/sites/default/files/tn/SB_Infographic_81216a.pdf).

Non-Discrimination Statement

In accordance with Federal civil rights law and U.S. Department of Agriculture (USDA) civil rights regulations and policies, the USDA, its Agencies, offices, and employees, and institutions participating in or administering USDA programs are prohibited from discriminating based on race, color, national origin, sex, disability, age, or reprisal or retaliation for prior civil rights activity in any program or activity conducted or funded by USDA.

Persons with disabilities who require alternative means of communication for program information (e.g. Braille, large print, audiotape, American Sign Language, etc.), should contact the Agency (State or local) where they applied for benefits. Individuals who are deaf, hard of hearing or have speech disabilities may contact USDA through the Federal Relay Service at (800) 877-8339. Additionally, program information may be made available in languages other than English.

To file a program complaint of discrimination, complete the [USDA Program Discrimination Complaint Form](https://www.usda.gov/sites/default/files/documents/USDA-OASCR%20P-Complaint-Form-0508-0002-508-11-28-17Fax2Mail.pdf), (AD-3027) found online at <https://www.usda.gov/sites/default/files/documents/USDA-OASCR%20P-Complaint-Form-0508-0002-508-11-28-17Fax2Mail.pdf>, and at any USDA office, or write a letter addressed to USDA and provide in the letter all of the information requested in the form. To request a copy of the complaint form, call (866) 632-9992. Submit your completed form or letter to USDA by:

1. **Mail:** U.S. Department of Agriculture Office of the Assistant Secretary for Civil Rights 1400 Independence Avenue, SW Washington, D.C. 20250-9410;

2. **Fax:** (202) 690-7442; or **Email:** program.intake@usda.gov.

This institution is an equal opportunity provider.



The opportunity is here.

The fire is within.

LOCKERS

**If you need a locker for the 21-22 school year,
see Mrs. Gum in the Dean's office!**



Lockers will be assigned in B-C.

2021-2022 RED PARKING PASSES

- If you are in need of a pass fill out the google form on the Pekin High website.
- Watch your email account to see when they are ready for pick up from the Dean's Office and return your old pass.



DRAGON RULES



PCHS DRESS CODE

See Student Handbook
for more on Dress and Grooming

Clothing, accessories, make-up, and hair color should in no way distract from the learning environment at school or school activities nor should they create a danger to the health and safety of the students.

School personnel reserve the right to make determinations on acceptable appearance and dress.

- Masks are required, and must be worn over the nose and mouth.
- Shirts with sleeves covering the entire torso and shoulders are required.
- Pants, jeans, shorts, dresses, and skirts must extend to at least mid-thigh.
- When wearing leggings (including knit jeggings) and yoga pants, the top must cover the pelvic region and buttocks.
- No pants may have holes above mid-thigh.
- No undergarments of any kind may be exposed.
- Pajamas/pajama pants are not acceptable attire.
- As a health and safety measure, all students must wear shoes. (slippers are not allowed)

Students who choose to dress in a manner not appropriate for school will be instructed to change their clothing before they will be admitted to class.

Do you meet dress code?



Shorts are
mid- thigh length



Holes are
below mid-thigh



No holes above mid thigh



Shorts
must be
mid thigh
or longer



Do you meet dress code?



No hats



No hoods up



**Shirts must
cover the
entire torso**

Hallway Social Distancing



- Stay to your right
- Obey one way hallways
- Stay 6 feet apart
- Wear your mask

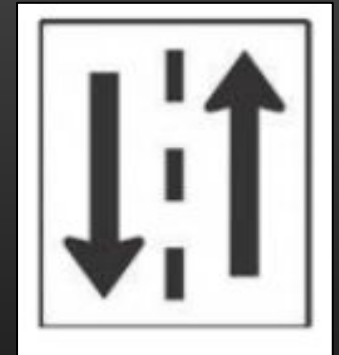

G

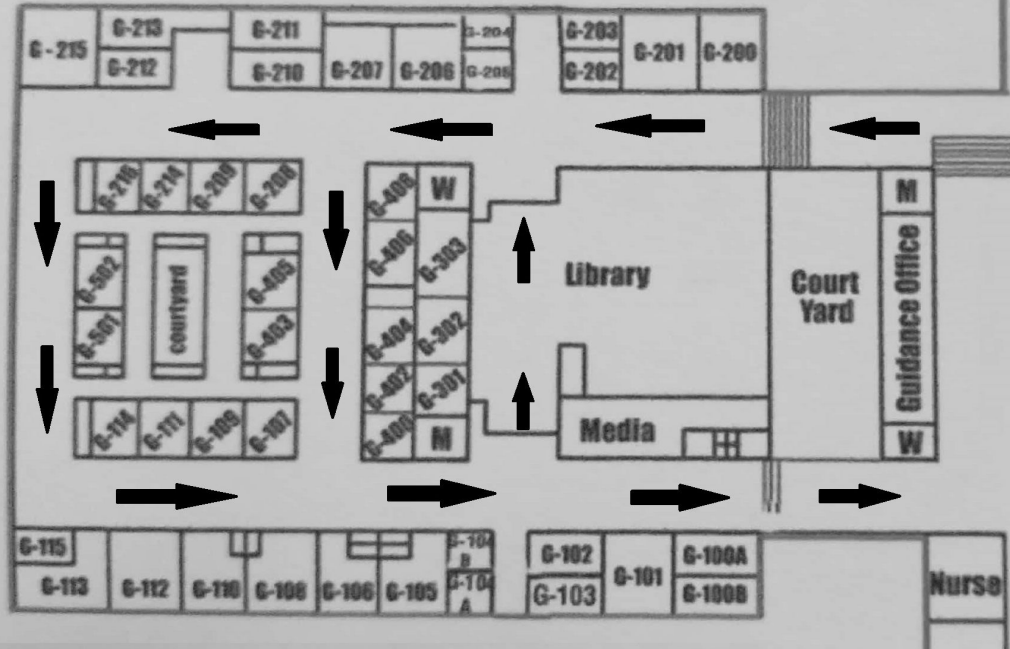

G Building One Way Halls

TRAFFIC FLOW

To aid with Social Distancing during Passing Periods, a few areas in G Building will now be considered "ONE WAY"

DRAGON OPPORTUNITIES



Speech Team Auditions!!!

September 21st and 22nd
G 101 (Pyle's Room)
3:30 PM



Go to the Speech Team [website](#) to fill out an [audition form](#), find [audition material](#), and information about the different high school [speech events](#).

No prior acting or public speaking experience is needed!



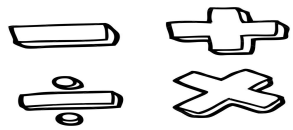

MATH CLUB

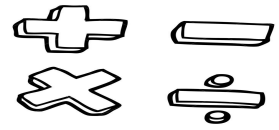

Who's PUMPED to make some
Mathemagic!?

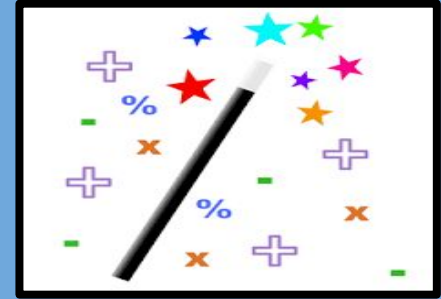

Email- aslobidsky@pekinhigh.net
or
Stop in Room C313 with questions

DRAGON COUNSELING NEWS



UPCOMING COLLEGE REP VISITS

Paul Mitchell The School - Normal	September 16th - 10:45am/4th Hour
Eastern Illinois University	September 29th - 9:40/3rd Hour
Methodist College of UnityPoint Health	September 29th - 1:20pm/6th hour
Greenville University	October 4th - 1:20pm/6th Hour
Missouri State University	October 5th - 1:20pm/6th Hour



**Juniors &
Seniors only**

Sign up in
the
Counseling
Office

AP EXAM REGISTRATION -- Aug 19th-Oct. 15th!!

- ❖ Any student enrolled in an AP course has had the AP exam fee(s) added to their Skyward Account.
- ❖ The total cost **per exam** is \$87.
(unless you are on free/reduced for lunch)
- ❖ Fees need to be **paid in-full no later than Oct. 15th.**
- ❖ Any students **NOT** wanting to take their AP Exam(s) will need to inform **Mrs. Bisping or Mrs. Solver** in the Counseling Office by the Oct. 15th deadline.
- ❖ Any **FEES NOT PAID** by Oct. 15th will result in an exam **NOT** being ordered for students to take the exam.

OUR DRAGONS:

WEAR MASKS

SOCIAL DISTANCE

WASH HANDS FREQUENTLY

