

Highland Primary

2021-2022



Back to School

Parents:

GETTING TO AND FROM SCHOOL SAFELY:





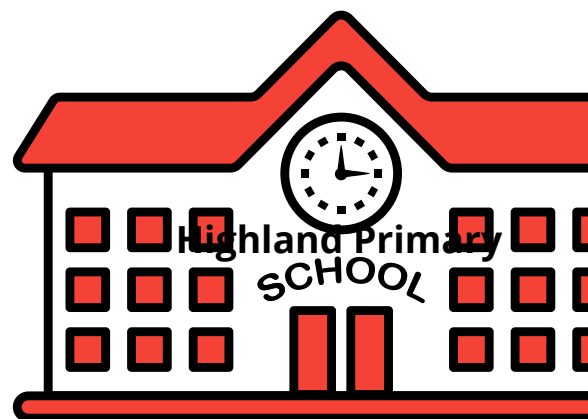
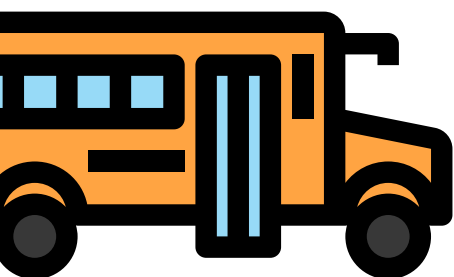





Schedule: Pre-K: 8:30-11, 12:30-3
K-2: 8:40-3:20 (Doors open at 8:15)

- ✓ **Before coming to school**, parents/guardians must check their child's temperature and assess symptoms; if your child has a fever of 100.4 or higher, or a cough, shortness of breath, chills, fatigue, muscle and body aches, headache, sore throat, or new loss of taste or smell, congestion or runny nose, nausea, vomiting, diarrhea, or has been in direct contact with someone who has COVID-19, parents must keep their child home and contact their doctor.
- ✓ **If your child is eligible for bus transportation and you wish for them to ride a bus**, parents will need to check the correct boxes on InfoSnap when registering.
- ✓ **If your child is a pick up student**, please meet at the designated door. (See Pick-Up Map below).
- ✓ **On the bus**, students will wear face covering and sit no more than two to a seat with social distancing. Each bus will be cleaned nightly.
- ✓ **If your child rides in a car to school**, please drop your child off in the circle drive at the front East most door. Children will be required to wear a mask to enter the school. Parents/guardians are not able to accompany children into the building, but may enter through the front middle doors if they have business in the office.
- ✓ Primary students are **not allowed** to walk or ride a bike alone to and from school, without proper supervision.
- ✓ **Dogs** are not allowed on school grounds when children are present.



Students:

SAFETY AT SCHOOL:

-  **When I arrive at school**, I will wear my face covering and grab my breakfast (if my parent wishes) and report to my classroom.
-  **I will bring a water bottle to school with my name on it**, as water fountains will be closed for regular use; water fountains may only be used to refill water bottles throughout the day.
-  **I will remember to bring a clean mask daily**, to wear at my school.
-  **When I am moving about the classroom and school**, I will wear my face covering and practice social distancing.
-  **When I am in the classroom**, I will wear my face covering at all times. If my classroom goes outside for a lesson I may remove my face covering. I will use my own earbuds or headphones for computer lessons, and I will use hand sanitizer after I complete my computer task. All attempts will be made to have desks, tables, and computer stations spaced three feet apart.
-  **I will have a schedule for washing my hands** or when using hand sanitizer throughout the day.
-  **I will take regularly scheduled breaks throughout the academic day with my mask off**, when I am outside and the weather permits.
-  **When I am in special classes**, I will practice social distancing and sit with my "small family."
-  **When I am in the cafeteria**, I will practice social distancing. Before picking up my food, I will use hand sanitizer. No more than 6 students will sit at any one table.
-  **I will wash hands** or use hand sanitizer before and after using shared supplies.
-  **Access to my school will be limited** to students, staff and critical volunteers.

General Safety Guidelines:

SAFETY PROCEDURES FOR EVERYONE:

- ✓ **Limited furniture** will be permitted in the classrooms to accommodate added space between desks, tables, and chairs.
- ✓ **Furniture** may be added to the classrooms as allowed. We will continue to try to accommodate the social distance between desks, tables, and chairs.
- ✓ **No cloth seating or resources** will be used in the classrooms.
- ✓ **Rugs may be added later in the year** if we are able to maintain a healthy environment.
- ✓ **Students will continue with small family seating** (groupings) in the classrooms, special classes and cafeteria to limit quarantines and exposures.
- ✓ **Bathroom occupancy** will be 6 students (small family) to limit quarantines and exposures.
- ✓ **All doors and stairwells** will return to 2-way traffic.
- ✓ **We will continue to use "small family" groups and seating charts** in all specialist classes, classrooms and cafeteria.
- ✓ **Students may sit closer than 3 ft** apart for small amounts of time. (Under 15 min)



Supply Lists:



PRE-K

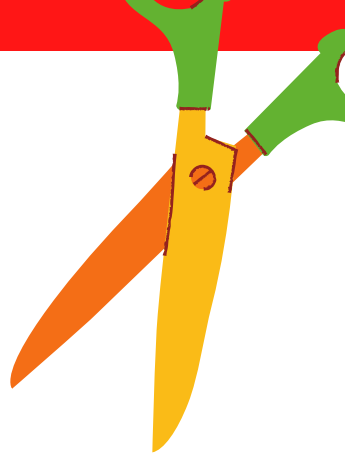

****All supplies should be labeled with your child's name****

ECH/PreK-AM

- Backpack **No wheels** (large enough to hold a pocket folder)
- change of clothes - Please put in a gallon size Ziploc bag labeled with child's name.
- 2 plastic folders with pockets on the bottom

ECH/PreK-PM

- Backpack No wheels (large enough to hold a pocket folder)
- change of clothes - Please put in a gallon size Ziploc bag labeled with child's name.
- 2 plastic folders with pockets on the bottom

Supply Lists:

✓ KINDERGARTEN

****All supplies should be labeled with your child's name****



- 1 RED plastic folder with two pockets and prongs
- 1 plastic folder with two pockets color of choice
- 1 pink block eraser
- 24 count box of standard size Crayola crayons
- 8 count Crayola crayons (Not JUMBO)
- 2 (4 oz.) bottles of white Elmer's school glue (not "No Run" or Gels)
- 3 glue sticks (2 for classroom, 1 for art)
- 10 yellow (#2) pencils, sharpened
- 1 box broad tipped large washable Crayola Classic Markers
- 1 Crayola watercolor paint set (single row)
- 1 pair of Fiskars scissors
- 1 large box of facial tissues
- 1 box of baby wipes or a refill pack (Boys)
- 1 container of Clorox wipes (Girls)
- gym shoes (velcro or slip on) No black soles - unless non-marking
- backpack or book bag (NO WHEELS)
- 1 box of gallon size Ziploc bags - (Boys)
- 1 box of sandwich size Ziploc bags - (Girls)
- Headphones (not earbuds) that will fit an iPad
- If your child uses a lunch box, be sure to label it with child's name
- 1 large bath towel (no rest mats, please)
- 1 plastic supply box

Supply Lists:

✓ 1ST GRADE



All supplies should be labeled with your child's name*

- 20 (#2) yellow pencils, sharpened
- 1 box broad tipped large Crayola Classic Markers
- 1 pink block eraser
- 3 **PLASTIC 2-pocket** folders with prongs and pockets across the bottom (1 green, the other 2 can be any color)
- 1 spiral notebook (80 sheets and wide-ruled)
- 24 count box of standard size Crayola crayons (NO LARGER)
- 1 Crayola watercolor paint set
- 1 pair of Fiskars scissors
- 1 (4 oz.) bottles of Elmer's glue
- 5 large glue sticks (.77 oz.)
- 4 black dry-erase markers
- 1 supply box (approximately 8" x 4 1/4")
- 2 large boxes of facial tissues
- 1 box of baby wipes or a refill pack (boys)
- 1 box of gallon size freezer Ziploc bags (girls) -No Ziplocs for Mrs. Counts
- **Wide Ruled** composition notebook
- gym shoes - No black soles unless non-marking
- backpack or book bag - used daily (WITHOUT WHEELS)

Please send additional supplies after winter break because they will be running low:

- 10 (#2) pencils, sharpened
- 1 box of broad tipped large Crayola Classic Markers
- 24 count box of standard size Crayola crayons
- 4 large glue sticks (.77 oz.)
- 1 large box of facial tissues

Supply Lists:

✓ 2ND GRADE

All supplies should be labeled with your child's name*

- 6 (#2) pencils, sharpened
- 1 box of 24 (#2) Ticonderoga yellow pencils
- 1 Crayola fine line markers - 10 classic colors
- 1 pink eraser (separate from pencils)
- package of pencil top erasers
- 6 black dry-erase markers
- 2 boxes of 24 count Crayola crayons (NO LARGER)
- 2 red plastic folders - pockets across the bottom
- 2 folders of your choice - pockets across the bottom
- 2 composition books (cover is speckled)
- 2 yellow highlighters
- 1 supply box (approximately 8" x 4 1/4")
- 6 glue sticks
- 2 pair of Fiskars scissors - pointed ends
- 2 large boxes of facial tissues
- 1 box of gallon size freezer Ziploc bags (boys)
- 1 box of sandwich size Ziploc bags (girls)
- 1 box of baby wipes
- 1 container of Clorox wipes
- 1 clean old sock for dry erase board
- 1 pair of Earbuds or earphones for chromebooks
- gym shoes - **non-marking soles**
- backpack or book bag - used daily (without wheels)
- **NO TRAPPER KEEPERS** - These are too big for student desks.
- Post-its (3x3) - 3 pack

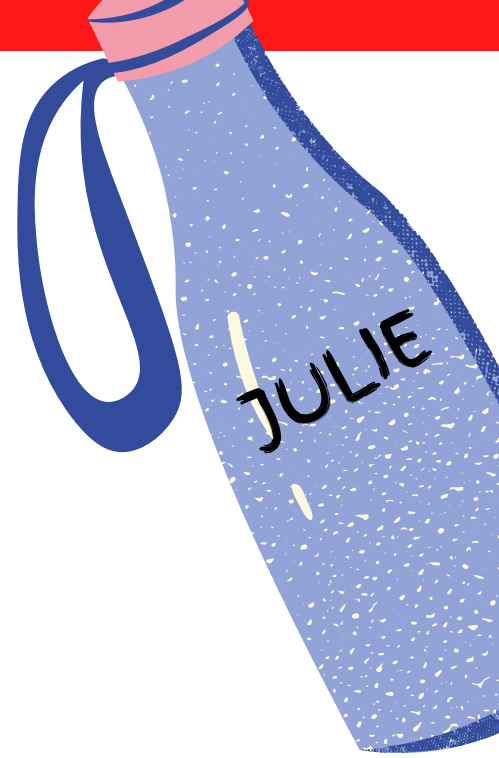

Supply Lists:



SPECIAL EDUCATION

Kindergarten will also need the following items:

- 1 pencil box (to hold supplies)
- 1 box colored pencils
- 2 pink block erasers
- 6 glue sticks
- 1 pair of Fiskars scissors - pointed ends
- 1 container of Clorox wipes
- 1 box pencil top erasers
- 2 boxes of tissues
- 1 pack of sticky notes
- 3 wide ruled spiral notebooks
- 12 count sharpened pencils
- 24 count box of Crayola crayons
- 1 bottle white school glue
- 1 pair of scissors
- 4-pack thin dry erase markers
- 1 highlighter

Students in 1st Grade will also need the following items:

- 24 count box of standard size Crayola crayons
- 6 glue sticks
- 4 pink block erasers
- 1 box of quart size Ziploc bags (Girls)
- 1 box of gallon size Easy Glide Freezer Bags (Boys)
- 1 pair of scissors
- 3 large boxes of facial tissues
- 1 plastic pencil box
- 1 pack sticky notes
- 2 dry erase markers
- 1 highlighter
- 1 package of baby wipes (girls)
- 1 container of Clorox wipes (boys)



Supply Lists:



SPECIAL EDUCATION

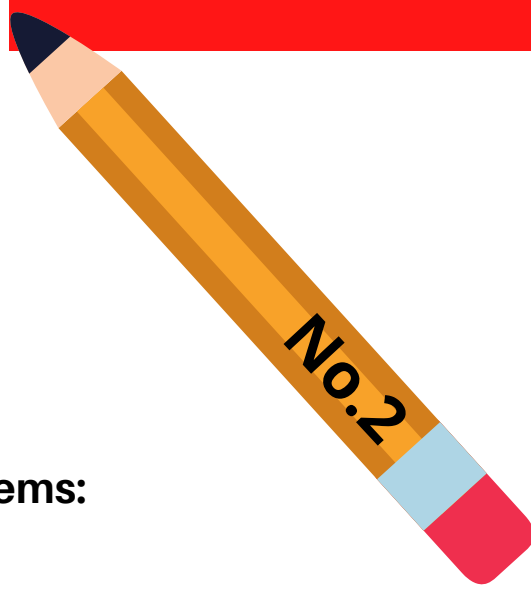

Students in 2nd grade will also need the following items:

- 6 glue sticks
- 2 box of tissues
- 1 pack of sticky notes
- 3 wide ruled spiral notebooks

**** Mrs. Bloemer and will be in contact with parents regarding general education supplies.**

- 1 backpack (no wheels please)
- 1 plastic supply box
- 2 packs baby wipes
- 3 boxes of tissues
- 2 containers of disinfecting wipes
- 2 glue sticks
- 1 bottle white glue
- 1 blunt child scissors
- 1 box markers
- 1 box crayons
- 1 pack dry erase markers
- 1 box pencils
- 1 clipboard (flat particle board)
- 1 pack of notecards

Pick Up Map:

PLAYGROUND

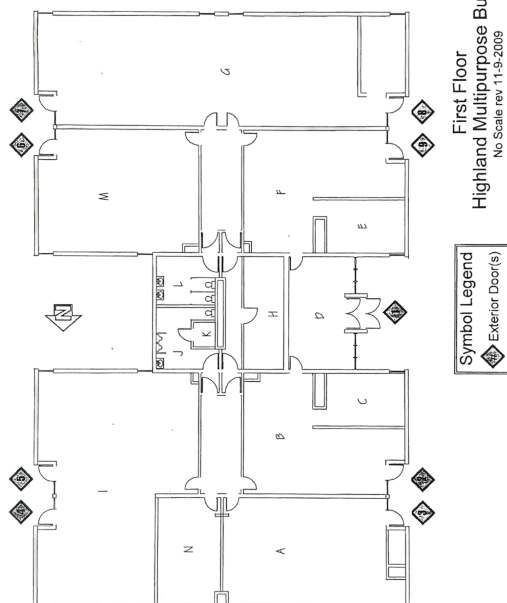

PRE-K:

Carman: Door 2
Hanlon: Door 14
Wilke: Door 3
Zuccarelli: Door 3

KINDERGARTEN

Albers: Door 5
Mendenhall: Door 6
Mortland: Door 5
Potthast: Door 5
Townsend: Door 5
Wesselman: Door 6
Woods: Door 6

1ST GRADE

Drazen: Door 2
Counts: Door 2
Ficker: Door 2
Geest: Door 14
Moss: Door 1
Pittman: Door 1
Wilkinson: Door 1

2ND GRADE

Chapman: Cafeteria/Playground
Kellerstrass: Cafeteria/Playground
Laird: Cafeteria/Playground
Sinnock: Cafeteria/Playground
Smart: Cafeteria/Playground
Smith: Cafeteria/Playground
Warnecke: Cafeteria/Playground

General Safety Guidelines:

SAFETY PROCEDURES FOR EVERYONE:

- ✓ **Any student needing to quarantine** will be provided an opportunity to continue learning during the quarantine period through at home learning with paper packets or computerized assignments.
- ✓ **Parents who will be picking up a child for early dismissal** due to illness or a medical appointment will be expected to call the front office when they arrive at the school and remain in their vehicle in front of the office. A staff member will bring the child to the vehicle, check your identification, and assist you in signing out the student. There is no dismissal within 15 minutes of the regular end of the school day, and only parents, guardians, or other individuals identified on the student's contact list, with appropriate identification, will be allowed to leave with the student.
- ✓ **The school nurse will have a designated isolation area** in the event that a child or a staff member comes to school and presents COVID-19 symptoms. Parents will be contacted to pick ill students up immediately. Contact tracing will be used to identify students or staff members who may need to self-quarantine for 14 days. Students will transition to at home learning with paper packets or computerized assignments using the Seesaw platform.
- ✓ **All buildings and work spaces will be cleaned nightly.**



Special Dates:

- **August 16, 6-7 pm Back to School Night** Meet your teacher & bring your supplies
- **August 17 & 18 Pre-K Screenings** by appointment
- **August 18, First day for grades 1 & 2, Kindergarten Orientation A-K** 9:30, L-Z 1:30
- **August 23 , Pre-K Orientation** - 9:30-10 AM classes, 2-2:30 PM classes
- **August 24 , First day for Pre-K students**
- **September 6, Labor Day - No School**
- **September 10, Fundraiser Zoom-Up**

We are looking forward to a great school year!



Igniting bright futures to build a better community.