

2023-2024 Skyward Parent Online Registration Guide

Go to www.mcallenisd.org, then Click on Register

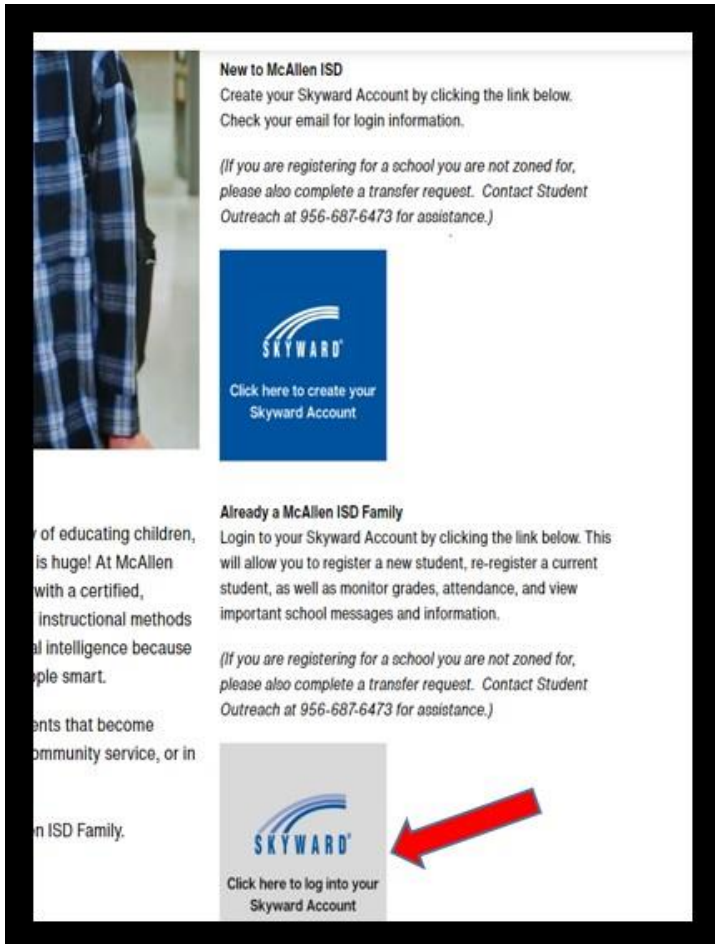

If you are a Returning Student, click on the bottom (GREY) link, if you are a New Student to the district, click on the top (BLUE) link



Not sure what school you are zoned to?
Click on the link below

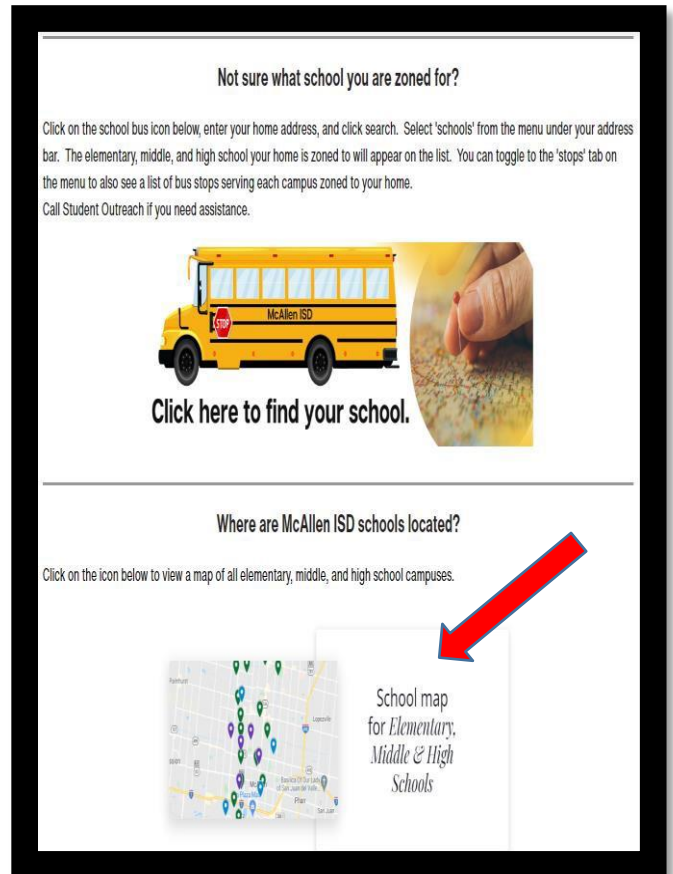

Enter your Skyward Family access account log in & password. If you don't remember your log in and password, please contact your child's current campus.



Once you log in, click on the “2023-24 Returning Student Registration” button

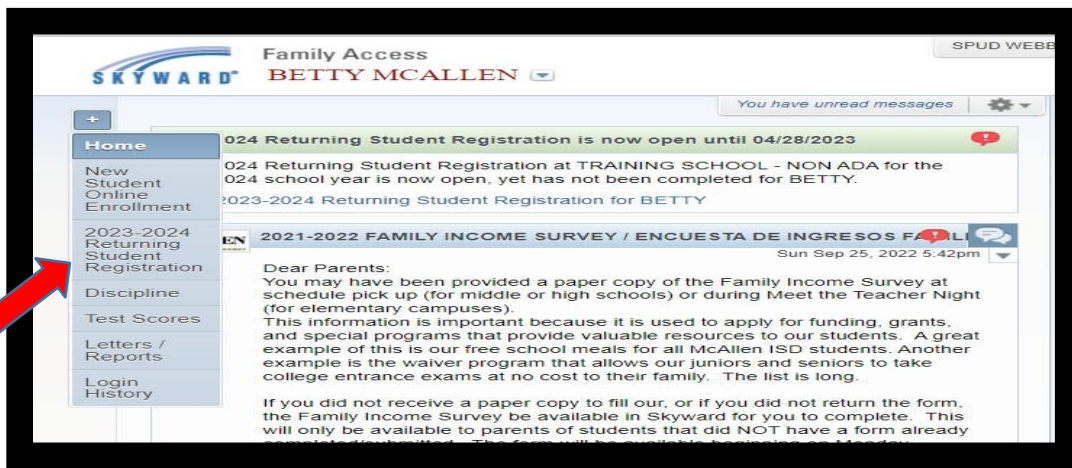

Please read the instructions and click the “Next” button to review and answer all forms.

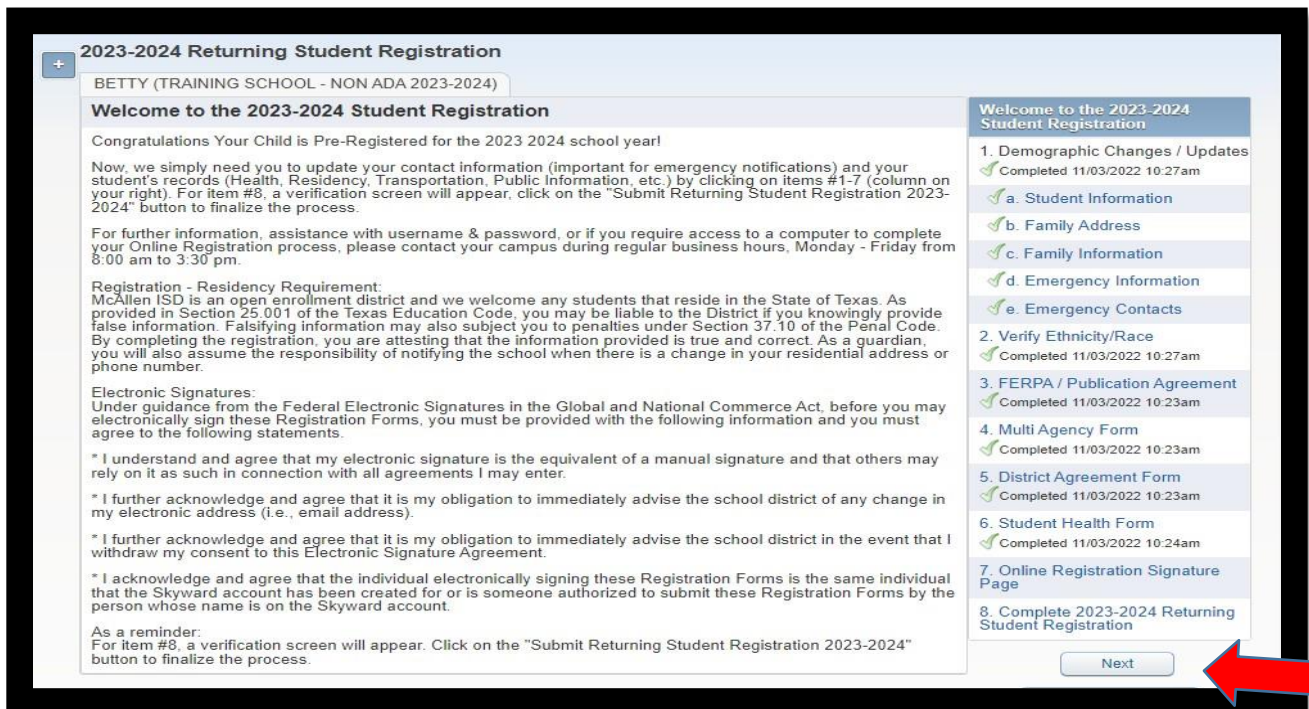

When each step is finished, you will see a button on the bottom or top of the page that tells you “Complete step and go on to the next step”, if you can’t proceed, it means that information is missing in your current step.

Print Complete Step 3 Only Complete Step 3 and move to Step 4

**FAMILY EDUCATIONAL RIGHTS AND PRIVACY ACT (FERPA)
CHILDREN'S ONLINE PRIVACY AND PROTECTION ACT (COPPA)**

**AVISO SOBRE INFORMACION DIRECTORIA Y RESPUESTA DEL
PADRE EN CUANTO A REVELAR INFORMACION ESTUDIANTIL
LEY DE PRIVACIDAD Y PROTECCION EN LINEA PARA NINOS**

Click this link to review the FERPA/COPPA form in English
Haga clic aquí para revisar la forma FERPA/COPPA en Español

FERPA / COPPA GUIDELINES ARE EFFECTIVE IMMEDIATELY / LAS DIRECTRICES FERPA / COPPA SON EFECTIVAS INMEDIATAMENTE	Checkmark = 'Yes' Marca de verificación = Si
1. Do you give the district permission to use the information outlined in the above link for the specified school-sponsored purposes? (example: use student's picture in MISD website, yearbook or other school related events) ¿Le da el permiso al distrito de usar la información de la pagina anterior para los fines especificados patrocinados por la escuela? (ejemplo: use la foto del estudiante en el sitio web de MISD o en otros eventos relacionados con la escuela)	<input checked="" type="checkbox"/>
2. Do you give the district permission to release the information outlined in the above link for requests unrelated to the school-sponsored puposes listed above? (example: private vendor requests for student directory information) ¿Le da al distrito permiso para divulgar la información en esta lista a las solicitudes relacionadas con los propósitos auspiciados por la escuela mencionados anteriormente?	<input checked="" type="checkbox"/>
3. Do you give the district permission to release the student's name, address and telephone number to a military recruiter? ¿Le da el permiso al distrito para liberar el nombre del estudiante, dirección, y número de teléfono a un reclutador militar?	<input checked="" type="checkbox"/>
4. Do you give the district permission to release the student's name, address, and telephone number to an institution of higher education? ¿Le da el permiso al distrito para liberar el nombre del estudiante, dirección, y número de teléfono a una institución de educación superior?	<input checked="" type="checkbox"/>

Print Complete Step 4 Only Complete Step 4 and move to Step 5

**Employment Survey
Encuesta de trabajo**

*Within the past 3 years, have you, or someone in your household, looked for work or worked in agriculture or fishing, with poultry or packing fruits or vegetables?
¿Dentro de los últimos 3 años, usted o alguien de su familia, fue en busca o salió a los trabajos en agricultura o pesca, con aves o empaçando frutas o verduras?

No

**Student Residency Questionnaire
Cuestionario de residencia de estudiante**

The following questions are intended to address the McKinney-Vento Act (42 U.S.C.11434a(2)). The answers to this residency information help determine the services the student may be eligible to receive.
Las siguientes preguntas tienen por finalidad respetar la Ley McKinney-Vento (42 U.S.C.11434a(2)). Las respuestas a esta información de residencia ayuda a determinar los servicios que el estudiante puede recibir.

Is your current address a temporary living arrangement?
¿Su domicilio actual es una vivienda temporaria?

No

Is this temporary living arrangement due to loss of housing or economic hardship? (Example includes fire, flood, lost job, divorce, domestic violence, kicked out by parents, parent in military and was deployed, parents in jail, etc.)
¿Usted tiene este arreglo de vivienda temporaria debido a pérdida de vivienda o problemas económicos? (por ejemplo: incendio, inundación, perdida de trabajo, divorcio, violencia doméstica, echado de casa por los padres, padre es militar y ha sido enviado fuera del país, parents) en la cárcel, etc.)

No

Have you answered 'YES' to either of the questions above? If so then where is the student presently living?
¿Fue su respuesta a alguna de las preguntas anteriores 'SI'? Si 'SI' entonces ¿Dónde vive actualmente el estudiante?

In a motel/ En un motel

In a shelter/ En una vivienda

Checkmark='Yes'
Marca de verificación='Si'

The final step will be a signature page that includes a summary of the forms included in the 2023-2024 Returning Student Online Registration.

Print Complete Step 7 Only Complete Step 7 and move to Step 8

2023-2024 RETURNING STUDENT ONLINE REGISTRATION SIGNATURE CONFIRMATION PAGE

This form serves as an acknowledgement of all the forms I reviewed during the 2023-2024 Returning Student Online Registration process.
Este formulario sirve como reconocimiento de todos los formularios que revisé durante el proceso de registro en línea para la devolución de 2023-2024.

I reviewed and agree with the responses provided on the 2023-2024 FERPA form.
Revisé y estoy de acuerdo con las respuestas proporcionadas en el formulario FERPA 2023-2024.

I reviewed and agree with the reesponses provided on the 2023-2024 MultiAgency form
Revisé y estoy de acuerdo con las respuestas proporcionadas en el formulario de múltiples agencias 2023-2024.

I reviewed and agree with the responses provided on the 2023-2024 Agreement form
Revisé y acepto las respuestas proporcionadas en el formulario de Acuerdo 2023-2024.

I reviewed and agree with the responses provided on the 2023-2024 Student Health form
Revisé y estoy de acuerdo con las respuestas proporcionadas en el formulario de Salud Estudiantil 2023-2024.

By providing my electronic signature below I acknowledge, understand and agree with the responses to the questions on the Returning Student Online Registration forms.
As a parent/guardian, I understand I can modify any responses provided on these forms, If I choose to modify the responses, I must contact my child's campus. Al proporcionar mi firma electrónica a continuación, reconozco, entiendo y acepto las respuestas a las preguntas en los formularios de registro en línea para estudiantes que regresan. Como padre/tutor, entiendo que puedo modificar cualquier respuesta proporcionada en estos formularios. Si elijo modificar las respuestas, debo comunicarme con la escuela de mi hijo.

Student' Parent 

12/05/2022

Once all steps are completed, the final step will be to press the “Submit 2023-2024 Returning Student Registration” button. Please remember that if you don’t press this button, the registration will not be processed.

Family Access
SKYWARD BETTY MCALLEN

SPUD WEBB My Account

2023-2024 Returning Student Registration

BETTY (TRAINING SCHOOL - NON ADA 2023-2024) Print

Step 8. Complete 2023-2024 Returning Student Registration (Required)
By completing 2023-2024 Returning Student Registration, you are confirming that the Steps below have been finished.
Are you sure you want to complete 2023-2024 Returning Student Registration for BETTY?

Review 2023-2024 Returning Student Registration Steps

Step 1)	Demographic Changes / Updates	Completed 11/03/2022 10:27am
<i>No Requested Changes exist for Step 1.</i>		
Step 2)	Verify Ethnicity/Race	Completed 11/03/2022 10:27am
<i>No Requested Changes exist for Step 2.</i>		
Step 3)	FERPA / Publication Agreement	Completed 12/06/2022 12:36pm
Step 4)	Multi Agency Form	Completed 12/06/2022 1:31pm
Step 5)	District Agreement Form	Completed 11/03/2022 10:23am
Step 6)	Student Health Form	Completed 11/03/2022 10:24am
Step 7)	Online Registration Signature Page	Completed 12/06/2022 1:30pm

Guardian Name: SPUD WEBB Guardian Address: 2185 N KENNEDY CIR
RIO GRANDE CITY, TX 78582

Submit 2023-2024 Returning Student Registration

Once the “Submit 2023-2024 Returning Student Registration” button is pressed, you will get the following message in your Skyward home page. You will also receive an email notifying you about the completion of the registration.

Family Access
SKYWARD BETTY MCALLEN

SPUD WEBB My Account Email History Ex

District Li

2023-2024 Returning Student Registration

BETTY (TRAINING SCHOOL - NON ADA 2023-2024)

✔ 2023-2024 Returning Student Registration was **successfully completed** and submitted to the district for BETTY on Tue Dec 6, 2022 1:41pm by SPUD WEBB.

[Go back to review completed steps](#)

[Mark 2023-2024 Returning Student Registration as not completed and make changes](#)