



Presentation for

## REGIONAL SCHOOL UNIT NO. 10

School Committee

*Rumford and Mexico, Maine*

July 20, 2021



1. Site Design Update
2. Discussion on Locally Funded Items
3. Upcoming Meetings

# UPDATED SITE PLAN

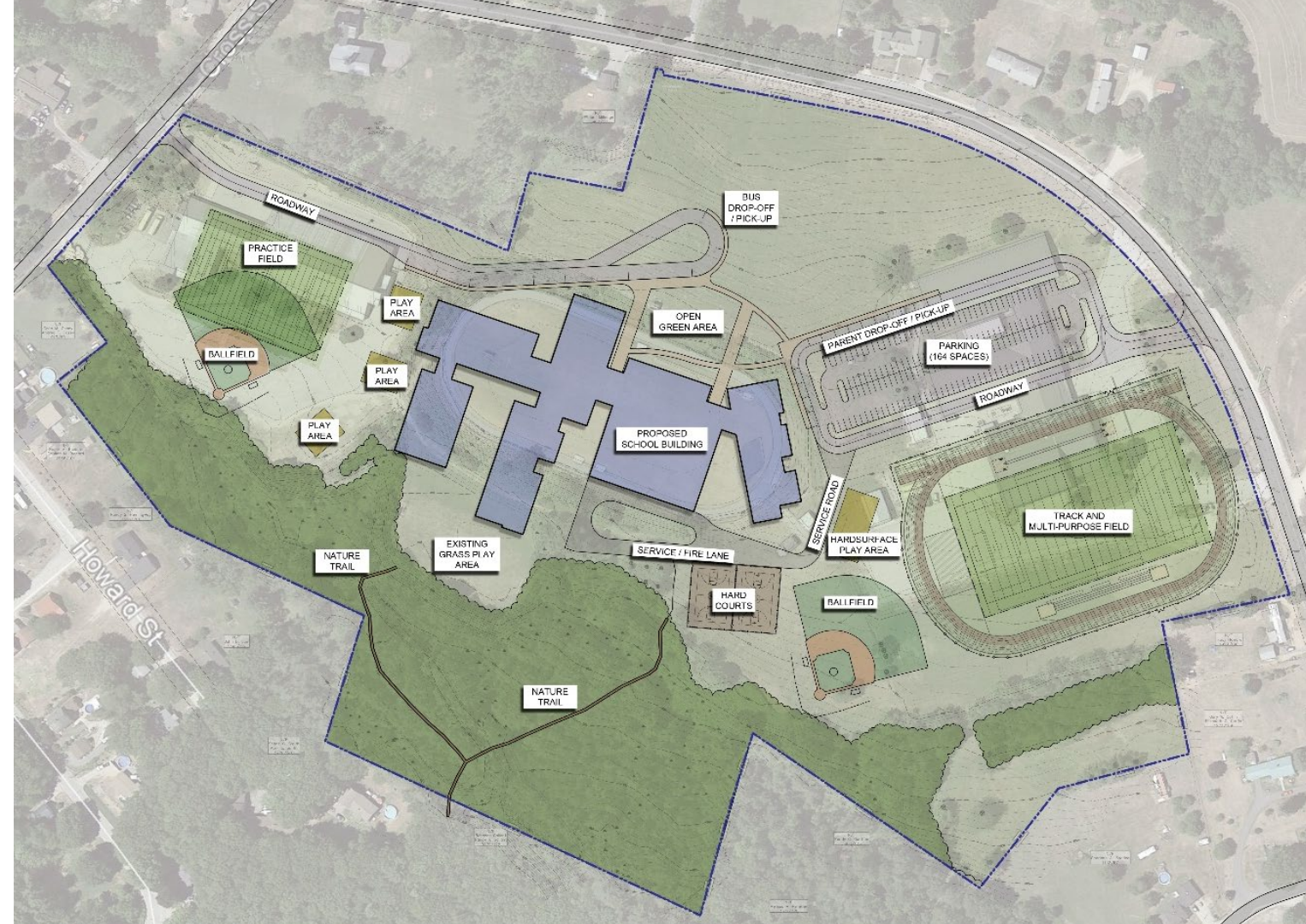



# Discussion of Locally Funded Items

## Additional Item

## Probable Project Cost

• Basketball Court <i>(Part of Hardscape Play Area)</i>	N/A
• Baseball Field <i>(Part of DOE standards)</i>	N/A
• Softball Field <i>(Part of DOE standards)</i>	N/A
1. Artificial Turf at Football/Soccer Field	
2. Field Lighting at Football/Soccer Field	
3. Bleachers <i>(1,000 seats)</i>	
4. Press Box	
5. Score Board	
6. Concessions Building	
7. Security/Admissions Gate Fencing	
8. Additional 4 Track Lanes	
9. Athletic Field Irrigation <i>(Baseball, Softball, Football-50-75k per field)</i>	
10. Cross Country Trails	

## DISCUSSION OF LOCALLY FUNDED ITEMS

## Additional Item

## Probable Project Cost

- Off-Site Improvements (*Traffic-related, DOE mandated*)
- 11. Landscaping/Garden Beds
- 12. Concrete Walkways beyond 50'
- 13. Parking above DOE Supported spaces (*appx. 150*)
- 14. Greenhouse
- 15. Outdoor Classroom
- 16. Nature Based Play Area (*School Ground Greening Coalition*)
- 17. Outdoor Maintenance/Storage Building
- 18. Outdoor Athletic Equipment Storage Building
- 19. Rainwater Harvesting for Garden Program

## DISCUSSION OF LOCALLY FUNDED ITEMS



## Additional Item

## Probable Project Cost

- 20. ES Auditorium *(750 seats, 7,500 SF)*
- 21. MS Auditorium *(350 seats, 4,000 SF)*
- 22. Gymnasium *(4,000 SF additional for regulation size)*
- 23. Fitness Room *(2,500 SF)*
- 24. Community Stair *(400 SF)*
- 25. Geothermal Heating/Cooling *(50% cost sharing)*
- 26. Air Conditioning
- 27. LEED Certification *(Administrative Costs)*
- 28. Passive House Strategies *(TBD)*

## DISCUSSION OF LOCALLY FUNDED ITEMS

## Additional Item

## Probable Project Cost

- 20. ES Auditorium *(750 seats, 7,500 SF)*
- 21. MS Auditorium *(350 seats, 4,000 SF)*
- 22. Gymnasium *(4,000 SF additional for regulation size)*
- 23. Fitness Room *(2,500 SF)*
- 24. Community Stair *(400 SF)*
- 25. Geothermal Heating/Cooling *(50% cost sharing)*
- 26. Air Conditioning
- 27. LEED Certification *(Administrative Costs)*
- 28. Passive House Strategies *(TBD)*

## DISCUSSION OF LOCALLY FUNDED ITEMS



## 06.16.21:Locally funded items prioritized (without seeing pricing):

1. Geothermal Heating/Cooling (*50% cost sharing*)
2. Passive House Strategies (*TBD*)
3. Parking above DOE Supported spaces (*appx. 150*)
4. Outdoor Classroom
5. MS Auditorium (*350 seats, 4,000 SF*)
6. Nature Based Play Area (*School Ground Greening Coalition*)
7. Score Board (this was decided to be eliminated because they already have a new one)
8. Community Stair (*400 SF*)
9. Outdoor Maintenance/Storage Building
10. Gymnasium (*4,000 SF additional for regulation size*)
11. Air Conditioning
12. ES Auditorium (*750 seats, 7,500 SF*)
13. Outdoor Athletic Equipment Storage Building **TIED** Fitness Room (*2,500 SF*)
14. Concessions Building
15. Additional 4 Track Lanes **TIED** Concrete Walkways beyond 50'
16. Security/Admissions Gate Fencing
17. Greenhouse
18. Landscaping/Garden Beds
19. Press Box
20. Field Lighting at Football/Soccer Field
21. Rainwater Harvesting for Garden Program
22. LEED Certification (*Administrative Costs*)
23. Cross Country Trails
24. Bleachers (*1,000 seats*)
25. Athletic Field Irrigation (*Baseball, Softball, Football-50-75k per field*)
26. Artificial Turf at Football/Soccer Field

## LOCAL ITEMS DISCUSSION

*"A welcoming and collaborative learning environment where we plant the seeds and nurture the roots for a strong tomorrow."*

Additional Item	Probable Project Cost
• Basketball Court <i>(Part of Hardscape Play Area)</i>	N/A
• Baseball Field <i>(Part of DOE standards)</i>	N/A
• Softball Field <i>(Part of DOE standards)</i>	N/A
1. Artificial Turf at Football/Soccer Field	\$600,000-\$800,000
2. Field Lighting at Football/Soccer Field	\$400,000-\$600,000
3. Bleachers <i>(1,000 seats)</i>	\$500,000-\$600,000
4. Press Box	\$80,000-\$120,000
5. Score Board	\$30,000-\$45,000
6. Concessions Building	\$200,000-\$300,000
7. Security/Admissions Gate Fencing	\$50,000-\$75,000
8. Additional 4 Track Lanes	\$150,000-\$200,000
9. Athletic Field Irrigation <i>(Baseball, Softball, Football-50-75k per field)</i>	\$150,000-\$225,000
10. Cross Country Trails	\$25,000-\$50,000

## DISCUSSION OF LOCALLY FUNDED ITEMS

## Additional Item

- Off-Site Improvements (*Traffic-related, DOE mandated*)

11. Landscaping/Garden Beds	\$100,000-\$150,000
12. Concrete Walkways beyond 50'	\$50,000-\$75,000
13. Parking above DOE Supported spaces ( <i>appx. 150</i> )	\$600,000-\$800,000
14. Greenhouse	\$200,000-\$300,000
15. Outdoor Classroom	\$50,000-\$75,000
16. Nature Based Play Area ( <i>School Ground Greening Coalition</i> )	\$500,000-\$750,000
17. Outdoor Maintenance/Storage Building	\$150,000-\$200,000
18. Outdoor Athletic Equipment Storage Building	\$150,000-\$200,000
19. Rainwater Harvesting for Garden Program	\$20,000-30,000

## Probable Project Cost

## DISCUSSION OF LOCALLY FUNDED ITEMS

## Additional Item

## Probable Project Cost

20. ES Auditorium <i>(750 seats, 7,500 SF)</i>	\$3,000,000-\$3,750,000
21. MS Auditorium <i>(350 seats, 4,000 SF)</i>	\$1,600,000-\$2,000,000
22. Gymnasium <i>(4,000 SF additional for regulation size)</i>	\$1,600,000-\$2,000,000
23. Fitness Room <i>(2,500 SF)</i>	\$1,000,000-\$1,250,000
24. Community Stair <i>(400 SF)</i>	\$160,000-\$200,000
25. Geothermal Heating/Cooling <i>(50% cost sharing)</i>	\$1,300,000-1,800,000**
26. Air Conditioning	\$1,000,000-1,500,000**
27. LEED Certification <i>(Administrative Costs)</i>	\$100,000-\$150,000
28. Passive House Strategies <i>(added insulation, triple pane)</i>	\$400,000 - \$3,500,000*

## DISCUSSION OF LOCALLY FUNDED ITEMS

## 06.16.21: Locally funded items prioritized (after seeing pricing):

1. Geothermal Heating/Cooling (*50% cost sharing*)
2. Passive House Strategies (*TBD*)\*
3. Parking above DOE Supported spaces (*appx. 150*)
4. Outdoor Classroom
5. MS Auditorium (*350 seats, 4,000 SF*)
6. Community Stair (*400 SF*)
7. Fitness Room (*2,500 SF*)
8. Concrete Walkways beyond 50'
9. Nature Based Play Area (*School Ground Greening Coalition*)
10. Air Conditioning
11. Score Board (this was decided to be eliminated because they already have a new one)
12. Gymnasium (*4,000 SF additional for regulation size*)
13. ES Auditorium (*750 seats, 7,500 SF*)
14. Outdoor Maintenance/Storage Building
15. Concessions Building
16. Additional 4 Track Lanes **TIED** Outdoor Athletic Equipment Storage Building
17. Greenhouse
18. Security/Admissions Gate Fencing
19. Press Box
20. Landscaping/Garden Beds
21. Rainwater Harvesting for Garden Program
22. Field Lighting at Football/Soccer Field **TIED** LEED Certification (*Administrative Costs*)
23. Cross Country Trails
24. Bleachers (*1,000 seats*)
25. Athletic Field Irrigation (*Baseball, Softball, Football-50-75k per field*)
26. Artificial Turf at Football/Soccer Field

## LOCAL ITEMS DISCUSSION

*"A welcoming and collaborative learning environment where we plant the seeds and nurture the roots for a strong tomorrow."*

## Without seeing pricing:

1. Geothermal Heating/Cooling (50% cost sharing)
2. Passive House Strategies (TBD)\*
3. Parking above DOE Supported spaces (appx. 150)
4. Outdoor Classroom
5. MS Auditorium (350 seats, 4,000 SF)
6. Nature Based Play Area (School Ground Greening Coalition)
7. Score Board (this was decided to be eliminated because they already have a new one)
8. Community Stair (400 SF)
9. Outdoor Maintenance/Storage Building
10. Gymnasium (4,000 SF additional for regulation size)
11. Air Conditioning
12. ES Auditorium (750 seats, 7,500 SF)
13. Outdoor Athletic Equipment Storage Building **TIED**  
Fitness Room (2,500 SF)

## With seeing pricing:

- |   |    |                  |
|---|----|------------------|
| 1. Geothermal Heating/Cooling (50% cost sharing)  | —— | \$1.3 - \$1.5M** |
| 2. Passive House Strategies (TBD)*  | —— | \$400K - \$3.5M  |
| 3. Parking above DOE Supported spaces (appx. 150)                                       | —— | \$600k – 800k    |
| 4. Outdoor Classroom  | —— | \$50k – 75k      |
| 5. MS Auditorium (350 seats, 4,000 SF)  | —— | \$1.6M - \$2M    |
| 6. Community Stair (400 SF)   | —— | \$160k - \$200k  |
| 7. Fitness Room (2,500 SF)  | —— | \$1M - \$1.25M   |
| 8. Concrete Walkways beyond 50'   | —— | \$50k - \$75k    |
| 9. Nature Based Play Area (School Ground Greening Coalition)                            | —— | \$500k – \$750k  |
| 10. Air Conditioning  | —— | \$1M - \$1.5M    |
| 11. Score Board (this was decided to be eliminated because they already have a new one) |    |                  |
| 12. Gymnasium (4,000 SF additional for regulation size)                                 | —— | \$1.6M - \$2M    |
| 13. ES Auditorium (750 seats, 7,500 SF)   | —— | \$3M- \$3.75M    |
| 14. Outdoor Maintenance/Storage Building  | —— | \$150k - \$200k  |

## Approx. Value:

## LOCAL ITEMS DISCUSSION

*“A welcoming and collaborative learning environment where we plant the seeds and nurture the roots for a strong tomorrow.”*

**RSU 10 NEW SCHOOL****MECHANICAL OPTIONS SUMMARY**

July 15, 2021

**PREFERRED CONSTRUCTION  
MANAGEMENT****TOTAL SF 169,500**

HVAC OPTION	HVAC TOTAL COST	HVAC ADDITIONAL LOCAL COST TO BASE	PASSIVE HOUSE COSTS	TOTAL ADDITIONAL COST TO BASE	INCREMENTAL COST/SF	NOTES
BASE DESIGN PARTIAL AC	\$10,510,534					
BASE DESIGN FULL COOLING	\$13,404,512	\$2,893,977	\$0	\$2,893,977	\$17.07	
BASE DESIGN FULL COOLING W/ GEOTHERMAL	\$14,675,762	\$4,165,227	\$0	\$4,165,227	\$24.57	
VRF SYSTEM OPTION	\$13,074,528	\$2,563,994	\$0	\$2,563,994	\$15.13	
FULL COOLING DESIGN WITH WINDOW UPGRADES	\$13,102,415	\$2,591,881	\$1,355,424	\$3,947,305	\$23.29	Triple glazed windows
FULL COOLING DESIGN WITH WALL UPGRADES	\$13,240,096	\$2,729,562	\$564,867	\$3,294,429	\$19.44	Dense pack insulation (7") at walls
FULL COOLING DESIGN WITH ROOF UPGRADES	\$13,258,810	\$2,748,276	\$1,091,865	\$3,840,141	\$22.66	Additional 2" rigid insulation and 3" spray insulation at roof
FULL COOLING DESIGN WITH SLAB UPGRADES	\$13,397,828	\$2,887,294	\$389,818	\$3,277,112	\$19.33	Additional 2" rigid insulation under slab
FULL COOLING DESIGN WITH ALL UPGRADES	\$12,752,197	\$2,241,663	\$3,401,974	\$5,643,637	\$33.30	All Passive House Upgrades

**\*ALL COSTS ARE BURDENED WITH ADDONS.****\*\*ALL ADDITIONAL COSTS ARE INCREMENTAL TO THE BASE DESIGN PARTIAL AC COST.**

## LOCAL ITEMS DISCUSSION

*"A welcoming and collaborative learning environment where we plant the seeds and nurture the roots for a strong tomorrow."*



**RSU 10 NEW SCHOOL****MECHANICAL OPTIONS SUMMARY**

July 20, 2021

**PREFERRED CONSTRUCTION  
MANAGEMENT**

TOTAL SF 169,500

HVAC OPTION	HVAC TOTAL COST	HVAC ADDITIONAL LOCAL COST TO BASE	PASSIVE HOUSE COSTS	TOTAL ADDITIONAL COST TO BASE	INCREMENTAL COST/SF	NOTES
BASE DESIGN PARTIAL AC	\$10,281,289					
BASE DESIGN FULL COOLING	\$12,877,180	\$2,595,891	\$0	\$2,595,891	\$15.31	
BASE DESIGN FULL COOLING W/ GEOTHERMAL	\$14,148,430	\$3,867,141	\$0	\$3,867,141	\$22.81	
VRF SYSTEM OPTION	\$13,074,528	\$2,793,239	\$0	\$2,793,239	\$16.48	
FULL COOLING DESIGN WITH WINDOW UPGRADES	\$12,585,108	\$2,303,820	\$1,355,424	\$3,659,244	\$21.59	Triple glazed windows
FULL COOLING DESIGN WITH WALL UPGRADES	\$12,692,045	\$2,410,757	\$564,867	\$2,975,624	\$17.56	Dense pack insulation (7") at walls
FULL COOLING DESIGN WITH ROOF UPGRADES	\$12,681,352	\$2,400,063	\$1,091,865	\$3,491,928	\$20.60	Additional 2" rigid insulation and 3" spray insulation at roof
FULL COOLING DESIGN WITH SLAB UPGRADES	\$12,819,033	\$2,537,744	\$389,818	\$2,927,562	\$17.27	Additional 2" rigid insulation under slab
FULL COOLING DESIGN WITH ALL UPGRADES	\$12,134,637	\$1,853,348	\$3,401,974	\$5,255,322	\$31.00	All Passive House Upgrades

\*ALL COSTS ARE BURDENED WITH ADDONS.

\*\*ALL ADDITIONAL COSTS ARE INCREMENTAL TO THE BASE DESIGN PARTIAL AC COST.

## LOCAL ITEMS DISCUSSION

*"A welcoming and collaborative learning environment where we plant the seeds and nurture the roots for a strong tomorrow."*

**RSU 10 NEW SCHOOL****GEOHERMAL OPTIONS SUMMARY**

July 15, 2021

**PREFERRED CONSTRUCTION  
MANAGEMENT**

TOTAL SF 169,500

HVAC OPTION	HVAC/GEOHERMAL TOTAL COST	DIFFERENTIAL COST TO BASE DESIGN**	PASSIVE HOUSE COSTS**	TOTAL ADD'L COST TO BASE DESIGN**	INCREMENTAL COST/SF	NOTES
BASE DESIGN PARTIAL AC	\$10,510,534					
BASE DESIGN FULL COOLING W/ GEOTHERMAL	\$14,675,762	\$4,165,227	\$0	\$4,165,227	\$24.57	NO PASSIVE HOUSE COMPONENTS
FULL COOLING DESIGN WITH WINDOW UPGRADES	\$14,298,665	\$3,788,131	\$1,355,424	\$5,143,555	\$30.35	Triple glazed windows
FULL COOLING DESIGN WITH WALL UPGRADES	\$14,496,346	\$3,985,812	\$564,867	\$4,550,679	\$26.85	Dense pack insulation (7") at walls
FULL COOLING DESIGN WITH ROOF UPGRADES	\$14,500,060	\$3,989,526	\$1,091,865	\$5,081,391	\$29.98	Additional 2" rigid insulation and 3" spray insulation at roof
FULL COOLING DESIGN WITH SLAB UPGRADES	\$14,669,078	\$4,158,544	\$389,818	\$4,548,362	\$26.83	Additional 2" rigid insulation under slab
FULL COOLING DESIGN WITH ALL UPGRADES	\$13,918,447	\$3,407,913	\$3,401,974	\$6,809,887	\$40.18	All Passive House Upgrades

\*ALL COSTS ARE BURDENED WITH ADDONS.

\*\*ALL ADDITIONAL COSTS ARE INCREMENTAL TO THE BASE DESIGN PARTIAL AC COST.

## LOCAL ITEMS DISCUSSION

*"A welcoming and collaborative learning environment where we plant the seeds and nurture the roots for a strong tomorrow."*

## RSU 10 NEW SCHOOL

### GEOHERMAL OPTIONS SUMMARY

July 20, 2021



PREFERRED CONSTRUCTION  
MANAGEMENT

TOTAL SF 169,500

HVAC OPTION	HVAC/GEOHERMAL TOTAL COST	DIFFERENTIAL COST TO BASE DESIGN**	PASSIVE HOUSE COSTS**	TOTAL ADD'L COST TO BASE DESIGN**	INCREMENTAL COST/SF	NOTES
BASE DESIGN PARTIAL AC	\$10,281,289					
BASE DESIGN FULL COOLING W/ GEOTHERMAL	\$14,148,430	\$3,867,141	\$0	\$3,867,141	\$22.81	NO PASSIVE HOUSE COMPONENTS
FULL COOLING DESIGN WITH WINDOW UPGRADES	\$13,796,358	\$3,515,070	\$1,355,424	\$4,870,494	\$28.73	Triple glazed windows
FULL COOLING DESIGN WITH WALL UPGRADES	\$13,948,295	\$3,667,007	\$564,867	\$4,231,874	\$24.97	Dense pack insulation (7") at walls
FULL COOLING DESIGN WITH ROOF UPGRADES	\$13,922,602	\$3,641,313	\$1,091,865	\$4,733,178	\$27.92	Additional 2" rigid insulation and 3" spray insulation at roof
FULL COOLING DESIGN WITH SLAB UPGRADES	\$14,090,283	\$3,808,994	\$389,818	\$4,198,812	\$24.77	Additional 2" rigid insulation under slab
FULL COOLING DESIGN WITH ALL UPGRADES	\$13,285,887	\$3,004,598	\$3,401,974	\$6,406,572	\$37.80	All Passive House Upgrades

\*ALL COSTS ARE BURDENED WITH ADDONS.

\*\*ALL ADDITIONAL COSTS ARE INCREMENTAL TO THE BASE DESIGN PARTIAL AC COST.

## LOCAL ITEMS DISCUSSION

*"A welcoming and collaborative learning environment where we plant the seeds and nurture the roots for a strong tomorrow."*



Questions?