

# Setting Up Your iPad

Hello

Press home to open

1. Press the Home button

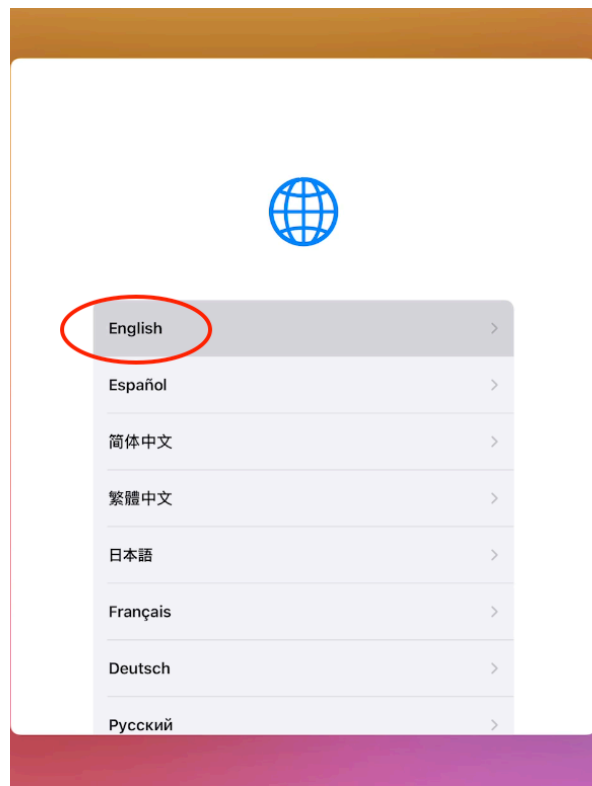

2. Choose English

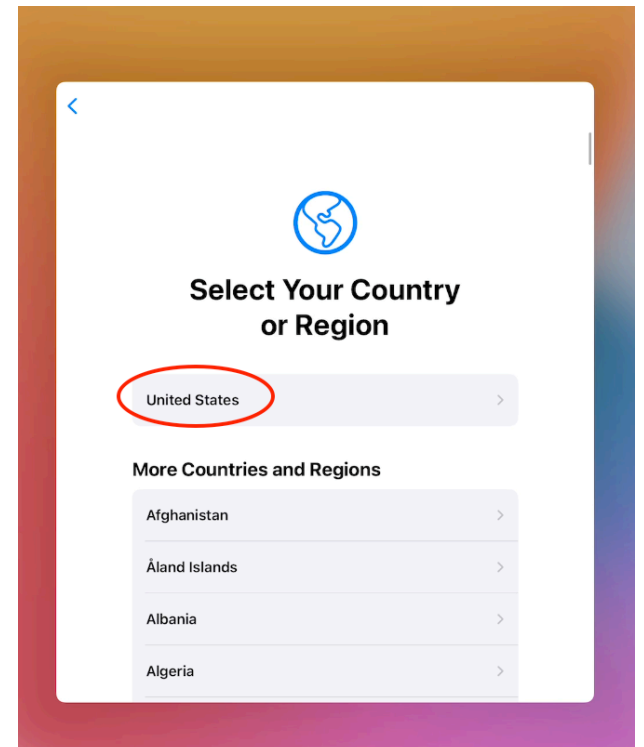

3. Choose United States

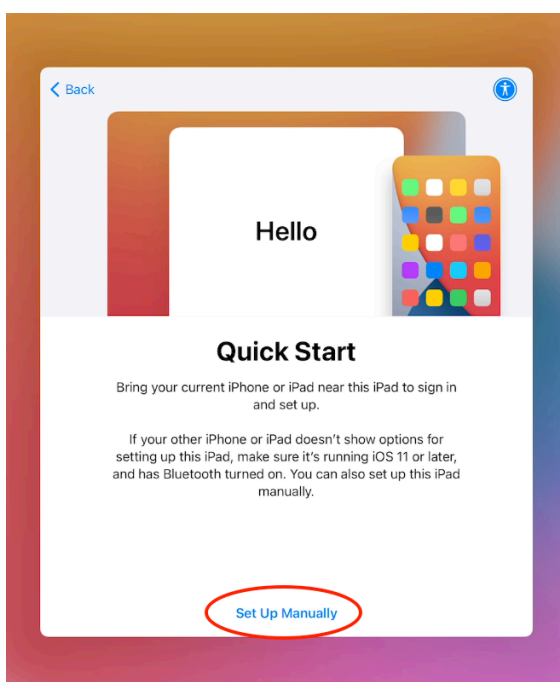

4. Tap Set Up Manually

Your screen will  
show your  
available  
networks

5. Choose Apple Store  
(or if you are outside  
the district, choose  
your network)

Your screen will  
ask for your  
network  
password

6. Type 12345678 for  
the password and then  
tap Join (or if you are  
outside the district, type  
in your network  
password)

# Setting Up Your iPad

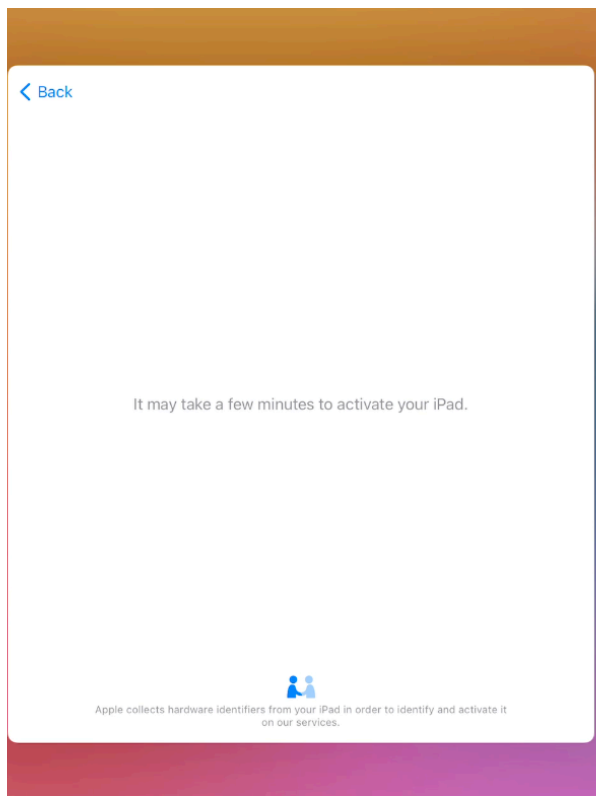

6. This step may take a few minutes like it states

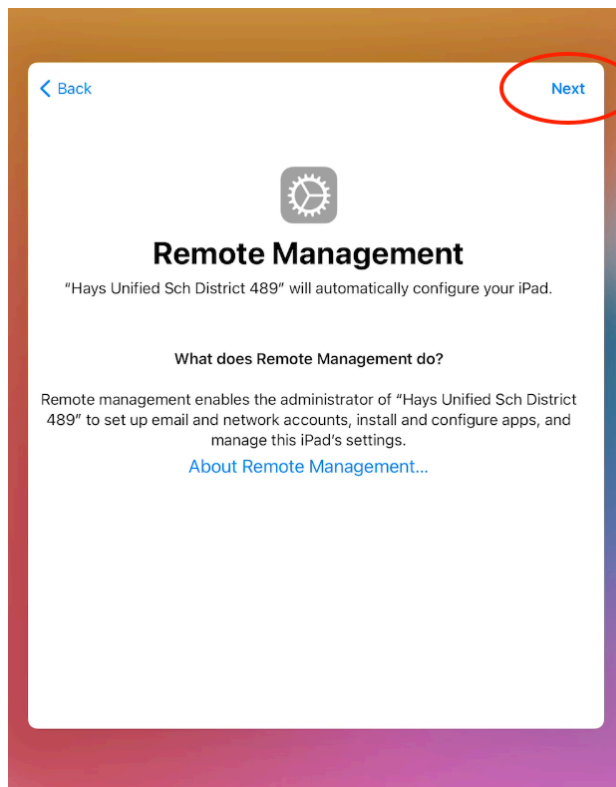

7. When you see the Remote Management screen, tap Next

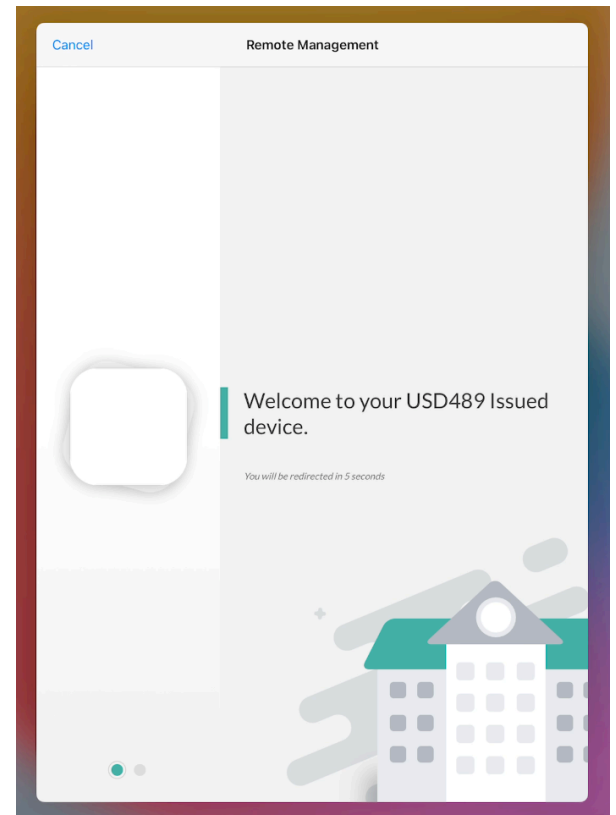

8. The first screen for Mosyle will count down before it moves to the next screen automatically

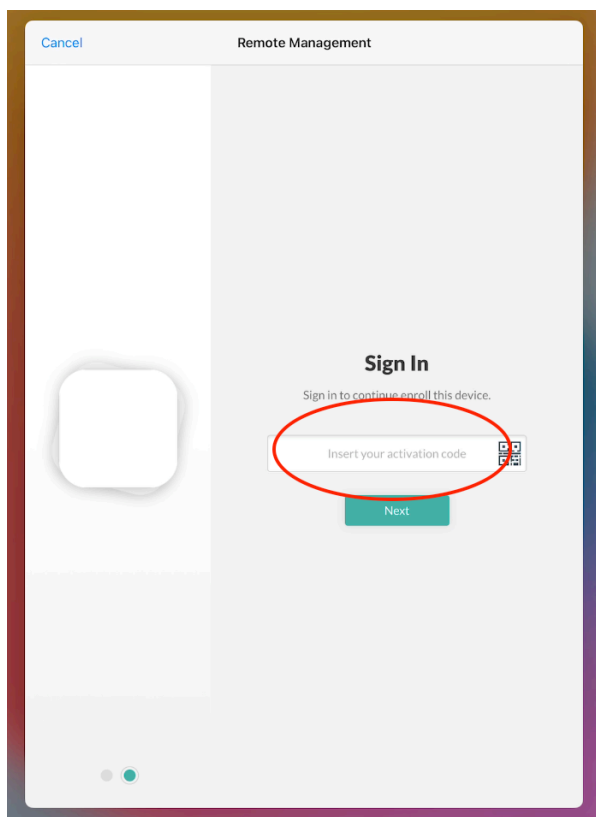

9. This is where you will type in the code that was emailed to you

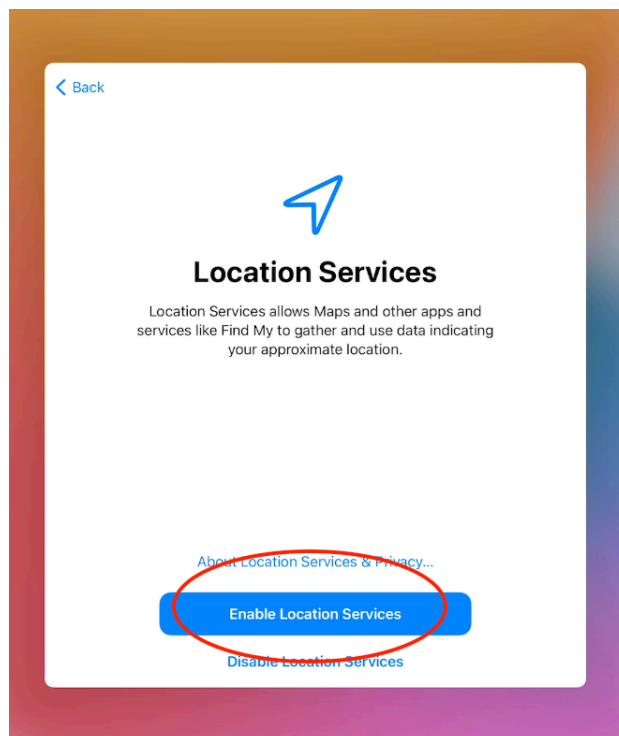

10. Tap Enable Location Services

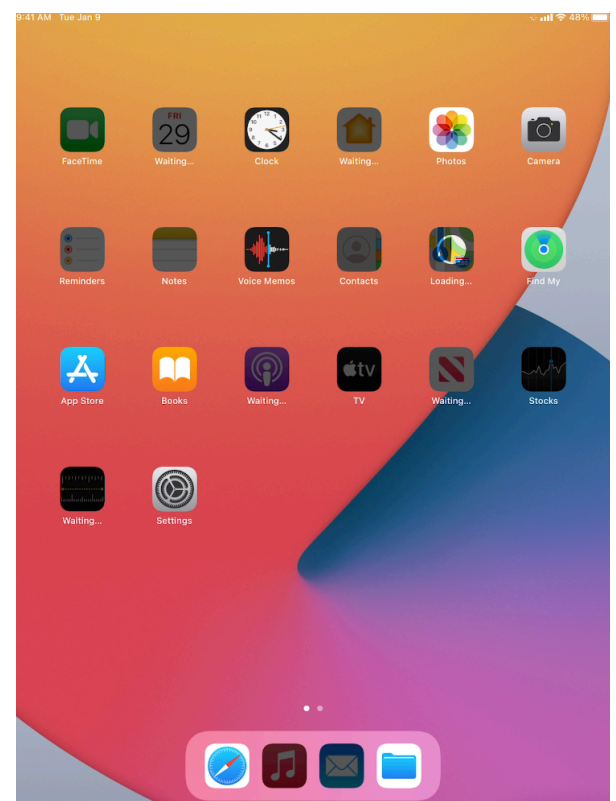

11. Your iPad will move to the Home Screen and you will see apps begin to load

# Setting Up Your iPad

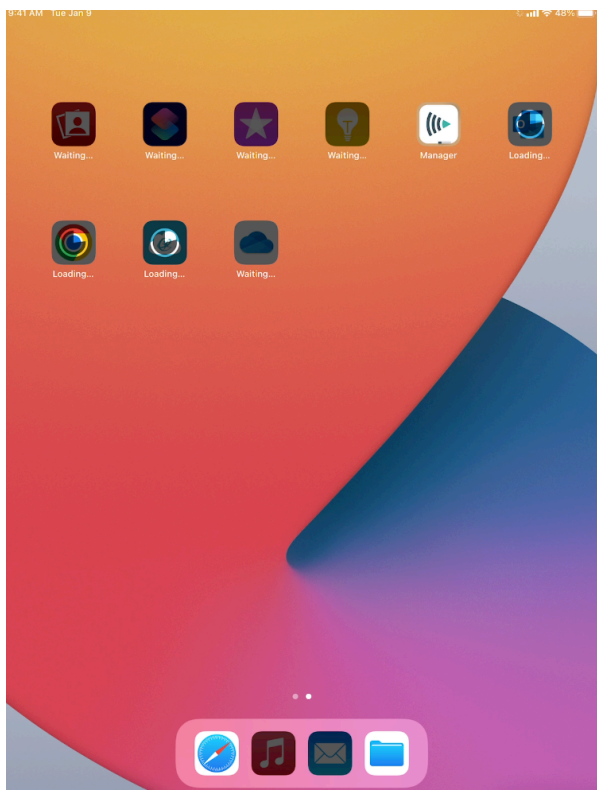

12. If you swipe to the second screen you will see the apps the district has preloading for you

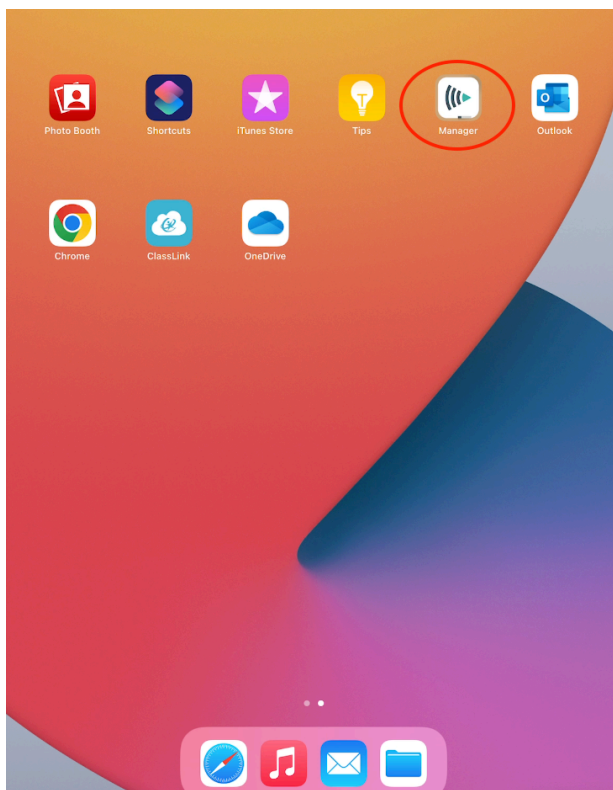

13. Tap the Manager app - this is the app that will allow you to download other apps

\*this app also does many more features that we will teach/rollout throughout the year

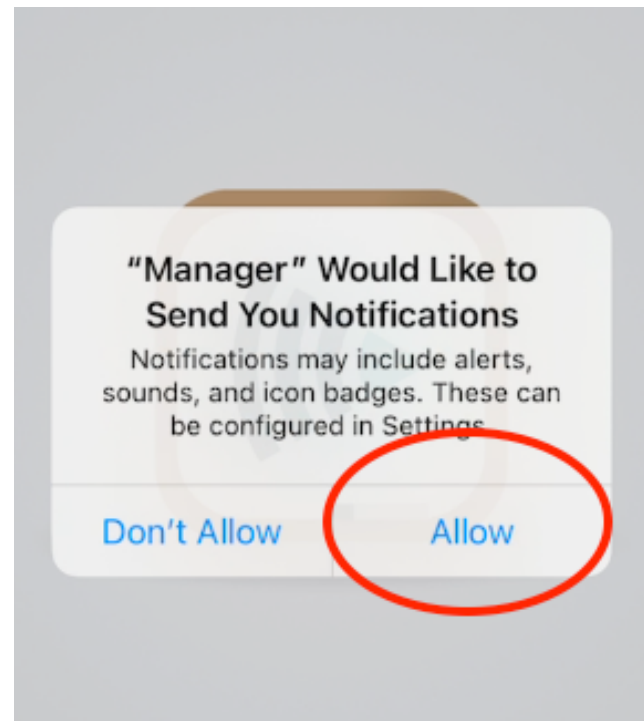

14. Click Allow to allow Manager to send notifications

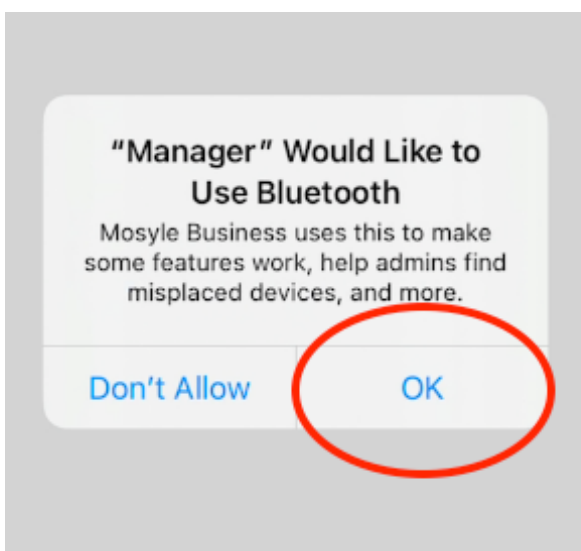

15. Tap OK to allow Manager to use bluetooth

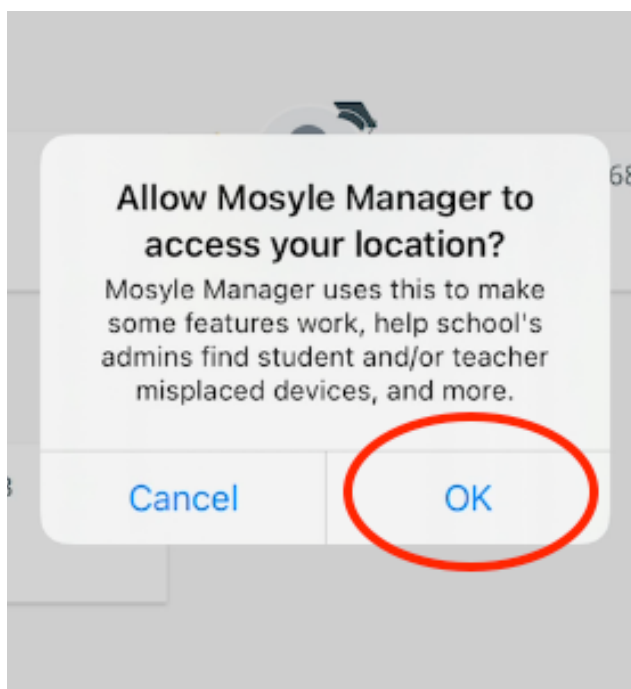

16. Here you will see all of the apps assigned to you - to install an app tap on (Re)Install/Update below the app

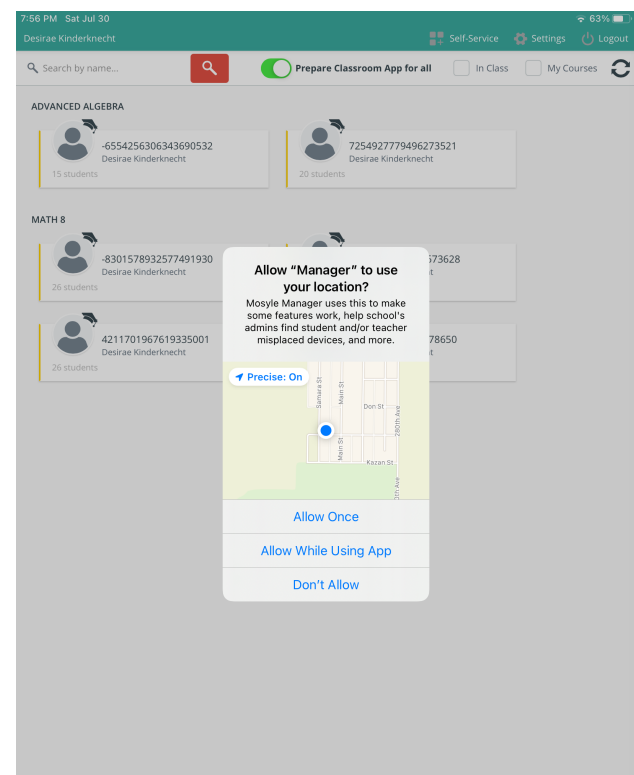

17. Tap Allow While Using App



# Setting Up Your iPad

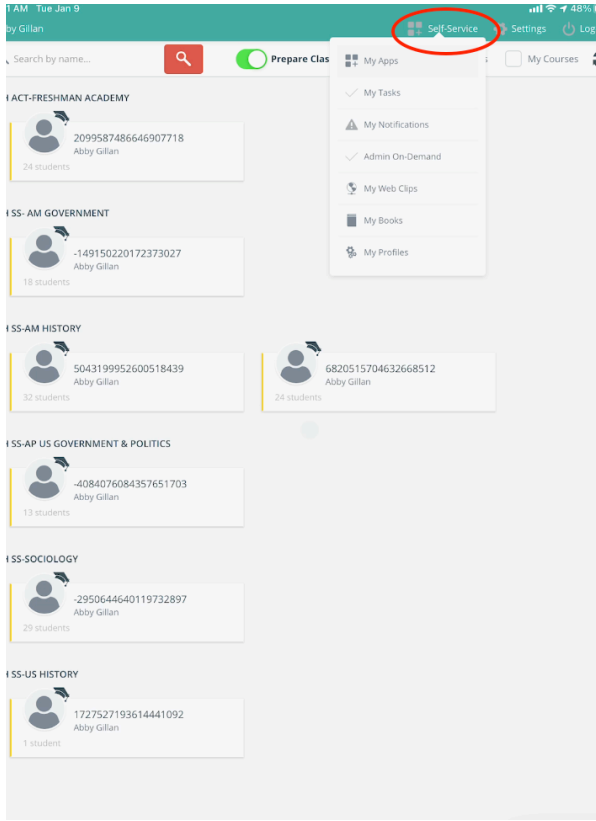

14. Tap Self-Service

\*this app also does many more features that we will teach/rollout throughout the year

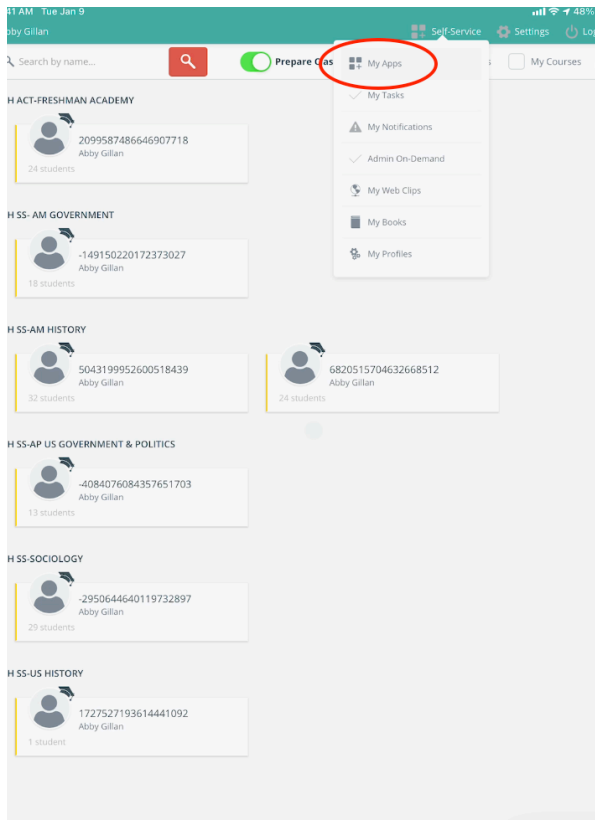

15. Tap My Apps

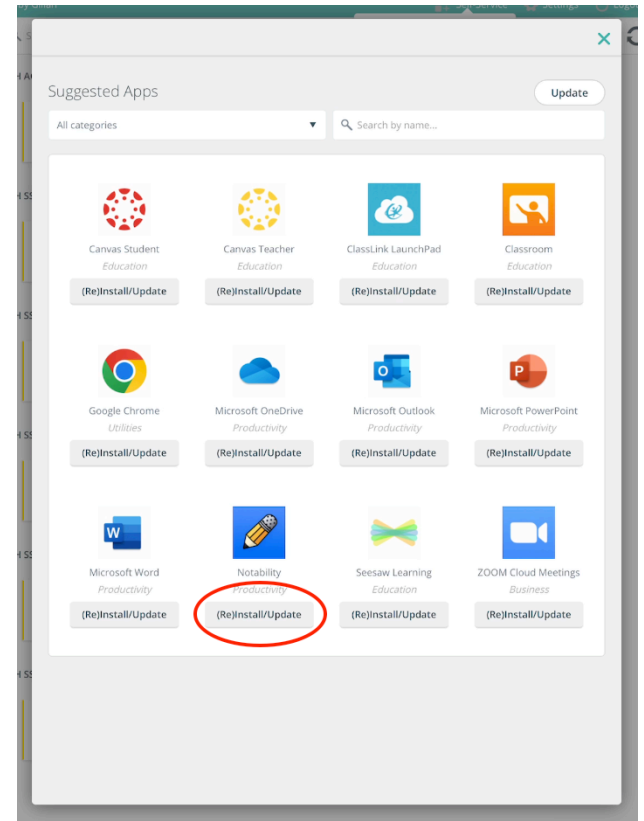

16. Here you will see all of the apps assigned to you - to install an app tap on (Re)Install/Update below the app

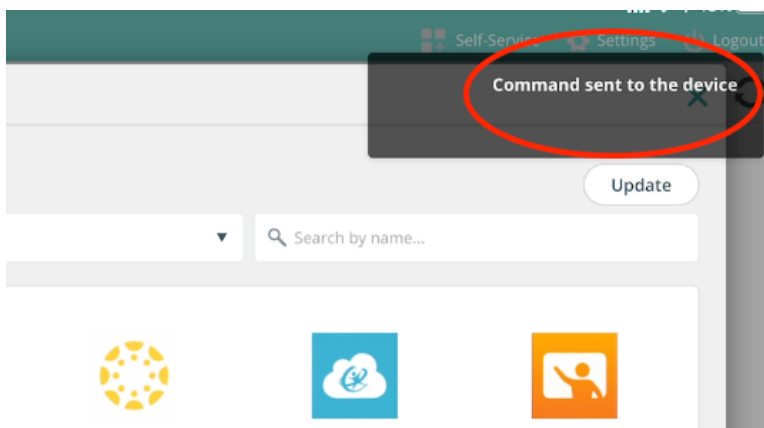

18. Once you tap to install and app you will see “Command sent to the device”

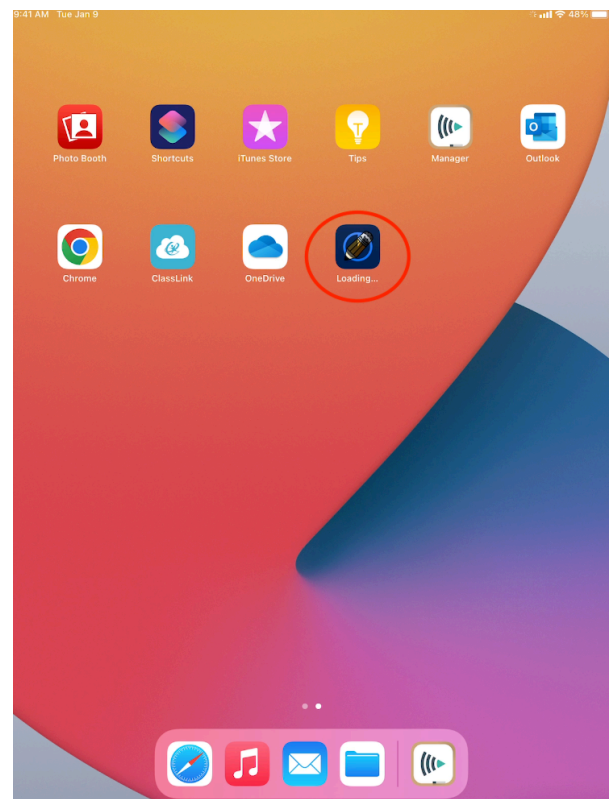

19. If you close out of Manager and go back to your Home Screen, you will see the app loading